

CERTIFIED LAND CORNER RESTORATION

Index No. N-11

State of Wisconsin }
County of Forest } ss.

I Daniel K. Pleoger, do hereby certify that on the 6 day of November, 1981, I ~~was~~ Est. ~~evidence of the~~ Quarter corner of Sections 16 & 21 Township 37 15 East, North, Range 15 East, Fourth Principal Meridian, as described hereon; and that from this evidence I established a new monument and accessories as described hereon to perpetuate the original location of this corner.

Resident witnesses:

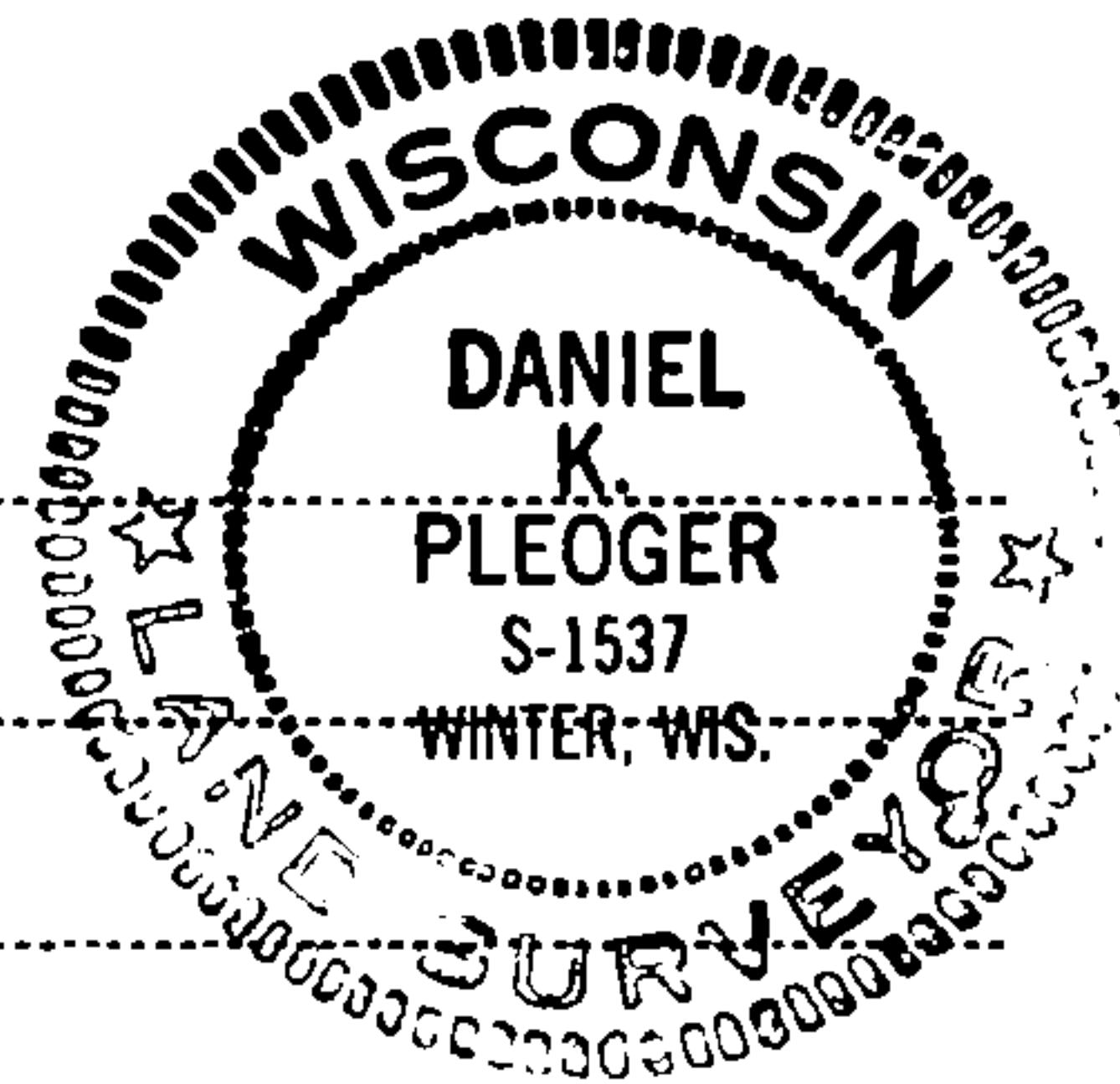

FORM 985 H. C. MILLER CO., MILWAUKEE

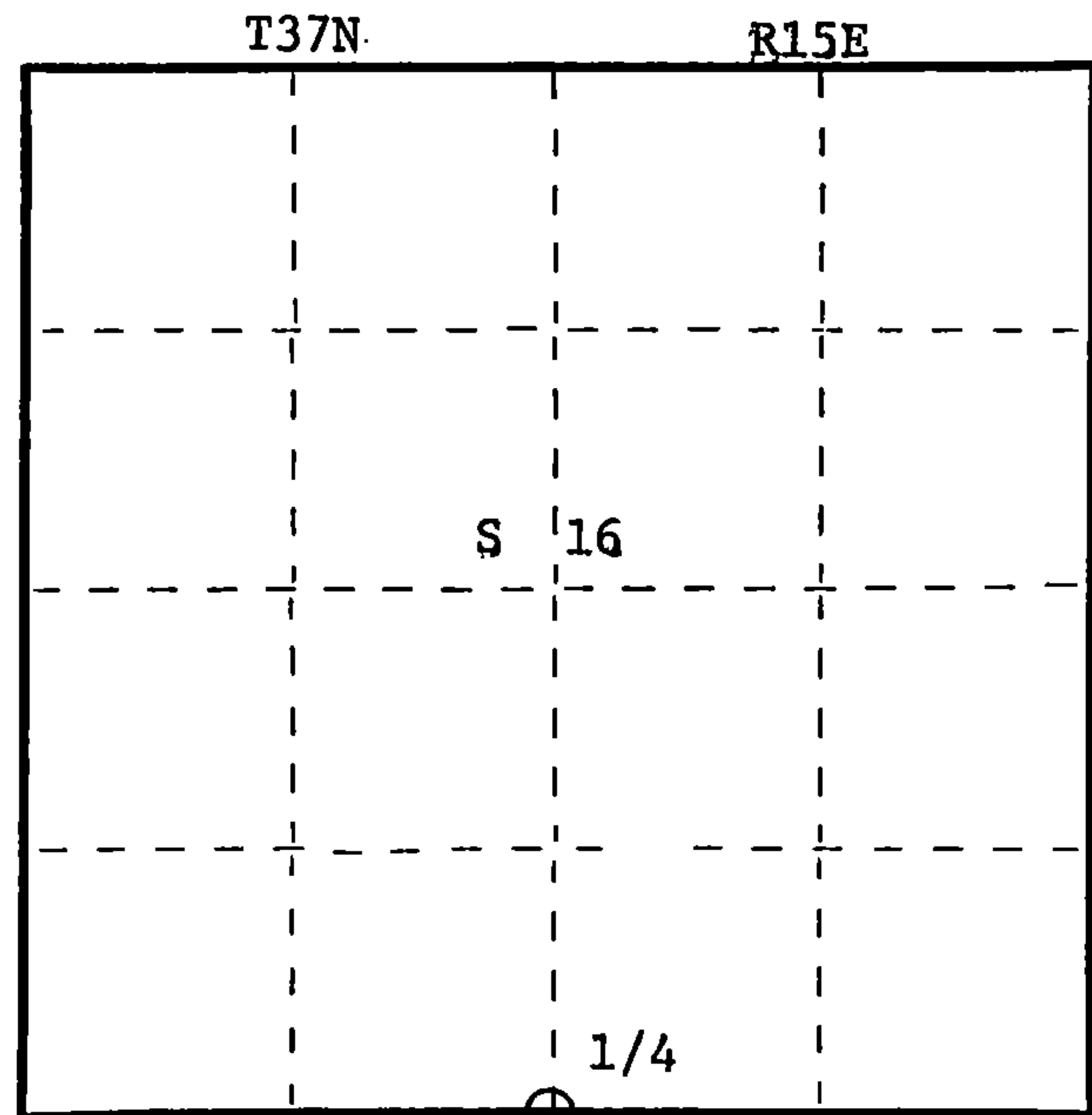

○ = Corner monument restored.

History of original corner establishment:

Original corner established by James L. Nowlin, Gov. Deputy Surveyor in 1865 from which sugar 12" bears N34W 10 lks and lind 12" bears S24W 10 lks.

Description of corner evidence found:

Total distance from section corner 16, 17, 20, 21 to section corner 15, 16, 21, 22 is 5243.012 ft. at bearing S88-14-39E.
Set 1/4 corner 2621.506 ft. intermediate.

Description of monument and accessories I established to perpetuate the original location of this corner.

Set a 2 1/2" aluminum A-1 federal monument with alloy cap stamped: T37N R15E

Monument projects 8" above ground

Marked NBTs:

- Maple 7" north 47.85 ft.
- Sugar 7" West 19.05 ft.
- Sugar 9" S34W 34.91 ft.
- Scribed 1/4 - B.T.

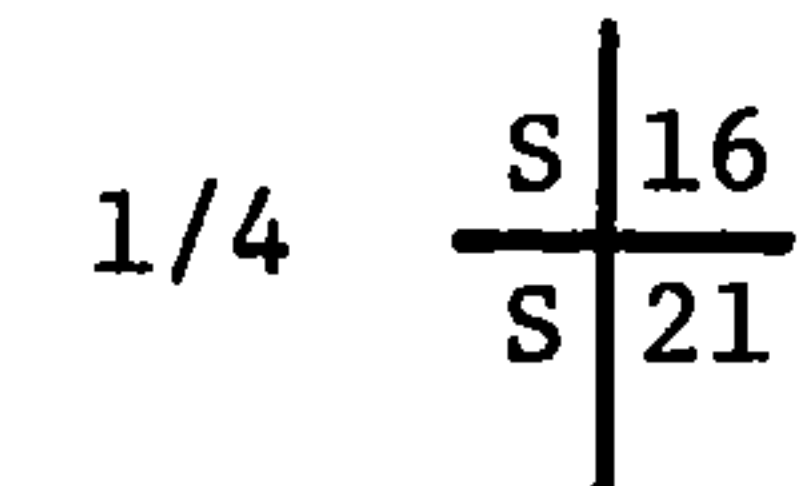

S1537 - 1981

Dated at Rhineland, Wis., this 12th day of November, 1981

Signature Daniel K. Pleoger Title Registered Land Surveyor Registration No. 1537
(County Surveyor, Registered Land Surveyor, or other duly authorized official)

Office of Register of Deeds, County of Forest, I hereby certify that the within instrument was filed in this office for record on the 9th day of April, 1982 at 11:00 o'clock A. M.

DOCUMENT NO. **121397**

(Register of Deeds)

By _____ Deputy

43715160020

U.S. PUBLIC LAND SURVEY MONUMENT RECORD

Index No. N-11

State of Wisconsin } ss.
County of Forest

I Gary L. Pisoni, do hereby certify that on the 9th day of February, 1994, I found evidence of the South Quarter corner of Section 16 Township 37 North, Range 15 East, Fourth Principal Meridian, as described hereon; and that from this evidence I established a new monument and accessories as described hereon to perpetuate the original location of this corner.

Resident witnesses:

.....
.....
.....

History of original corner establishment:

Original Government Survey in 1865 by J.L. Nowlin. West corrected between Sections 16 and 21, at 40.08 chs. set Quarter Section Post, from which the following bear; Sugar, 12", N34°W, 10 lks., Linden, 12", S24°W, 10 lks.

On 11-06-81, Daniel Pleoger, a Registered Land Surveyor, restored the corner position at proportionate distance and on line between opposing Section Corners. At the corner position, set a 2½ inch dia. aluminum A-1 Federal Monument with an alloy cap stamped; T37N R15E, 1/4, S16, S21, S-1537, 1981. Blazed and scribed the following bearing trees;

Description of corner evidence found:	Maple	7"	North	47.85 feet
	Sugar	7"	West	19.05 feet
	Sugar	9"	S34°W	34.91 feet

Found the monument as described above, and the following bearing trees;

Sugar Maple	8"	North	48.10 feet
Sugar Maple	8"	N89°W	19.24 feet
Sugar Maple	14"	S34°W	35.29 feet

Description of monument and accessories I established to perpetuate the original location of this corner.

Blazed and scribed the following new bearing trees; (measurements are taken to a nail in side of tree)

Ash	4"	S30°E	6.16 feet
Steel Sign Post	6"	N65°E	1.05 feet

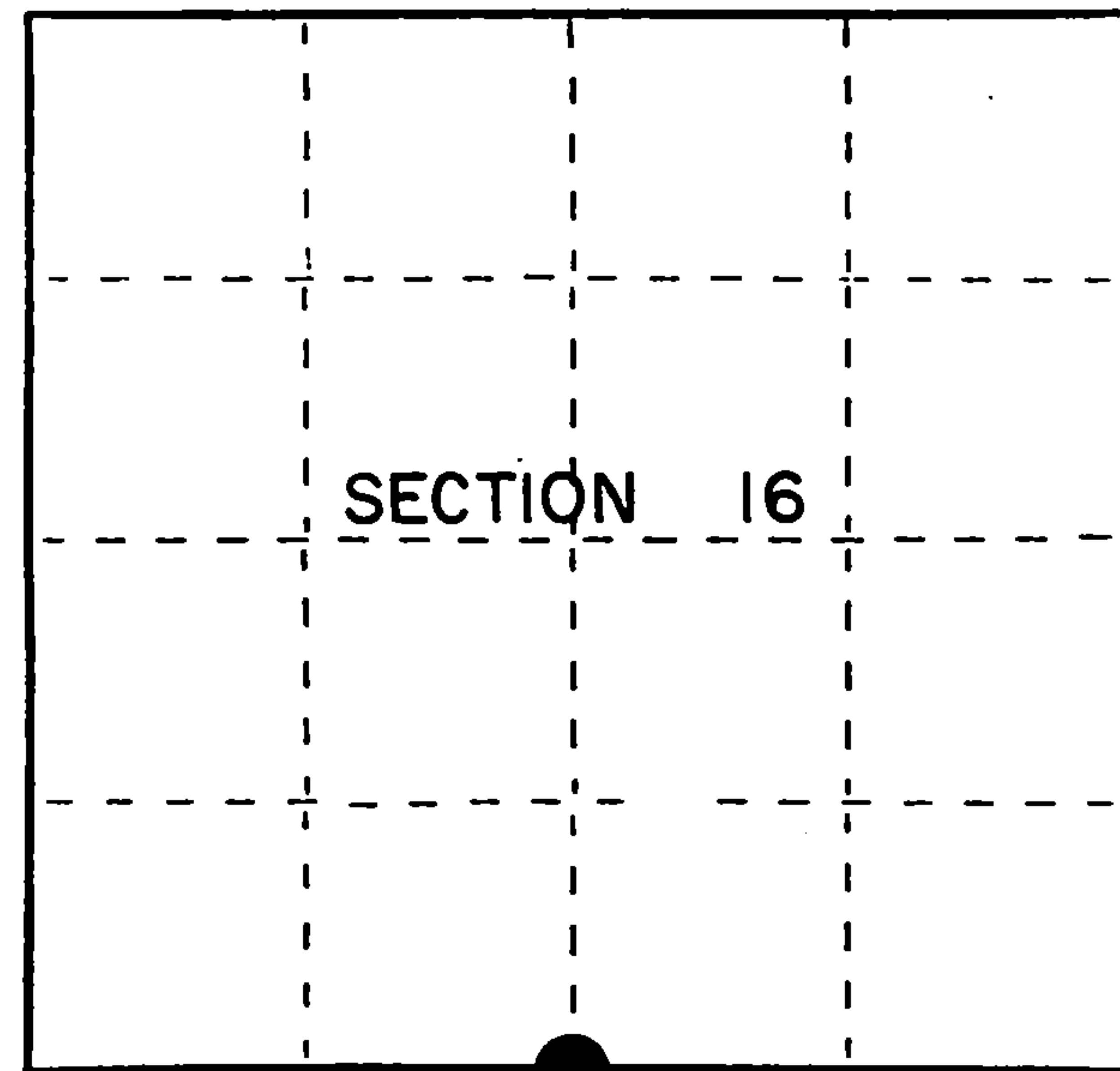

● = Corner monument restored.

Dated at Iron River, MI, Wis., this 5th day of May, 1994

Signature: *Gary L. Pisoni* Title: Land Surveyor Registration No. S-1634
(County Surveyor, Registered Land Surveyor, or other duly authorized official)

Office of Register of Deeds, County of Forest, I hereby certify that the within instrument was filed in this office for record on the 24th day of March, 1997 at 1:30 o'clock P.M.

(Register of Deeds)
By: *John J. Fabian* Deputy

FORM NO. 985-A
H.C. Miller Company

Stock No. 26273

158135

43715160020

(e) Describe any material discrepancy between the location of the corner as restored or reestablished and the location of that corner as previously restored or reestablished by distance and direction. Show the discrepancy on the plan view drawing under (d), above. Show the distances between the corner as previously restored or reestablished and (1) the corner as restored or reestablished, and (2) to at least 2 of the witness monuments shown on the drawing in (d), above.

None

(f) Was the corner restored through acceptance of (1) an obliterated evidence location, or, (2) a found perpetuated location?

Restored through acceptance of a found perpetuated location.

(g&h) Was the corner reestablished through lost corner proportionate methods? If so, show the method, including the directions and distances to other public land survey corners used as evidence or used for proportioning in determining the corner location?

NO

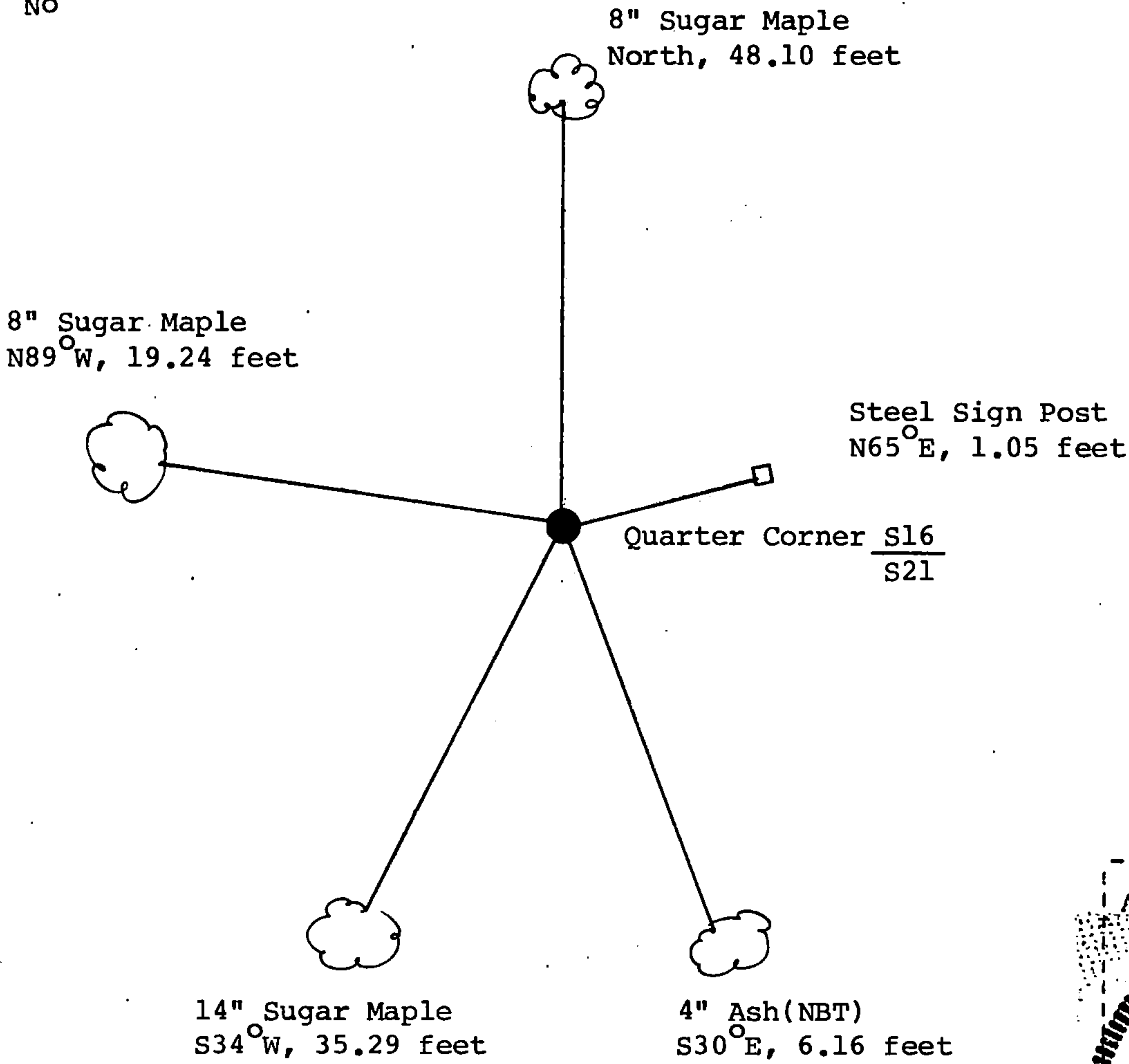

(i) I, Gary L. Pisoni (type or print name) certify that the corner location shown on this record was determined by me or under my direction and control and that this U.S. Public Land Survey Monument Record is correct and complete to the best of my knowledge and belief.

Gary L. Pisoni
Signature

9-18-95
Date