

CERTIFIED LAND CORNER RESTORATION

Index No. W-15

W15

State of Wisconsin }
County of Forest } ss.

I Daniel K. Plegger, do hereby certify that on the 12th day of March, 1981, I found established ~~at the~~ NC 1/16 corner of section 34 Township 37, North, Range 14 East, Fourth Principal Meridian, as described hereon; and that from this evidence I established a new monument and accessories as described hereon to perpetuate the original location of this corner.

Resident witnesses

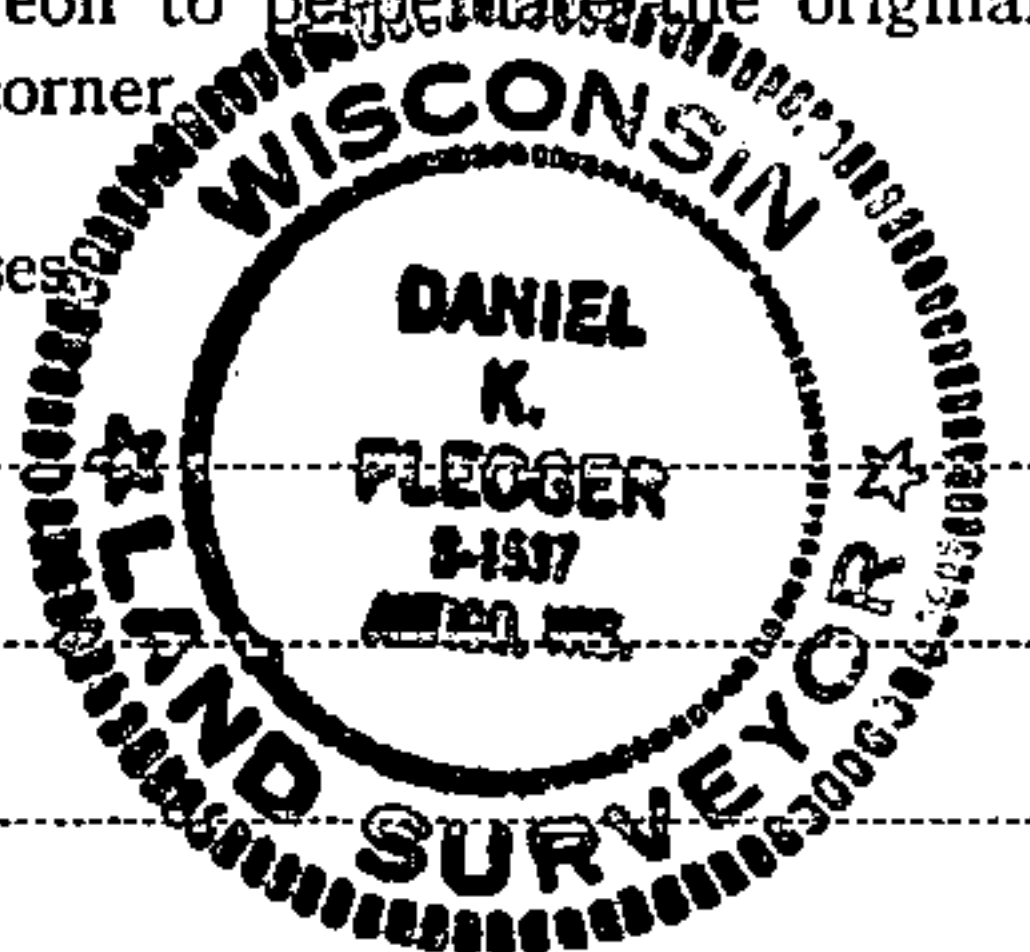

FORM 985 R. C. MILLER CO., MILWAUKEE

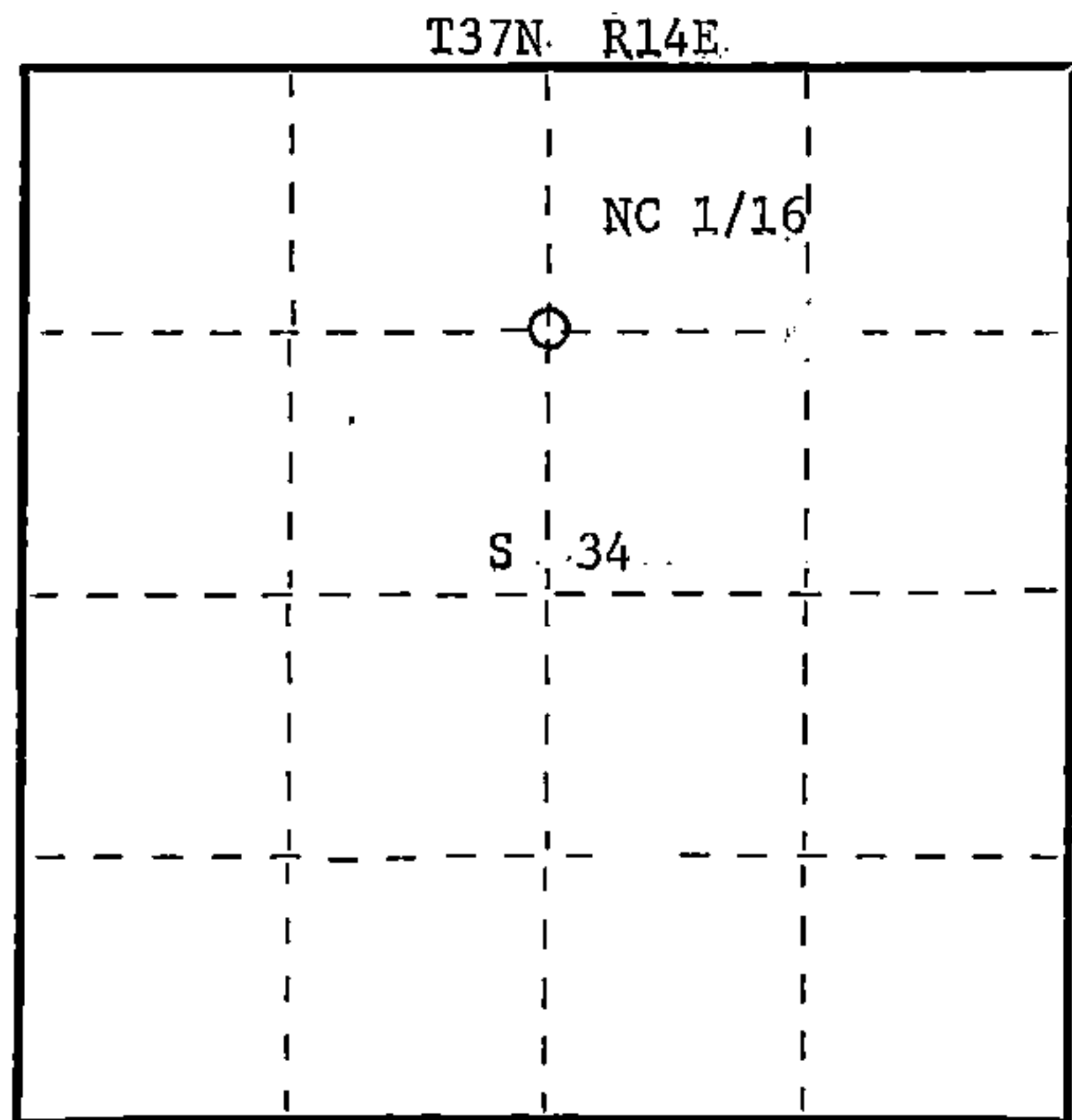

○ = Corner monument restored.

History of original corner establishment:

Corner established in 1921 by J.R. Ritter, Registered Land Surveyor. Old 5" squared cedar post bears east .07 feet of our position.

Description of corner evidence found:

Total distance from 1/4 corner between sections 27 and 34 to C 1/4 corner section 34 is 2705.90 feet at bearing S2-14-21W.
Set NC 1/16 1352.95 intermediate.

Description of monument and accessories I established to perpetuate the original location of this corner.

Set a 1-1/2" iron pipe with 2" diameter brass cap stamped:
Projecting 24" above ground.
Marked NBT's:

Black Spruce 5" S64°W 11.77 feet - scribed 1/16 BT.
B.O.: Right-Of-Way post N1°E 18.06 feet

S1537
T37N R14E
NC 1/16 S 34
CPI 1981

Dated at Rhineland, Wis., this 24th day of June, 1981

Signature Daniel K. Plegger Title Registered Land Surveyor Registration No. 1537
(County Surveyor, Registered Land Surveyor, or other duly authorized official)

Office of Register of Deeds, County of Forest, I hereby certify that the within instrument was filed in this office for record on the 1st day of July, 1981 at 8:30 o'clock A. M.

Regina Stutzman
(Register of Deeds)
By _____ Deputy

DOCUMENT NO.
120040

43714343020