

CERTIFIED LAND CORNER RESTORATION

Index No. 23

State of Wisconsin }
County of Forest } ss.

I Philip T. Hansen, do hereby certify that on the 15th day of December, 1975, I found evidence of the Quarter corner of Sections 6 and 31 Township 37 and 36, North, Range 14 East, Fourth Principal Meridian, as described hereon; and that from this evidence I established a new monument and accessories as described hereon to perpetuate the original location of this corner.

Resident witnesses:

Glen Barker

Jim Claflin

Tom Jewell

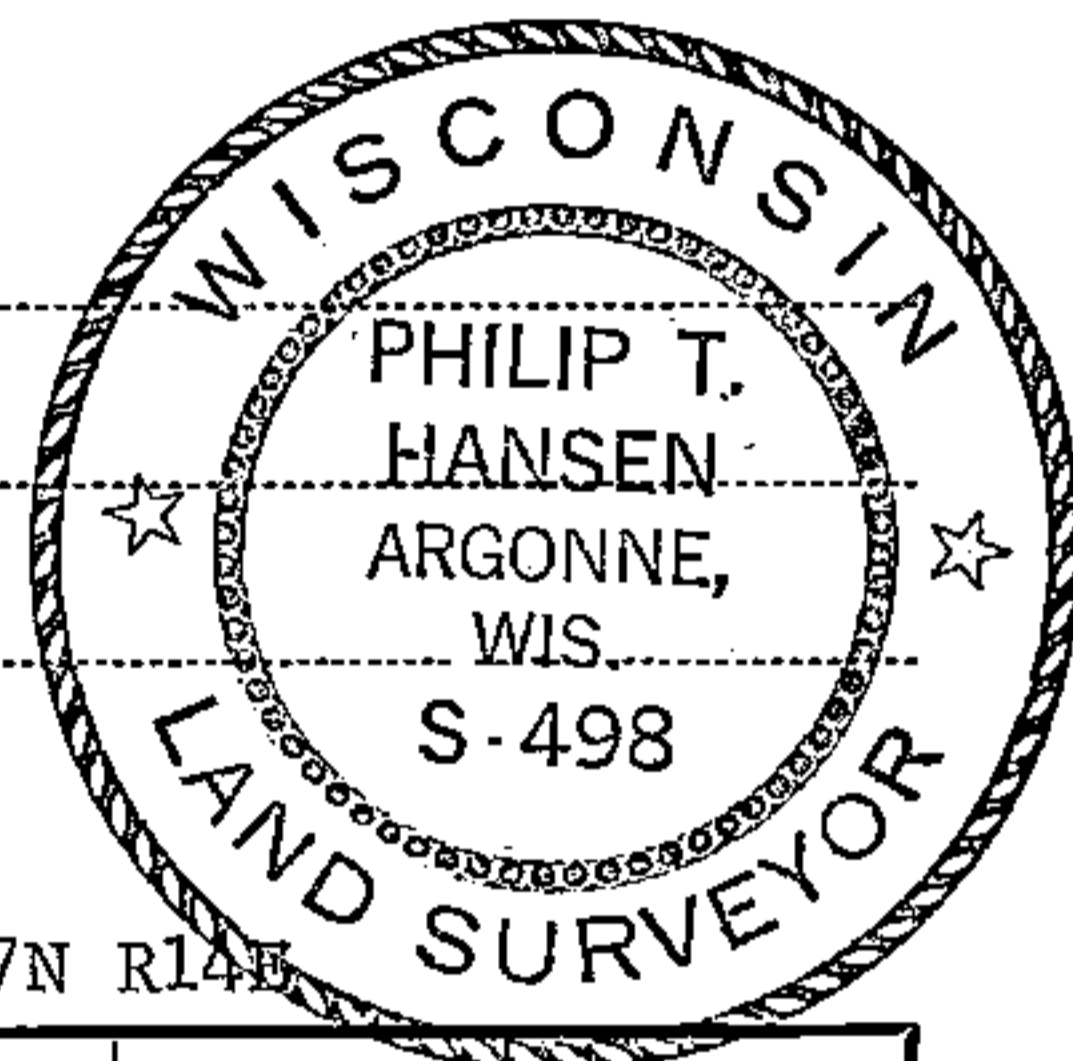

T37N R14E

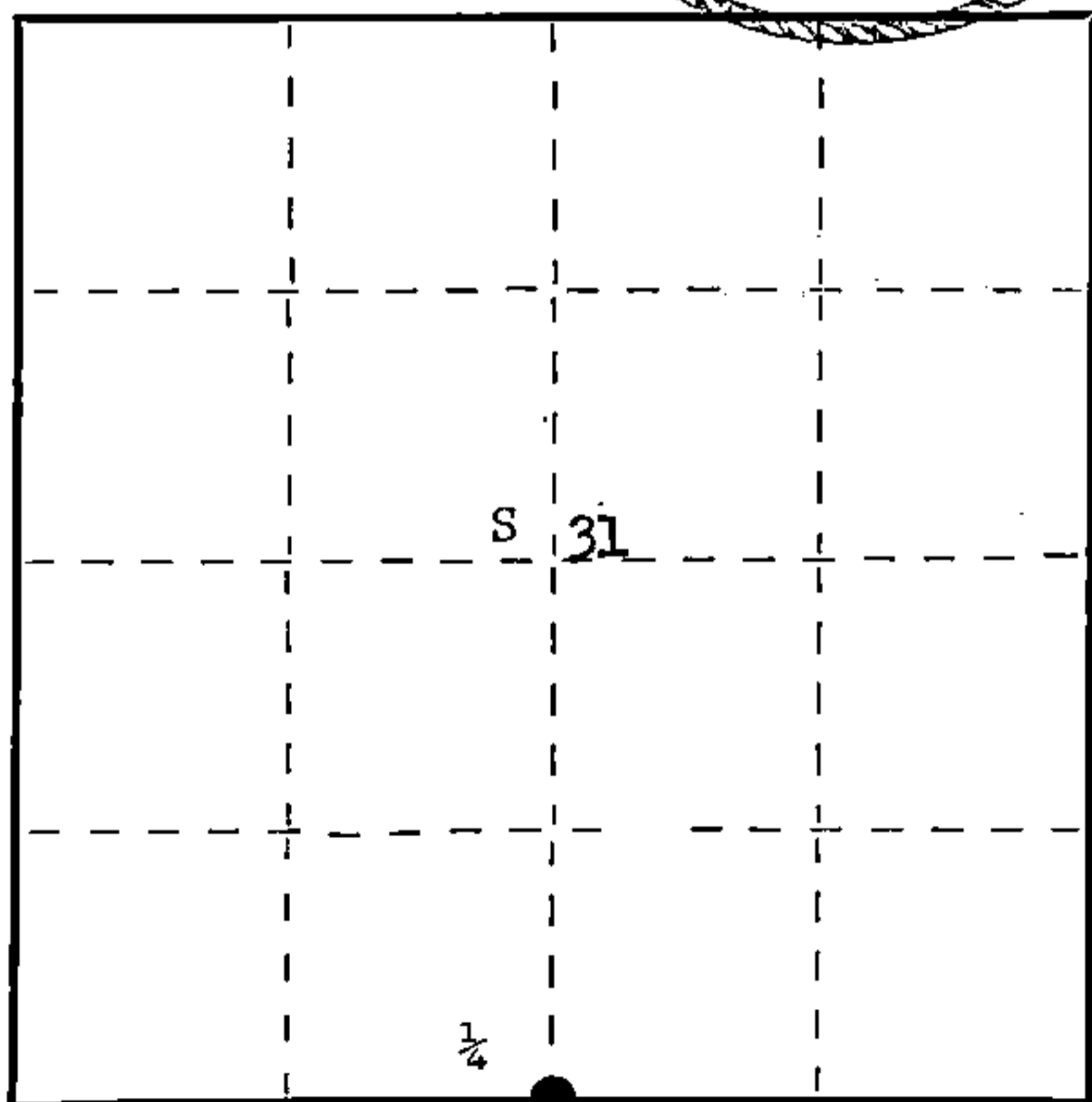

○ = Corner monument restored.

History of original corner establishment: Original corner established by A. Millard, Deputy Surveyor, in 1859, from which hemlock 10" bears N45°W 6 links, and maple 10" bears S25°E 16 links.

Corner recovered by Ray Leigh, Consolidated Forester, about 1945. Set new 4" scribed cedar post in place of old corner. Scribed 8" cedar S11°E 26 links.

Description of corner evidence found: Recovered 4" cedar post, squared and scribed 1/4 S S6, 1/4 S S31, in poor condition.

Recovered OBT - cedar 8" S11°E 26.1 links, scribed 1/4 S.

Description of monument and accessories I established to perpetuate the original location of this corner.

Replaced 4" cedar post with 2 1/2" Berntsen A-1 Federal Monument, aluminum, with magnet installed in cap and base. Pipe projects 18" above ground. Cap stamped -

NBT's - B. ash 6" S48°W 87.8 links, scribed 1/4 BT.
Maple 8" S74°E 47 links, scribed 1/4 BT.

Pipe and BT's painted blue.

S498-
T37N R14E
1/4 S 31
S 6
T36N R14E
1975

Dated at Argonne, Wis., this 22nd day of December, 1975

Signature *Philip T. Hansen* Title Registered Land Surveyor Registration No. S-498
(County Surveyor, Registered Land Surveyor, or other duly authorized official)

Office of Register of Deeds, County of Forest, I hereby certify that the within instrument was filed in this office for record on the 5th day of January, 1976 at 2:45 o'clock P. M.

EUGENE STATEZNY

(Register of Deeds)

DOCUMENT NUMBER -- 108502

By *Eileen Schmidt* Deputy

FORM 985 H. C. MILLER CO., MILWAUKEE

43714310020

U. S. PUBLIC LAND SURVEY MONUMENT RECORD

INSTRUCTIONS: This record shall show the location of the corner and shall include all of the following nine elements (a through i).

- (a) Identify the corner by reference to the U.S. public land survey system.
- = Corner monument restored.

1/4 corner common to Sections 6 & 31, T36-37N, R14E, 4th P.M., Forest County, WI.

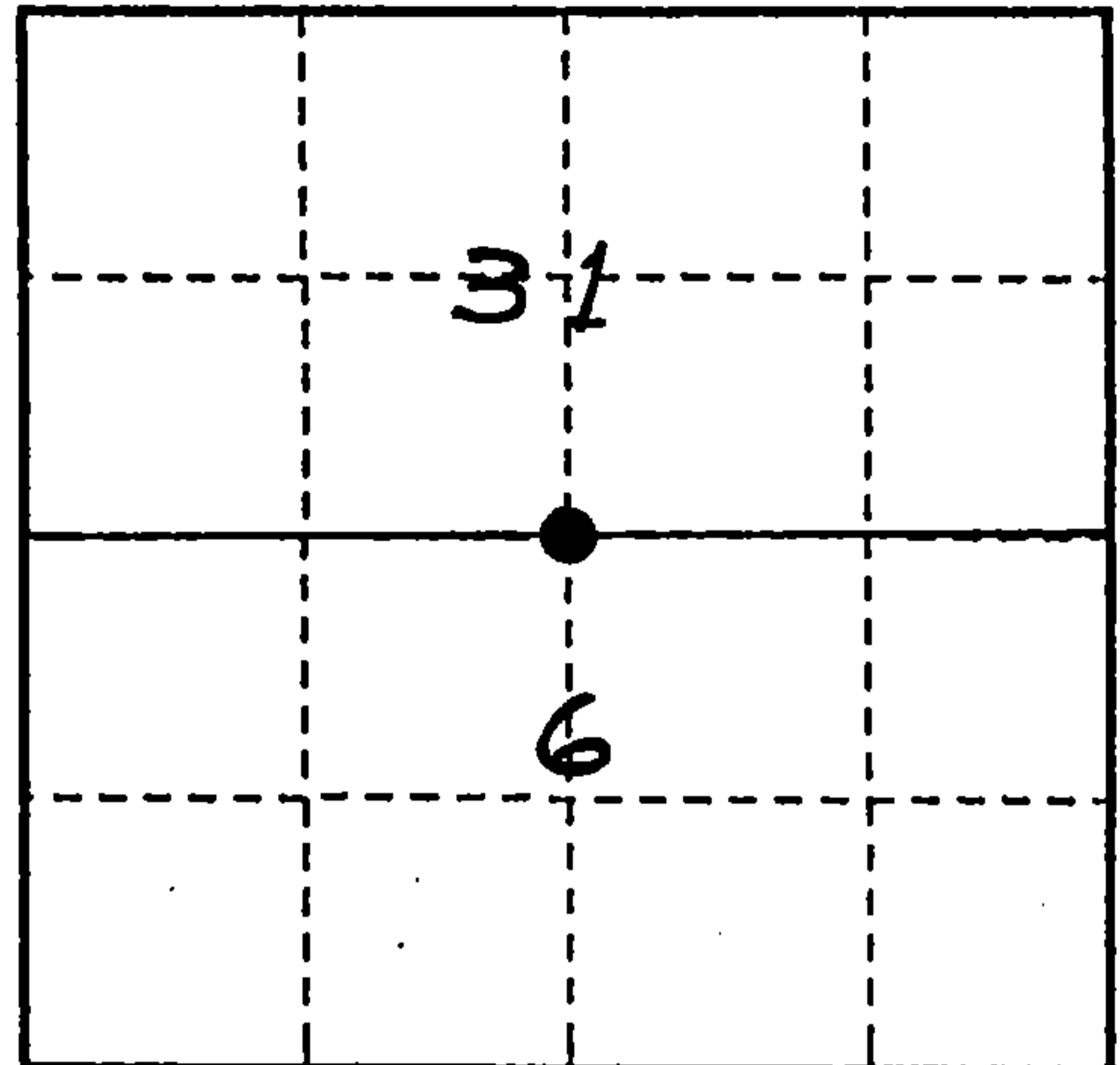

- (b) Describe any record evidence, monument evidence, occupational evidence, testimonial evidence or any other material evidence you considered, and whether the monument was found or placed.

Original survey by A. Millard, Deputy Surveyor, in 1859.

Original Bearing Trees:

Hemlock 10", N45°W - 6 links Maple 10", S25°E - 16 links

1930- Corner post set by E.B. Hurst, Consolidated Forester, and P. Hansen.

1945- Corner restored by Ray Leigh, Consolidated Forester.

1976- The corner was monumented by Philip Hansen, S-498, and recorded on document No. 108502, January 5, 1976. He found a 3" squared cedar post and replaced it with an aluminum monument.

1993- I found the 2 1/2" Bernstein monument noted in Hansen Certificate and upgraded the accessories as noted below.

- (c) In the plan view drawing below, provide reference ties to at least 4 witness monuments, or, if the location is within a municipality, to at least 2 witness monuments. (witness monuments shall be made of concrete, natural stone, iron or other equally durable material.)

- (d) Show a plan view drawing depicting the relevant monuments and reference ties which is sufficient in detail to enable accurate relocation of the corner monument if the corner monument is disturbed. Indicate north.

REGISTER'S OFFICE
 Forest County, Wis.
 Received for record this 2nd day
 of June, A.D. 1993 at
12 o'clock P.M. and recorded
 in Vol. Consolidated Restorations
 page A-3
Paul Cl. He, Deputy
 Register of Deeds

Found monument as noted above.

- 1- 7" B. Ash-N28°W-14.34 feet
- 2- 14" Maple-S72°E-31.27 feet
- 3- Steel sign post-Southeast-2.32 feet
- 4- 9" Cedar-S10°E-17.63 feet
- 5- 8" B. Ash-S49°W-58.24 feet

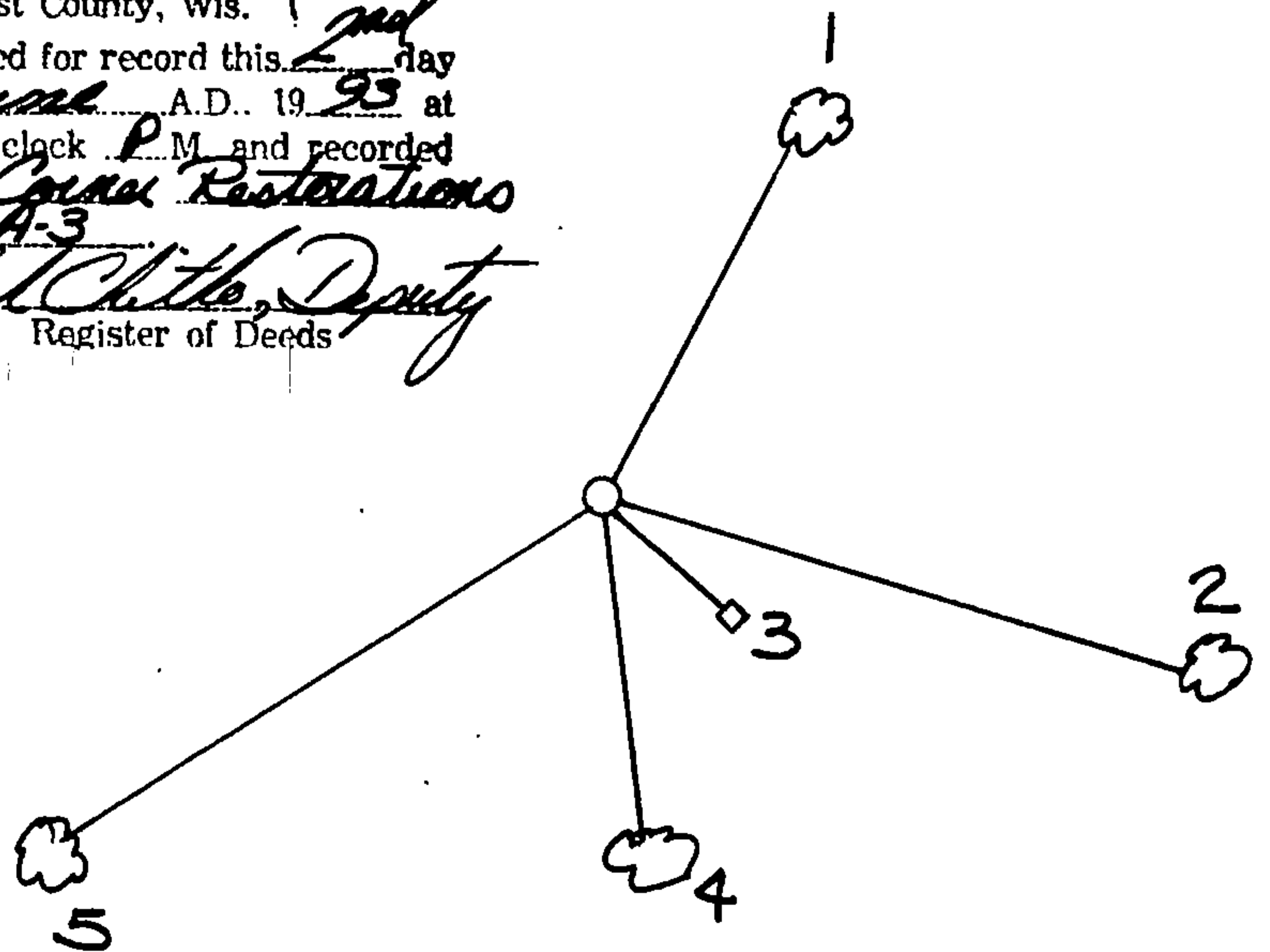

4371431 0020

(d) Describe any material discrepancy between the location of the corner as restored or reestablished and the location of that corner as previously restored or reestablished by distance and direction. Show the discrepancy on the plan view drawing under (d), above. Show the distances between the corner as previously restored or reestablished and (1) the corner as restored or reestablished, and (2) to at least 2 of the witness monuments shown on the drawing in (d), above.

None

(f) Was the corner restored through acceptance of (1) an obliterated evidence location, or, (2) a found perpetuated location?

(2) A found perpetuated location.

(g & h) Was the corner reestablished through lost corner proportionate methods? If so, show the method, including the directions and distances to other public land survey corners used as evidence or used for proportioning in determining the corner location?

No.

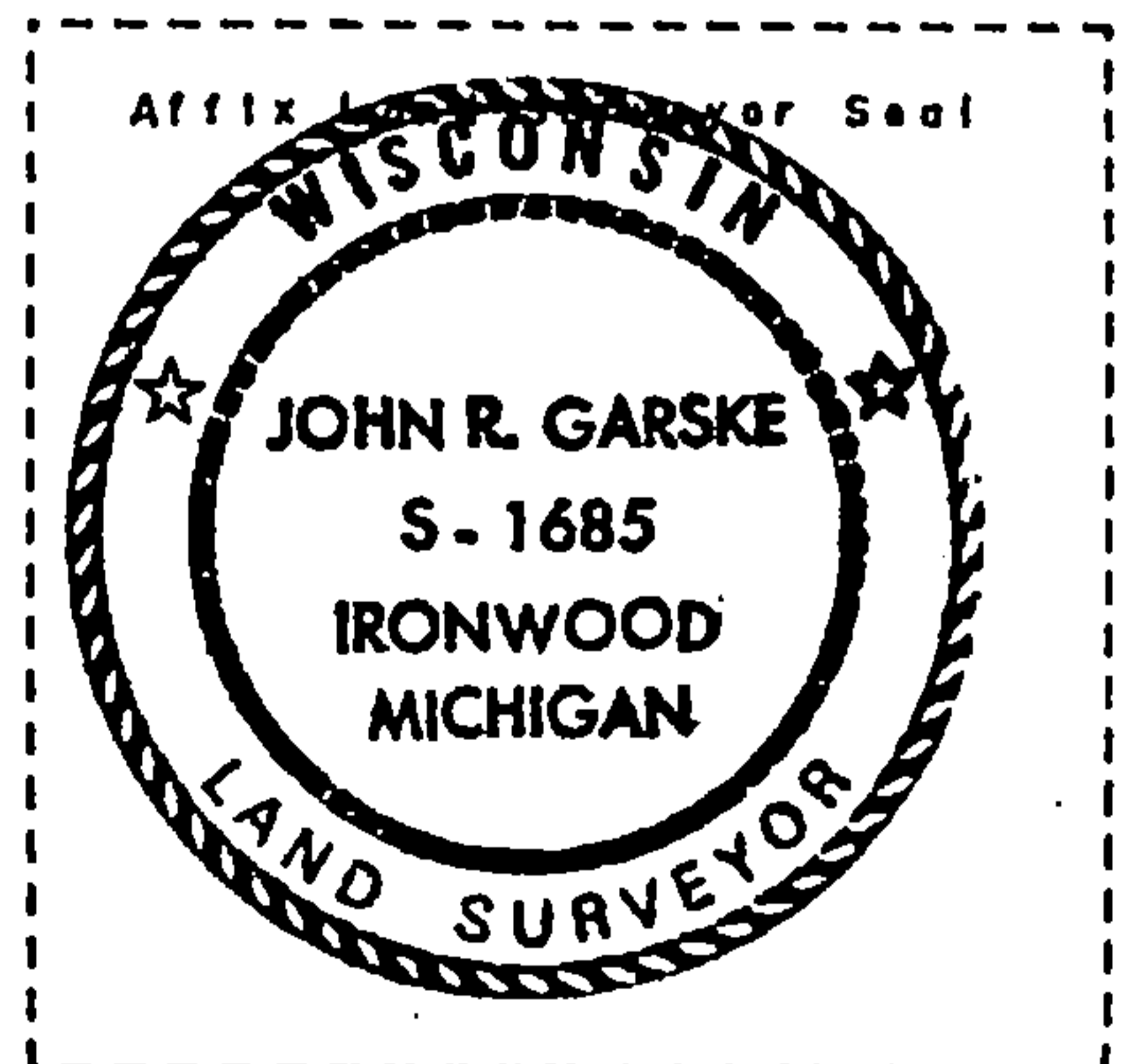

(1) I, John R. Garske, S-1685

(type or print name) certify that the corner location shown on this record was determined by me or under my direction and control and that this U.S. Public Land Survey Monument Record is correct and complete to the best of my knowledge and belief.

John R. Garske
Signature

3/19/93
Date

CERTIFICATE READY FOR FILING:

Sue Vogt
District Ranger