

CERTIFIED LAND CORNER RESTORATION

Index No. 5-23

S23

State of Wisconsin }
County of Forest } ss.

I Daniel K. Pleoger, do hereby certify that on the 13th day of April, 19 81, I ~~found~~ established ~~the~~ NE 1/16 corner of Section 25 Township 37 North, Range 14 East, Fourth Principal Meridian, as described hereon; and that from this evidence I established a new monument and accessories as described hereon to perpetuate the original location of this corner.

History of original corner establishment:

No evidence of any previous corner.

Description of corner evidence found:

Total distance from 1/4 corner between sections 24 and 25 to C 1/4 corner section 25 is 2586.684 feet at bearing S0-19-00E. Set NC 1/16 1293.342 feet intermediate.

Resident witnesses:

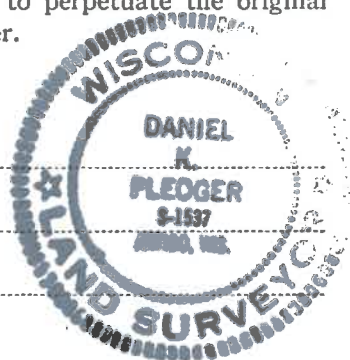

Description of monument and accessories I established to perpetuate the original location of this corner.

Set a 1-1/2" iron pipe with 2" diameter brass cap stamped: Monument projects 18" above ground.

Marked NBT's:

Twin Maple 7" N78°W 4.47 feet
Bl. Spruce 7" N87°E 31.34 feet
scribed 1/16 - B.T.

S1537
T37N R14E
NC 1/16 S 25
CPI-1981

FORM 985 H. C. MILLER CO., MILWAUKEE

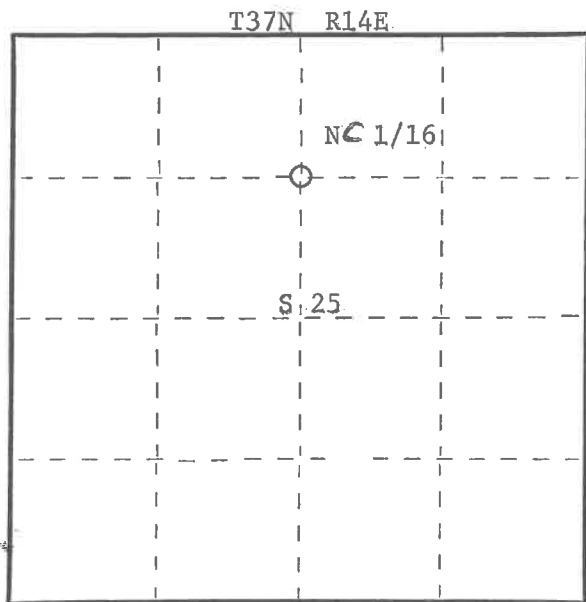

○ = Corner monument restored.

Dated at Rhinelander, Wis., this 24th day of June, 19 81

Signature Daniel K. Pleoger Title Registered Land Surveyor Registration No. 1537
(County Surveyor, Registered Land Surveyor, or other duly authorized official)

Office of Register of Deeds, County of Forest, I hereby certify that the within instrument was filed in this office for record on the 1st day of July, 19 81 at 8:30 o'clock A. M.

Eugene Stutzman
(Register of Deeds)
By Deputy

DOCUMENT NO. 120036

43714 25308D