

CERTIFIED LAND CORNER RESTORATION

Index No. W-9

State of Wisconsin }  
County of Forest } ss.

I, Philip T. Hansen, do hereby certify that on the 30th day of November, 1977, I ~~found~~ established ~~evidence~~ of the N 1/16 corner of Section 32 - 33 Township 37, North, Range 13 East, Fourth Principal Meridian, as described hereon; and that from this evidence I established a new monument and accessories as described hereon to perpetuate the original location of this corner.

Resident witnesses:

Glen Barker

Jim Claflin

Herb Wagoner

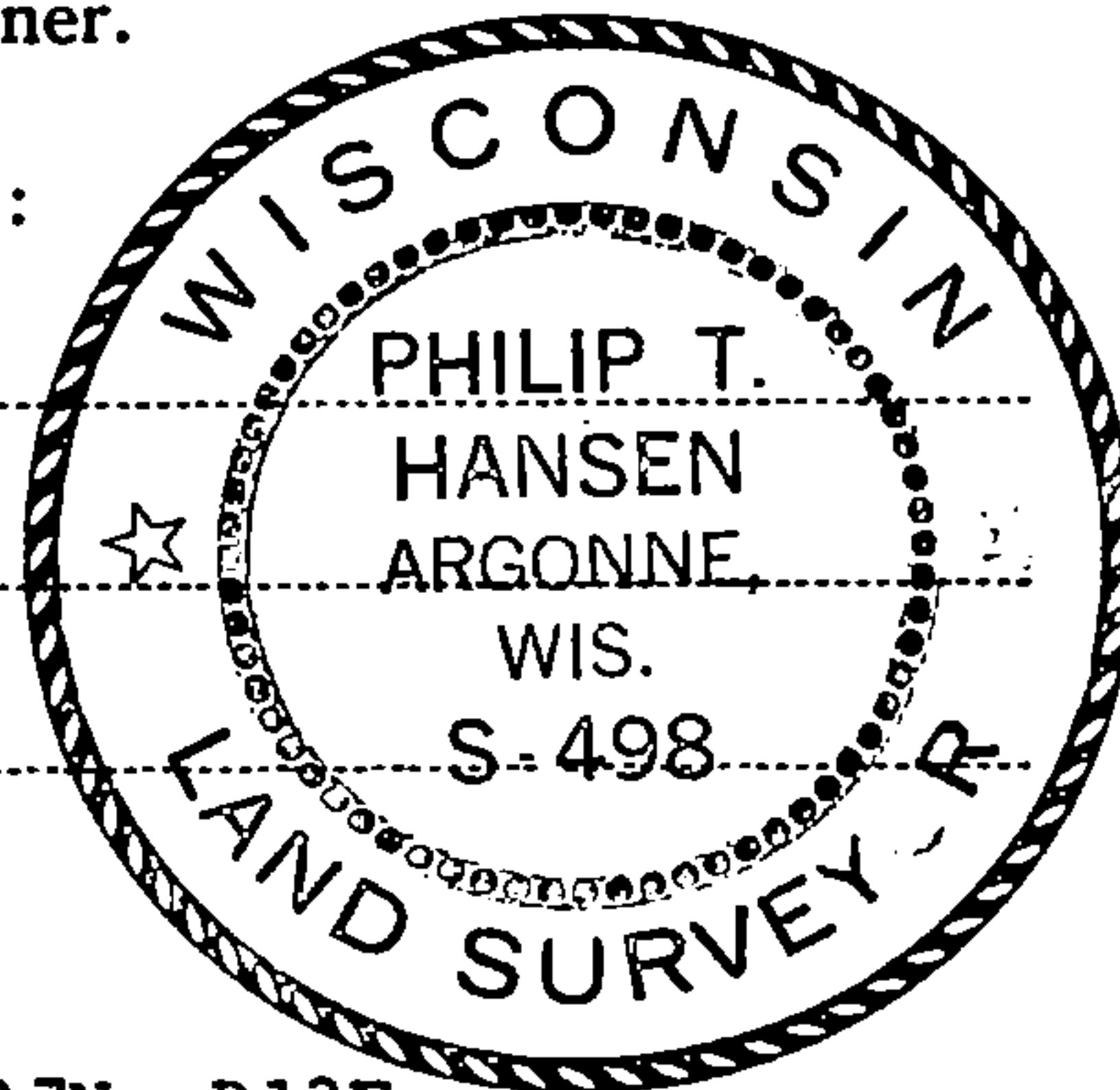

FORM 985 H. C. MILLER CO., MILWAUKEE

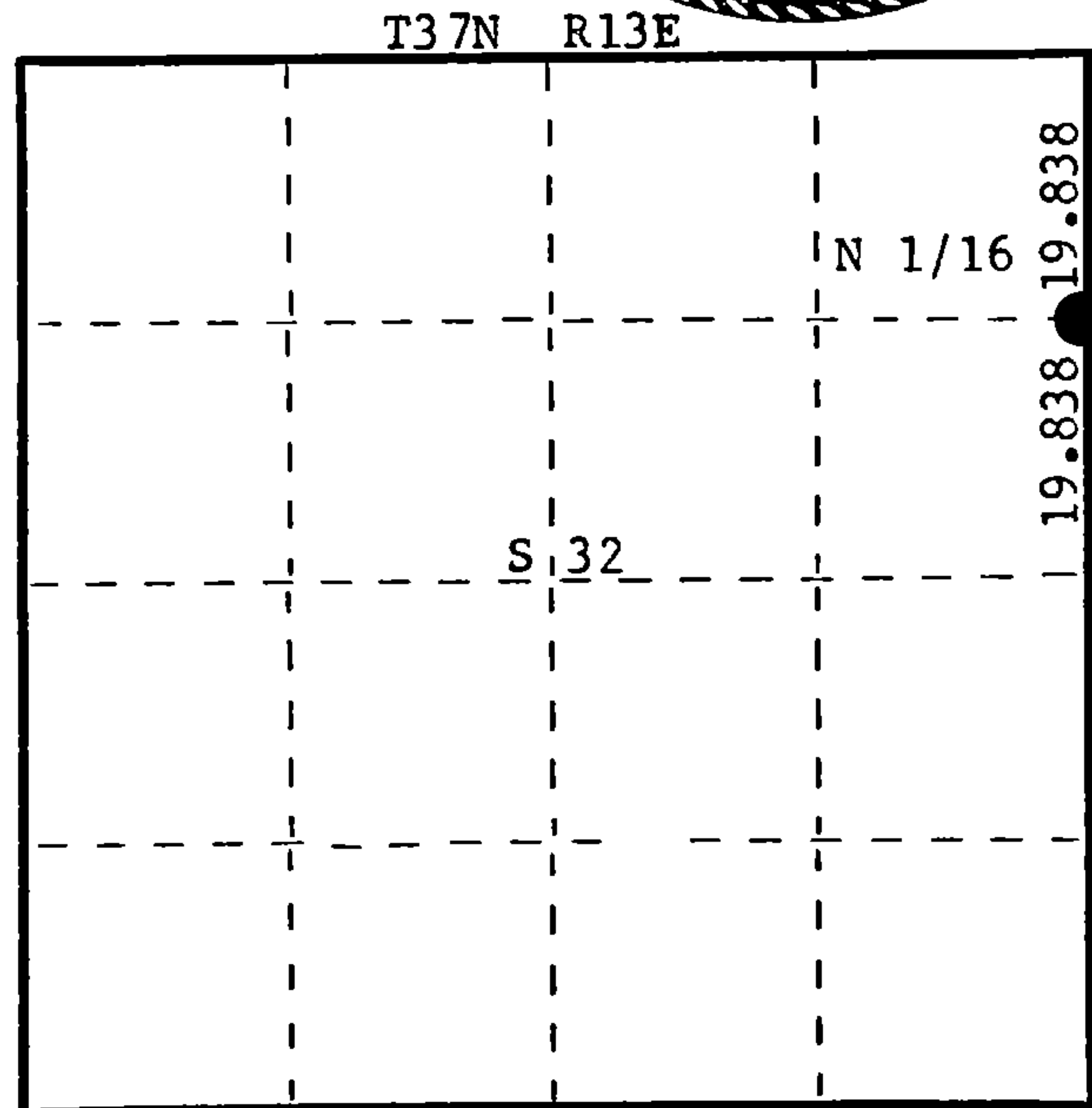

○ = Corner monument restored.

History of original corner establishment:

No record of any previous survey.

Description of corner evidence found:

No evidence of any corner recovered.

Corner established by proportion from computed distance. Ran traverse from previously established 1/4 corner and section corner 28, 29, 32, 33. Computed distance 2618.631 ft. (39.6762 chains), bearing N 0° 27' 23" W. Established N 1/16 at 19.838 chains intermediate. Corner fell 18" east of centerline of Highway 32 & 55 and in line with old fence line running west.

Description of monument and accessories I established to perpetuate the original location of this corner.

Set a PK in blacktop for true corner.

Set a 1 1/2" iron pipe with 2" brass cap, S80°W, 60 links for witness corner.

Monument projects 18" above ground. Cap stamped:

Marked B.O. to true corner.

Power Pole S22°W 127 links

Power Pole 3713-32 - E5 N10°W 265.9 links

S498  
T37N R13E  
N 1/16 32 33 W.C.  
N80°E - 60 links  
CPI-1977

Dated at Rhineland, Wis., this 3rd day of December, 1977

Signature Philip T. Hansen Title Registered Land Surveyor Registration No. S-498  
(County Surveyor, Registered Land Surveyor, or other duly authorized official)

Office of Register of Deeds, County of Forest, I hereby certify that the within instrument was filed in this office for record on the 14th day of December, 1977 at 3:00 o'clock P. M.

Eugene Stetson  
(Register of Deeds)

DOCUMENT NUMBER - **112972**

By \_\_\_\_\_ Deputy

43713323000