

## CERTIFIED LAND CORNER RESTORATION

State of Wisconsin

County of Forest

SS.

I, Jean F. Resvick, do hereby certify that on the 5 day of June, 19 75,  
I found evidence of the South quarter corner of Sections 14  
Township 37 North, Range 13 East, Fourth Principal Meridian, as described  
hereon; and that from this evidence I established a new monument and accessories as described hereon to per-  
petuate the original location of this corner:

## Description of original monument and accessories and subsequent restorations:

Surveyed in 1865 by J. L. Nowlin  
40.16 ch West corrected between Sec. 14 and 23  
Set post  
Spruce 8, N4E, 8 lks  
Spruce 10, S6W, 10 lks  
J. R. Ritter, July 1921  
Found original evidence and replaced post  
Fir 5, N---, 3 lks  
Cedar 10, ---E, 5½ lks  
Description of corner evidence found:  
Iron pipe on north side of scribe cedar post  
Balsam 10" snag, N74W, 1.98 ft.  
Fallen cedar, N85E, 3.63 ft.

## Description of monument and accessories I established to perpetuate the location of this corner:

Replace post and pipe with 2 inch inside diam. galvanized iron pipe, 5 feet long,  
filled with concrete, with brass cap stamped T37N, R13E, S14, ¼, S23, 1975, S-802

## Blazed and scribed the following new bearing trees:

Cedar 13, N66E, 13.88 ft.  
Cedar 10, S6W, 31.59 ft.

Set steel sign post 0.5 ft. north of monument

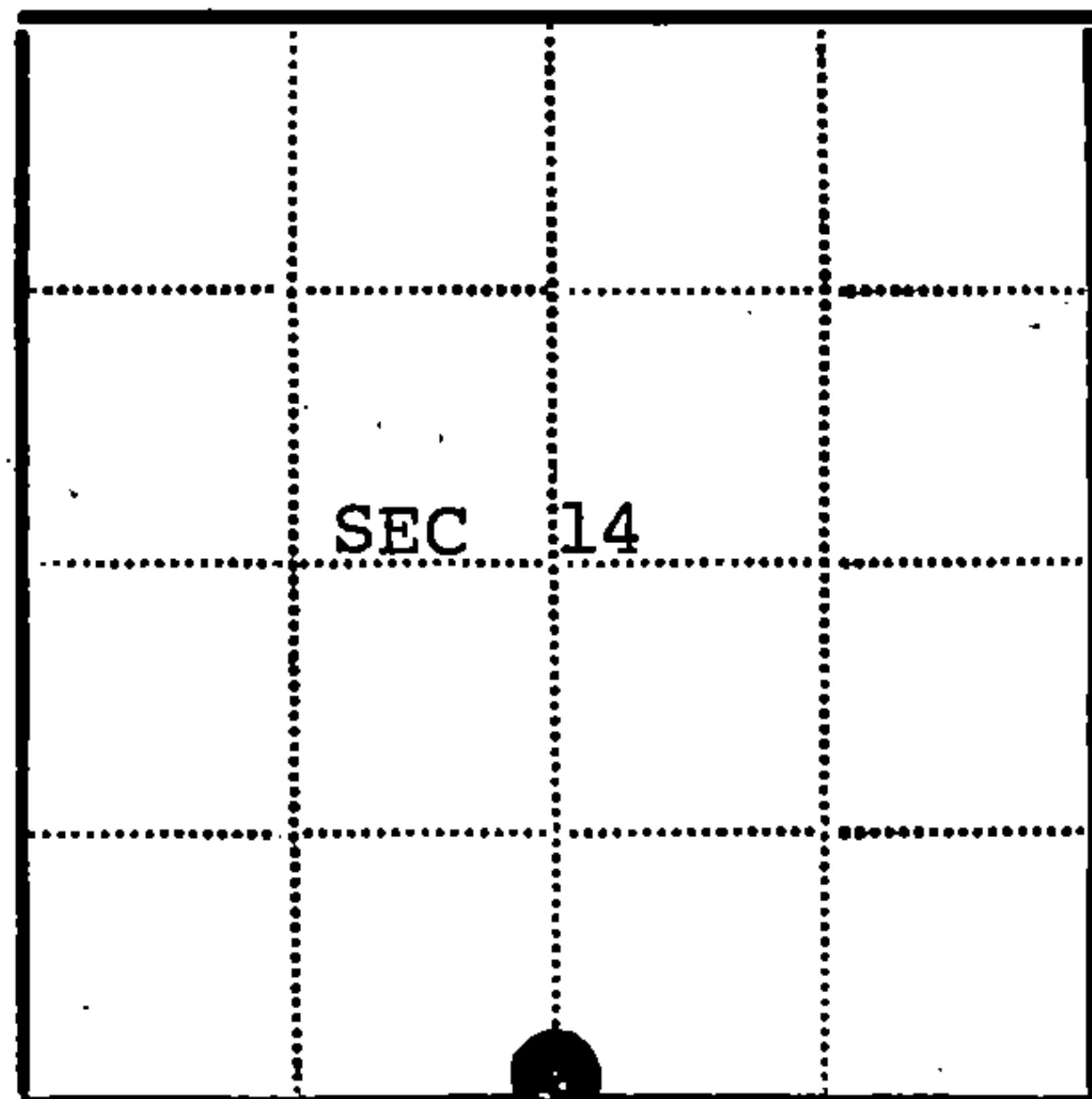
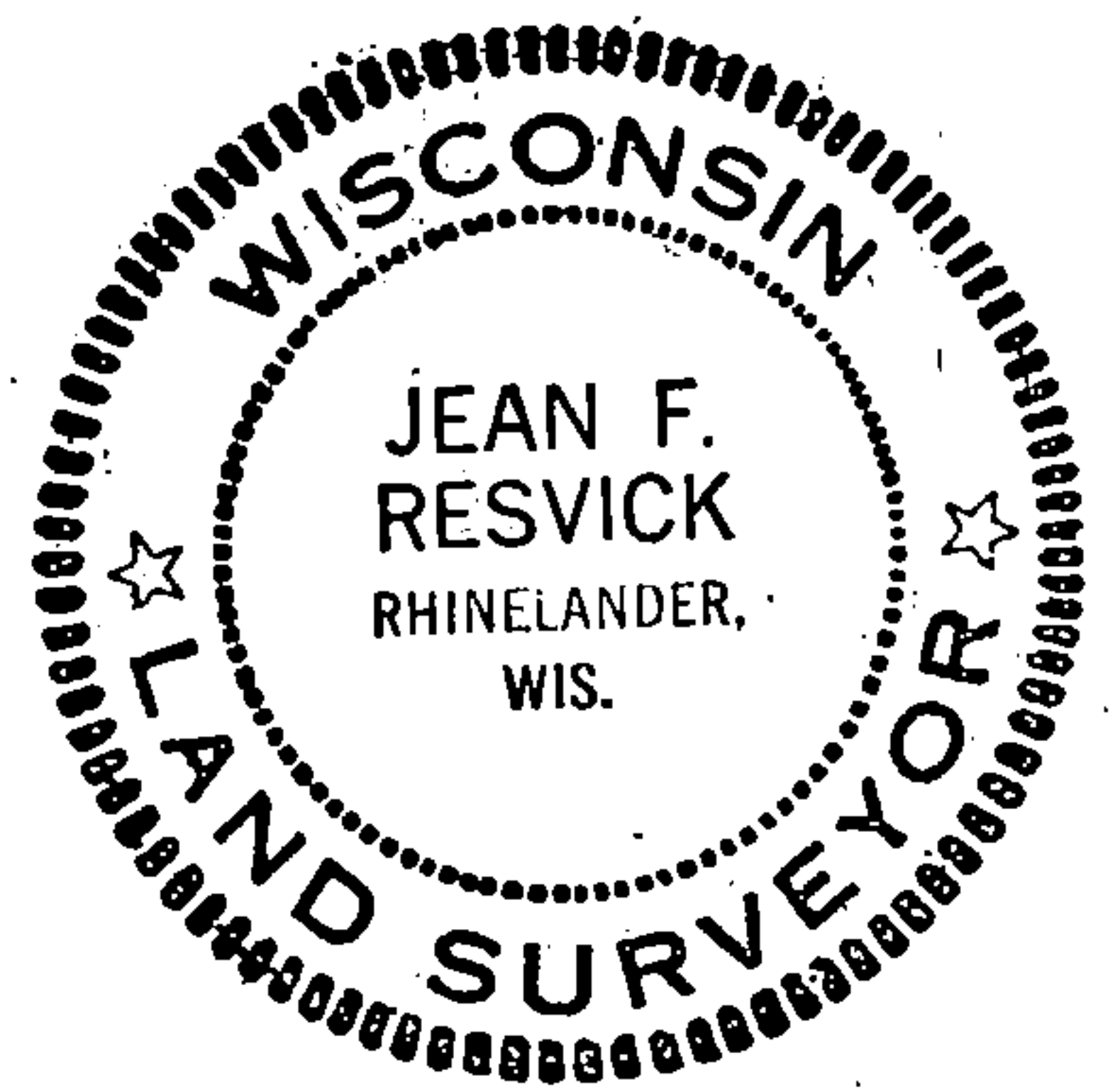

● - Corner monument restored

□ -

Resident witnesses

Dated at Rhinelanders Wisconsin, this 9 day of July,  
19 75.

Signature Jean F. Resvick Title Land Surveyor  
(County Surveyor, Registered Land Surveyor, or other duly authorized official)

Surveyors Registration No. S-802DOCUMENT  
NUMBER **107391**Office of Register of Deeds County of Forest

I hereby certify that the within instrument was filed in this office for record  
on the 11th day of July, 19 75, and was filed in Book  
No. \_\_\_\_\_ Page No. \_\_\_\_\_ of County Records.

Signature Eugene Stutzman Title Register of Deeds

Township 37 North, Range 13 East, Section 14, Index No. N-19, Page No. \_\_\_\_\_

43713140020

N19

State of Wisconsin }  
County of Forest } ss.

I, Gary L. Pisoni, do hereby  
certify that on the 15th day  
of August, 1990, I found  
evidence of the South Quarter  
corner of Section 14  
Township 37, North, Range  
13 East, Fourth Principal Meridian,  
as described hereon; and that from this evidence  
I established a new monument and accessories  
as described hereon to perpetuate the original  
location of this corner.

Resident witnesses:

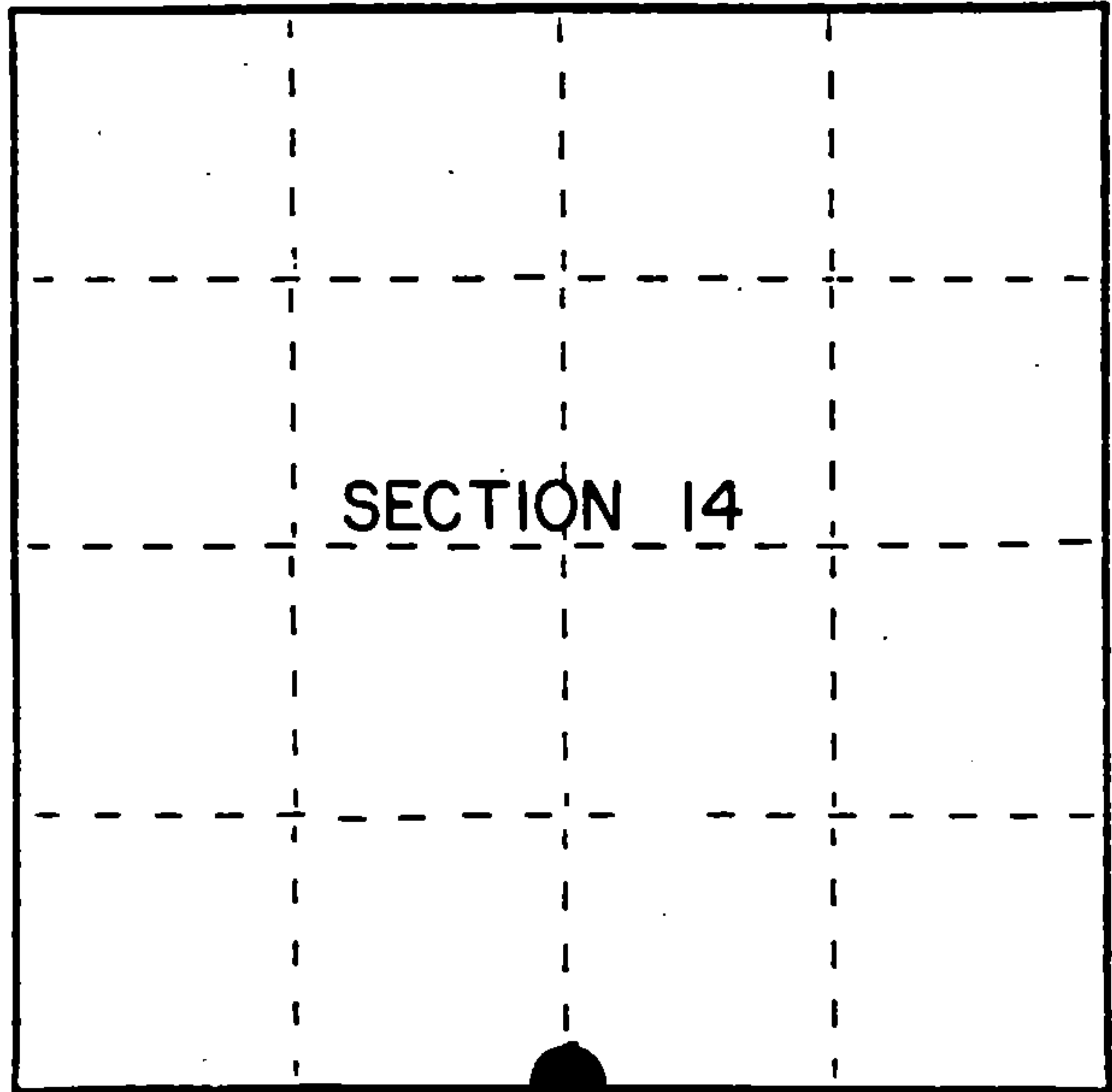

● = Corner monument restored.

History of original corner establishment:  
Original Government Survey in 1865 by J.L. Nowlin.  
In 1921 J.R. Ritter set an iron pipe.  
In 1975, Jean Resvick, RLS with the U.S. Forest Service, found an iron pipe alongside  
a scribed cedar post, and original bearing tree evidence. In place of post and pipe, set  
a 2 inch diameter galvanized iron pipe, 5 feet long, with a brass cap marked; T37N,  
R13E, 1/4, S14, S23, 1975, S-802. From which the following bear;

Cedar	13"	N66°E	13.88 feet
Cedar	10"	S06°W	31.59 feet
Steel Sign Post		North	0.50 feet

Description of corner evidence found:

Found monument as described and in place, from which the following bear;

Cedar	16"	N66°E	13.88 feet
Cedar	15"	S06°W	31.59 feet
Steel Sign Post		North	0.50 feet

Description of monument and accessories I established to perpetuate the original location of this corner.  
Blazed and scribed the following new bearing trees; (measurements taken to a nail in  
side of tree)

Cedar	12"	N75°W	8.71 feet
Cedar	11"	S33°E	38.24 feet

Dated at Iron River, MI, this 13th day of December, 1990

Signature Gary L. Pisoni Title Land Surveyor Registration No S-1634  
(County Surveyor, Registered Land Surveyor, or other duly authorized official)

Office of Register of Deeds, County of Forest, I hereby certify that the within  
instrument was filed in this office for record on the 15th day of March, 1993  
at 10:45 o'clock P M.

Paul Aschenbrenner  
(Register of Deeds)

By \_\_\_\_\_ Deputy



- e) Describe any material discrepancy between the location of the corner as restored or reestablished and the location of that corner as previously restored or reestablished by distance and direction. Show the discrepancy on the plan view drawing under (d), above. Show the distances between the corner as previously restored or reestablished and (1) the corner as restored or reestablished, and (2) to at least 2 of the witness monuments shown on the drawing in (d), above.

See drawing below.

- (f) Was the corner restored through acceptance of (1) an obliterated evidence location, or, (2) a found perpetuated location?

Restored through acceptance of a found perpetuated location.

- (g&h) Was the corner reestablished through lost corner proportionate methods? If so, show the method, including the directions and distances to other public land survey corners used as evidence or used for proportioning in determining the corner location?

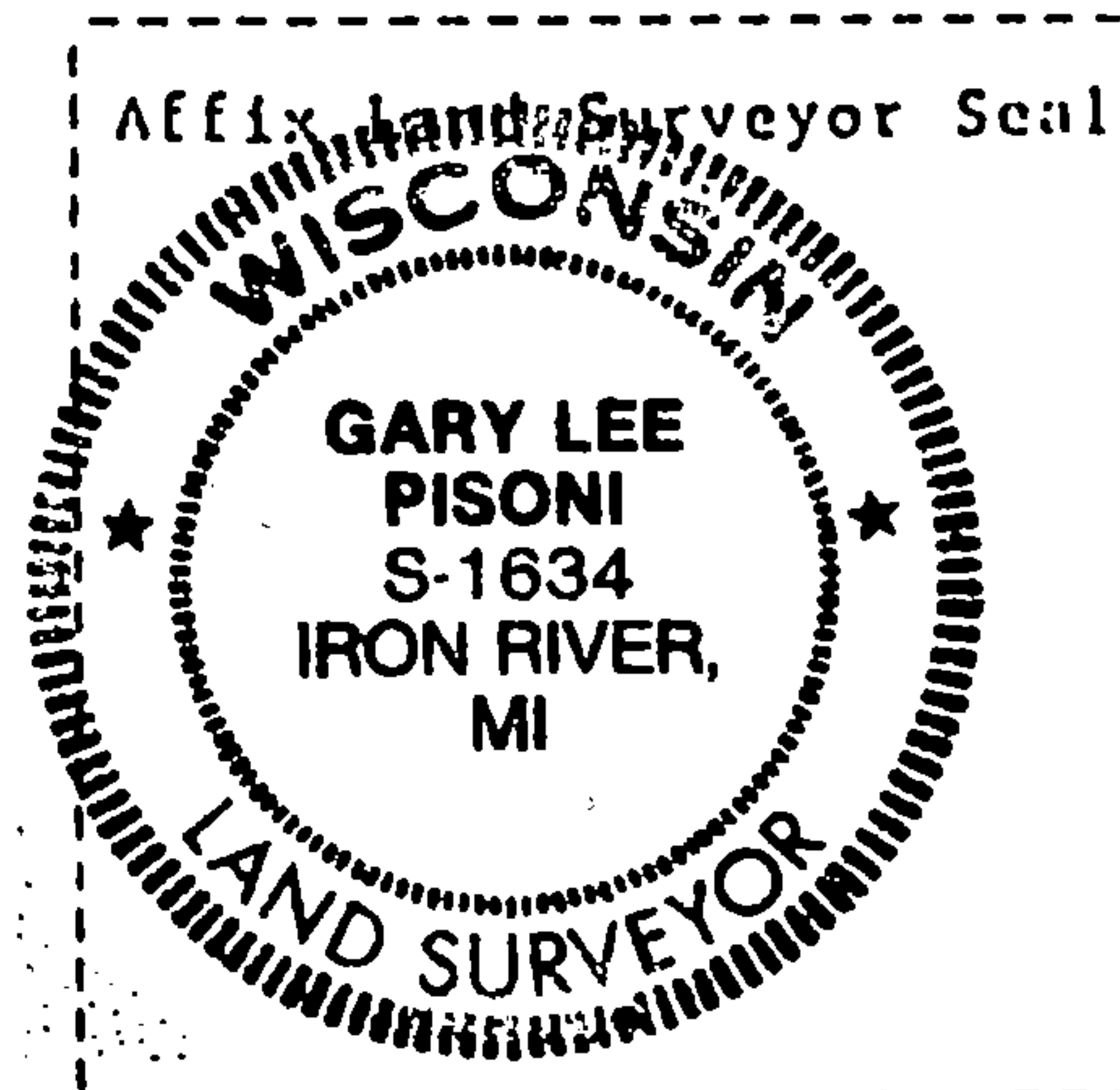
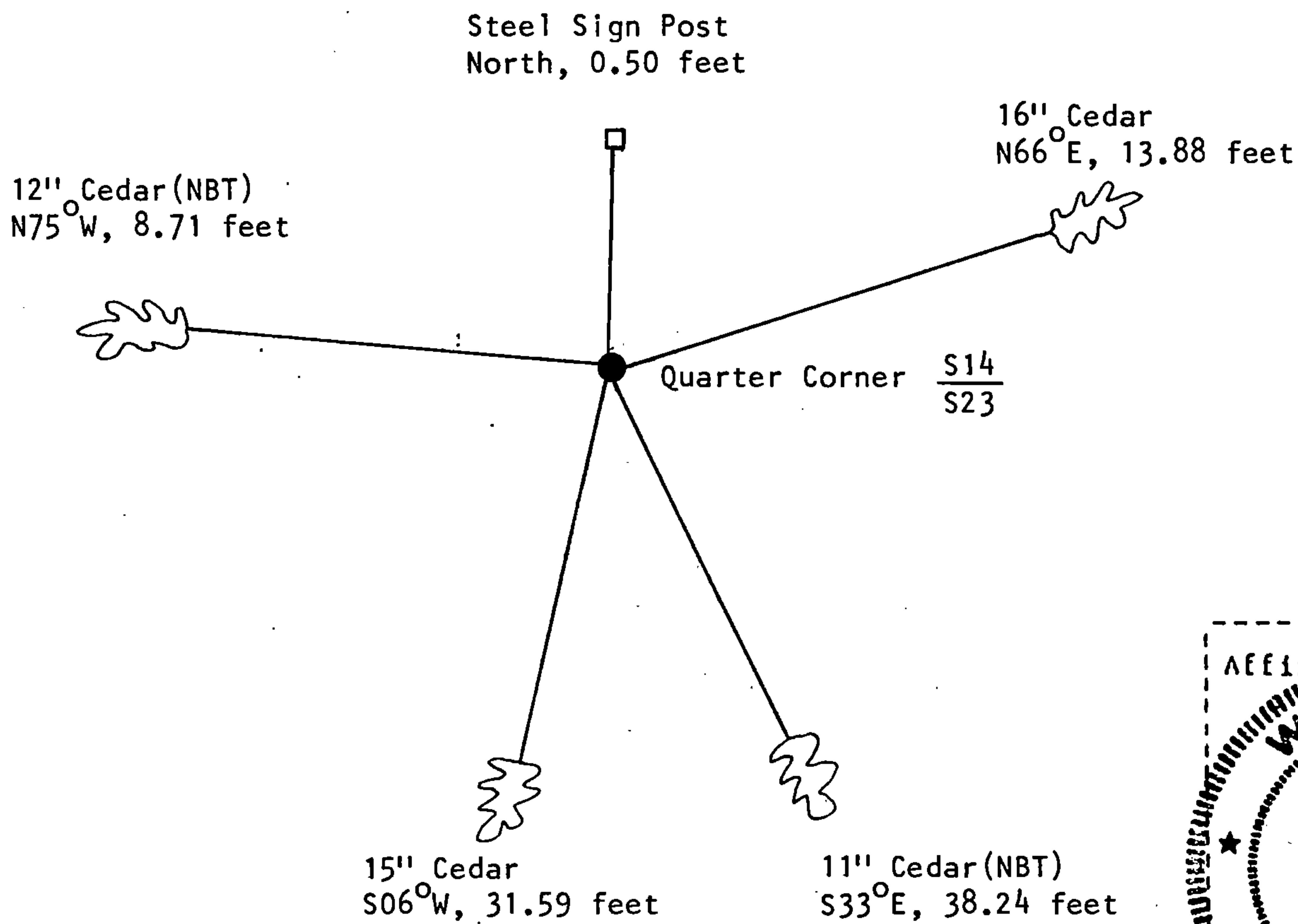

- (i) I, Gary L. Pisoni  
(type or print name) certify that the corner location shown on this record was determined by me or under my direction and control and that this U.S. Public Land Survey Monument Record is correct and complete to the best of my knowledge and belief.

Gary L. Pisoni August 14 1991  
Signature Date

Survey requested by: Darrell E. Richards 10/30/91  
Acting District Ranger Date