

U.S. PUBLIC LAND SURVEY MONUMENT RECORD

Index No. R-9

State of Wisconsin }  
County of FOREST } ss.

I John C. Schulke, do hereby certify that on the 1st day of June, 1986, I found evidence of the Southeast corner of Section 20 Township 37 North, Range 12 East, Fourth Principal Meridian, as described hereon; and that from this evidence I established a new monument and accessories as described hereon to perpetuate the original location of this corner.

Resident witnesses:  
\_\_\_\_\_  
\_\_\_\_\_  
\_\_\_\_\_

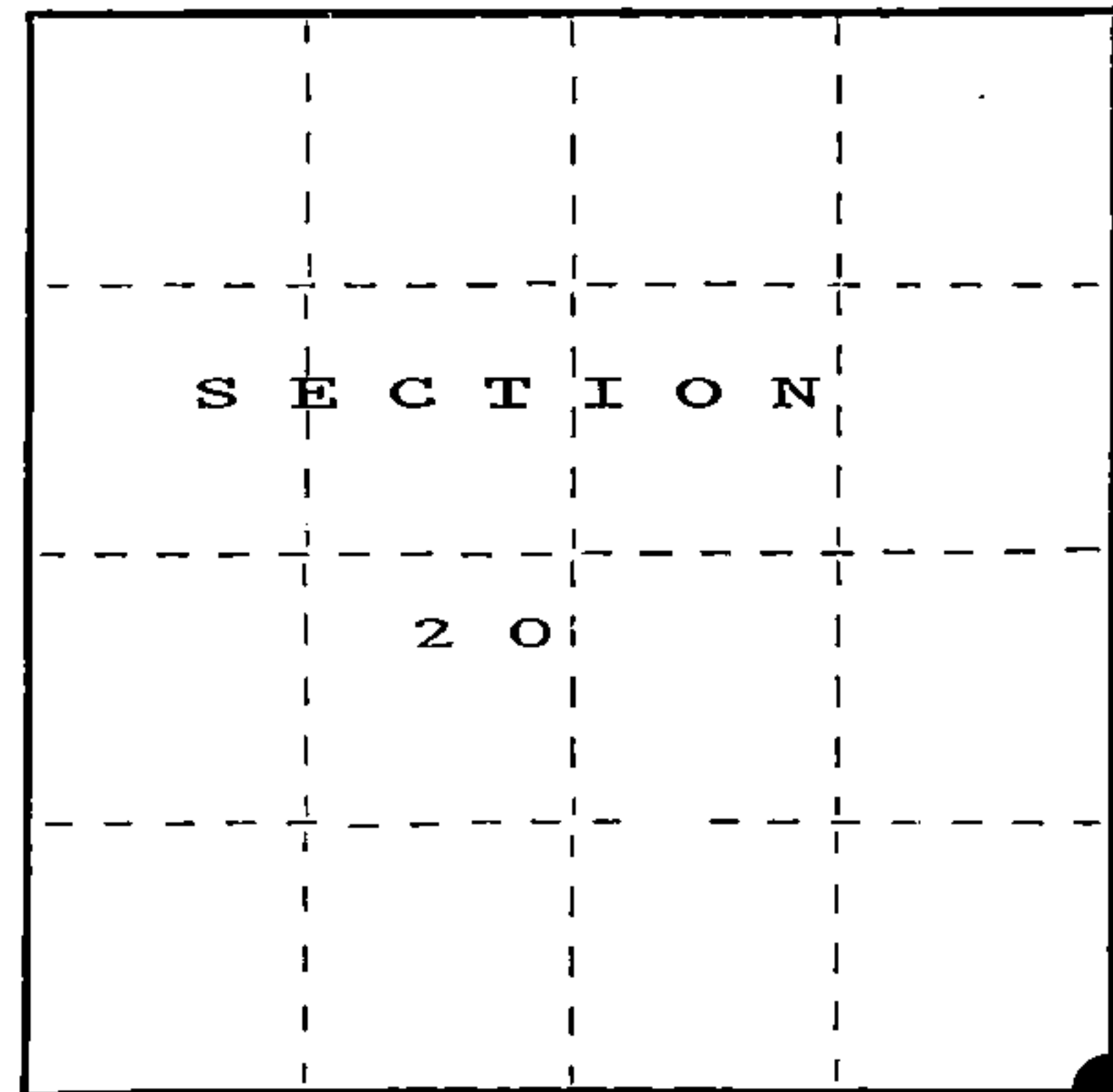

○ = Corner monument restored.

History of original corner establishment:  
Original Government Survey in 1859 by William Daugherty.

Original bearing trees: Cedar 8" N40°E 50 lks.  
Cedar 10" S64°W 18 lks.

Description of corner evidence found:  
Recovered badly rotted cedar stumps which fit the GLO bearing trees. The stump to the Northeast had evidence of scarring. The position of the corner also fits very good with Soo railroad survey maps.

Description of monument and accessories I established to perpetuate the original location of this corner.  
Set a 2 1/2" diameter aluminum pipe monument. 5 feet long, 4 feet in the ground, with an aluminum cap stamped; T37N, R12E, S20, S21, S28, S29, 1986, S-1665. Established the following new bearing trees which are blazed, scribed, painted and tagged.

Black Ash	8"	N51°E	17.83 feet
Cedar	8"	S71°E	23.83 feet
Black Ash	10"	S15°W	29.05 feet
Cedar	5"	N43°W	23.86 feet

Dated at Ludington, Michigan, ~~Wis~~, this fifth day of January, 1987.

Signature John C. Schulke Title Land Surveyor Registration No. S-1665  
(County Surveyor, Registered Land Surveyor, or other duly authorized official)

Office of Register of Deeds, County of Forest, I hereby certify that the within instrument was filed in this office for record on the 24th day of February, 1987 at 2:00 o'clock P.M.

Paul Aschenbrenner  
(Register of Deeds)

By \_\_\_\_\_ Deputy

REGISTER'S OFFICE  
Forest County, Wis.

Received for record this 24th day of January, A.D., 1987 at 2:00 o'clock P.M. and recorded in Vol. CORNER RESTORATIONS page 89

Paul Aschenbrenner  
Register of Deeds

FORM NO. 985-A

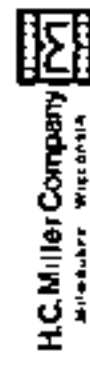

Stock No. 26273

DOCUMENT NUMBER  
132186

43712200000

(e) Describe any material discrepancy between the location of the corner as restored or reestablished and the location of that corner as previously restored or reestablished by distance and direction. Show the discrepancy on the plan view drawing under (d), above. Show the distances between the corner as previously restored or reestablished and (1) the corner as restored or reestablished, and (2) to at least 2 of the witness monuments shown on the drawing in (d), above.

Recovered "Iversons" Cedar bearing tree S72°W 64.9 feet. This bearing tree would if accepted place the corner in a position which would not fit the railroad maps. Note also that the area was searched for GLO corner evidence none could be found.

(f) Was the corner restored through acceptance of (1) an obliterated evidence location, or, (2) a found perpetuated location?  
 Obliterate evidence location.

(g&h) Was the corner reestablished through lost corner proportionate methods? If so, show the method, including the directions and distances to other public land survey corners used as evidence or used for proportioning in determining the corner location?

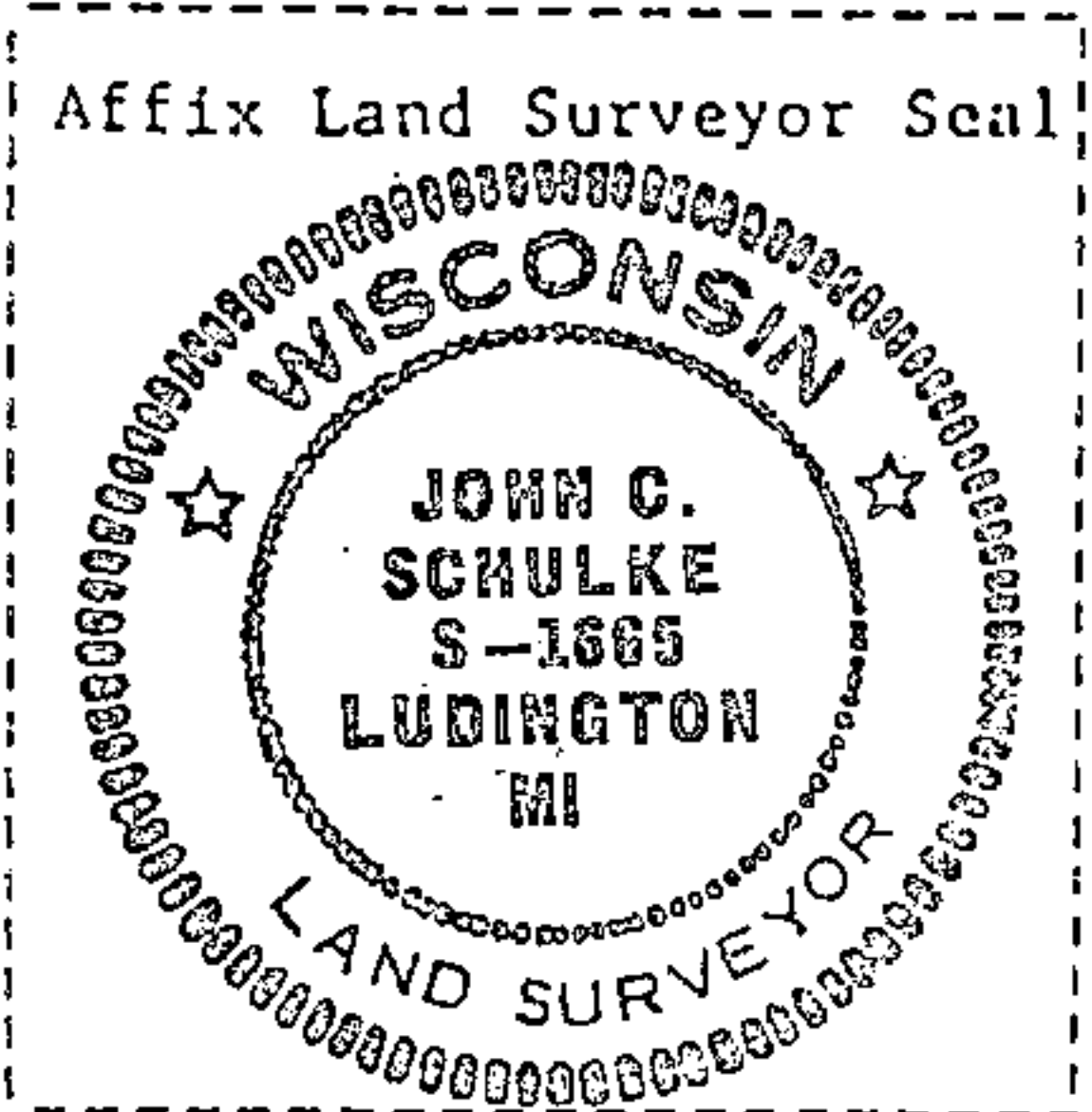
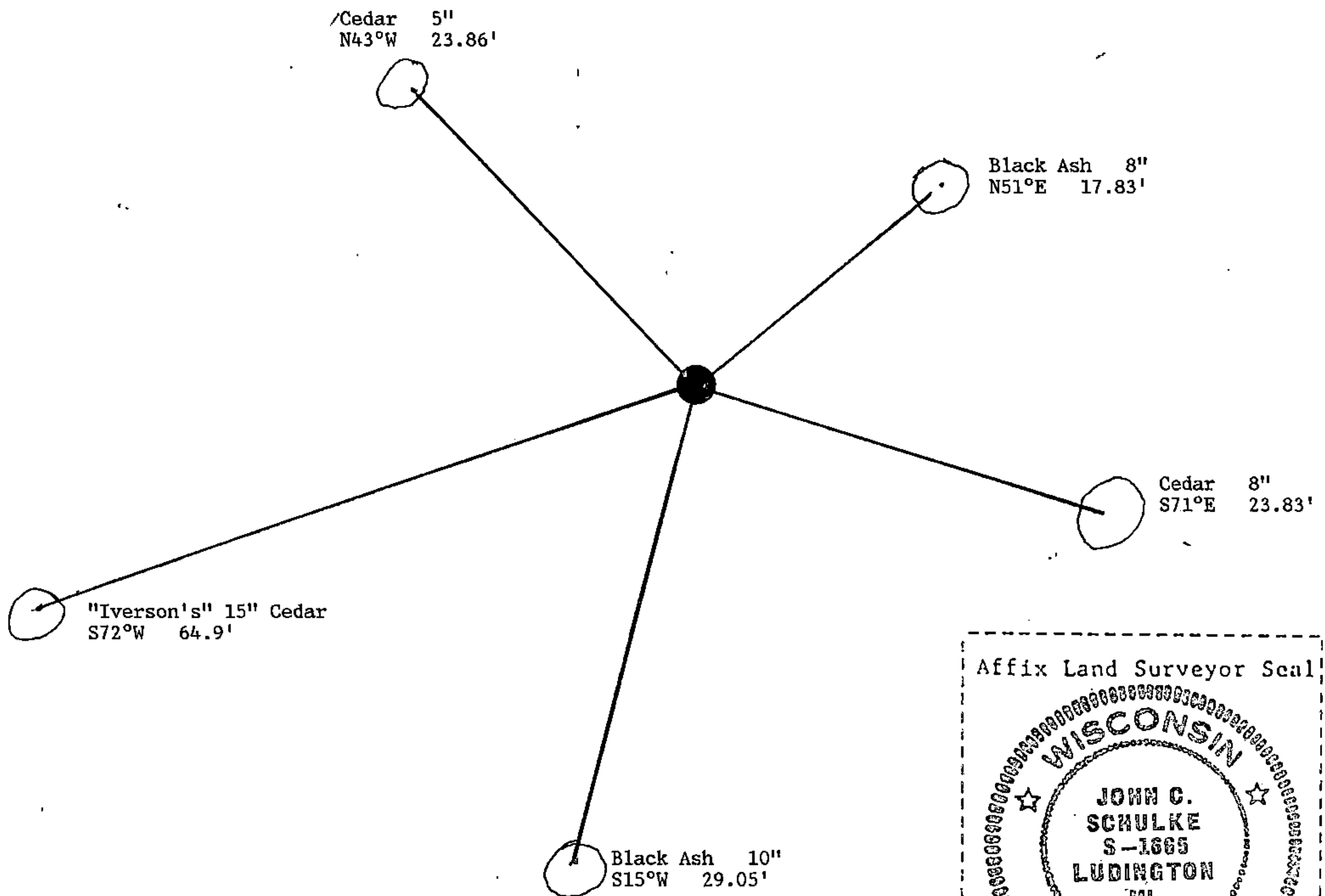

(i) I, John C. Schulke  
 (type or print name) certify that the corner location shown on this record was determined by me or under my direction and control and that this U.S. Public Land Survey Monument Record is correct and complete to the best of my knowledge and belief.

John C. Schulke January 5th, 1987  
 Signature Date

Certificate Ready for Filing: Dale S. Stage 2/24/87  
 District Ranger Date

U. S. PUBLIC LAND SURVEY MONUMENT RECORD

INSTRUCTIONS:

This record shall show the location of the corner and shall include all of the following nine elements (a through i).

- (a) Identify the corner by reference to the U.S. public land survey system.
- = Corner monument restored.

Section Corner to Sections 20, 21, 28 and 29, T37N, R12E, Forest County, Wisconsin

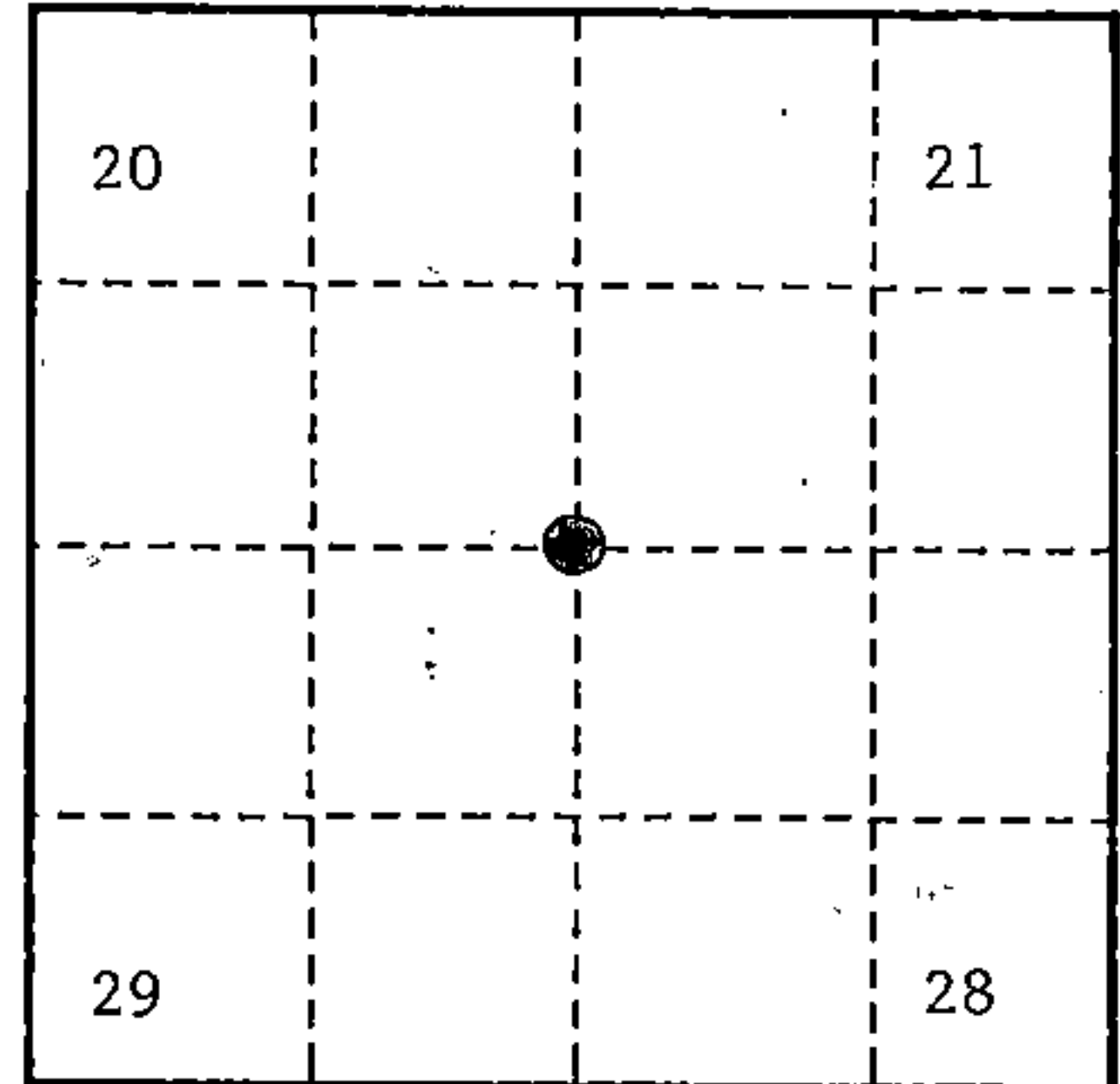

- (b) Describe any record evidence, monument evidence, occupational evidence, testimonial evidence or any other material evidence you considered, and whether the monument was found or placed.

Original Government Survey in 1859 by William E. Daugherty.

In 1986, John C. Schulke, RLS, found badly rotted cedar stumps which fit with GLO bearing trees. The Northeast stump had evidence of scarring. This position fits well with the railroad survey maps. From bearing tree evidence, set a 2½" diameter aluminum pipe monument, 5 feet long, 4 feet in the ground, with an aluminum cap stamped; T37N, R12E, S20, S21, S28, S29, 1986, S-1665. Blazed and scribed the following bearing trees;

Black Ash	8"	N51°E	17.83 feet
Cedar	8"	S71°E	23.83 feet
Black Ash	10"	S15°W	29.05 feet
Cedar	5"	N43°W	23.86 feet

On 9-28-99, Gary L. Pisoni, RLS, found the monument as described above, found the bearing trees as described below, and made new bearing trees as described below.

See previously recorded Land Corner Certificate, Document #132186.

- (c) In the plan view drawing below, provide reference ties to at least 4 witness monuments, or, if the location is within a municipality, to at least 2 witness monuments. (witness monuments shall be made of concrete, natural stone, iron or other equally durable material.)

- (d) Show a plan view drawing depicting the relevant monuments and reference ties which is sufficient in detail to enable accurate relocation of the corner monument if the corner monument is disturbed. Indicate north.

1. Black Ash, 10", N51°E, 17.83 feet
2. Black Ash, 12", S15°W, 29.05 feet
3. Steel Sign Post, Southwest, 1.50 feet
4. Black Ash, 9", S18°E, 8.54 feet (NBT)
5. Black Ash, 10", N36°W, 33.27 feet (NBT)

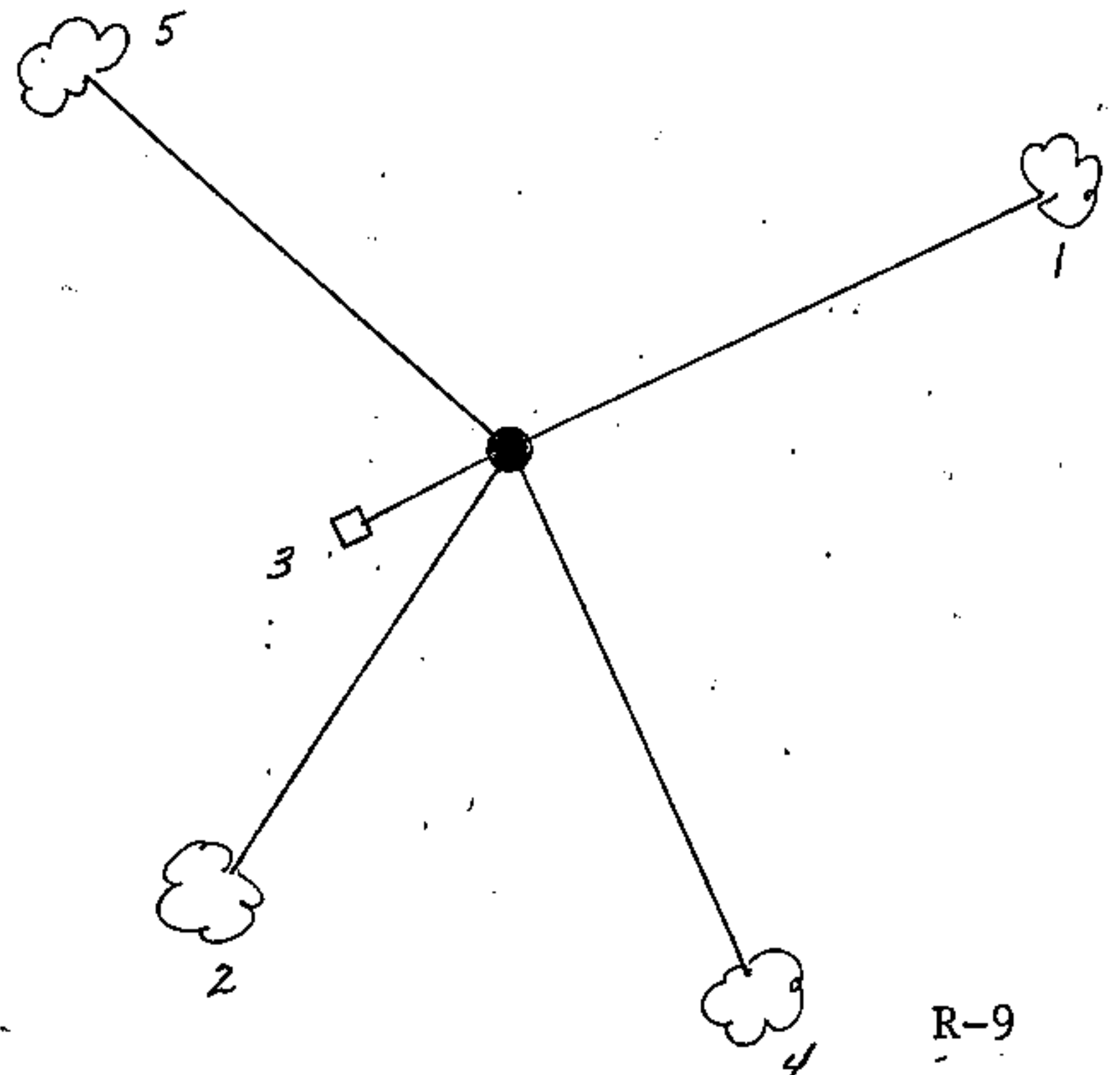

REGISTER'S OFFICE  
 Forest County, Wis.  
 Received for record this 27th day  
 of October A.D., 1999 at  
 10:05 o'clock A.M. and recorded  
 in Vol. Corner Restoration  
 page R-9  
*Kay Swanson* Deputy  
 Register of Deeds

(e) Describe any material discrepancy between the location of the corner as restored or reestablished and the location of that corner as previously restored or reestablished by distance and direction. Show the discrepancy on the plan view drawing under (d), above. Show the distances between the corner as previously restored or reestablished and (1) the corner as restored or reestablished, and (2) to at least 2 of the witness monuments shown on the drawing in (d), above.

None

(f) Was the corner restored through acceptance of (1) an obliterated evidence location, or, (2) a found perpetuated location?

Found perpetuated location.

(g & h) Was the corner reestablished through lost corner proportionate methods? If so, show the method, including the directions and distances to other public land survey corners used as evidence or used for proportioning in determining the corner location?

(1) I, Gary L. Pisoni

(type or print name) certify that the corner location shown on this record was determined by me or under my direction and control and that this U.S. Public Land Survey Monument Record is correct and complete to the best of my knowledge and belief.

*Gary L. Pisoni*

10-2-99

Signature

Date

CERTIFICATE READY FOR FILING:

*[Signature]*

District Ranger

