

U.S. PUBLIC LAND SURVEY MONUMENT RECORD

Index No. N-9

State of Wisconsin } ss.  
County of FOREST

I, John C. Schulke, do hereby certify that on the 30th day of May, 1986, I found evidence of the Southwest corner of Section 16, Township 37 North, Range 12 East, Fourth Principal Meridian, as described hereon; and that from this evidence I established a new monument and accessories as described hereon to perpetuate the original location of this corner.

Resident witnesses:

History of original corner establishment:

Original Government Survey in 1859 by William Daugherty.

Original bearing trees:	Hemlock	16"	S20°E	21 lks.
	Birch	10"	S44°W	11 lks.
Bearing GLO swamp calls:			South	16.25 chains
" " " "			East	3.0 chains

Description of corner evidence found:

Found evidence of a post hole by GLO swamp calls. Recovered the following 1859 bearing trees:

Decayed Hemlock	S20°E	13.9 feet
stump hole	S44°W	7.3 feet

Description of monument and accessories I established to perpetuate the original location of this corner.

Set a 2 1/2" dia. aluminum pipe monument, 3 feet long, 2 feet in the ground, with an aluminum cap stamped; T37N, R12E, S16, S17, S20, S21, 1986, S-1665. Established the following new bearing trees which are blazed, scribed, painted and tagged.

Spruce	14"	N24°E	18.68 feet
Balsam	14"	S73°E	8.50 feet
Balsam	11"	N69°W	29.38 feet
Triple White			
Birch	14"	N26°W	45.84 feet
Steel sign post		Southeast	0.7 feet

Dated at Ludington, Michigan, Wis., this fifth day of January, 1987

Signature: John C. Schulke Title Land Surveyor Registration No. S-1665  
(County Surveyor, Registered Land Surveyor, or other duly authorized official)

Office of Register of Deeds, County of Forest, I hereby certify that the within instrument was filed in this office for record on the 24th day of February, 1987 at 2:00 o'clock P. M.

Paul Achenbrenner  
(Register of Deeds)

By Deputy

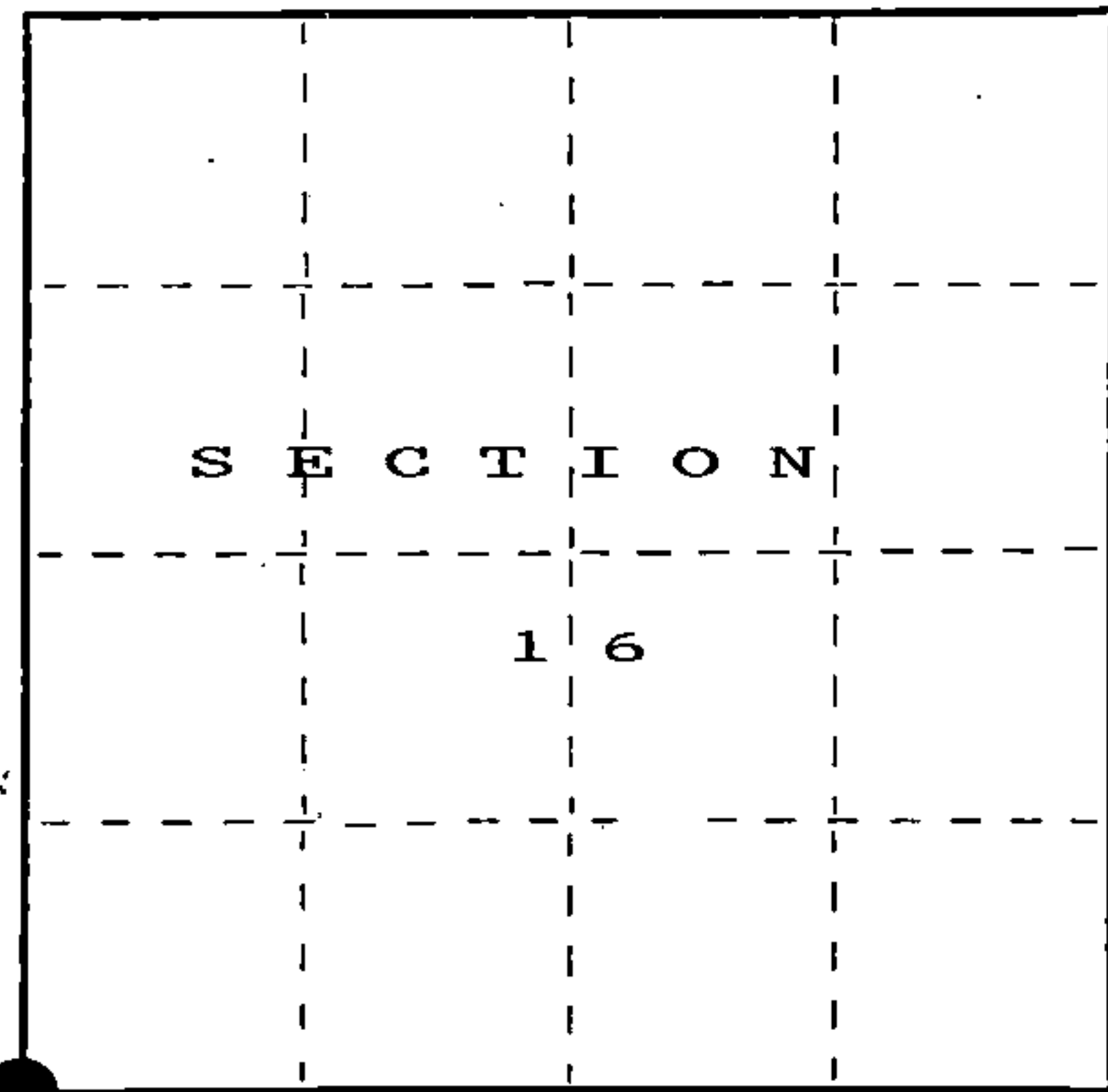

○ = Corner monument restored.

REGISTER'S OFFICE }  
Forest County, Wis. }  
Received for record this 24th day  
of January, A.D., 1987 at  
2:00 o'clock P.M. and recorded  
in Vol. CORNER RESTORATIONS  
page 8-9  
Paul Achenbrenner  
Register of Deeds

FORM NO. 985-A

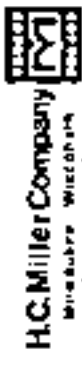

Stock No. 26273

DOCUMENT NUMBER  
132176

43712170000

(e) Describe any material discrepancy between the location of the corner as restored or reestablished and the location of that corner as previously restored or reestablished by distance and direction. Show the discrepancy on the plan view drawing under (d), above. Show the distances between the corner as previously restored or reestablished and (1) the corner as restored or reestablished, and (2) to at least 2 of the witness monuments shown on the drawing in (d), above.

No discrepancy, first corner restoration.

(f) Was the corner restored through acceptance of (1) an obliterated evidence location, or, (2) a found perpetuated location?

The corner was restored through acceptance of obliterated evidence.

(g&h) Was the corner reestablished through lost corner proportionate methods? If so, show the method, including the directions and distances to other public land survey corners used as evidence or used for proportioning in determining the corner location?

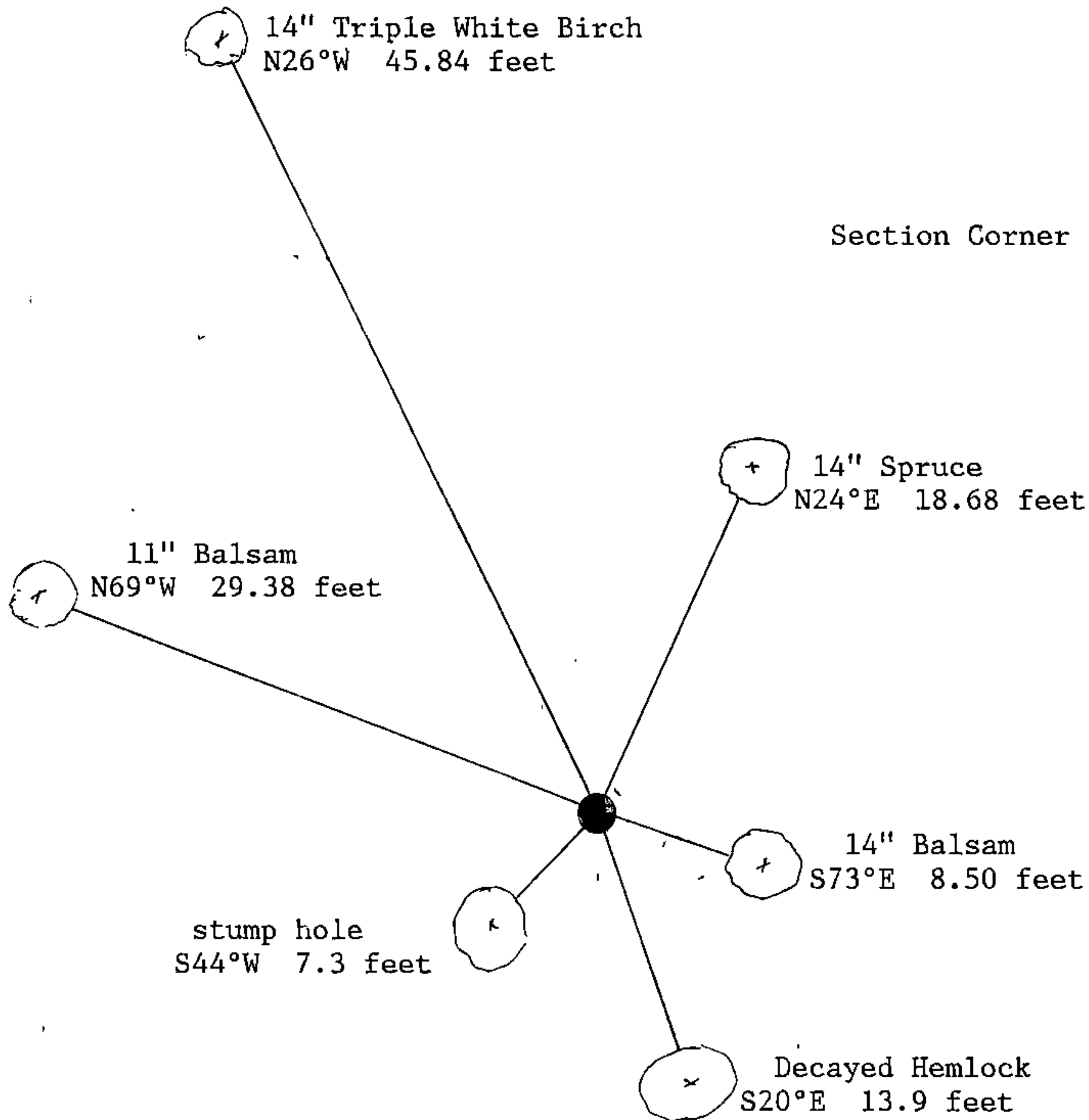

Section Corner	S17	S16
	S20	S21

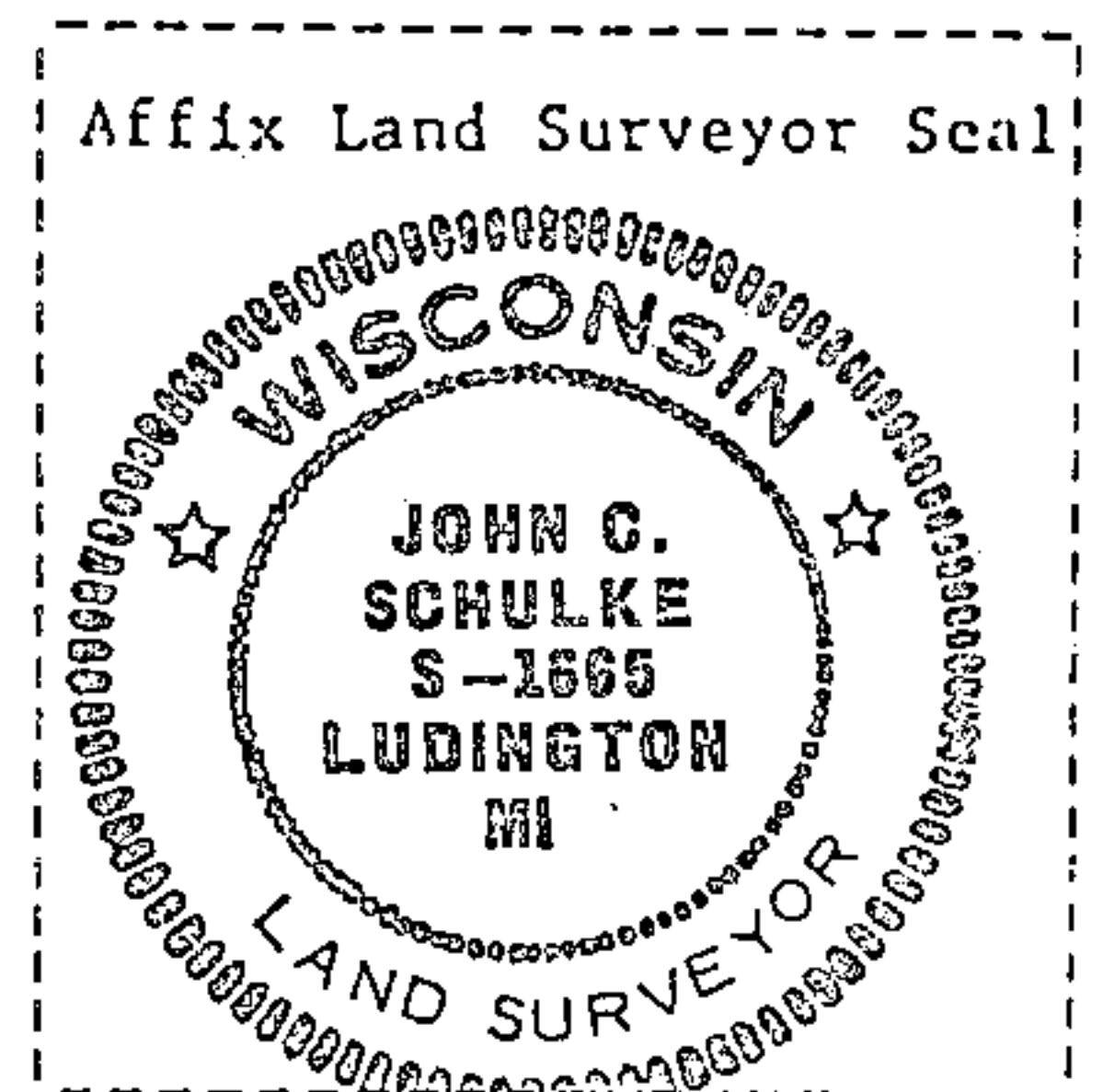

(i) I, John C. Schulke  
 (type or print name) certify that the corner location shown on this record was determined by me or under my direction and control and that this U.S. Public Land Survey Monument Record is correct and complete to the best of my knowledge and belief.

John C. Schulke January, 5th 1987  
 Signature Date

Certificate Ready for Filing: Doris Staeger 2/24/87  
 District Ranger Date

U. S. PUBLIC LAND SURVEY MONUMENT RECORD

INSTRUCTIONS:

This record shall show the location of the corner and shall include all of the following nine elements (a through i).

- (a) Identify the corner by reference to the U.S. public land survey system.
- = Corner monument restored.

Section Corner to Sections 16, 17, 20, 21  
T37N, R12E, Forest County, Wisconsin

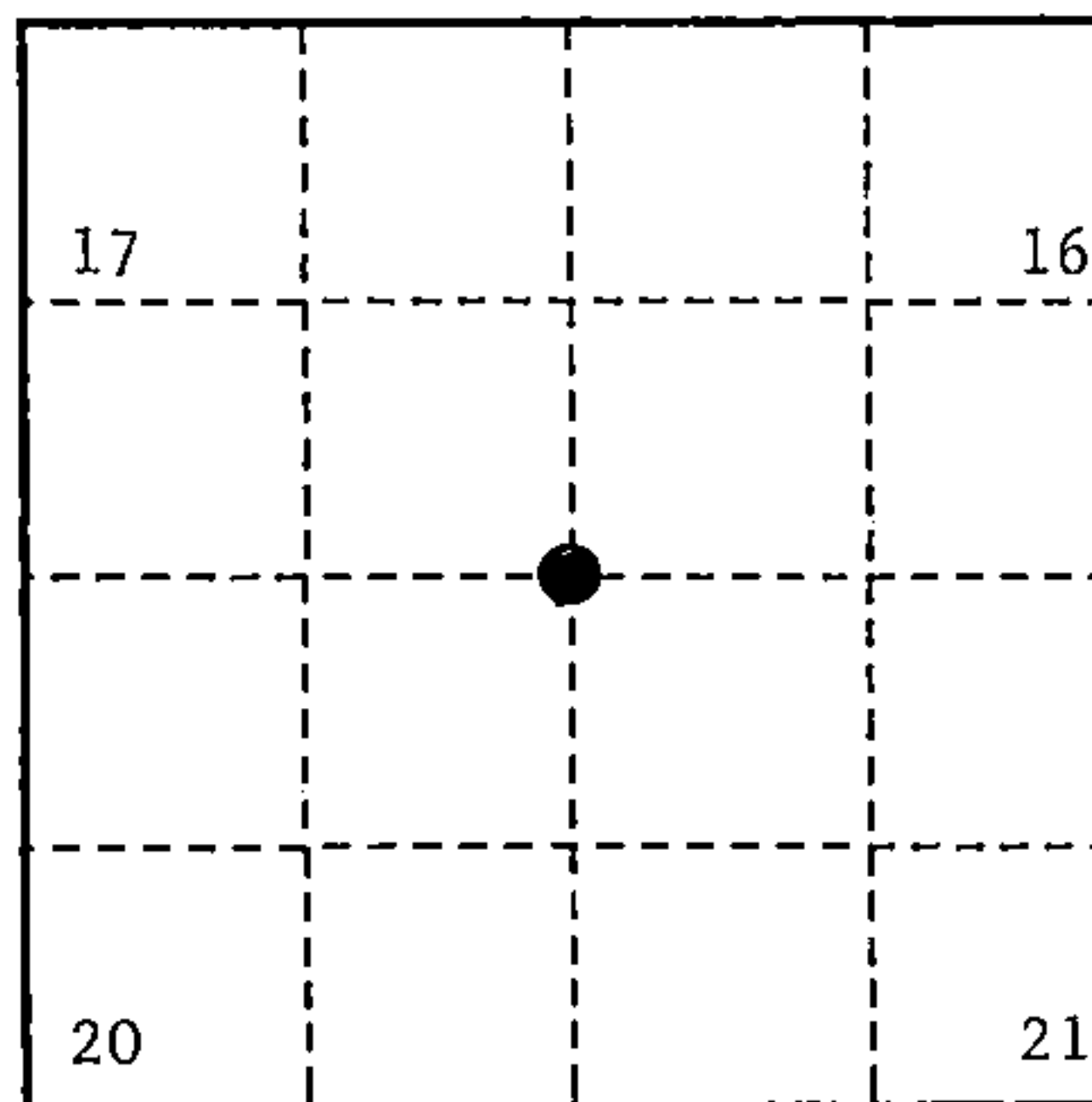

- (b) Describe any record evidence, monument evidence, occupational evidence, testimonial evidence or any other material evidence you considered, and whether the monument was found or placed.

Original Government Survey in 1859 by William E. Daugherty.

In 1986, John C. Schulke, RLS, found evidence of a post hole by GLO swamp calls and recovered the original bearing trees. In the post hole, he set a 2½" diameter aluminum pipe monument 3 feet long, with an aluminum cap stamped as follows: T37N, R12E, S17, S16, S20, S21, 1986, S-1665, from which the following bear:

Spruce	14"	N 24°E	18.68 feet
Balsam	14"	S 73°E	8.5 feet
Balsam	11"	N 69°W	29.38 feet
Triple White Birch	14"	N 26°W	45.84 feet
Steel sign post		SE	0.7 feet

On 9/7/99, Gary L. Pisoni RLS, found the above monument and the assessories as described below.

See previous Land Corner Certificate dated February 24, 1987, Document Number 132176

- (c) In the plan view drawing below, provide reference ties to at least 4 witness monuments, or, if the location is within a municipality, to at least 2 witness monuments. (witness monuments shall be made of concrete, natural stone, iron or other equally durable material.)

- (d) Show a plan view drawing depicting the relevant monuments and reference ties which is sufficient in detail to enable accurate relocation of the corner monument if the corner monument is disturbed. Indicate north.

1. White Birch, 15", N 33°W, 45.84 feet
2. Steel sign post, SE, 0.7 feet
3. Spruce, 6", N 9°E, 20.73 feet (NBT)
4. Popple, 4", S 78°E, 7.40 feet (NBT)
5. Balsam, 7", S 62°W, 2.30 feet (NBT)

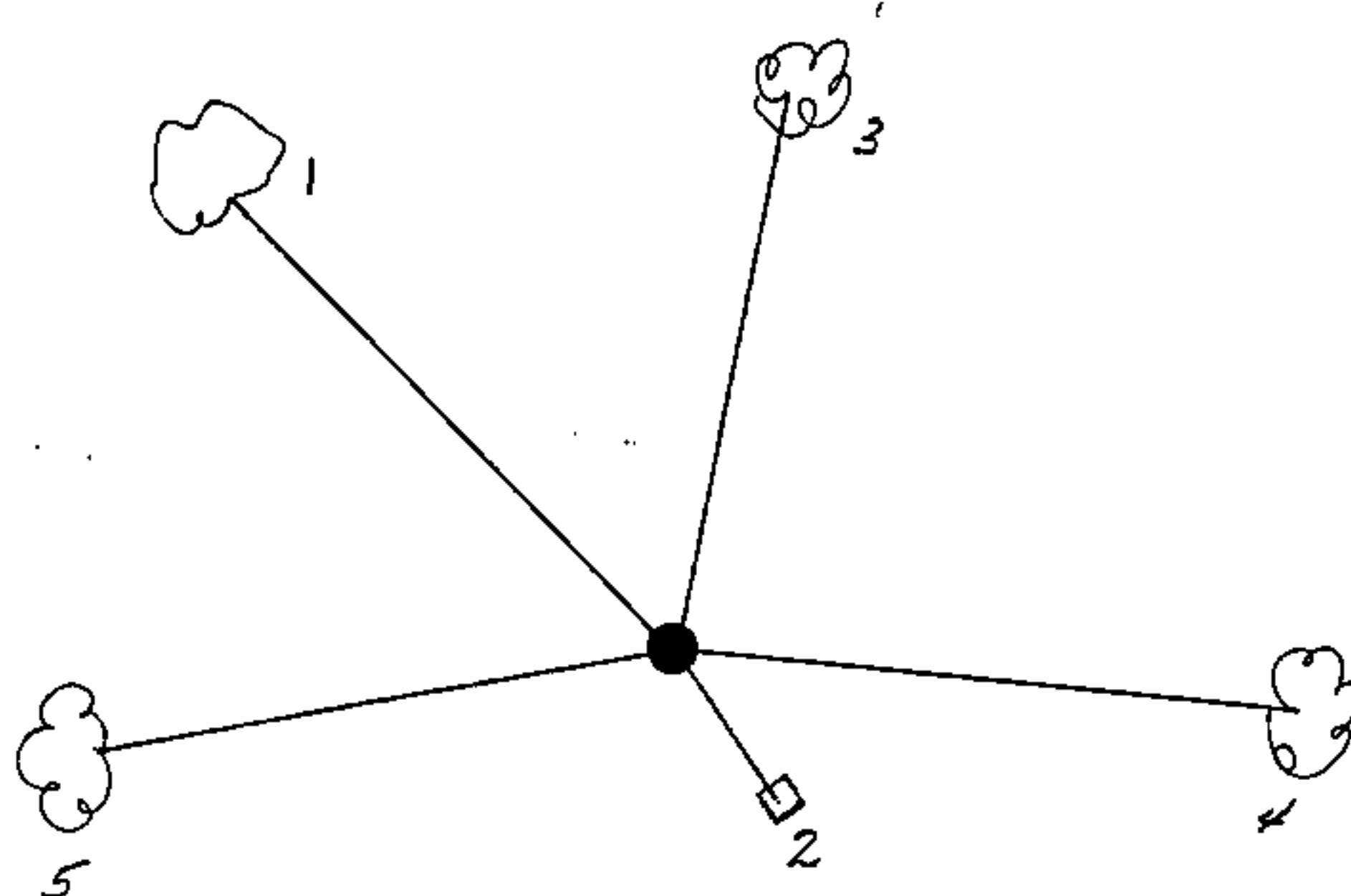

REGISTER'S OFFICE }  
Forest County, Wis. }  
Received for record this 27<sup>th</sup> day  
of October A.D., 1999 at  
10:05 o'clock A.M. and recorded  
in Vol. Corner Restoration  
page N 9  
Kay Swanson, Deputy  
Register of Deeds

43712170000

(e) Describe any material discrepancy between the location of the corner as restored or reestablished and the location of that corner as previously restored or reestablished by distance and direction. Show the discrepancy on the plan view drawing under (d), above. Show the distances between the corner as previously restored or reestablished and (1) the corner as restored or reestablished, and (2) to at least 2 of the witness monuments shown on the drawing in (d), above.

None

(f) Was the corner restored through acceptance of (1) an obliterated evidence location, or, (2) a found perpetuated location?

Restored from accepted evidence.

(g & h) Was the corner reestablished through lost corner proportionate methods? If so, show the method, including the directions and distances to other public land survey corners used as evidence or used for proportioning in determining the corner location?

Gary L. Pisoni

(1) I, \_\_\_\_\_  
(type or print name) certify that the corner location shown on this record was determined by me or under my direction and control and that this U.S. Public Land Survey Monument Record is correct and complete to the best of my knowledge and belief.

Signature

*Gary L. Pisoni*

10-1-99

Date

CERTIFICATE READY FOR FILING:

*[Signature]*

District Ranger

