

U.S. PUBLIC LAND SURVEY MONUMENT RECORD

Index No. G-9

State of Wisconsin }
 County of Forest } ss.

I, John C. Schulke, do hereby certify that on the 12th day of May, 1987, I found evidence of the East Quarter corner of Section 8 Township thirty-seven, North, Range twelve East, Fourth Principal Meridian, as described hereon; and that from this evidence I established a new monument and accessories as described hereon to perpetuate the original location of this corner.

Resident witnesses:

.....

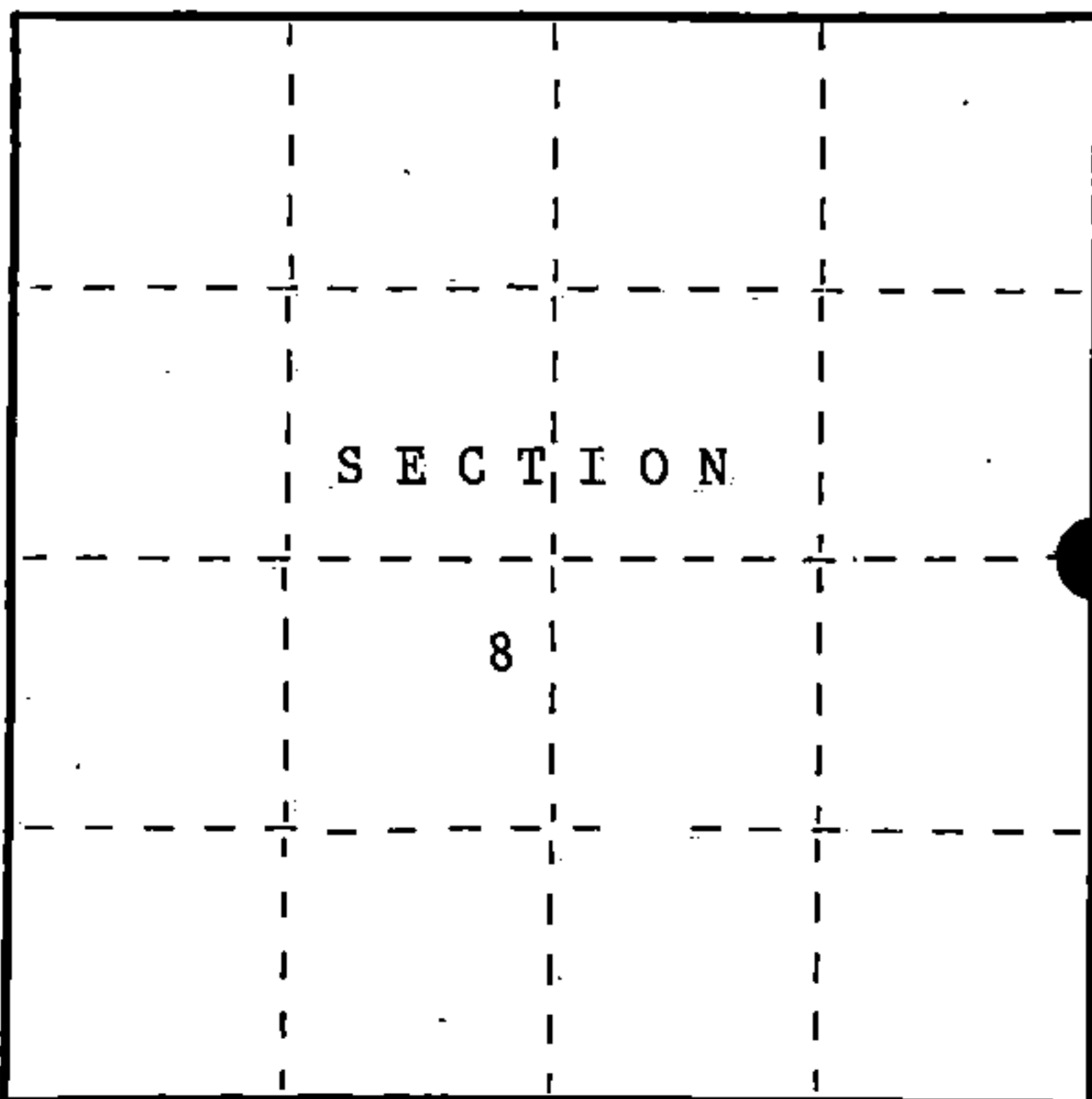

○ = Corner monument restored.

History of original corner establishment:

Original corner established in 1859 by William Daugherty, U.S. Deputy Surveyor. Set a wooden post with the following bearing trees:

Cedar	10"	S58°W	17 lks.
Hemlock	12"	N42°E	17 lks.

Description of corner evidence found:

Railroad records indicated corner was located in the center of the East-West town road. At the North and South Sixteenth corners of Sections 8 and 9 old fence corners were recovered. The distance was then doubled from the respective Section corners to locate the Quarter corner.

Description of monument and accessories I established to perpetuate the original location of this corner.

Set 2 1/2" diameter aluminum pipe monument, 30 inches long, 3 feet in the ground with an aluminum cap stamped T37N, R12E, 1/4, S8, S9, 1987, S-1665. Established the following bearing trees which are blazed, scribed, painted and tagged.

White Birch	10"	S50°E	23.89 feet
Black Ash	6"	N62°E	31.14 feet
Tamarack	6"	N48°W	82.59 feet
Red Maple	4"	S84°W	102.67 feet
Steel sign post		Southeast	14.1 feet

The corner is located in the center of the East-West road.

Dated at Hiles, Wis., this Eleventh day of November, 1987.

Signature: John C. Schulke Title: Land Surveyor Registration No. S-1665
 (County Surveyor, Registered Land Surveyor, or other duly authorized official)

Office of Register of Deeds, County of Forest, I hereby certify that the within instrument was filed in this office for record on the 2nd day of February, 1988 at 9:40 o'clock A. M.

Paul Achenbrenner
 (Register of Deeds)

By _____ Deputy

FORM NO. 985-A

H.C. Miller Company
 MILWAUKEE, WISCONSIN

Stock No. 26273

DOCUMENT NUMBER 134568

in

27-12
 43712082000

(e) Describe any material discrepancy between the location of the corner as restored or reestablished and the location of that corner as previously restored or reestablished by distance and direction. Show the discrepancy on the plan view drawing under (d), above. Show the distances between the corner as previously restored or reestablished and (1) the corner as restored or reestablished, and (2) to at least 2 of the witness monuments shown on the drawing in (d), above.

No discrepancy, first corner restoration.

(f) Was the corner restored through acceptance of (1) an obliterated evidence location, or, (2) a found perpetuated location?

1. an obliterated evidence location.

(g&h) Was the corner reestablished through lost corner proportionate methods? If so, show the method, including the directions and distances to other public land survey corners used as evidence or used for proportioning in determining the corner location?

No.

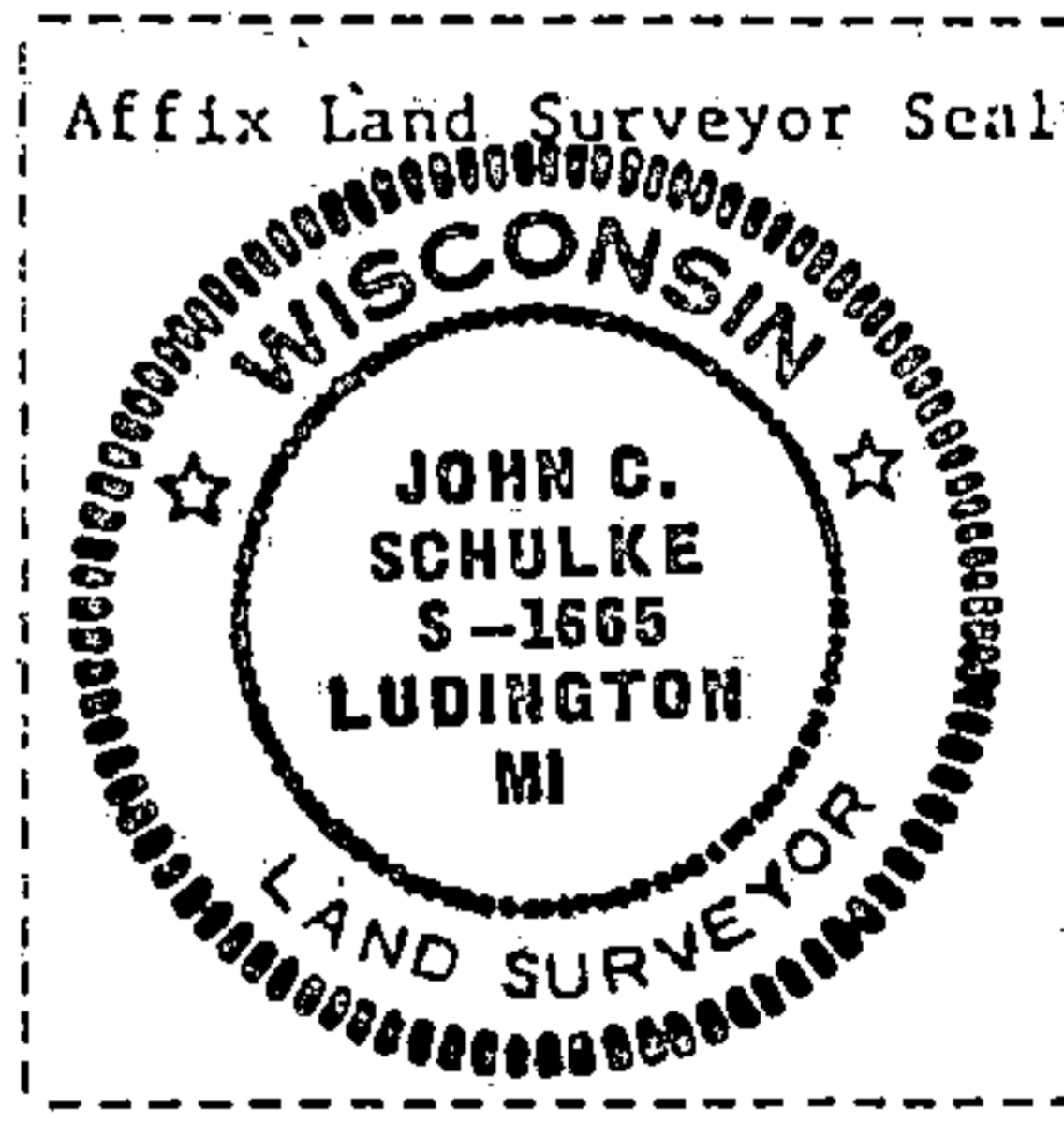
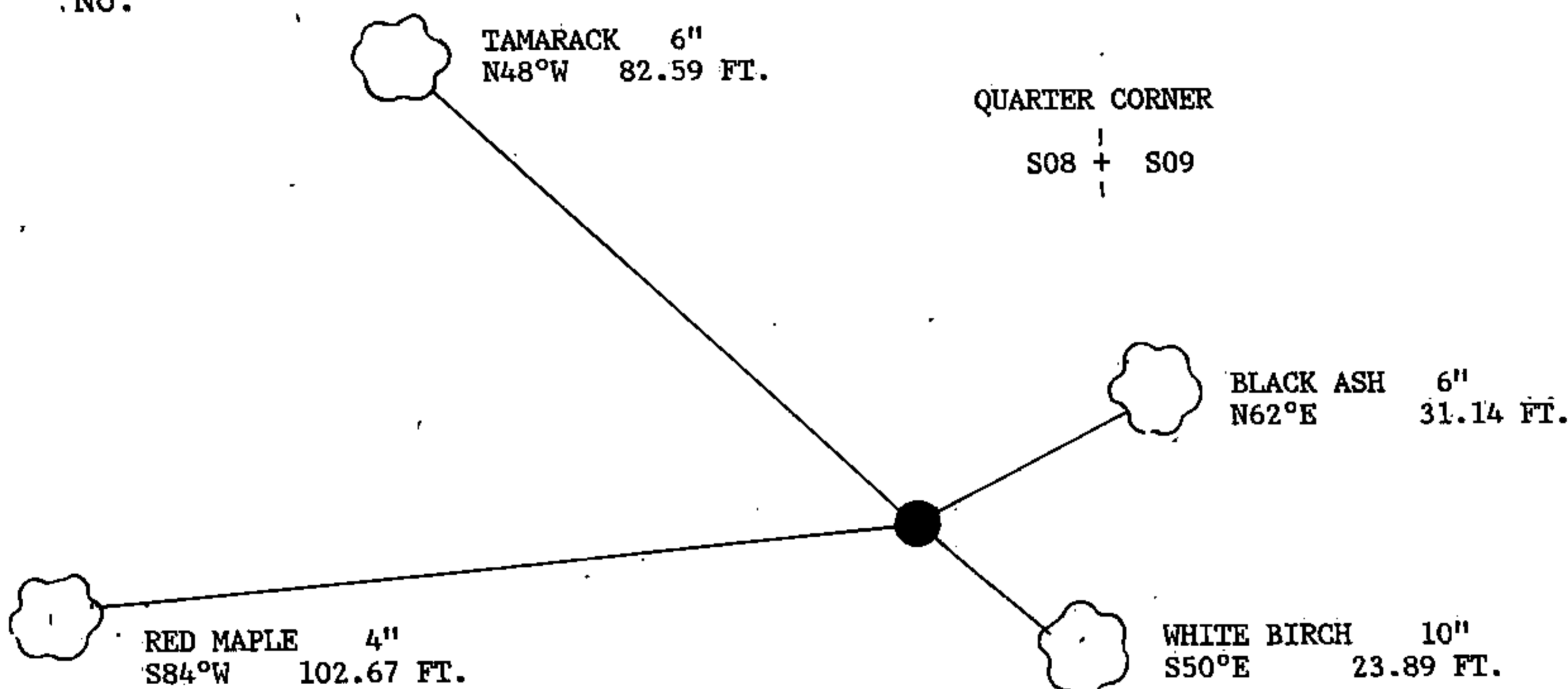

(i) I, John C. Schulke
 (type or print name) certify that the corner location shown on this record was determined by me or under my direction and control, and that this U.S. Public Land Survey Monument Record is correct and complete to the best of my knowledge and belief.

John C. Schulke Nov. 11, 1987
 Signature Date

Survey requested by: Dale Staege 2/1/88
 District Ranger Date