

U.S. PUBLIC LAND SURVEY MONUMENT RECORD

Index No. E-21

State of Wisconsin }
County of FOREST } ss.

I, John Schulke, do hereby certify that on the 28th day of August, 1989, I found evidence of the Southeast Section corner of Section 2 Township 37 North, Range 12 East, Fourth Principal Meridian, as described hereon; and that from this evidence I established a new monument and accessories as described hereon to perpetuate the original location of this corner.

Resident witnesses:

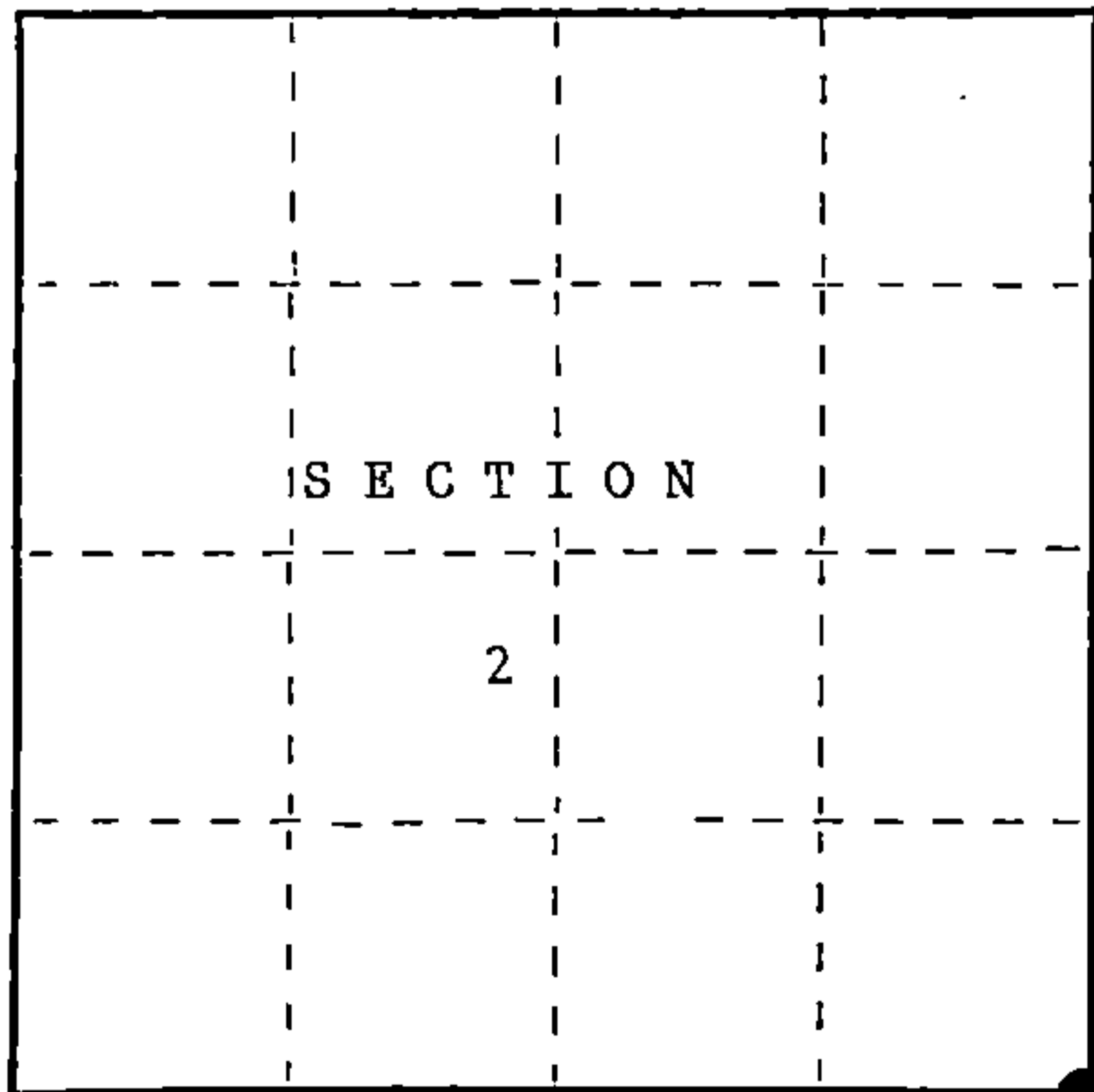

● = Corner monument restored.

History of original corner establishment:

In 1859, Original Government Surveyed by Wm. E. Daugherty. Set a wood post with the following corner references: Birch 10" S27°W 34 lks. Ironwood 10" N15°E 20 lks.

Description of corner evidence found:

In 1989, John Schulke found no evidence.

Description of monument and accessories I established to perpetuate the original location of this corner.

Set a 2 1/2" dia. X 36" aluminum magnetic cap monument stamped to identify the corner. Monument placed in a mound of stones. Set a steel sign post 1.2 ft. South of the monument. The following corner references:

- Sugar Maple 8" N48°E 12.43 ft.
- Hemlock 8" S55°E 25.49 ft.
- Sugar Maple 4" S40°W 30.48 ft.
- Sugar Maple 6" S89°W 22.85 ft.

Dated at Wabeno, Wis., this 25th day of October, 1989.

Signature: John C. Schulke Title: Register Land Surveyor Registration No. S-1665
(County Surveyor, Registered Land Surveyor, or other duly authorized official)

Office of Register of Deeds, County of Forest, I hereby certify that the within instrument was filed in this office for record on the 8th day of March, 1990 at 1:00 o'clock P. M.

Paul Achenbrenner
(Register of Deeds)

By _____ Deputy

FORM NO. 985-A



Stock No. 26273

DOCUMENT NUMBER

139247

43712020000

(c) Describe any material discrepancy between the location of the corner as restored or reestablished and the location of that corner as previously restored or reestablished by distance and direction. Show the discrepancy on the plan view drawing under (d), above. Show the distances between the corner as previously restored or reestablished and (1) the corner as restored or reestablished, and (2) to at least 2 of the witness monuments shown on the drawing in (d), above.

No.

(f) Was the corner restored through acceptance of (1) an obliterated evidence location, or, (2) a found perpetuated location?

Neither

(g&h) Was the corner reestablished through lost corner proportionate methods? If so, show the method, including the directions and distances to other public land survey corners used as evidence or used for proportioning in determining the corner location?

Yes.

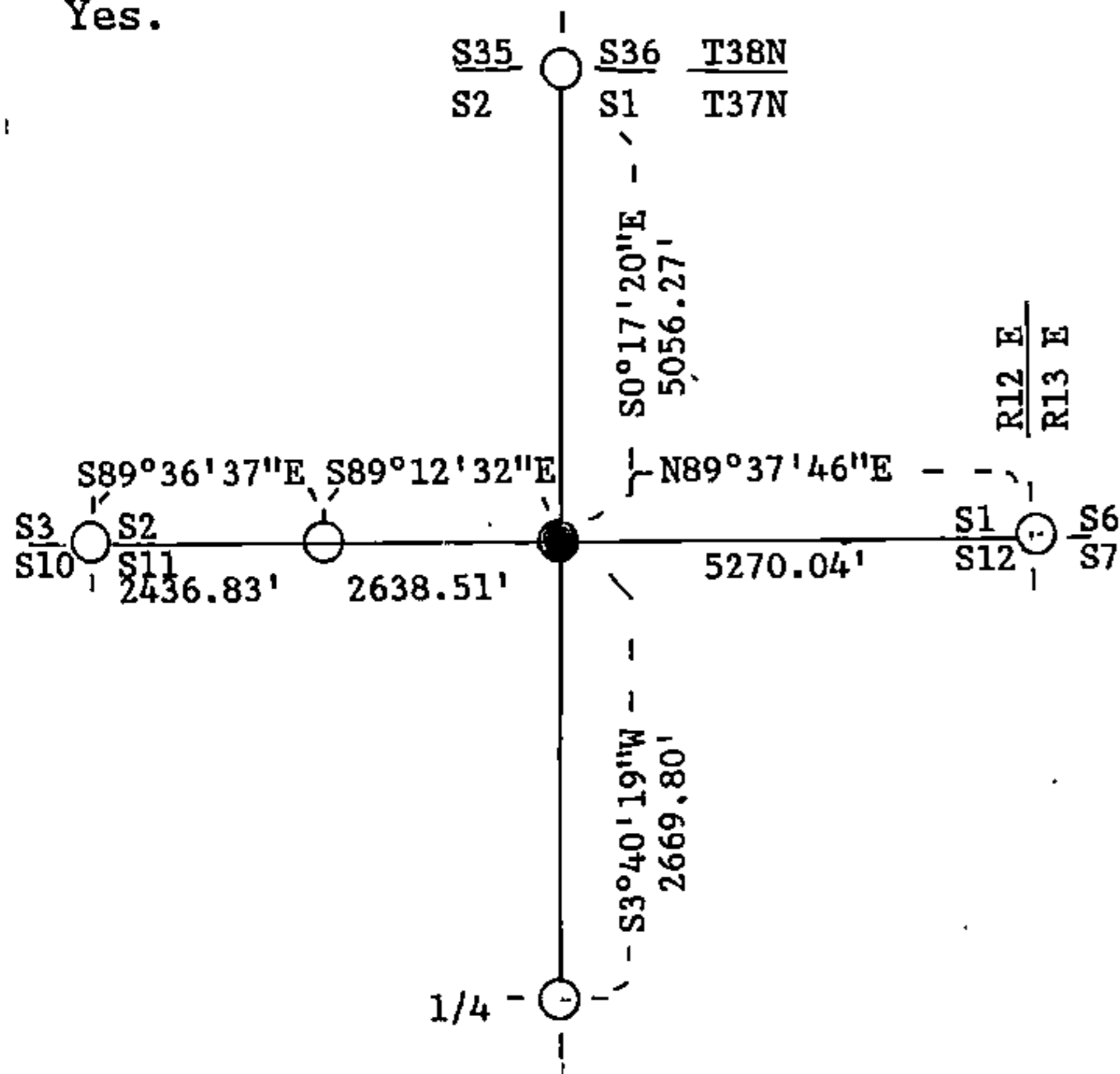

SECTION	CORNER
S2	S1
S11	S12

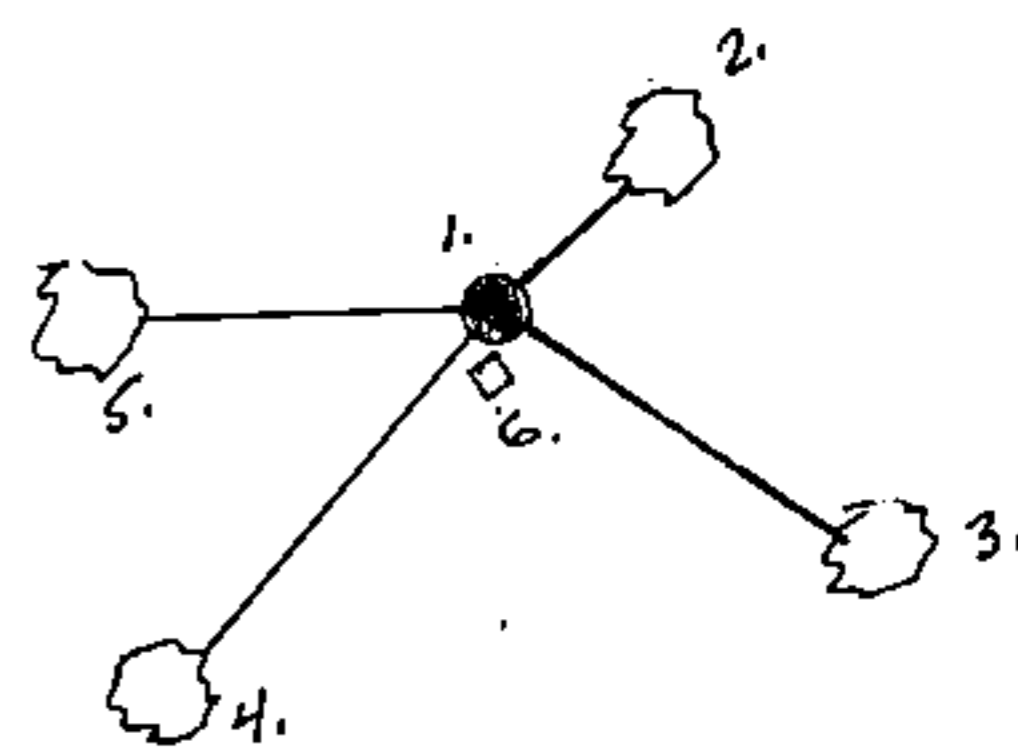

1. 2 1/2" X 36" aluminum monument.
2. Sugar Maple 8" N48°E 12.43 ft.
3. Hemlock 8" S55°E 25.49 ft.
4. Sugar Maple 4" S40°W 30.48 ft.
5. Sugar Maple 6" S89°W 22.85 ft.
6. Steel sign post South 1.2 ft.

(i) I, John Schulke (RLS-1665)
 (type or print name) certify that the corner location shown on this record was determined by me or under my direction and control and that this U.S. Public Land Survey Monument Record is correct and complete to the best of my knowledge and belief.

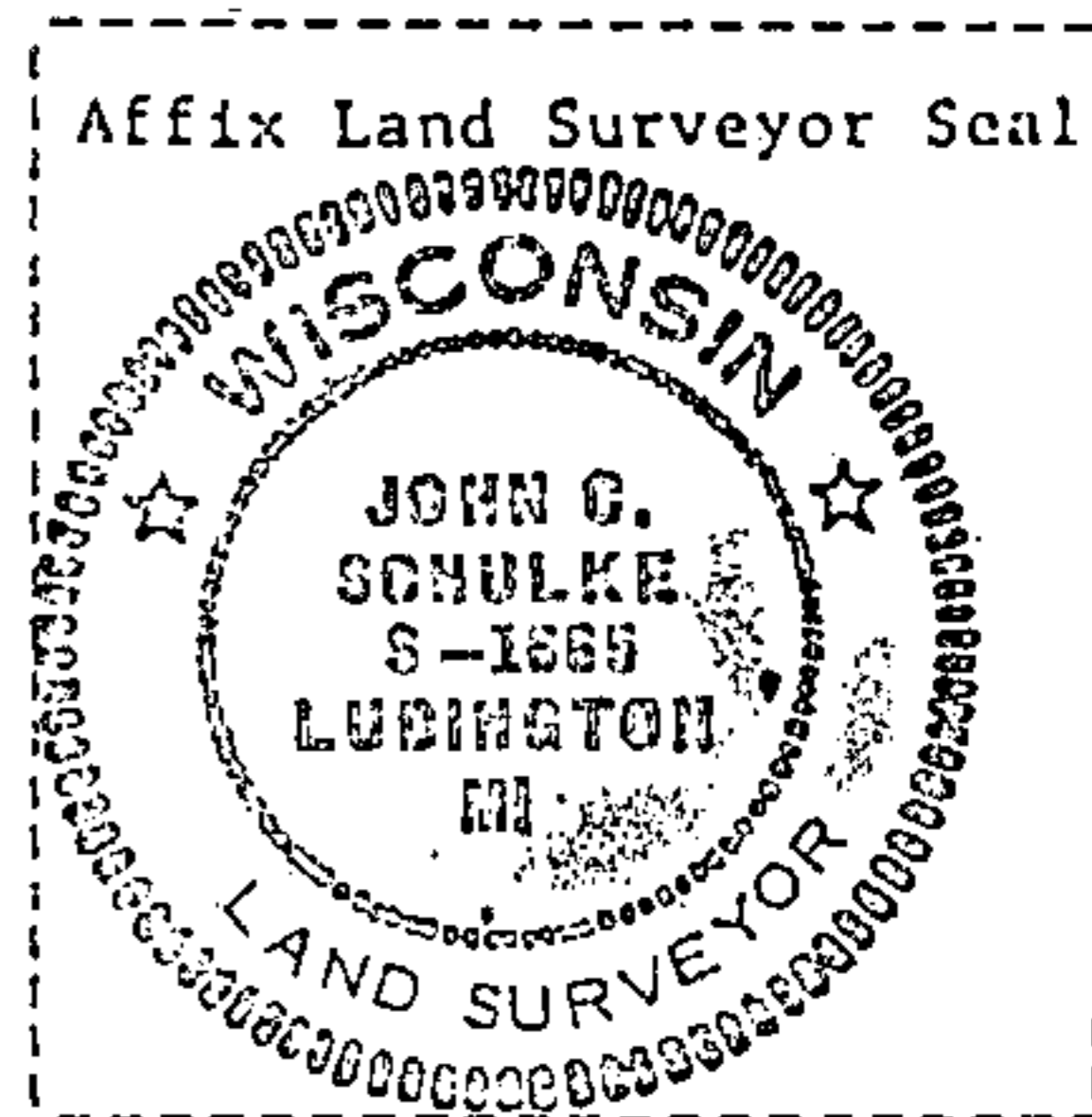

John C. Schulke Signature Oct 25th, 1989 Date

Survey requested by; Dale S. Staeg District Ranger 1989 Date