

CERTIFIED LAND CORNER RESTORATION

Index No. P-1

State of Wisconsin }
County of Forest } ss.

I Philip T. Hansen, do hereby certify that on the 14th day of February 14, 19 78, I found evidence of the Quarter corner of Section 24 & 19 Township 37, North, Range 11 & 12 East, Fourth Principal Meridian, as described hereon; and that from this evidence I established a new monument and accessories as described hereon to perpetuate the original location of this corner.

Resident witnesses:

Glen Barker

Jim Claflin

Herb Wagoner

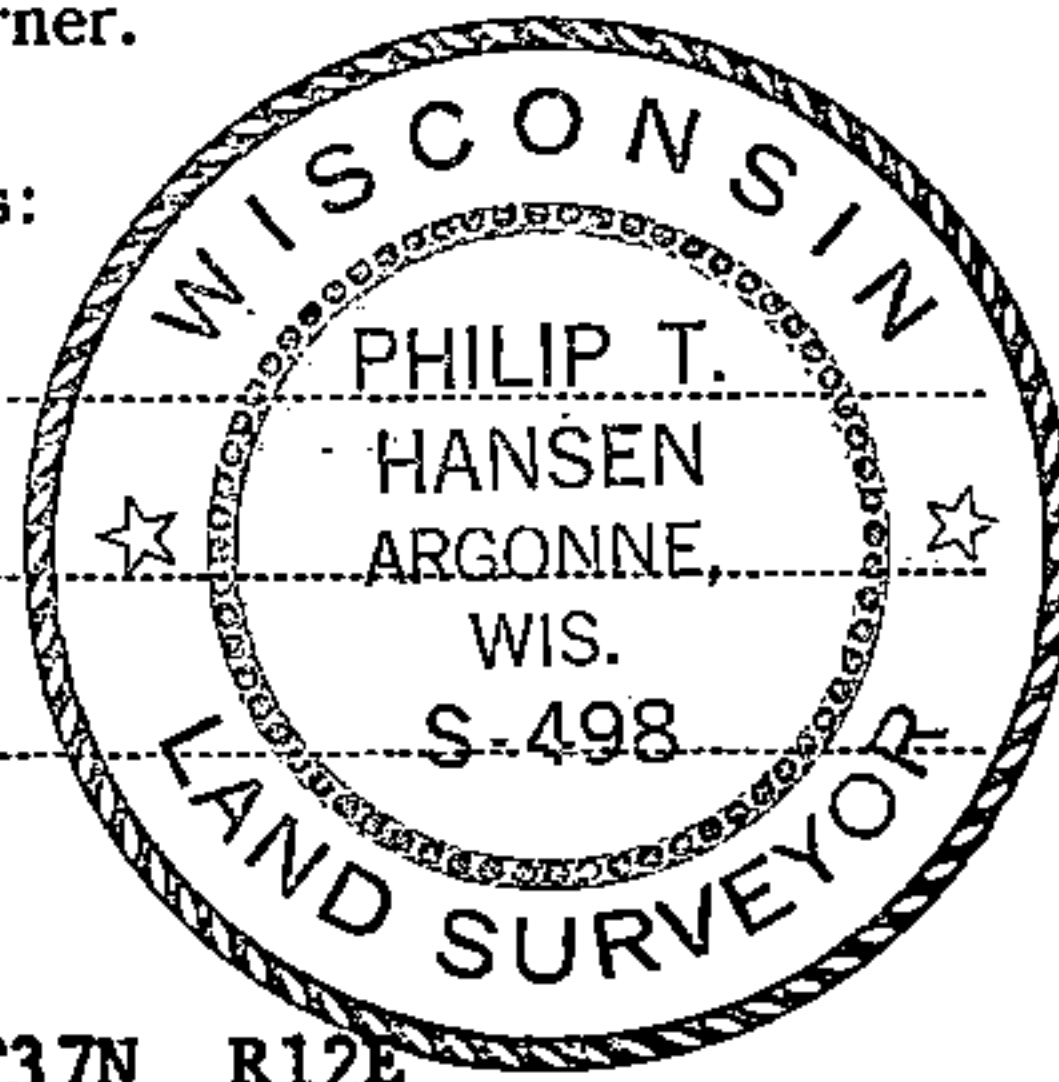

T37N R12E

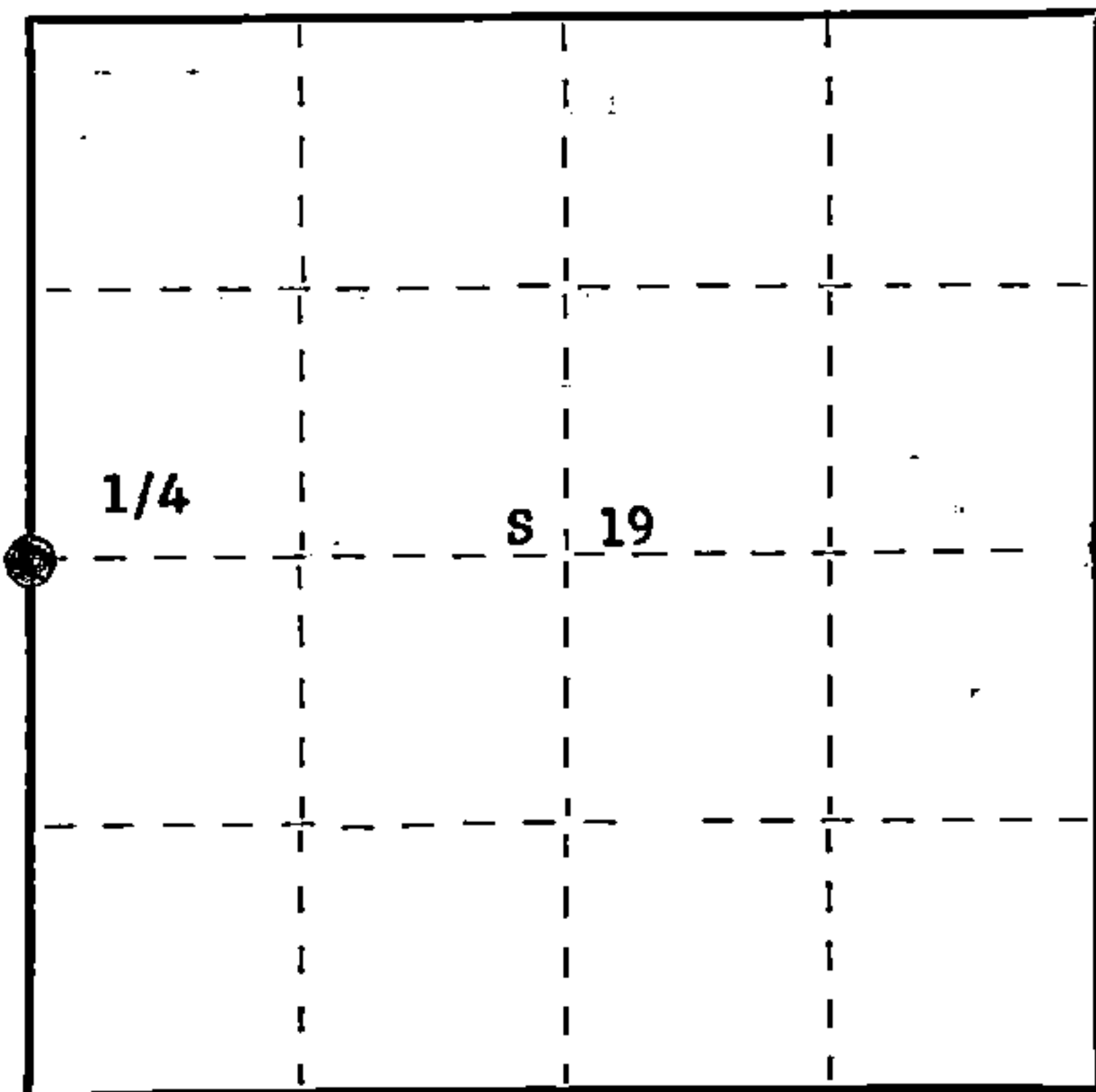

○ = Corner monument restored.

History of original corner establishment:

Corner established by Alfred Miller, Deputy Surveyor, in 1858, from which spruce 8" bears N20°W, 18 links and spruce 5" bears S45°E, 12 links.

Corner recovered by V.M. Maine, County Surveyor. Set new post and marked NBT's - spruce 6" N58° 50' W, 16 links and spruce 6" N76° 50' W, 7 links.

Description of corner evidence found:

Recovered Maine's 6" spruce BT N58° 50' W, 16 links, now a 2' high stump. Searched for, but unable to recover, his post or point of same. No evidence of the spruce 6" S76° 50' W, 7 links.

There is a 7" black spruce with beaver blazes facing the corner position.

Description of monument and accessories I established to perpetuate the original location of this corner.

Set 2 1/2" A-1 Berntsen Federal Monument at point S58° 50' E - 16 links from recovered BT.

Monument projects 8" above ground, cap stamped:
Marked NBT's - black spruce 7" S78°W, 12.1 links
black spruce 4" N74°E, 22.3 links
black spruce 6" N8°W, 61.8 links
tamarack 4" S38°E, 35 links
all scribed 1/4 BT.

Corner sets in a large black spruce swamp.

T37N
R 11 24 + 19 12
E E
S498-1978

Dated at Rhineland, Wis., this 28th day of February, 1978

Signature Philip T. Hansen Title Registered Land Surveyor Registration No. S-498
(County Surveyor, Registered Land Surveyor, or other duly authorized official)

Office of Register of Deeds, County of Forest, I hereby certify that the within instrument was filed in this office for record on the 15th day of March, 1978 at 1:15 o'clock P. M.

EUGENE STATEZNY
(Register of Deeds)

DOCUMENT NUMBER 113437

By Eileen Schmitt Deputy

FORM 985 H. C. MILLER CO., MILWAUKEE

43711242000

CERTIFIED LAND CORNER RESTORATION

Index No. P-1

State of Wisconsin }
County of Forest } ss.

I Philip T. Hansen, do hereby certify that on the 14th day of February, 19 78, I found evidence of the Quarter corner of Sections 24 & 19 Township 37, North, Range 11 & 12 East, Fourth Principal Meridian, as described hereon; and that from this evidence I established a new monument and accessories as described hereon to perpetuate the original location of this corner.

Resident witnesses:

Glen Barker

Jim Claflin

Herb Wagoner

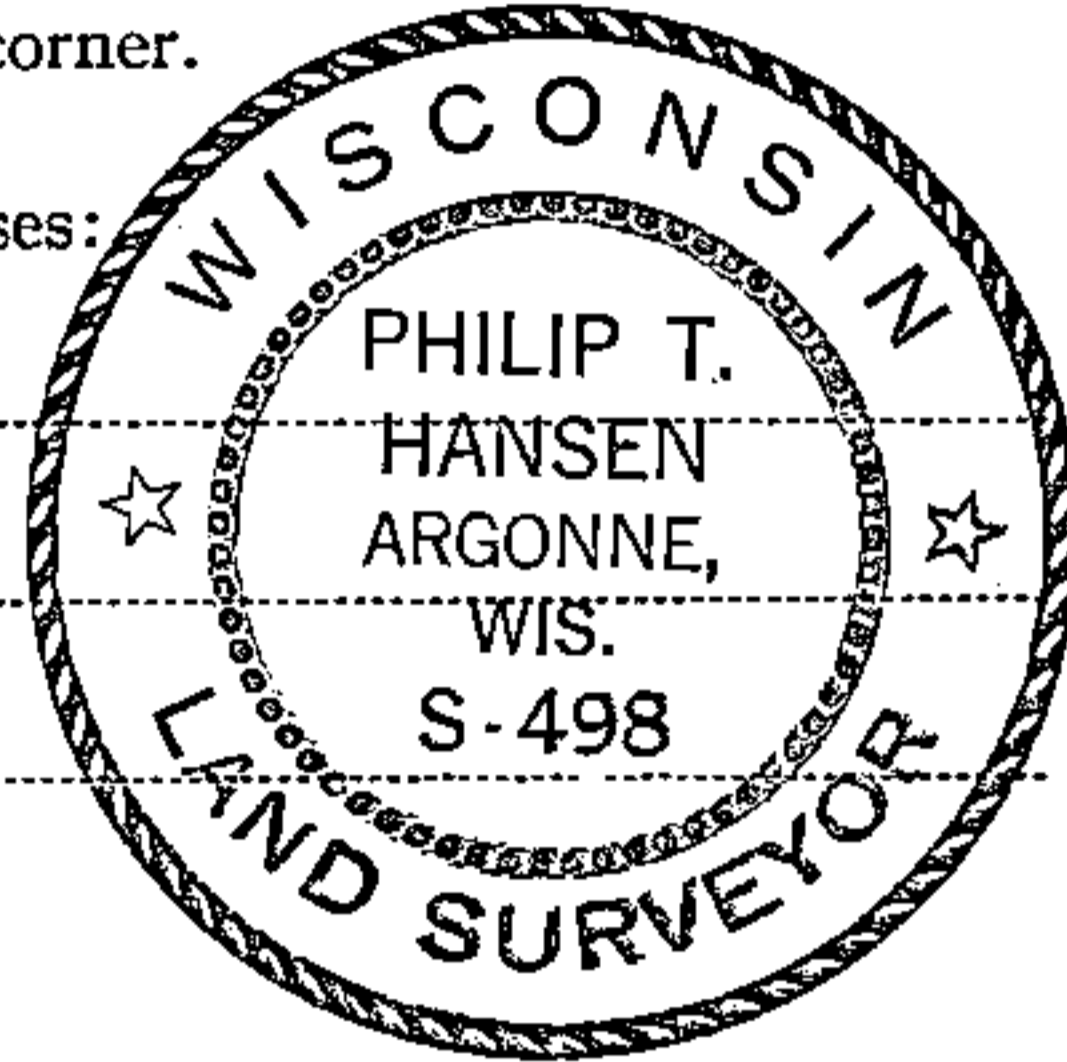

T37N R12E

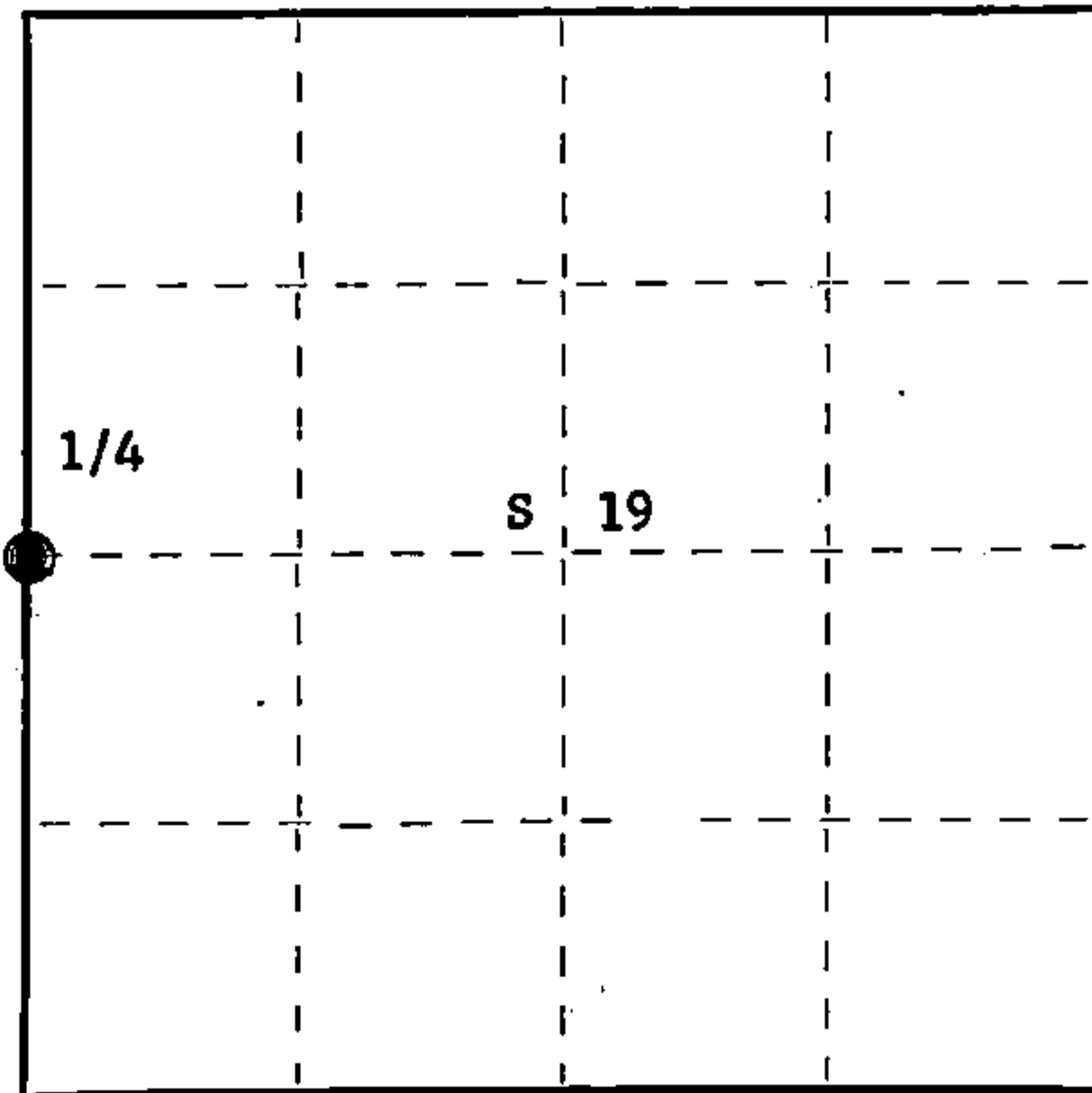

○ = Corner monument restored.

History of original corner establishment:

Corner established by Alfred Miller, Deputy Surveyor, in 1858, from which spruce 8" bears N20°W, 18 links and spruce 5" bears S45°E, 12 links.

Corner recovered by V.M. Maine, County Surveyor, set new post and marked NBT's - Spruce 6" N58° 50' W, 16 links and spruce 6" N76° 50' W, 07 links.

Description of corner evidence found:

Recovered Maine's 6" spruce BT N 58° 50' W, 16 links, now a 2' high stump. Searched for but unable to recover his post or point of same. No evidence of the spruce 6" S76° 50' W 7 links.

There is a 7" black spruce with beaver blazes facing the corner position.

Description of monument and accessories I established to perpetuate the original location of this corner.

Set 2 1/2" A-1 Federal Monument at point S 58° 50' E - 16 links from recovered BT. Monument projects 8" above ground. Cap stamped: Marked NBT's - black spruce 7" S78°W, 12.1 links
black spruce 4" N74°E, 22.3 links
black spruce 6" N8°W, 61.8 links
tamarack 4" S38°E, 35 links
all scribed 1/4 BT.

Corner sets in a large black spruce swamp.

R T37N R
11 24 19 12
E S498-1978 E

Dated at Rhineland, Wis., this 28th day of February, 19 78

Signature Philip T. Hansen Title Registered Land Surveyor Registration No. S-498
(County Surveyor, Registered Land Surveyor, or other duly authorized official)

Office of Register of Deeds, County of Forest, I hereby certify that the within instrument was filed in this office for record on the 13th day of November, 19 79 at 8:30 o'clock A. M.

Eugene Staszny
(Register of Deeds)

By _____ Deputy

DOCUMENT NO. **117080**

FORM 985 H. C. MILLER CO., MILWAUKEE

43711242000