

CERTIFIED LAND CORNER RESTORATION

Index No. L-1

State of Wisconsin }
County of Forest } ss.

I Philip T. Hansen, do hereby certify that on the 2nd day of August, 1976, I found evidence of the Quarter corner of Sec. 13 and 18 Township 37, North, Range 12 East, Fourth Principal Meridian, as described hereon; and that from this evidence I established a new monument and accessories as described hereon to perpetuate the original location of this corner.

Resident witnesses:

Glen Barker

Jim Glaflin

Herb Wagoner

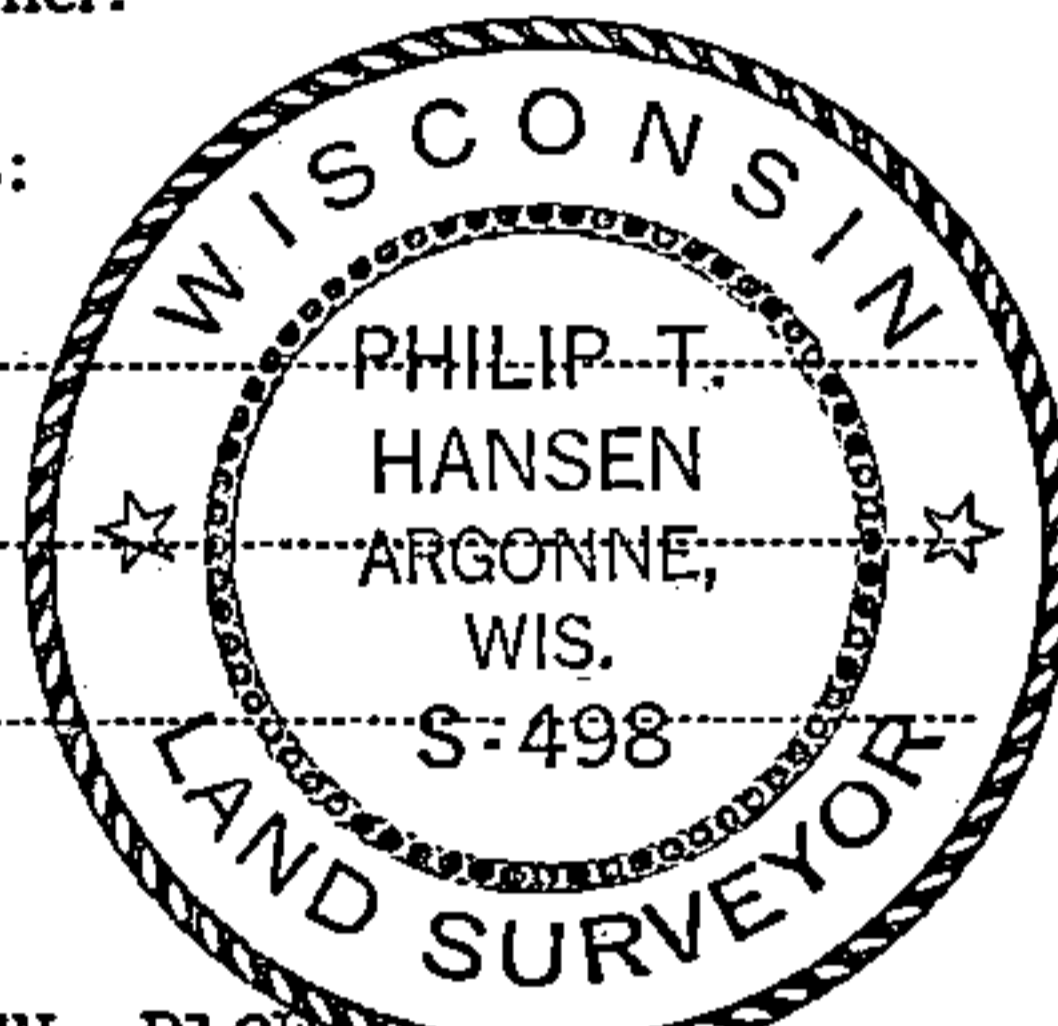

T37N RL2E

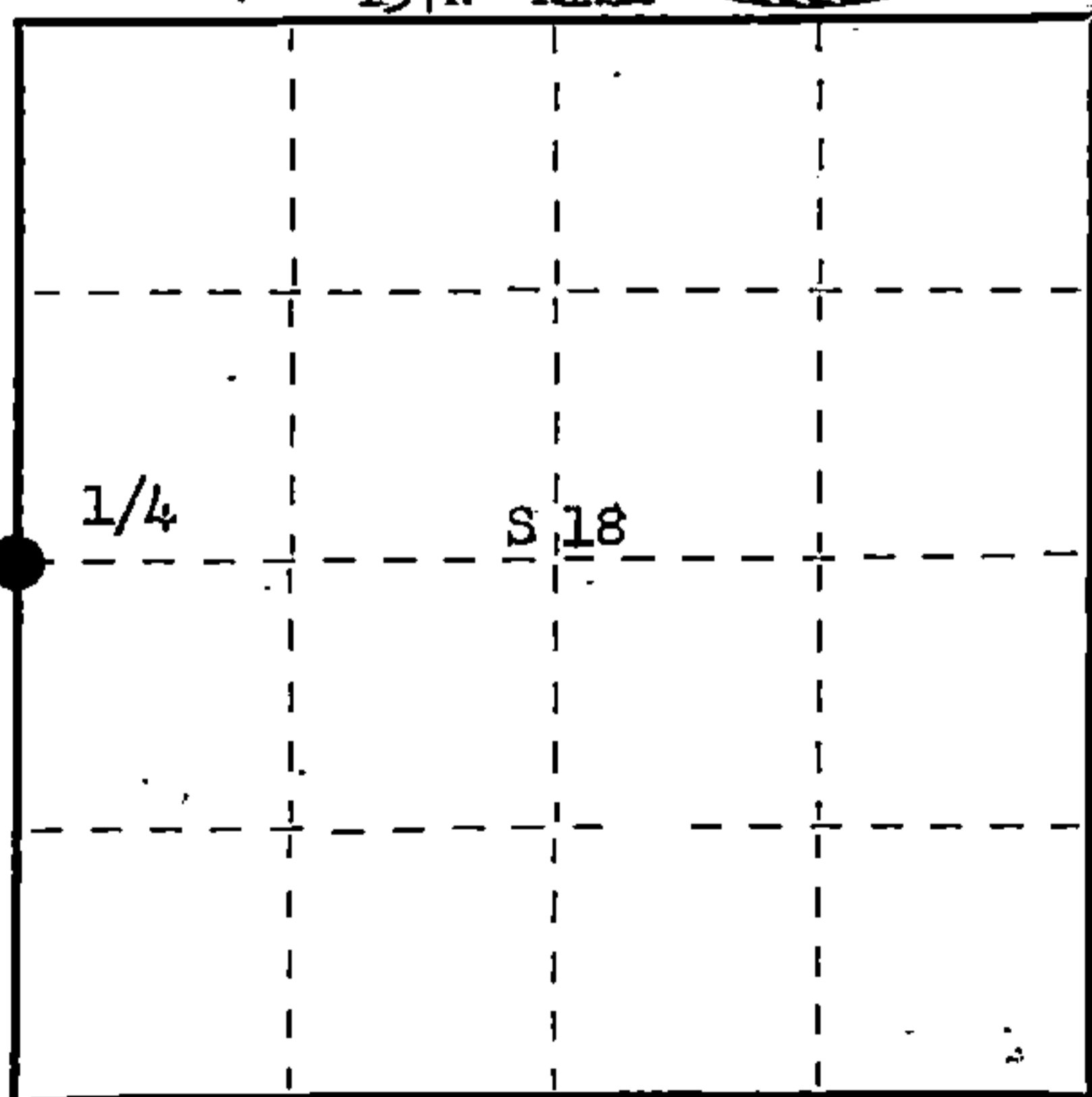

○ = Corner monument restored.

History of original corner establishment: Original Corner established by Alfred Millard, Deputy Surveyor, in 1857, from which White Pine 12" bears N 16° W 43 lks and Tamarack 10" bears S 71° E 8 lks.
Corner recovered by J.J. Melendy, in 1918. Recovered old post and original W.Pine BT. Tamarack was gone. Set new corner post and marked NBTs - Birch 9" S 71° W 22 lks and Birch 10" S 81° E 38 lks.
Corner recovered by V.M. Maine, County Surveyor, Oneida County. Recovered post, stump of original W.Pine BT and Melendy's BTs. Set new iron pipe with brass cap.
Corner recovered Maine's iron pipe and Melendy's post. Upon digging found point of original stake. Set new post, checked to Melendy's BTs.
Description of corner evidence found:
Recovered Melendy's old post laying down, Lawrence's squared and scribed 4" cedar post scribed 1/4S S13 RL1E, 1/4S S18 RL2E, also laying down.
Recovered Maine's iron pipe with brass cap standing in good condition, although not set in ground very deep. Cap stamped T37N RL1 Sec.13/S18 1/4.
Recovered OBT - W.Pine 12" N 16° W 43 lks.
Recovered Melendy's BT - Birch 10" (12") S 81° E 38 lks, scribed 1/4S S18.
Birch 9" S 71° W 22 lks, down and decayed.

Description of monument and accessories I established to perpetuate the original location of this corner. As iron pipe was not set very deep, it was extracted from ground and reset to project 24" above ground. Restamped brass cap.
NBT - Cedar 6" N 46° E 48.6 lks, scribed 1/4 BT.
Hemlock 8" S 37° E 15.7 lks, scribed 1/4 BT.
Hemlock 6" N 18° E 45.5 lks, scribed 1/4 BT.
Corner is 5 chains south of E-W logging road.
Monument and BTs painted blue.

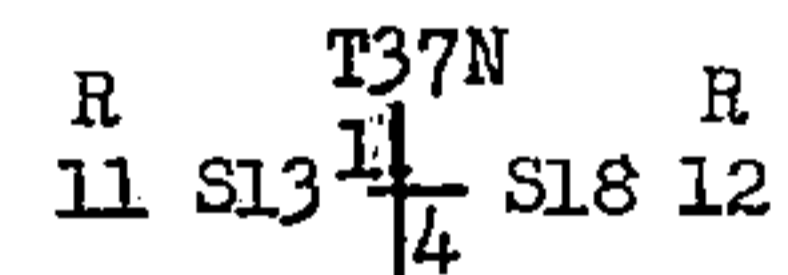

Dated at Rhineland, Wis., this 10th day of August, 1976

Signature Philip T. Hansen Title Registered Land Surveyor Registration No. S-498
(County Surveyor, Registered Land Surveyor, or other duly authorized official)

Office of Register of Deeds, County of Forest, I hereby certify that the within instrument was filed in this office for record on the 8th day of September, 1976 at 10 o'clock A. M.

Eugene Staszny
(Register of Deeds)
By.....Deputy

DOCUMENT NUMBER
110101

FORM 985 H. G. MILLER CO., MILWAUKEE

43711132000