

CERTIFIED LAND CORNER RESTORATION

Index No. N-1

State of Wisconsin }
County of Forest } ss.

I Philip T. Hansen, do hereby certify that on the 8th day of August, 1976, I found evidence of the Section corner of Sec. 13, 18, 24, 19 Township 37, North, Range 11 & 12 East, Fourth Principal Meridian, as described hereon; and that from this evidence I established a new monument and accessories as described hereon to perpetuate the original location of this corner.

Resident witnesses:

Glen Barker

Jim Clafin

Herb Wagoner

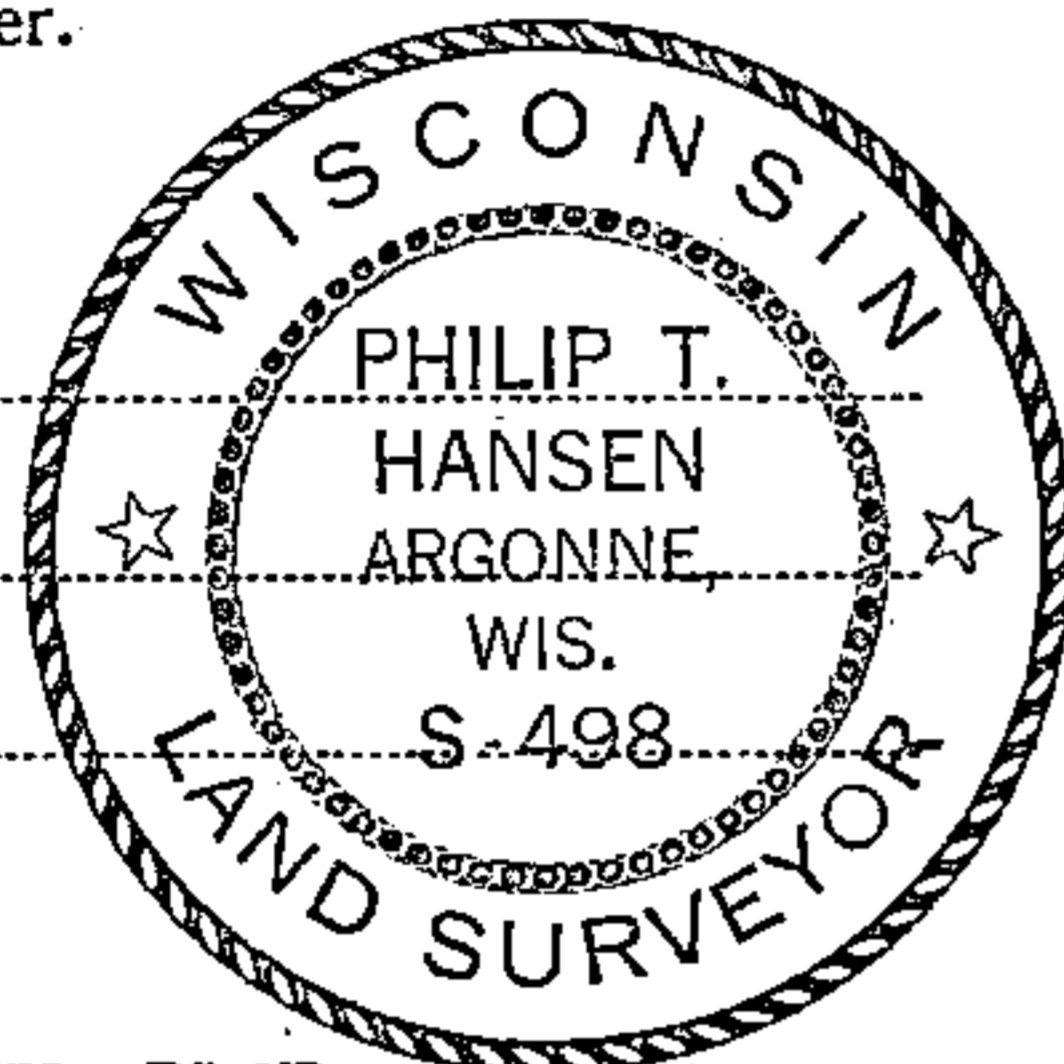

FORM 985 H. C. MILLER CO., MILWAUKEE

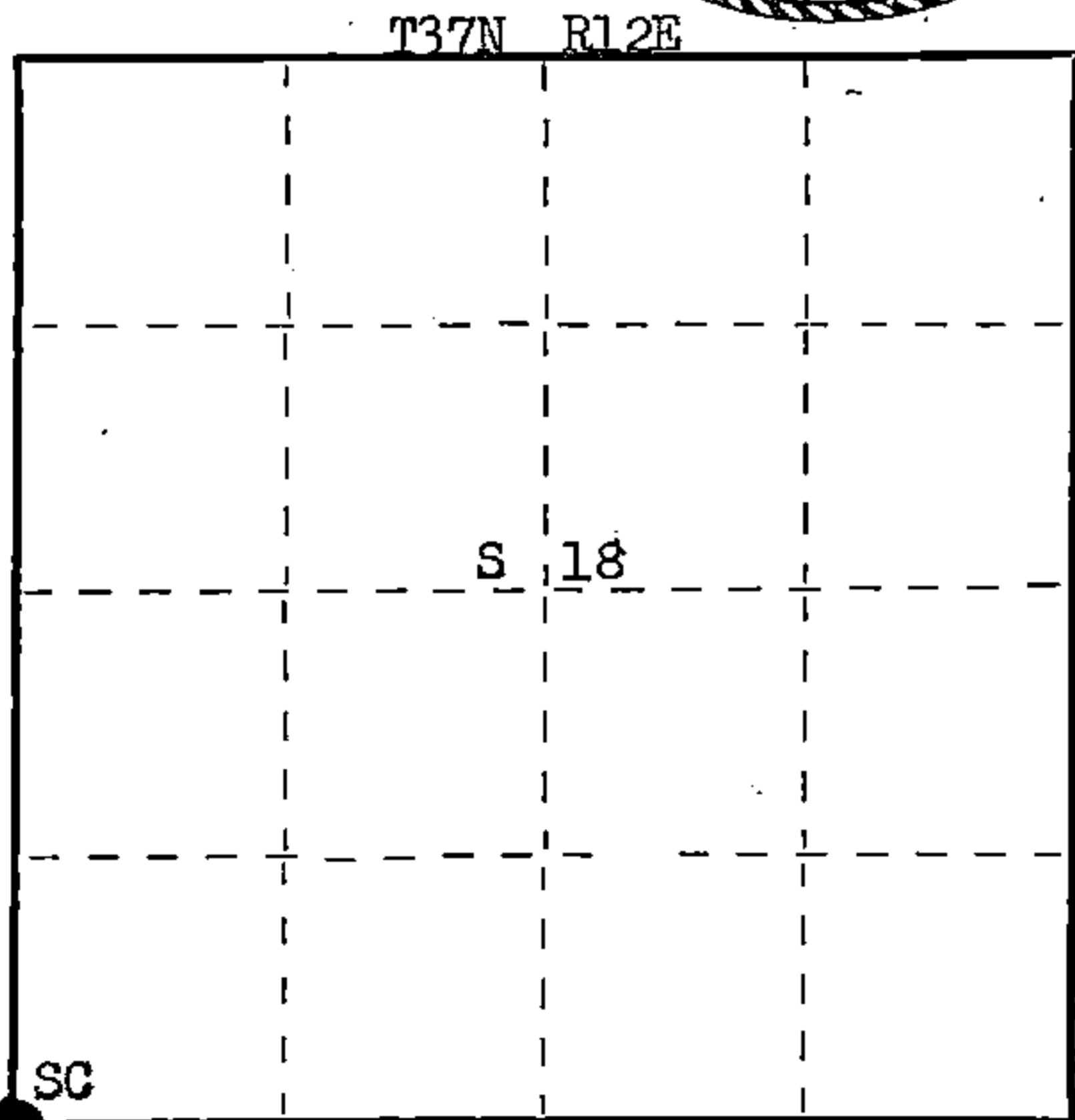

○ = Corner monument restored.

History of original corner establishment: Original Corner established by Alfred Millard, Deputy Surveyor, in 1857, from which Cedar 6" bears N 55° W 23 lks, Spruce 10" bears N 61° E 46 lks, Spruce 10" bears S 69° E 16 lks and Tamarack 12" bears S 20° W 8 lks. Corner recovered by V.M. Maine, County Surveyor, Oneida County. Found scribed post, mutilated some, original bearing tree, green and standing, Cedar 6" N 55° W 23 lks and stump of Tamarack 12" S 20° W 8 lks. Set 2 1/2" iron pipe with brass cap and marked NBTs - Cedar 7" S 36° W 14 lks, Cedar 8" N 74° W 53 lks, Cedar 4" N 70° E 21 1/2 lks. Corner recovered by H.C. Lawrence, Registered Land Surveyor, in 1948. Found Maine's iron pipe and original 6" cedar and stump of tamarack 12" S 20° W 8 lks.

Description of corner evidence found:

Recovered 2 1/2" iron pipe with brass cap stamped. Monument projects 18" above ground. Recovered original Cedar BT 6" (14") N 55° W 23 lks. Cedar 7" (10") S 36° W (S 46° W) 14 lks, scribe marks visible. Cedar 8" (10") N 74° W 53 lks (54 lks), scribed S13 BT. Cedar 4" N 70° E 21.5 lks.

T37
R S13 | S18 R
11 S24 | S19 12

Recovered H.C. Lawrence's cedar post, squared and scribed S13, S18, S19, S24 in fair condition 4 lks from iron pipe.

Description of monument and accessories I established to perpetuate the original location of this corner.

As Maine's iron pipe was in excellent condition and checked out the calls to original cedar BT, it was left as found. Propped Lawrence's wood post next to Maine's iron pipe. NBTs - Cedar 6" S 66° W 49.7 lks, scribed SC BT. Cedar 8" S 9° W 59 lks, scribed SC BT. Monument and BTs painted blue.

Dated at Rhineland, Wis., this 10th day of August, 19 76

Signature Philip T. Hansen Title Registered Land Surveyor Registration No. S-498
(County Surveyor, Registered Land Surveyor, or other duly authorized official)

Office of Register of Deeds, County of Forest, I hereby certify that the within instrument was filed in this office for record on the 8TH day of September, 19 76 at 10 o'clock A. M.

Eugene Staszny
(Register of Deeds)
By _____ Deputy

DOCUMENT NUMBER
110102

43711130000

U.S. PUBLIC LAND SURVEY MONUMENT RECORD

Index No. N-1

State of Wisconsin }
 County of FOREST } ss.

I, John C. Schulke, do hereby certify that on the Nineth day of October, 1986, I found evidence of the Southwest Section corner of Section 18, Township thirty-seven, North, Range twelve East, Fourth Principal Meridian, as described hereon; and that from this evidence I established a new monument and accessories as described hereon to perpetuate the original location of this corner.

Resident witnesses:

History of original corner establishment:

Original corner established in 1858 by Alfred Millard, U.S. Deputy Surveyor

Set a wooden post with the following bearing trees:

Cedar	6"	N55°W	23 lks.
Spruce	10"	N61°E	46 lks.
Spruce	10"	S69°E	16 lks.
Tamarack	12"	S20°W	8 lks.

Description of corner evidence found:

For history of recoveries on the Certified Land Corner Restoration form done by Philip T. Hansen (S-498), dated Sept. 1976. Document #110102.

Found a 2" iron pipe with a brass cap. Recovered the following bearing trees:

Cedar	9"	S66°W	32.9 ft.
Cedar	21"	N55°W	15.82 ft.
Cedar	15"	S46°W	9.7 ft.
Cedar	12"	S09°W	39.12 ft.
Cedar	16"	N74°W	36.02 ft.
Cedar	20"	N70°E	14.42 ft.

Cedar 19" S41°W 13.45 ft. Cedar 10" S37°W 15.35 ft.

Description of monument and accessories I established to perpetuate the original location of this corner.

Set steel sign post Northeast a distance of 0.8 ft. Painted and tagged the first six of the above bearing trees.

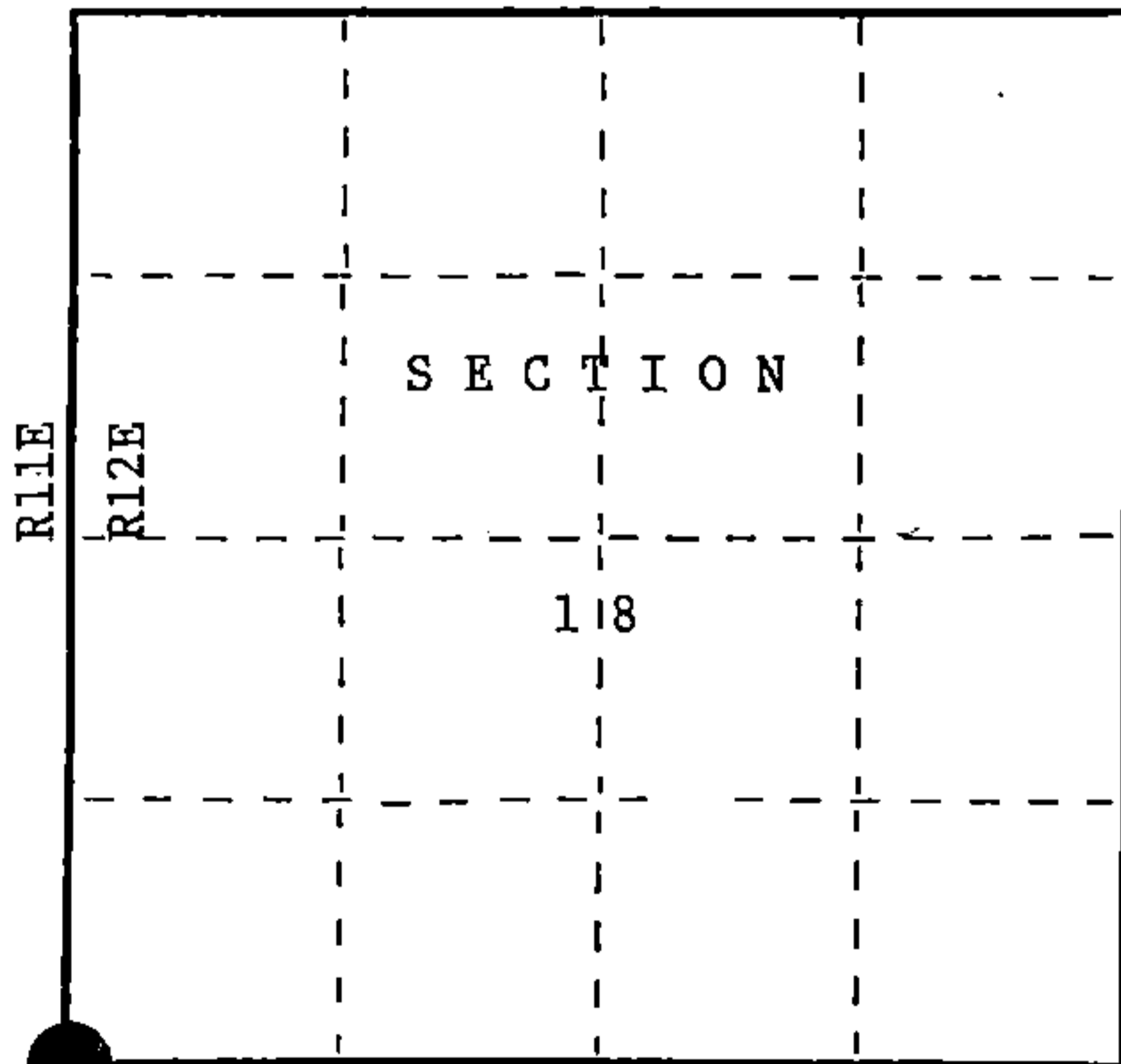

○ = Corner monument restored.

Dated at Hiles, Wisconsin, this Eleventh day of November, 1987

Signature John C. Schulke Title Land Surveyor Registration No. S-1665
 (County Surveyor, Registered Land Surveyor, or other duly authorized official)

Office of Register of Deeds, County of Forest, I hereby certify that the within instrument was filed in this office for record on the 2nd day of February, 1988 at 9:40 o'clock A.M.

Paul Ackenhauer
 (Register of Deeds)

By _____ Deputy

FORM NO. 985-A

H.C. Miller Company

Stock No. 26273

DOCUMENT NUMBER 134569

43711130000
87-12

(e) Describe any material discrepancy between the location of the corner as restored or reestablished and the location of that corner as previously restored or reestablished by distance and direction. Show the discrepancy on the plan view drawing under (d), above. Show the distances between the corner as previously restored or reestablished and (1) the corner as restored or reestablished, and (2) to at least 2 of the witness monuments shown on the drawing in (d), above.

No discrepancy, accepted existing corner monument.

(f) Was the corner restored through acceptance of (1) an obliterated evidence location, or, (2) a found perpetuated location?

The corner was restored through acceptance of a found perpetuated location.

(g&h) Was the corner reestablished through lost corner proportionate methods? If so, show the method, including the directions and distances to other public land survey corners used as evidence or used for proportioning in determining the corner location?

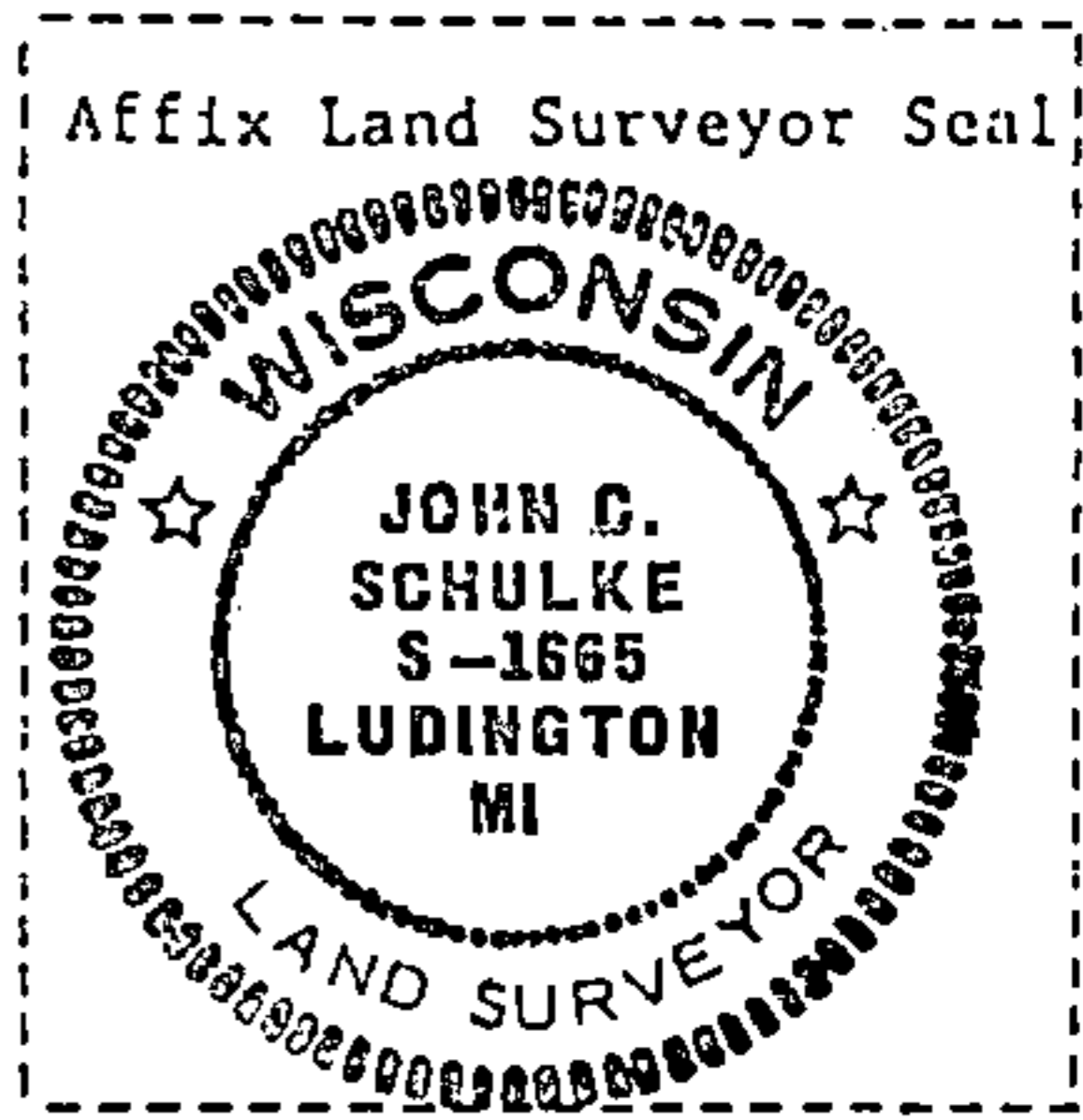
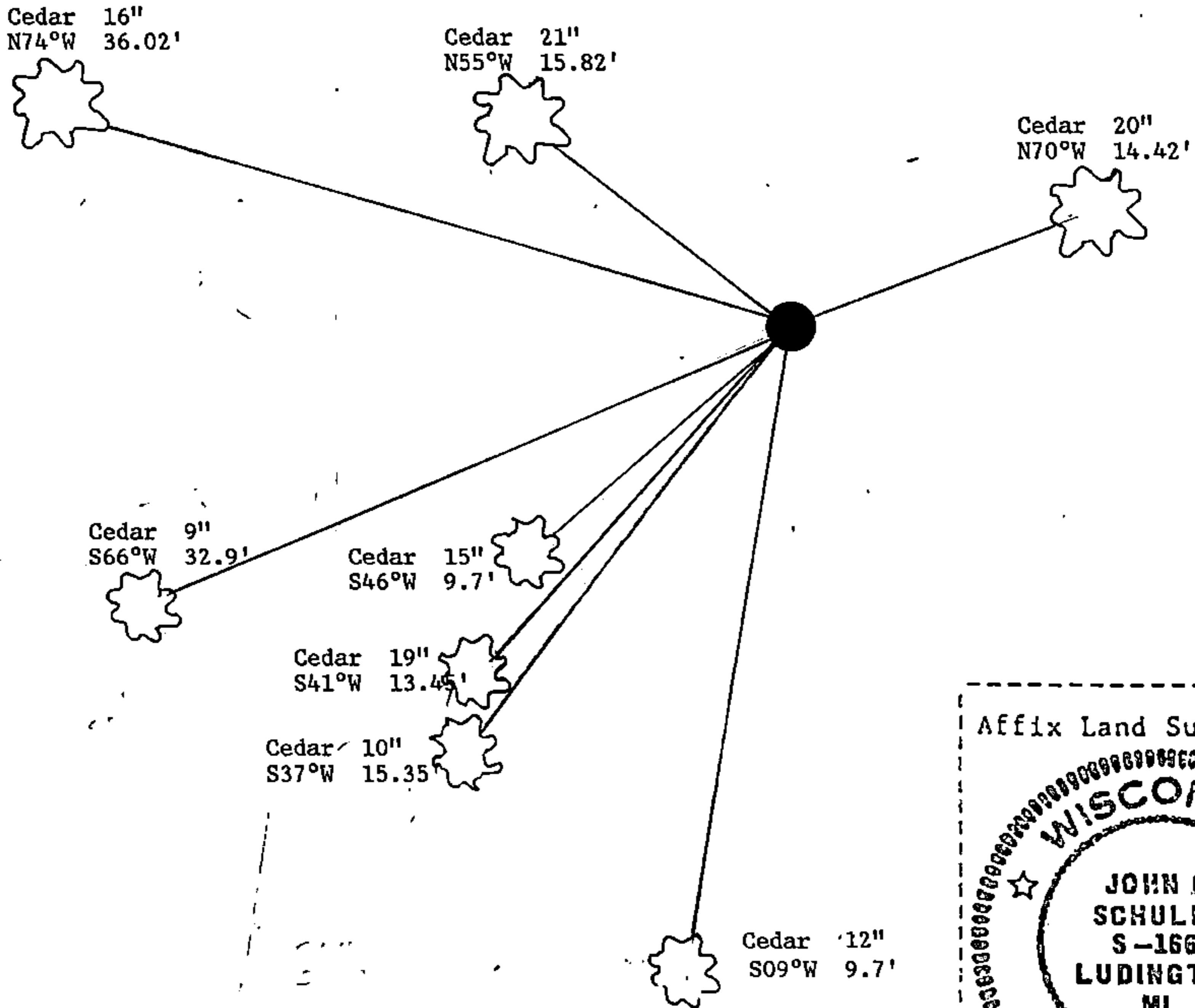

(i) I, John C. Schulke
 (type or print name) certify that the corner location shown on this record was determined by me or under my direction and control and that this U.S. Public Land Survey Monument Record is correct and complete to the best of my knowledge and belief.

John C. Schulke _____ Nov 11, 1987
 Signature Date

Survey requested by: Dale S. Staeger _____ 2/1/88
 District Ranger Date