

Document Number

195028

REGISTER'S OFFICE  
Forest County, Wis.  
Received for record this 6 day  
of August A.D., 2007 at  
2:35 o'clock P.M. and recorded  
in Vol. Corner Restoration  
page V-5

Kay Swanson, Deputy  
Register of Deeds

U.S. PUBLIC LAND SURVEY MONUMENT RECORD

(As Required by WI Adm. Code)

History of original corner establishment and subsequent restorations and descriptions of any record, monument, occupational, testimonial or other evidence considered:

1859 - James McBride, set corner section post and made the following B.T.'s:

- Birch, 12", N 80° W, 40 lks., 26.40 feet.
- Birch, 8", N 10° E, 30 lks., 19.80 feet.
- Hemlock, 12", S 38° E, 42 lks., 27.72 feet.
- Hemlock, 20", S 54° W, 20 lks., 13.20 feet.

1992 - Thomas R. Arnott, R.L.S., found and used corner for Certified Survey Map Vol.4-pg.159.

1996 - Norman A. Harrison, R.L.S., found and used corner calling an Existing Iron Pipe.

2007 - I found a 1" x 50" Iron Pipe marking the section corner. I accepted this position as the best available evidence of the corner position. I replaced Iron Pipe with a 2" x 30" Forest County Aluminum Pipe Monument.

Corner was: (Check All That Apply)

- Restored through acceptance of an obliterated evidence location.
- Restored through acceptance of a found perpetuated location.
- Considered a lost corner and reestablished through lost corner proportionate methods (include a plan view drawing showing distances and directions to other Public Land Survey Corners used for proportioning and determining the corner location).
- Restored or reestablished in a location that differs from a previous restoration or reestablishment (include a plan view drawing and indicate what was set and/or found).

Describe the monument and accessories used to perpetuate the location of this corner (include a plan view drawing and indicate what was set and/or found).

LEGEND:

2" x 30" Forest County Aluminum Pipe Monument Set

Note: All distances are taken to nail in side of tree.

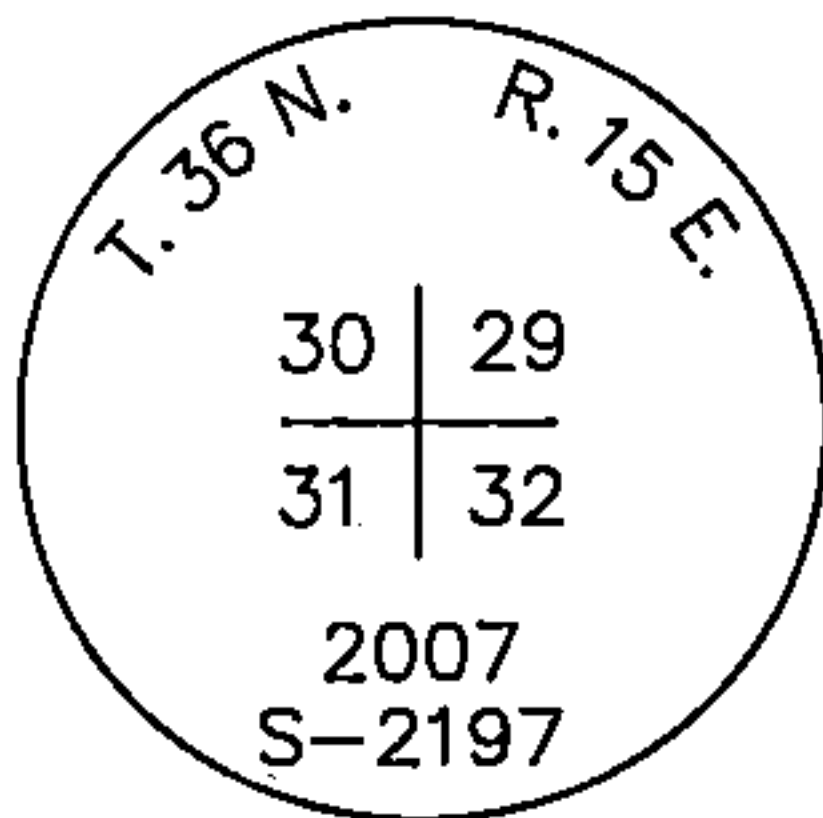

Monument Detail

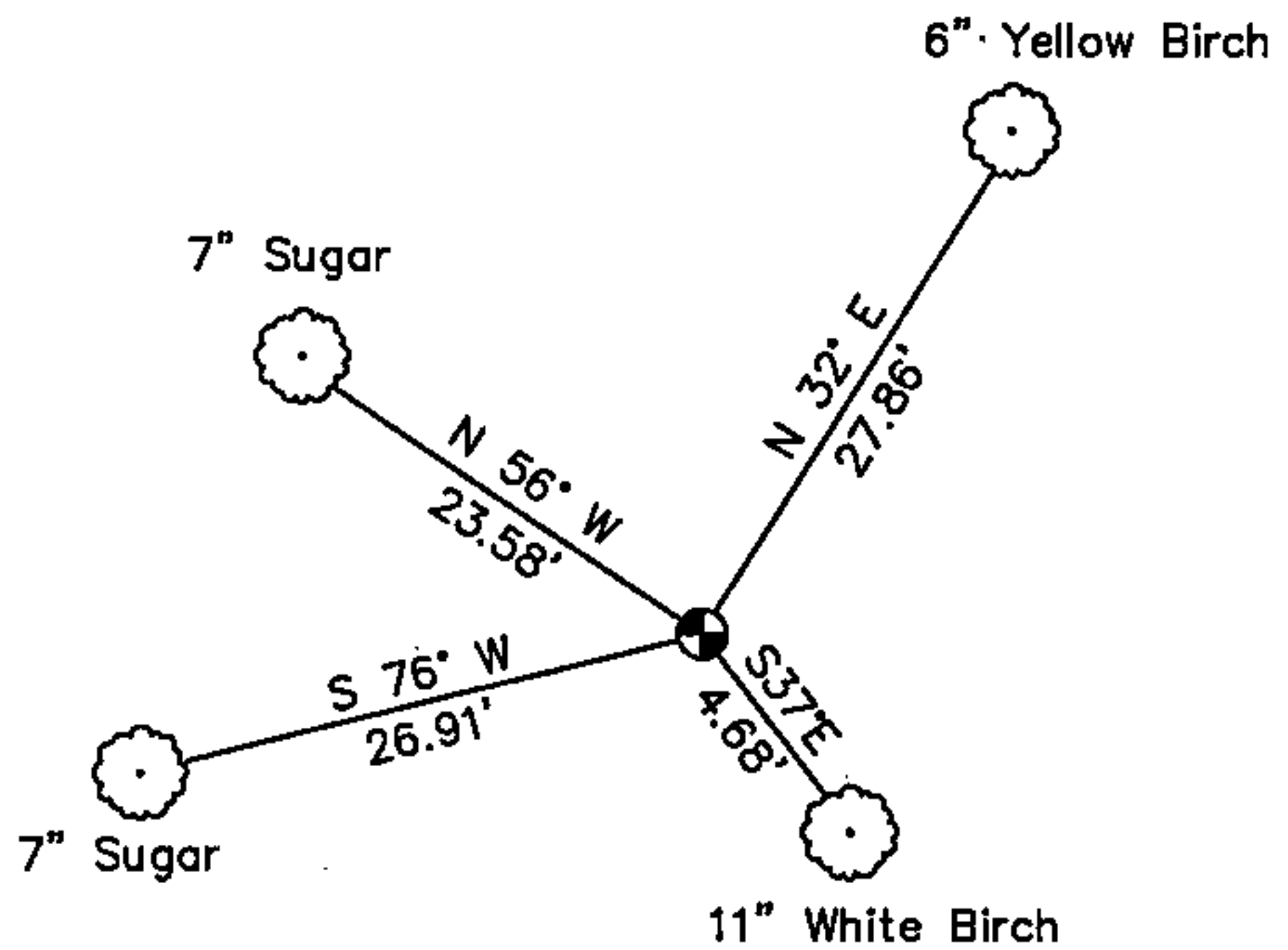

Sketch Not To Scale

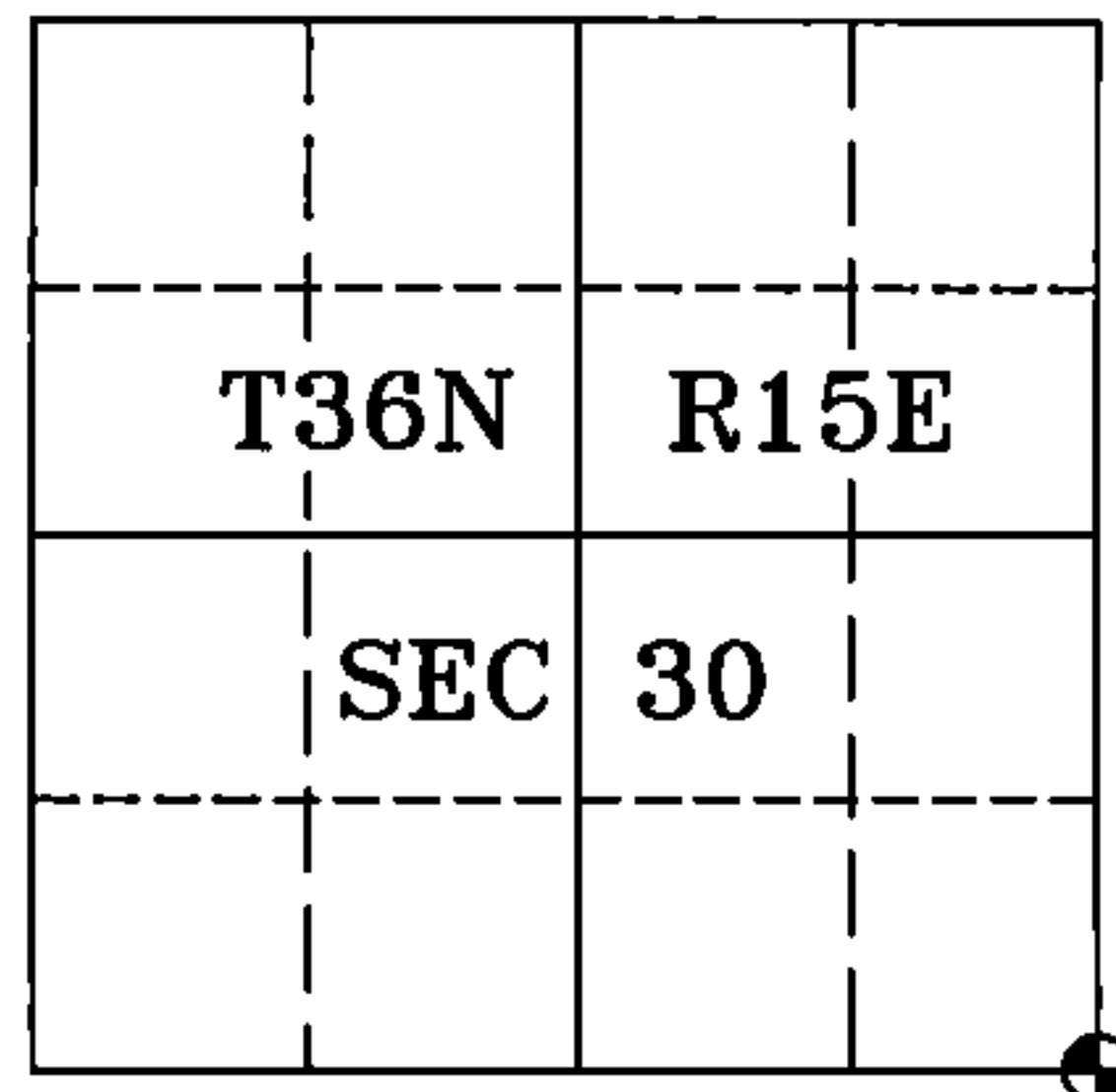
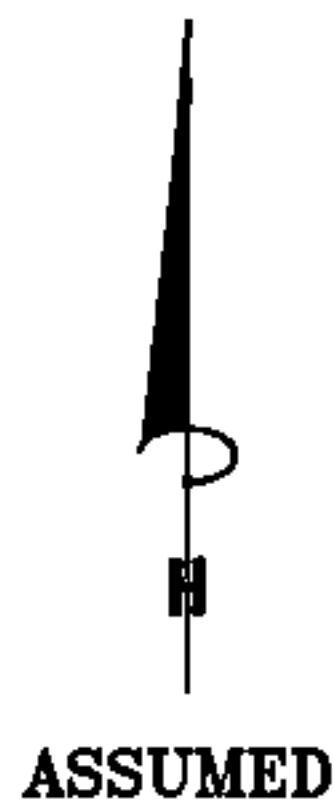
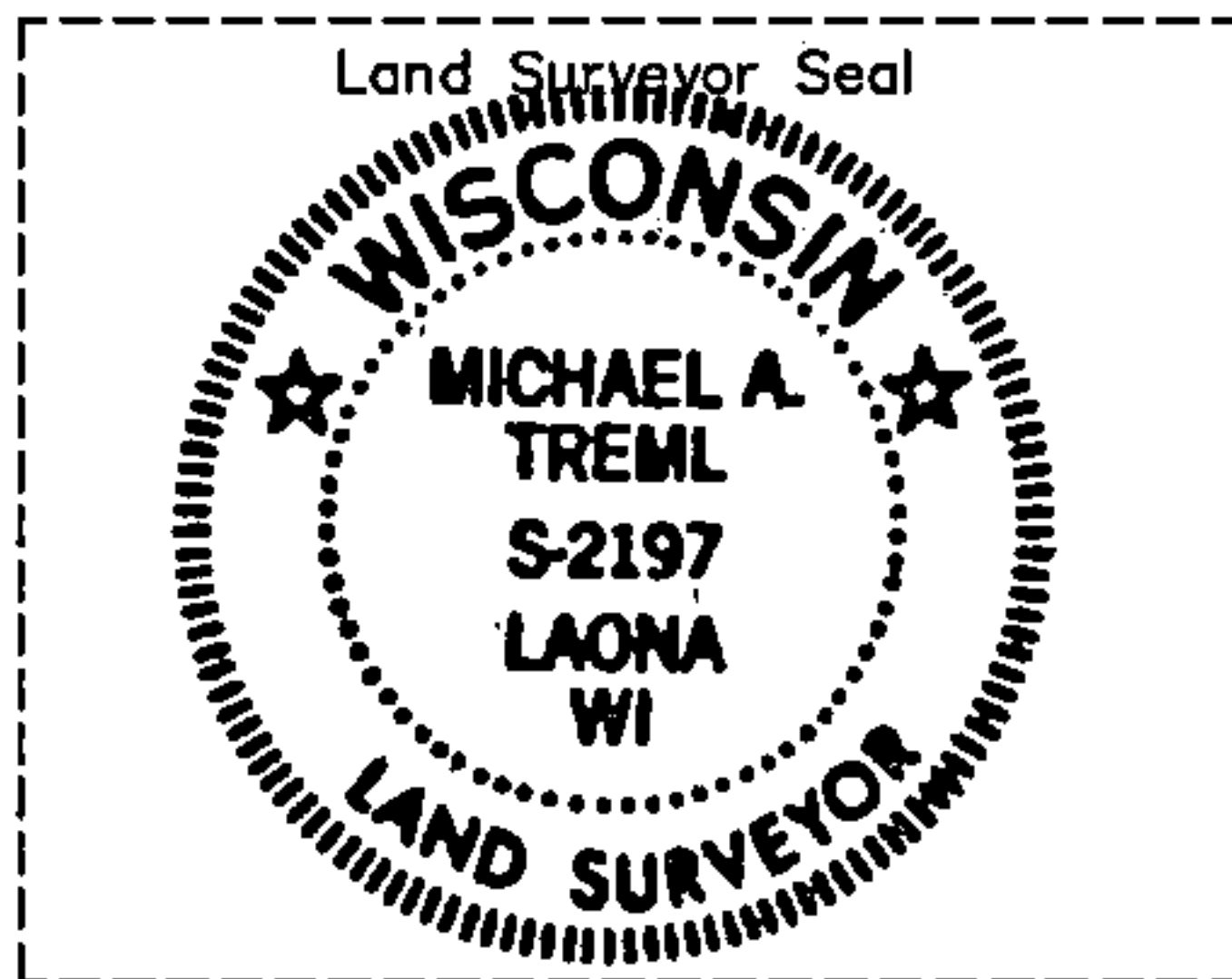

I, Michael A. Trembl, RLS (type or print name) certify that the corner location shown on this record was determined by me or under my direction and control and that this U.S. Public Land Survey Monument Record is correct and complete to the best of my knowledge and belief.

Michael A Trembl 7/10/07  
Signature Date

The South East corner of Section 30 T. 36 N., R. 15 E. Forest County, WI

Index No. V-5  
2007