

CERTIFIED LAND CORNER RESTORATION

State of Wisconsin }  
County of Forest } ss.

I William B. Cochrane, do hereby certify that on the 21st day of April, 1980, I found evidence of the Southeast Section corner of Section 26 Township 36 North, Range 15 East, Fourth Principal Meridian, as described hereon; and that from this evidence I established a new monument and accessories as described hereon to perpetuate the original location of this corner:

Description of original monument and accessories and subsequent restorations:

Surveyed in 1859 by James McBride.  
North between Sections 35 and 36, 80.00 chains set corner to Sections 25, 26, 35 and 36.  
Birch, 12 inches, N20W, 7 links  
Hemlock, 15 inches, N77E, 44 links  
Birch, 10 inches, S26E, 15 links  
Sugar, 14 inches, S37W, 22 links.

Description of corner evidence found:

1 1/2 inch iron pipe in a mound of rock and a squared post next to pipe.  
Yellow Birch snag with old face blaze.  
No scribing because of decay.  
S20E, 7 links from Yellow Birch snag puts corner 1 foot from pipe.  
No evidence of other bearing trees found.

Description of monument and accessories I established to perpetuate the location of this corner:

S20E, 7 links from the Yellow Birch snag, I set a 2 inch inside diameter, galvanized iron pipe, 3 feet long filled with concrete, with a brass cap stamped: T36N, R15E, S25, S26, S35, S36, 1980, S-1107

Blazed and scribed the following new bearing trees:

Maple, 8 inches, N65E, 17.67 feet  
Basswood, 15 inches, S20E, 35.95 feet  
Basswood, 10 inches, S63W, 19.49 feet  
Maple, 14 inches, N17W, 22.54 feet.

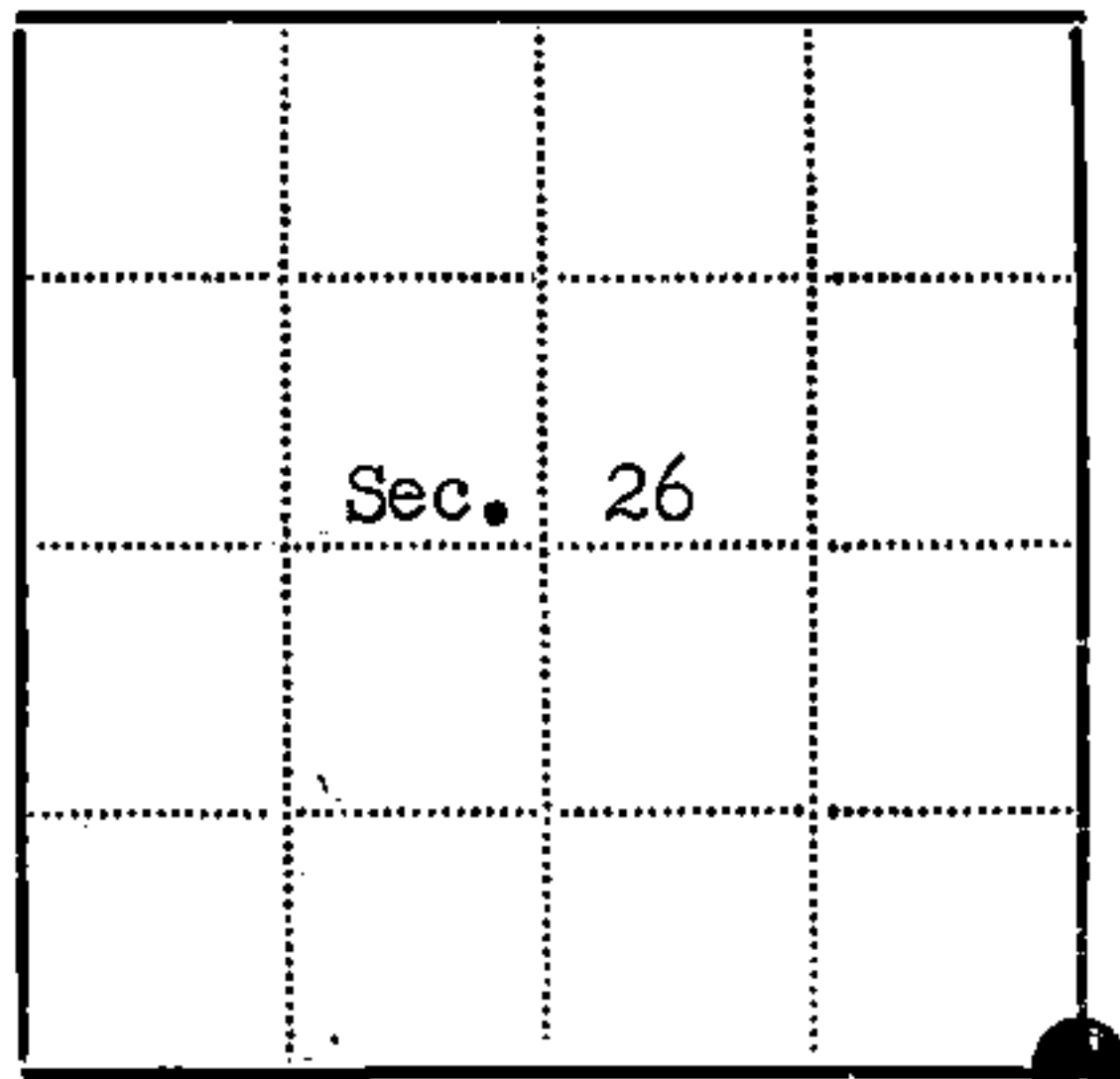
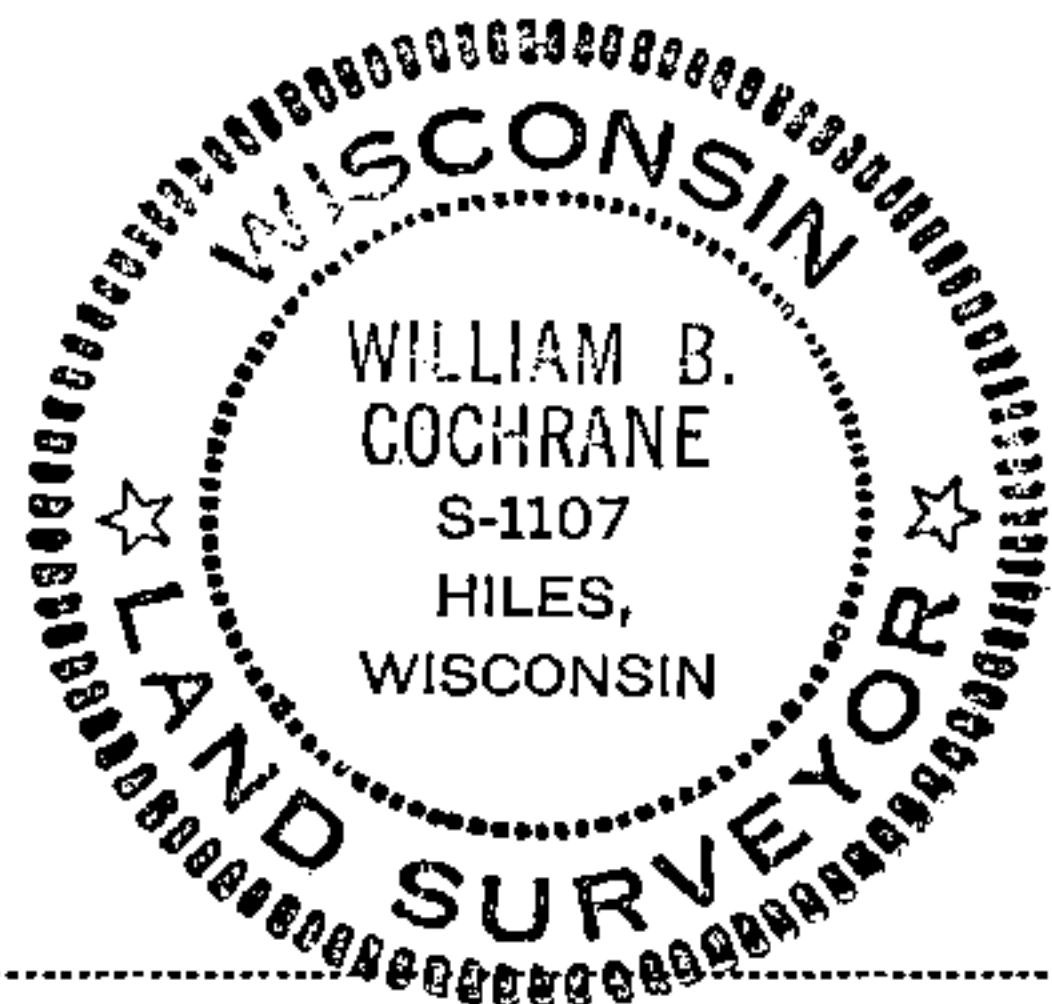

● - Corner monument restored  
□ -

Resident witnesses.....

Dated at Laona, Wisconsin, this 29th day of May, 1980.

Signature William B. Cochrane Title Land Surveyor  
(County Surveyor, Registered Land Surveyor, or other duly authorized official)

Surveyors Registration No. S-1107 DOCUMENT NO. 118082

Office of Register of Deeds County of Forest

I hereby certify that the within instrument was filed in this office for record on the 9th day of June, 1980, and was filed in Book No. of County Records.

Signature Sharon Mueller Title Deputy

Township 36 North, Range 15 East, Section 26; Index No. V-21, Page No.

431526 0000

V21