

CERTIFIED LAND CORNER RESTORATION

State of Wisconsin }
 County of Forest } ss.

I William B. Cochrane, do hereby certify that on the 8th day of May, 1980, I found evidence of the North quarter corner of Section 27, Township 36 North, Range 15 East, Fourth Principal Meridian, as described hereon; and that from this evidence I established a new monument and accessories as described hereon to perpetuate the original location of this corner:

Description of original monument and accessories and subsequent restorations:

Surveyed in 1859 by James McBride.
 West corrected between Sections 22 and 27, 39.75 chains set $\frac{1}{4}$ post to sections 22 and 27.
 Hemlock, 8 inches, S6E, 7 links
 Sugar, 15 inches, N54E, 14 links.

Description of corner evidence found:

$1\frac{1}{2}$ inch iron pipe in a mound of rock. Old post alongside of pipe.
 S6E, 7 links, Hemlock stump hole
 N54E, 14 links, Sugar stump hole.

Description of monument and accessories I established to perpetuate the location of this corner:

I replaced the iron pipe with a 2 inch inside diameter, galvanized iron pipe, 3 feet long, filled with concrete, with a brass cap stamped:
 T36N, R15E, $\frac{1}{4}$, S22, S27, 1980, S-1107

Blazed and scribed the following new bearing trees:

Basswood, 10 inches, S79E, 30.89 feet
 Maple, 11 inches, S32W, 37.20 feet.

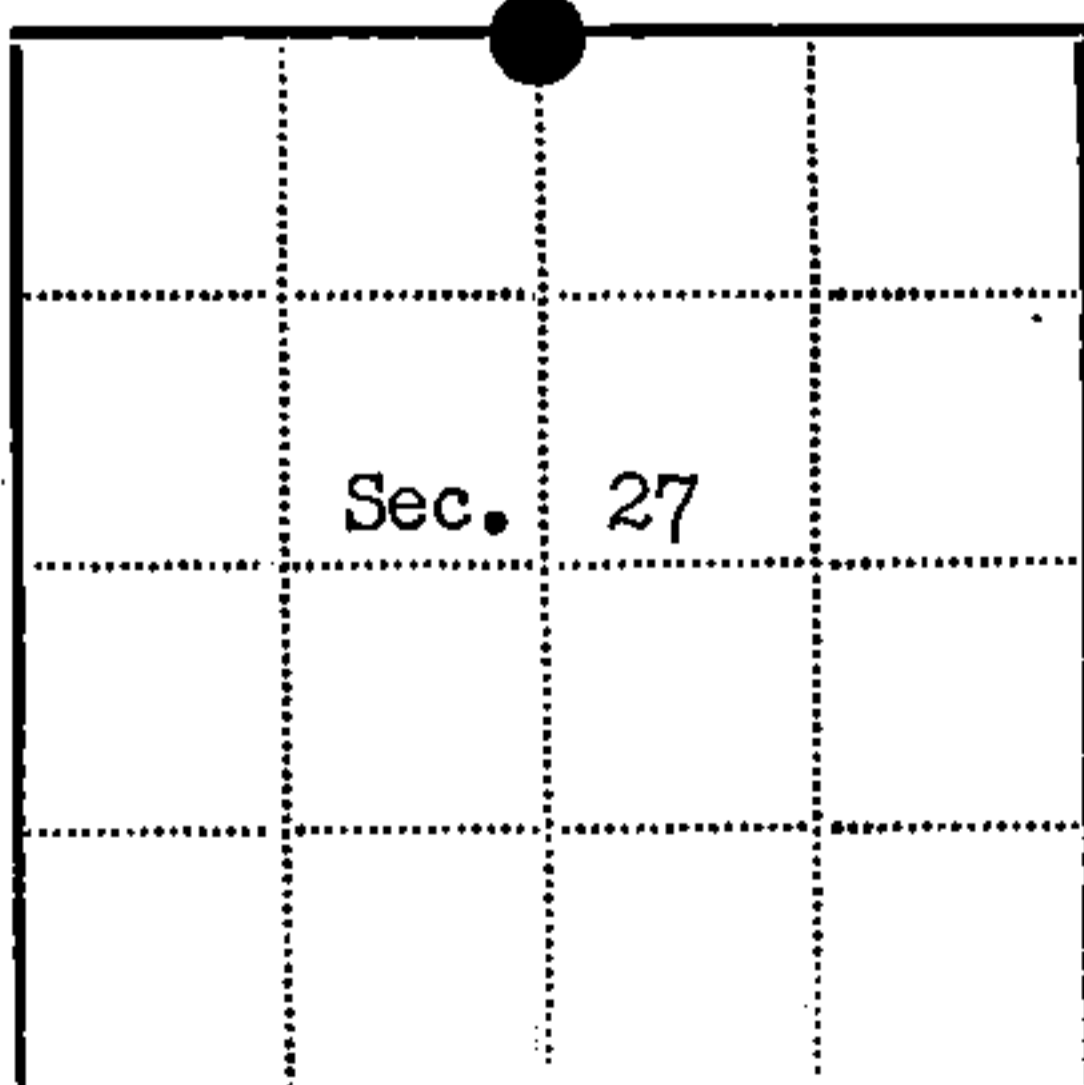
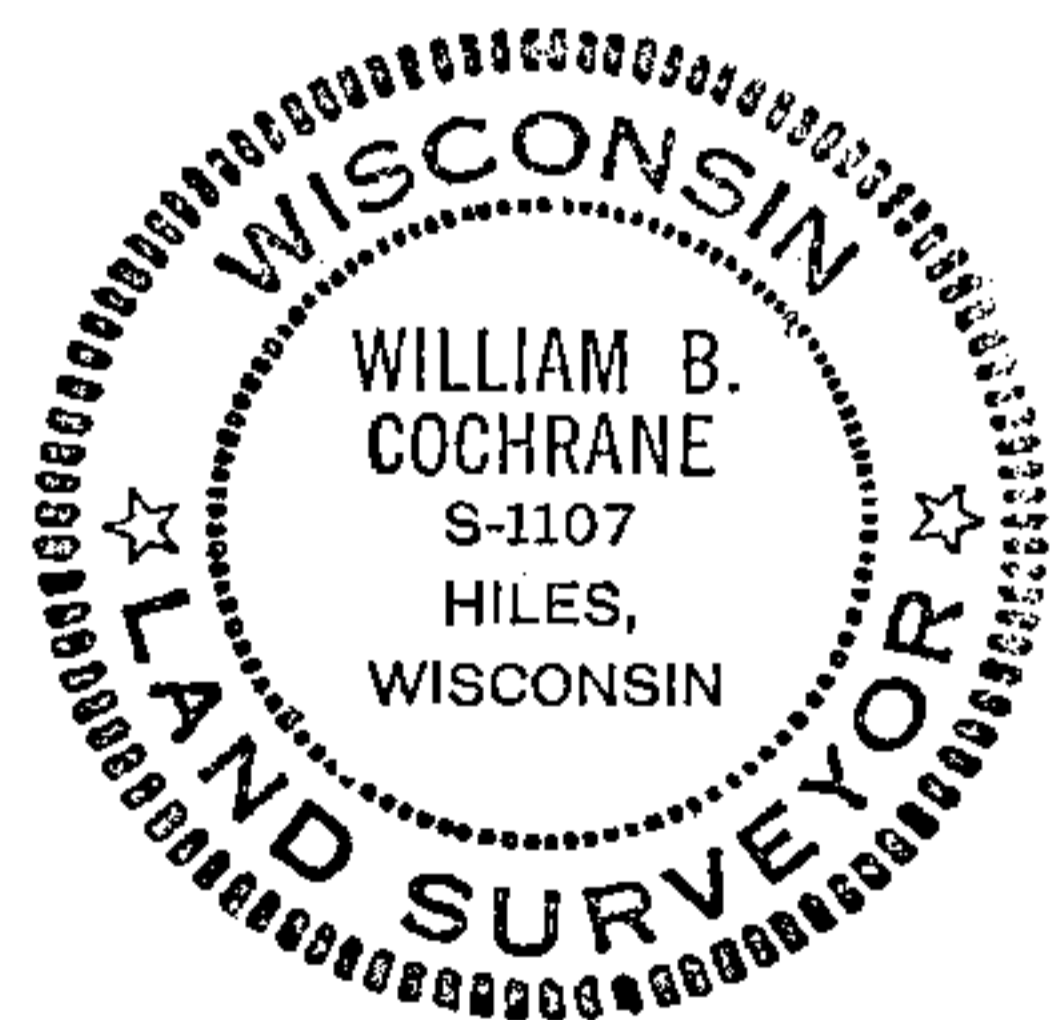

● - Corner monument restored
 □ -

Resident witnesses.....

Dated at Laona Wisconsin, this 28th day of May 1980.

Signature William B. Cochrane Title Land Surveyor
 (County Surveyor, Registered Land Surveyor, or other duly authorized official)

Surveyors Registration No. S-1107 DOCUMENT NO. 118077

Office of Register of Deeds County of Forest

I hereby certify that the within instrument was filed in this office for record on the 9th day of June, 1980, and was filed in Book No. _____ Page No. _____ of County Records.

Signature Sharon Mueller Title Deputy

Township 36 North, Range 15 East, Section 27, Index No. R-15, Page No. _____