

CERTIFIED LAND CORNER RESTORATION

State of Wisconsin }
County of Forest } ss.

I William B. Cochrane, do hereby certify that on the 5th day of May, 1980, I found evidence of the Northwest Section corner of Section 27 Township 36 North, Range 15 East, Fourth Principal Meridian, as described hereon; and that from this evidence I established a new monument and accessories as described hereon to perpetuate the original location of this corner:

Description of original monument and accessories and subsequent restorations:

Surveyed in 1859 by James McBride.
North between Sections 27 and 28, 80.00 chains set post corner to Sections 21, 22, 27 and 28.
Sugar, 10 inches, N22W, 10 links
Sugar, 15 inches, N83E, 24 links
Sugar, 12 inches, S75E, 30 links
Sugar, 15 inches, S17W, 52 links.

Description of corner evidence found:

2 inch iron pipe in a mound of stone. Old post lying next to pipe.
N22W, 10 links, stump hole
N83E, 24 links, stump hole
S17W, 52 links, stump hole.

Description of monument and accessories I established to perpetuate the location of this corner:

I replaced the iron pipe with a 2 inch inside diameter galvanized iron pipe, 3 feet long, filled with concrete with a brass cap stamped:
T36N, R15E, S21, S22, S27, S28, 1980, S-1107

Blazed and scribed the following new bearing trees:
Basswood, 11 inches, S85E, 4.15 feet
Basswood, 9 inches, S37E, 21.38 feet
Maple, 6 inches, S31W, 23.57 feet
Basswood, 11 inches, N62W, 6.89 feet.

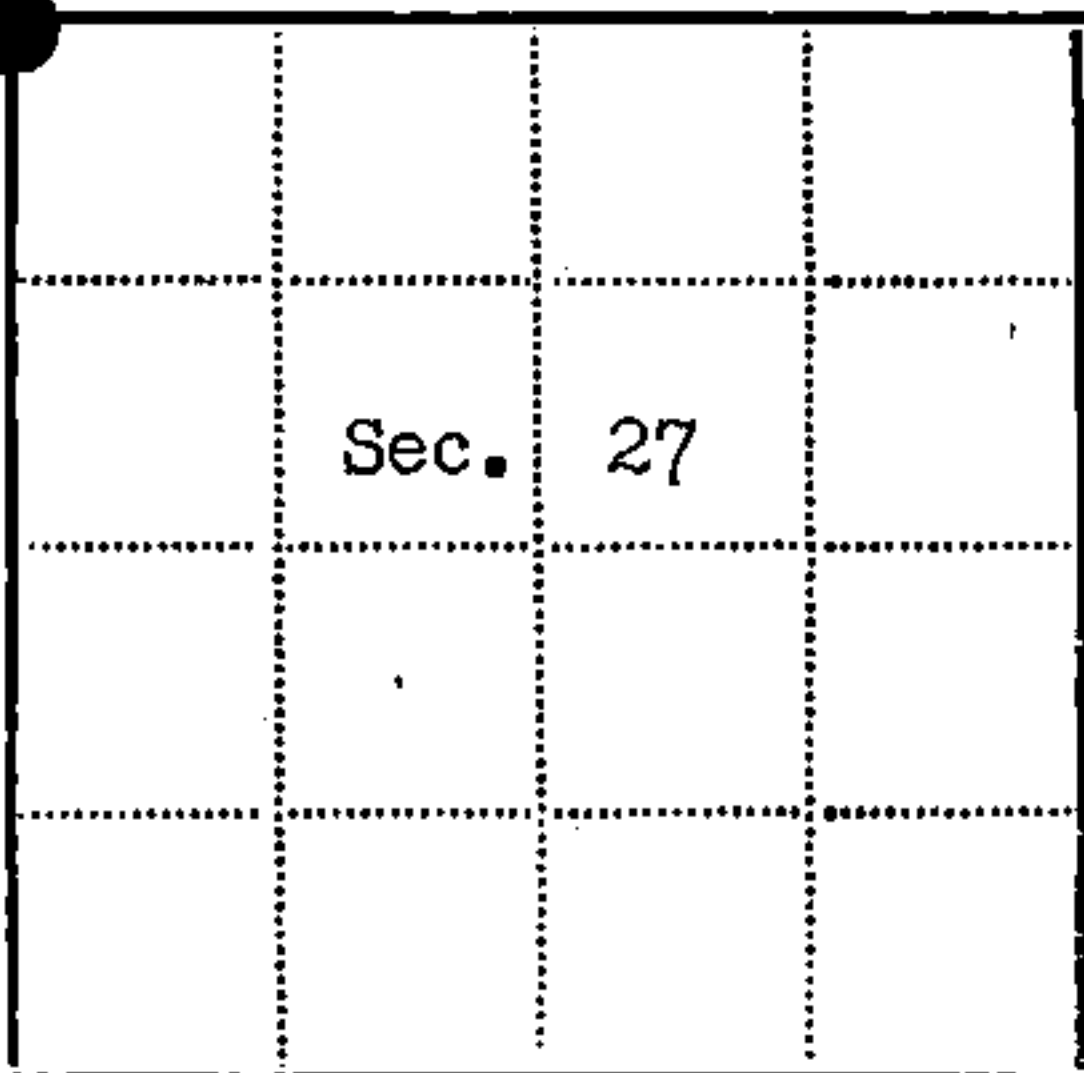
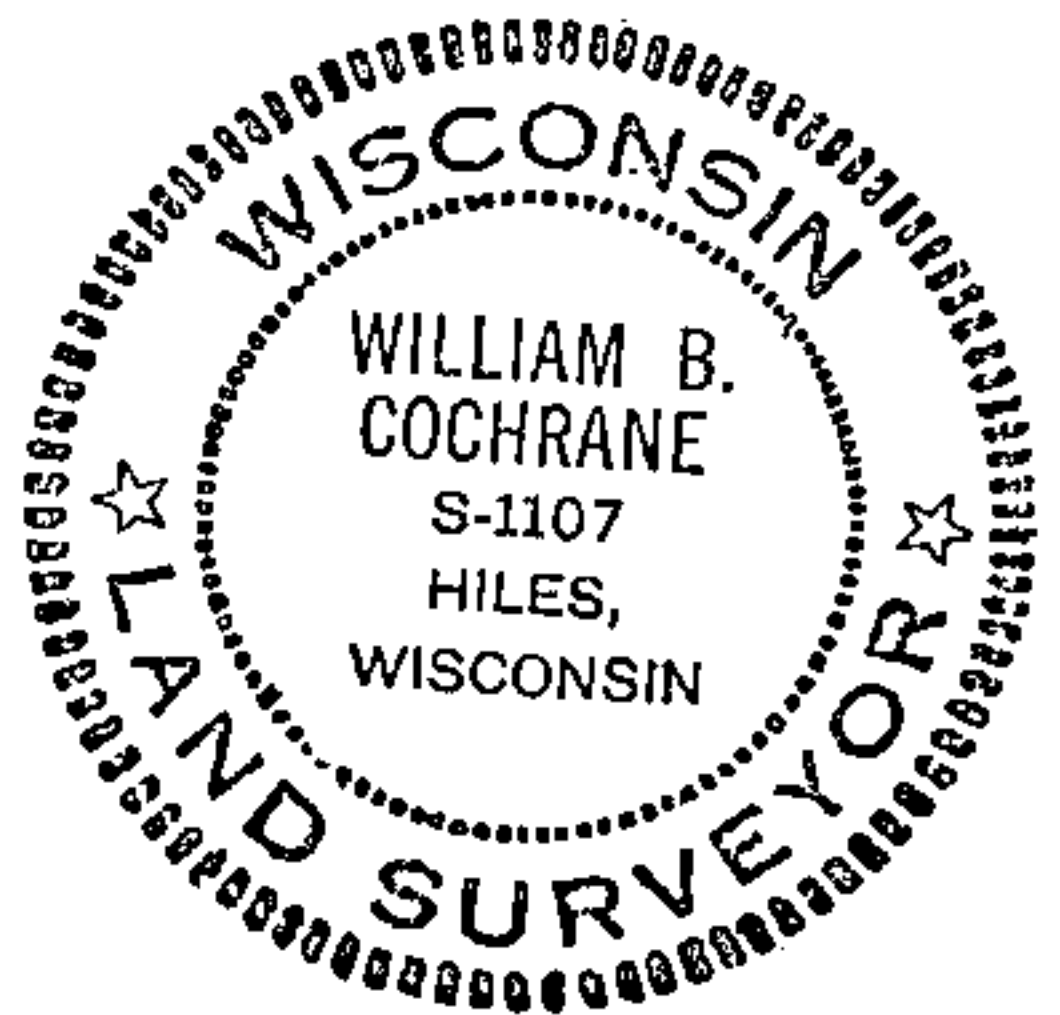

● - Corner monument restored
□ -

Resident witnesses.....

Dated at Laona Wisconsin, this 29th day of May 1980.

Signature William B. Cochrane Title Land Surveyor
(County Surveyor, Registered Land Surveyor, or other duly authorized official)

Surveyors Registration No. S-1107 DOCUMENT NO. 118076

Office of Register of Deeds County of Forest

I hereby certify that the within instrument was filed in this office for record on the 9th day of June 1980, and was filed in Book No. Page No. of County Records.

Signature Sharon Mueller Title Deputy

Township 36 North, Range 15 East, Section 27, Index No. R-13, Page No.

U. S. PUBLIC LAND SURVEY MONUMENT RECORD

INSTRUCTIONS:

This record shall show the location of the corner and shall include all of the following nine elements (a through i).

- (a) Identify the corner by reference to the U.S. public land survey system.
 ○ = Corner monument restored.

Section Corner to Sections 21, 22, 27, and 28,
 T.36N., R15E., Forest County, WI.

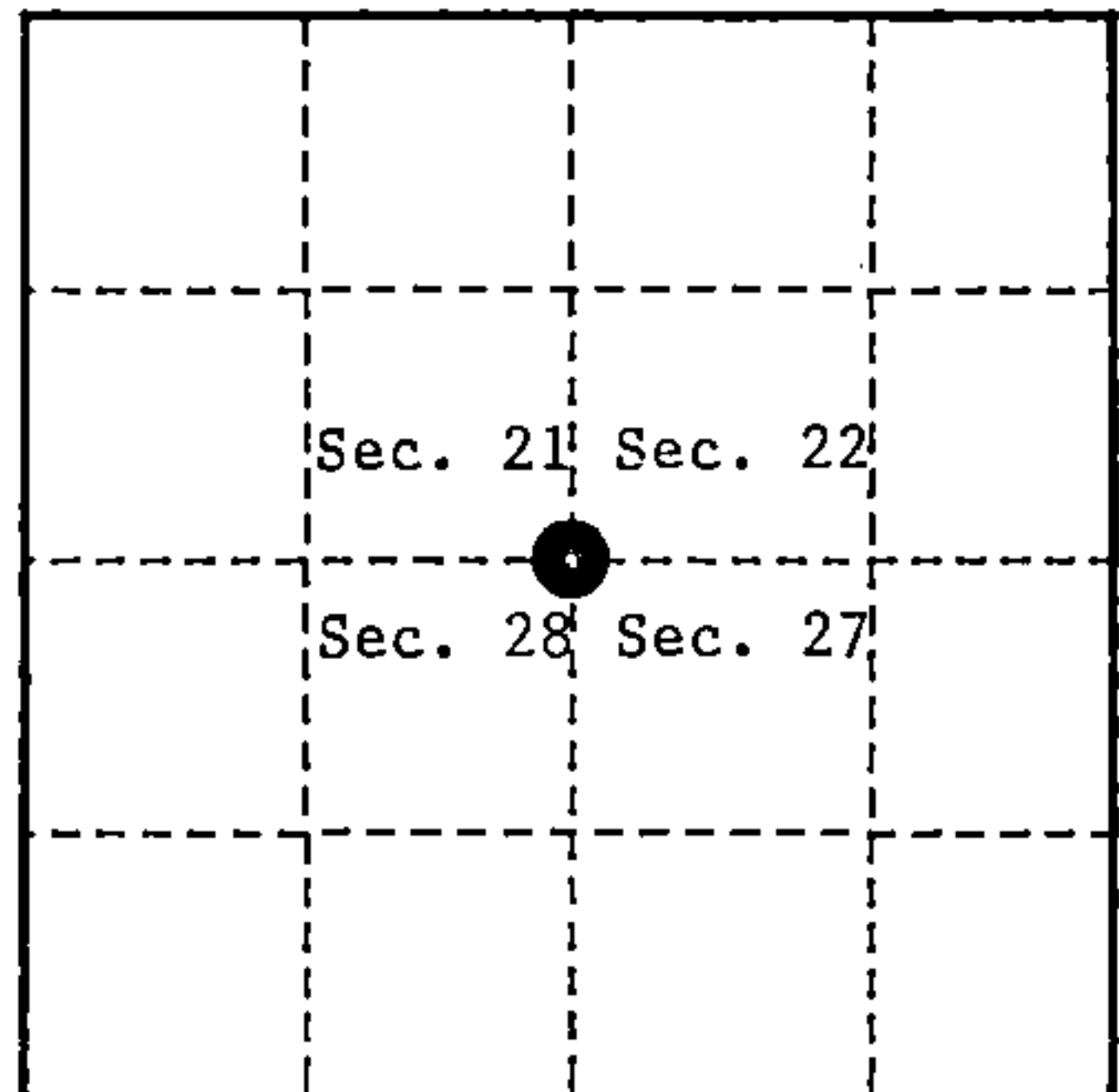

- (b) Describe any record evidence, monument evidence, occupational evidence, testimonial evidence or any other material evidence you considered, and whether the monument was found or placed.

Original survey in 1859 by James McBride. Set wood post and the following bearing trees; Sugar, 10", N.22°W., 10 links, Sugar, 15", N.83°E., 24 links, Sugar, 12", S.75°E., 30 links, Sugar, 15", S.17°W., 52 links.

In 1980, William Cochrane, R.L.S., found a 2" diameter iron pipe in a mound of stone and an old post lying next to pipe. Found stump holes N.22°W., 10 links, N.83°E., 24 links, S.17°W., 52 links. In place of iron pipe set a 2" x 36" galvanized iron pipe with a brass cap stamped to identify corner. Blazed and scribed new bearing trees; White Ash, 11", S.85°E., 4.15 feet, White Ash, 9", S.37°E., 21.38 feet, Maple, 6", S.31°W., 23.57 feet, White Ash, 11", N.62°W., 6.89 feet.

On November 5, 1991, Alan Harrison, R.L.S., found the monument and bearing trees as described above. The White Ash bearing trees incorrectly called Basswoods on Cochranes Corner Certificate and in field book. Also found Northwest White Ash bearing tree cut down by those unknown. Blazed and scribed 1 new bearing tree; Sugar, 6", N.55°W., 35.15 feet. Set a steel sign post 0.50 feet Northeast of monument.

- (c) In the plan view drawing below, provide reference ties to at least 4 witness monuments, or, if the location is within a municipality, to at least 2 witness monuments. (witness monuments shall be made of concrete, natural stone, iron or other equally durable material.)

- (d) Show a plan view drawing depicting the relevant monuments and reference ties which is sufficient in detail to enable accurate relocation of the corner monument if the corner monument is disturbed. Indicate north.

1. 2" x 36" galvanized iron pipe with brass cap stamped to identify corner.
2. White Ash, 11", S.85°E., 4.15 feet.
3. White Ash, 9", S.37°E., 21.38 feet.
4. Maple, 6", S.31°W., 23.57 feet.
5. Sugar, 6", N.55°W., 35.15 feet.
6. Steel Sign Post, Northeast, 0.50 feet.

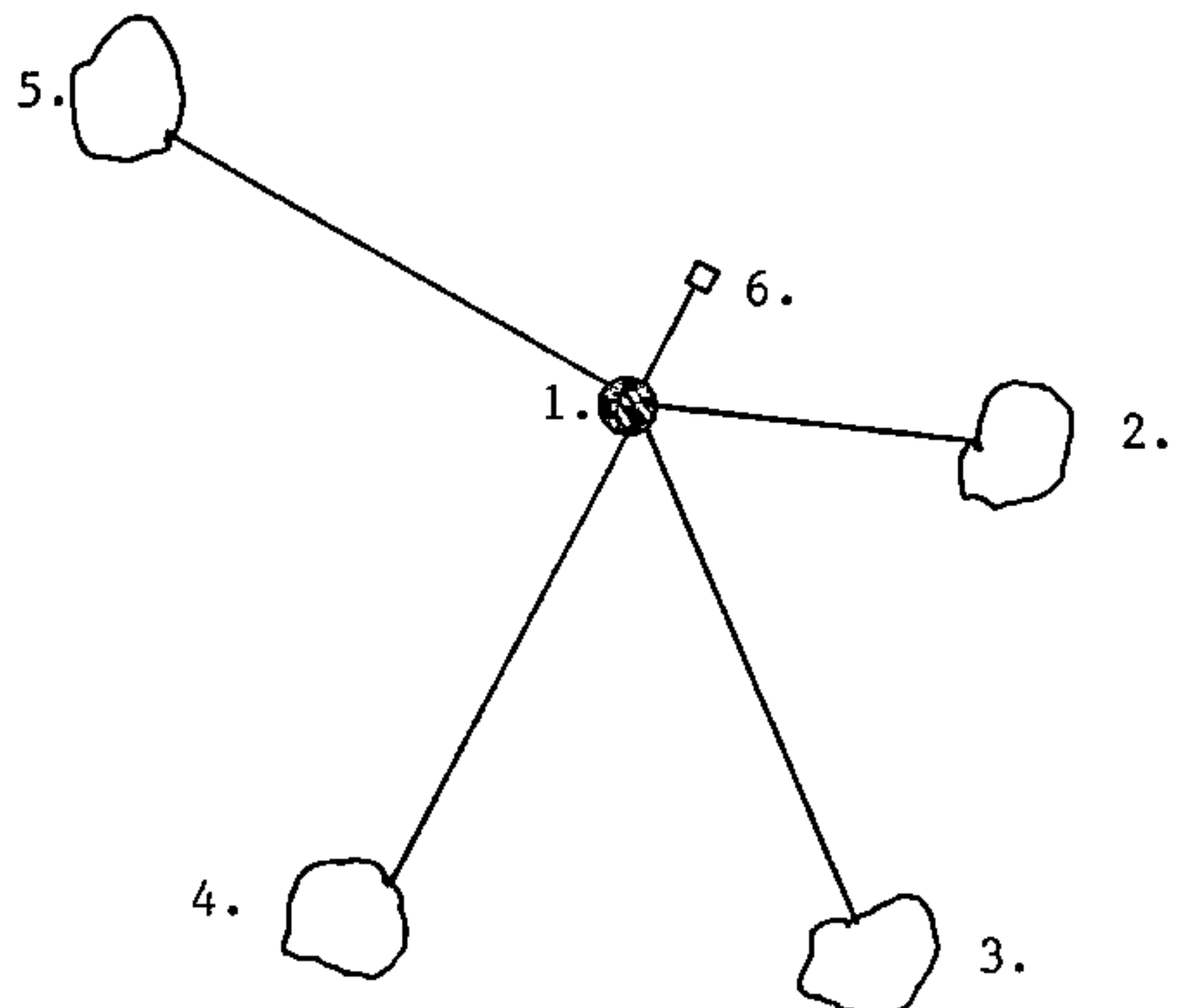

(e) Describe any material discrepancy between the location of the corner as restored or reestablished and the location of that corner as previously restored or reestablished by distance and direction. Show the discrepancy on the plan view drawing under (d), above. Show the distances between the corner as previously restored or reestablished and (1) the corner as restored or reestablished, and (2) to at least 2 of the witness monuments shown on the drawing in (d), above.

None

(f) Was the corner restored through acceptance of (1) an obliterated evidence location, or, (2) a found perpetuated location?

(2)

(g & h) Was the corner reestablished through lost corner proportionate methods? If so, show the method, including the directions and distances to other public land survey corners used as evidence or used for proportioning in determining the corner location?

No

REGISTER'S OFFICE
Forest County, Wis.
Received for record this 23rd day
of November A.D., 1994 at
9:00 o'clock A. M. and recorded
in Vol. Canu Restorations
page 36-15, R-13
Mark Chittick, Deputy
Register of Deeds

(1) I, Alan D. Harrison
(type or print name) certify that the corner location shown
on this record was determined by me or under my direction and
control and that this U.S. Public Land Survey Monument Record is
correct and complete to the best of my knowledge and belief.

Alan D. Harrison

Signature

10/31/94

Date

CERTIFICATE READY FOR FILING:

Sue Vap

District Ranger

