

CERTIFIED LAND CORNER RESTORATION

State of Wisconsin }  
County of Forest } ss.

I William B. Cochrane, do hereby certify that on the 21st day of May, 19 80, I found evidence of the West quarter corner of Section 15 Township 36 North, Range 15 East, Fourth Principal Meridian, as described hereon; and that from this evidence I established a new monument and accessories as described hereon to perpetuate the original location of this corner:

Description of original monument and accessories and subsequent restorations:

Surveyed in 1859 by James McBride  
North between Sections 15 and 16, 40.00 chains set quarter section post.  
Birch, 14 inches, N37W, 21 links  
Birch, 14 inches, S29E, 15 links.

Description of corner evidence found:

Very old post, rotted almost flush with the ground. Post point in place.  
N37W, 21 links, hardwood stump hole  
S29E, 15 links, very distinct hardwood stump hole.

Description of monument and accessories I established to perpetuate the location of this corner:

I replaced the post point with a 2 1/2 inch diameter aluminum pipe, 3 feet long, with an aluminum cap stamped:  
T36N, R15E, 1/4, S15, S16, 1980, S-1107

Blazed and scribed the following new bearing trees:  
Maple, 7 inches, N60E, 12.60 feet  
Maple, 7 inches, S23E, 9.31 feet.

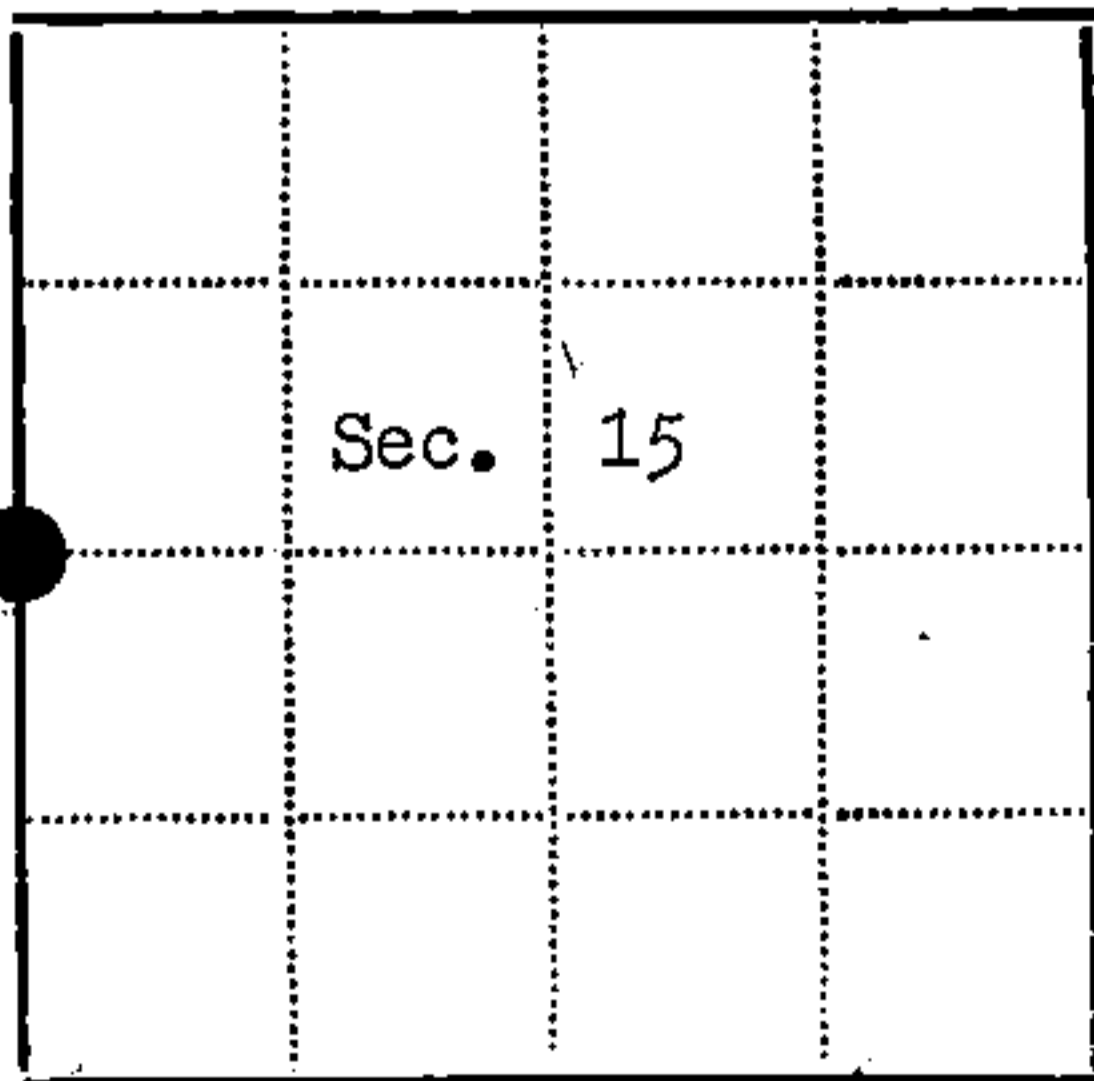
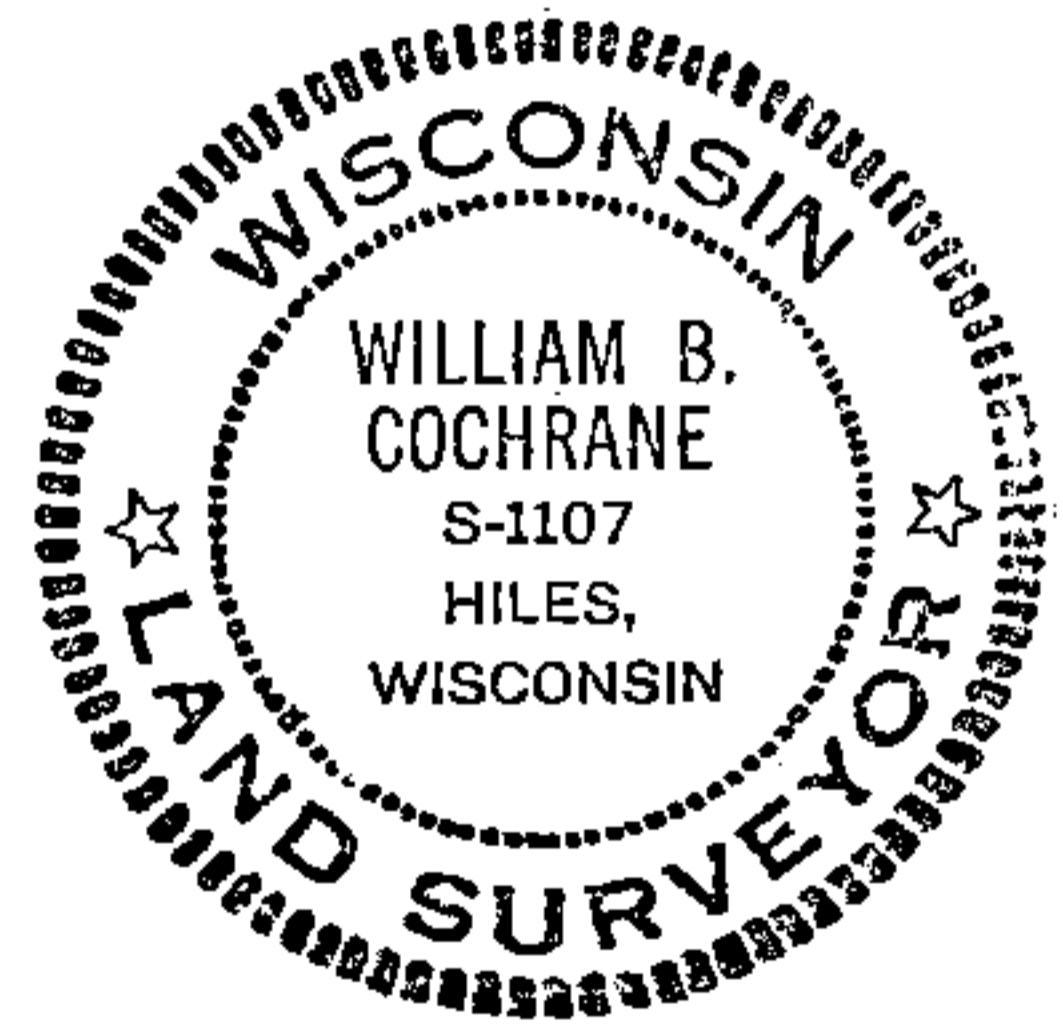

● - Corner monument restored  
□ -

Resident witnesses.....

Dated at Laona Wisconsin, this 27th day of May 19 80.

Signature William B. Cochrane Title Land Surveyor  
(County Surveyor, Registered Land Surveyor, or other duly authorized official)

Surveyors Registration No. S-1107 DOCUMENT NO. 118072

Office of Register of Deeds County of Forest

I hereby certify that the within instrument was filed in this office for record on the 9th day of June 19 80, and was filed in Book No. Page No. of County Records.

Signature Sharon Mueller Title Deputy

Township 36 North, Range 15 East, Section 15, Index No. L-13, Page No.

# U. S. PUBLIC LAND SURVEY MONUMENT RECORD

INDEX NO. L-13

Quarter \_\_\_\_\_ Corner to Section 15 16 T 36 N, R 15 E  
(Section/Quarter) \_\_\_\_\_

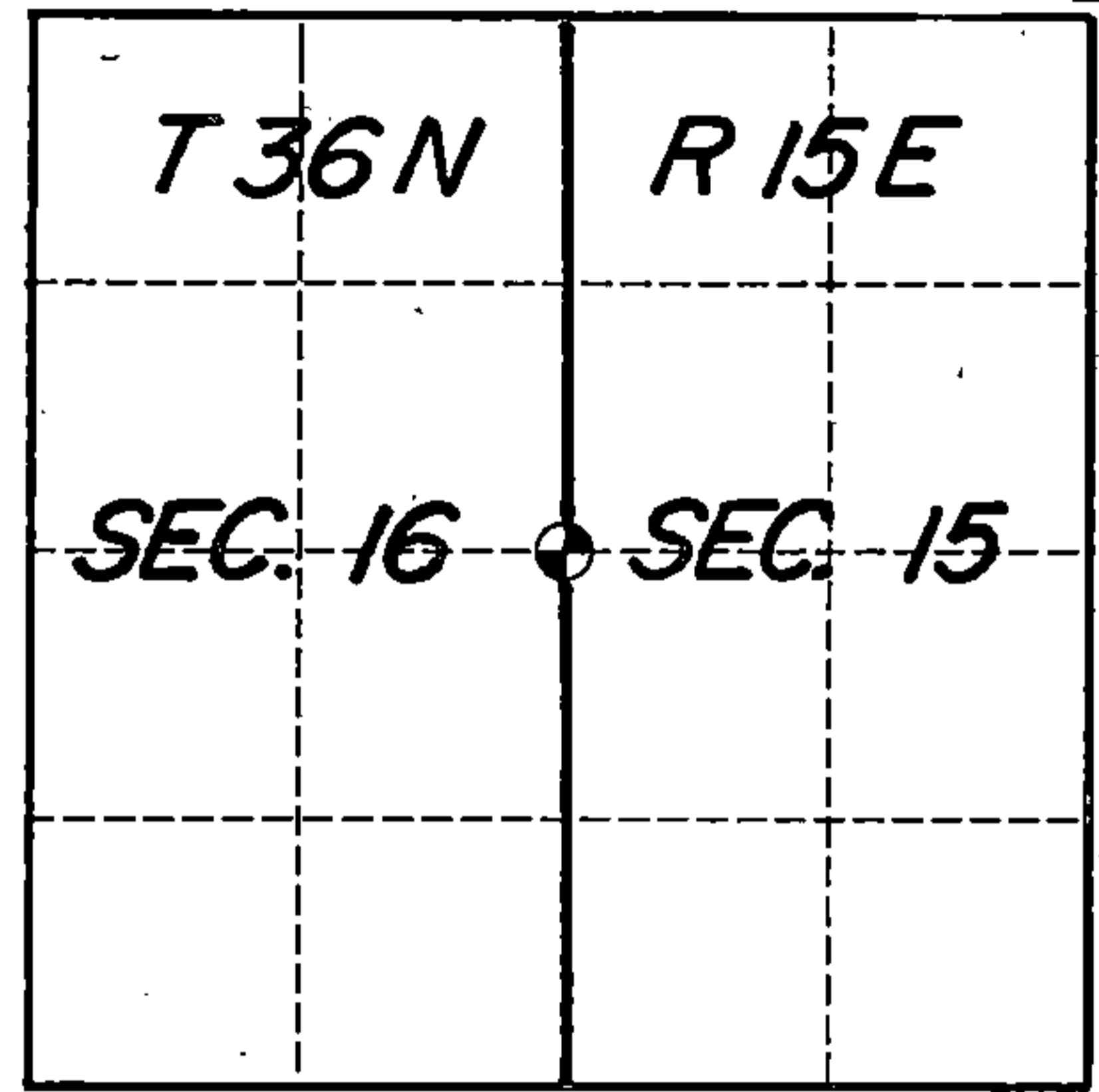

Show distances and bearings if set by proportional measurement.

History of original corner establishment, record evidence, monument evidence, occupational evidence, testimonial evidence or any other material evidence, and what you found and how the monument was set.

In 1859 James McBride, contract surveyor, set a wood post at this corner and scribed the following bearing trees:  
Birch 14" N 37°W 21 links  
Birch 14" S 29°E 15 links

In 1980 Bill Cochran found a rotted post with point in tact and two stump holes at the bearing tree calls. He placed a 2½" Aluminum post with cap stamped for corner at the post position and scribed two 7" Maple trees as accessories.

I found Bill's aluminum monument in tact and the two Maples had grown to 11" diameter trees. I marked two more trees as shown below.

○ = Corner monument restored.

In the plan view drawing below, provide reference ties to at least 4 witness monuments, or, if the location is within a municipality, to at least 2 witness monuments. (Witness monuments shall be made of concrete, natural stone, iron or other equally durable material, except wood other than bearing trees.) Also, show any material discrepancies between the corner restored or re-established and the location of any other previous corner location or occupation.

DOCUMENT NUMBER  
**143538**



Corner consists of a 2½" aluminum post with cap stamped for corner. The trees were blazed and scribed "BT" with nails driven into the centers for measurements to the monument. Bearings are magnetic.

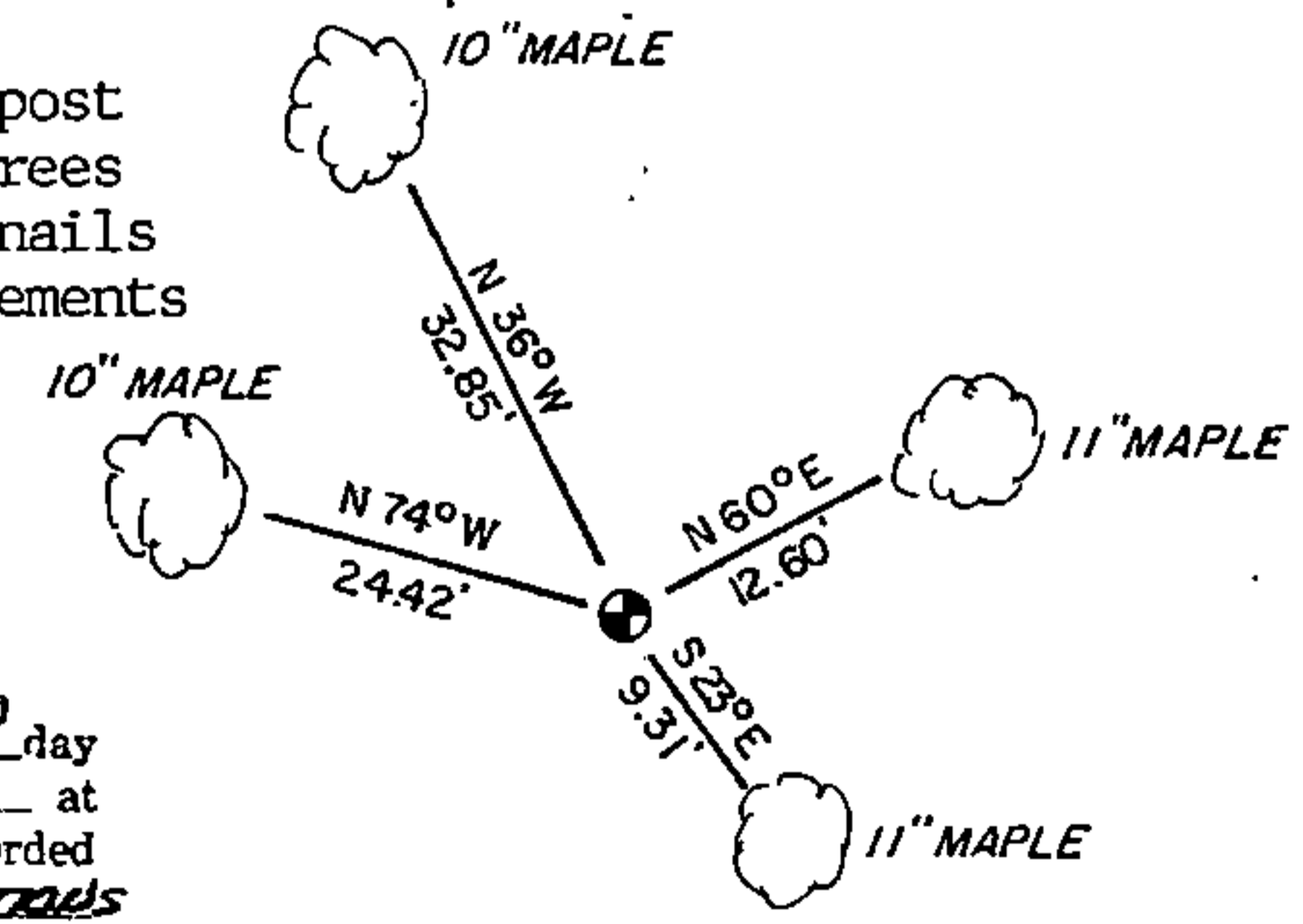

I, Kim H Pritzlaff, Contractor with USFS  
(Type or print name) certify that the corner location shown on this record was determined by me or under my direction and control and that this U.S. Public Land Survey Monument Record is correct and complete to the best of my knowledge and belief.

*Kim H Pritzlaff*  
Signature

11/30/91  
Date

REGISTER'S OFFICE  
Forest County, Wis.  
Received for record this 3RD day  
of JANUARY A.D., 1992 at  
9:30 o'clock A.M. and recorded  
in Vol. CORNER RESTORATIONS  
page L-13  
*J. Aschenbanner*  
Register of Deeds

43015102000