

CERTIFIED LAND CORNER RESTORATION

Index No. G-21

State of Wisconsin }
County of Forest } ss.

I, Philip T. Hansen, do hereby certify that on the 13th day of December, 1976, I found evidence of the Quarter corner of Section 11 & 12 Township 36, North, Range 15 East, Fourth Principal Meridian, as described hereon; and that from this evidence I established a new monument and accessories as described hereon to perpetuate the original location of this corner.

Resident witnesses:

Glen Barker

Jim Claflin

Herb Wagoner

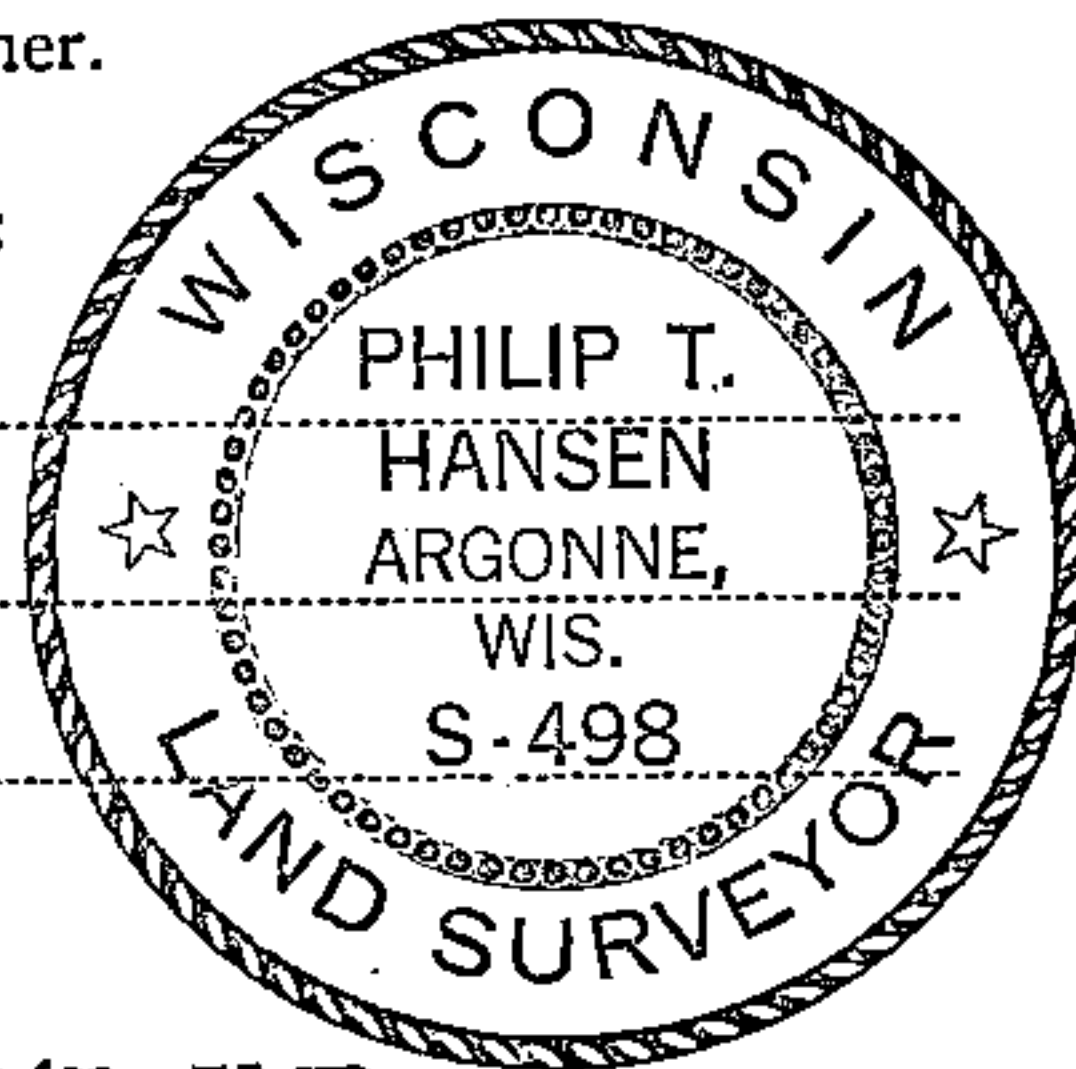

T36N R15E

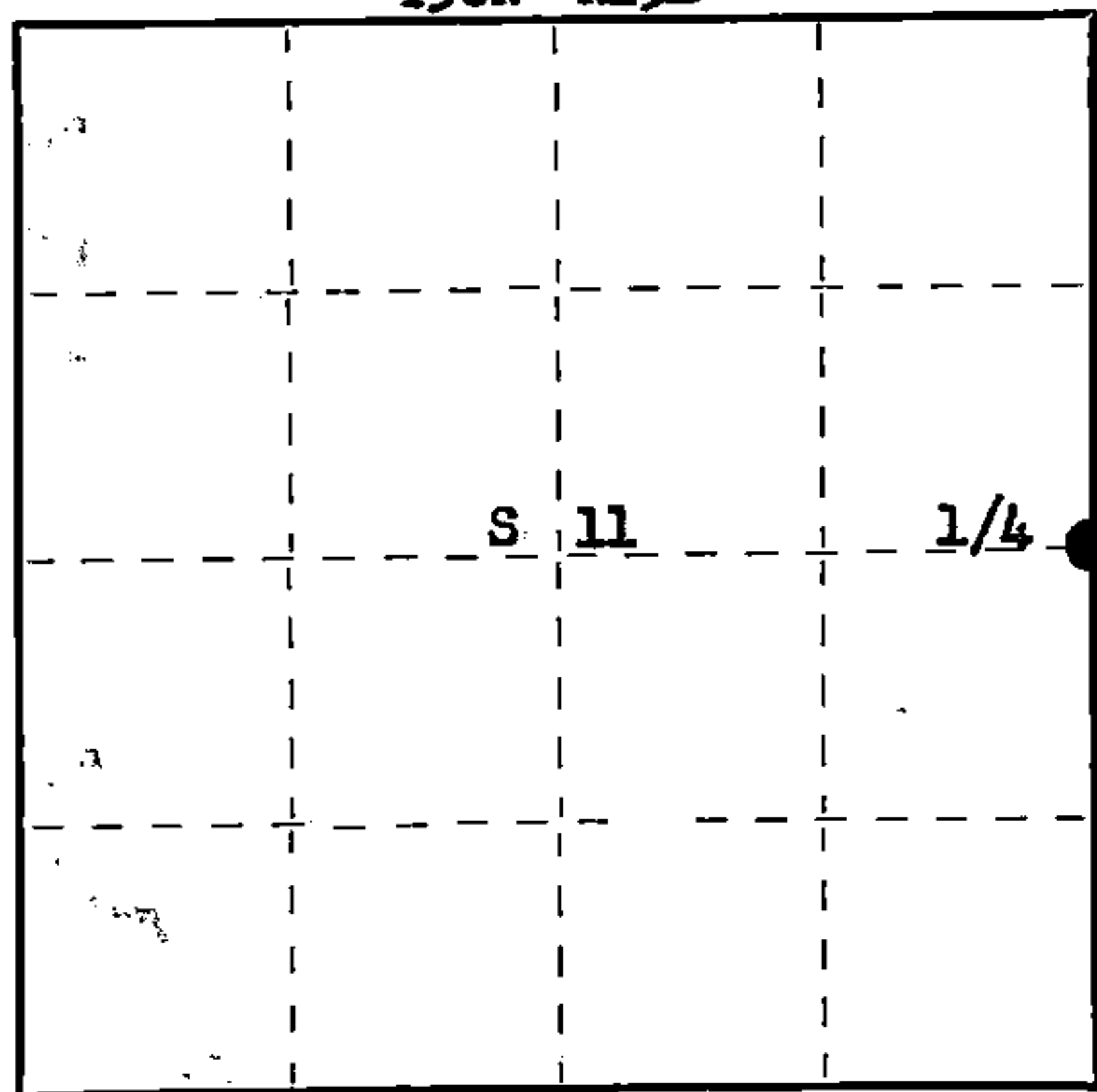

○ = Corner monument restored.

History of original corner establishment:

Original Corner established by James McBride, Deputy Surveyor, in 1859, from which Aspen 6" bears S 28° E 15 links and Aspen 8" bears N 49° W 26 links. Ray Leigh, Consolidated forester, reports he found an old cedar post still standing during cruising observation in 1948.

Description of corner evidence found:

Recovered a piece of old squared cedar post, 1 ft. long lying under snow and leaves.
Recovered the old post hole with evidence of old point.
Recovered old BT - Birch 14" N 80° W 12.5 links, stub 30" high. This had been chopped into years ago to expose scribing S - BT. Origin unknown.

Description of monument and accessories I established to perpetuate the original location of this corner.

Replaced point of old post with 2 1/2" A-1 Berntsen Federal Monument, aluminum with magnet installed in cap and base. Cap stamped:

Monument projects 12" above ground.

NBTs - Cedar 8" N 22° E 25.9 lks., scribed 1/4 BT.
Cedar 8" N 58° W 45.7 lks., scribed 1/4 BT.
Sugar 9" S 25° E 30.7 lks., scribed 1/4 BT.

T36N R15E
1/4 11 | 12
S498-1976

Dated at Rhineland, Wis., this 5th day of January, 1976.

Signature Philip T. Hansen Title Registered Land Surveyor Registration No. S-498
(County Surveyor, Registered Land Surveyor, or other duly authorized official)

Office of Register of Deeds, County of Forest, I hereby certify that the within instrument was filed in this office for record on the 21st day of January, 1977 at 4:00 o'clock P. M.

Eugene Stutzman
(Register of Deeds)

DOCUMENT NUMBER 110884

By _____ Deputy

FORM 985 H. C. MILLER CO., MILWAUKEE

43015112000

U. S. PUBLIC LAND SURVEY MONUMENT RECORD

INDEX NO. G-21

Quarter _____ Corner to Section 11 12 T36N, R15E
(Section/Quarter)

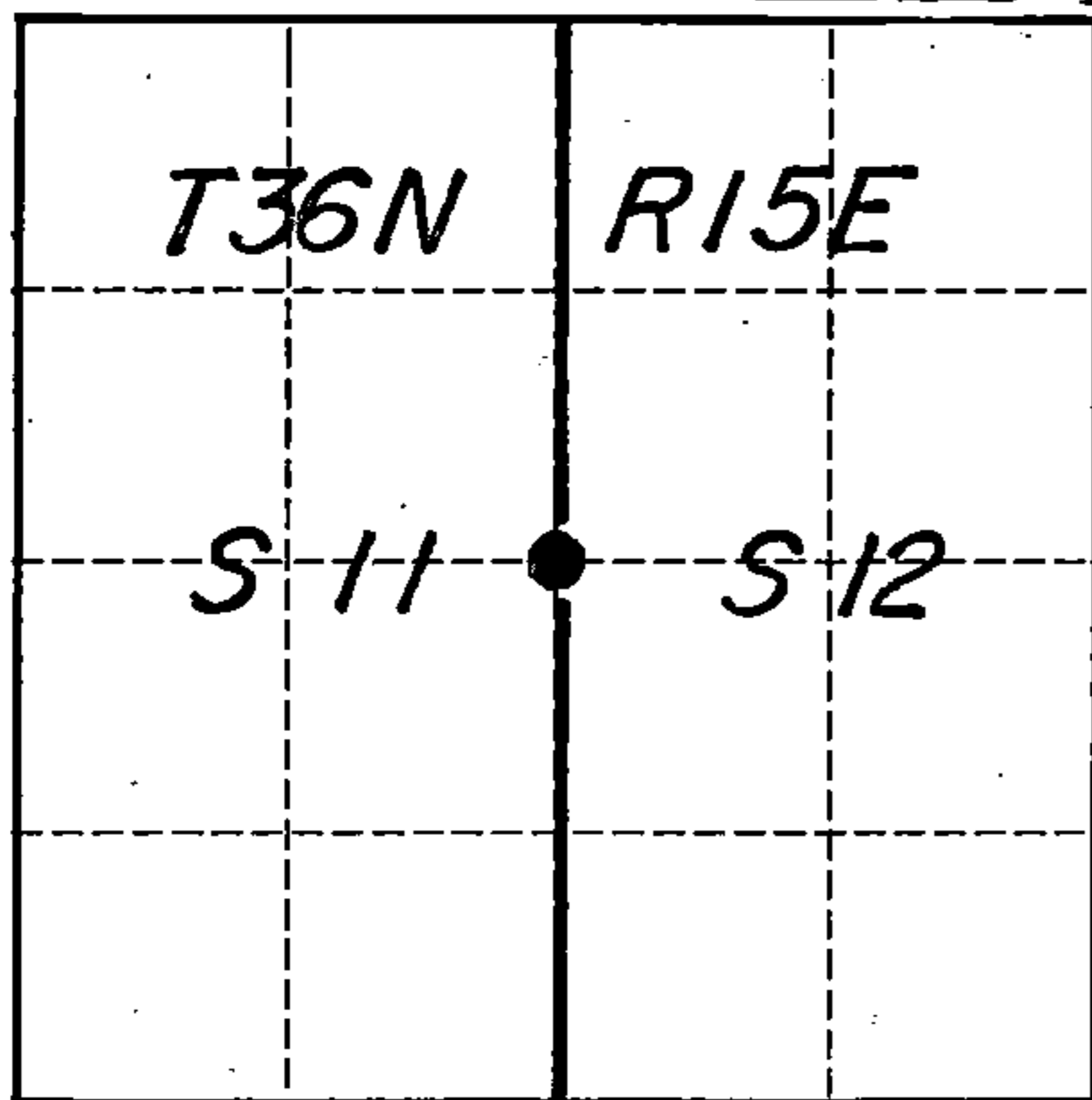

Show distances and bearings if set by proportional measurement.

History of original corner establishment, record evidence, monument evidence, occupational evidence, testimonial evidence or any other material evidence, and what you found and how the monument was set.

In 1859 James McBride set a wood post at this corner location and scribed the following trees : Aspen 6" S 28°E 15 links and an Aspen 8" N 49°W 26 links

In 1915 J. Melendy resurveyed Section 11 and found the original BTs and marked the following new BTs:

- Pine 18" N 41°E 57 1/8 links
- Pine 14" N 86 1/2°E 33 1/2 links
- W. Birch 12" N 81 1/2°W 12 1/2 links
- Maple 10" S 45 3/4°W 21 1/2 links

In 1976 Philip Hansen recovered an old wood post and an old BT on a Birch 14" N 80°W for 12.5 links. He set an aluminum Forest County Monument up 12" in place of the post.

I recovered Hansen's monument and his BTs all in good condition, but the monument was unstable. I set it further in the ground for stability and set a steel sign post near the corner painting and signing his BTs. Melendy's distances north and south fit the distances which I returned remarkably well.

In the plan view drawing below, provide reference ties to at least 4 witness monuments, or, if the location is within a municipality, to at least 2 witness monuments. (Witness monuments shall be made of concrete, natural stone, iron or other equally durable material, except wood other than bearing trees.) Also, show any material discrepancies between the corner restored or re-established and the location of any other previous corner location or occupation.

○ = Corner monument restored.



The corner consists of an aluminum Forest County monument. Distances are to nails driven into the tree centers which trees are scribed and blazed to USFS standard. Bearings are magnetic.

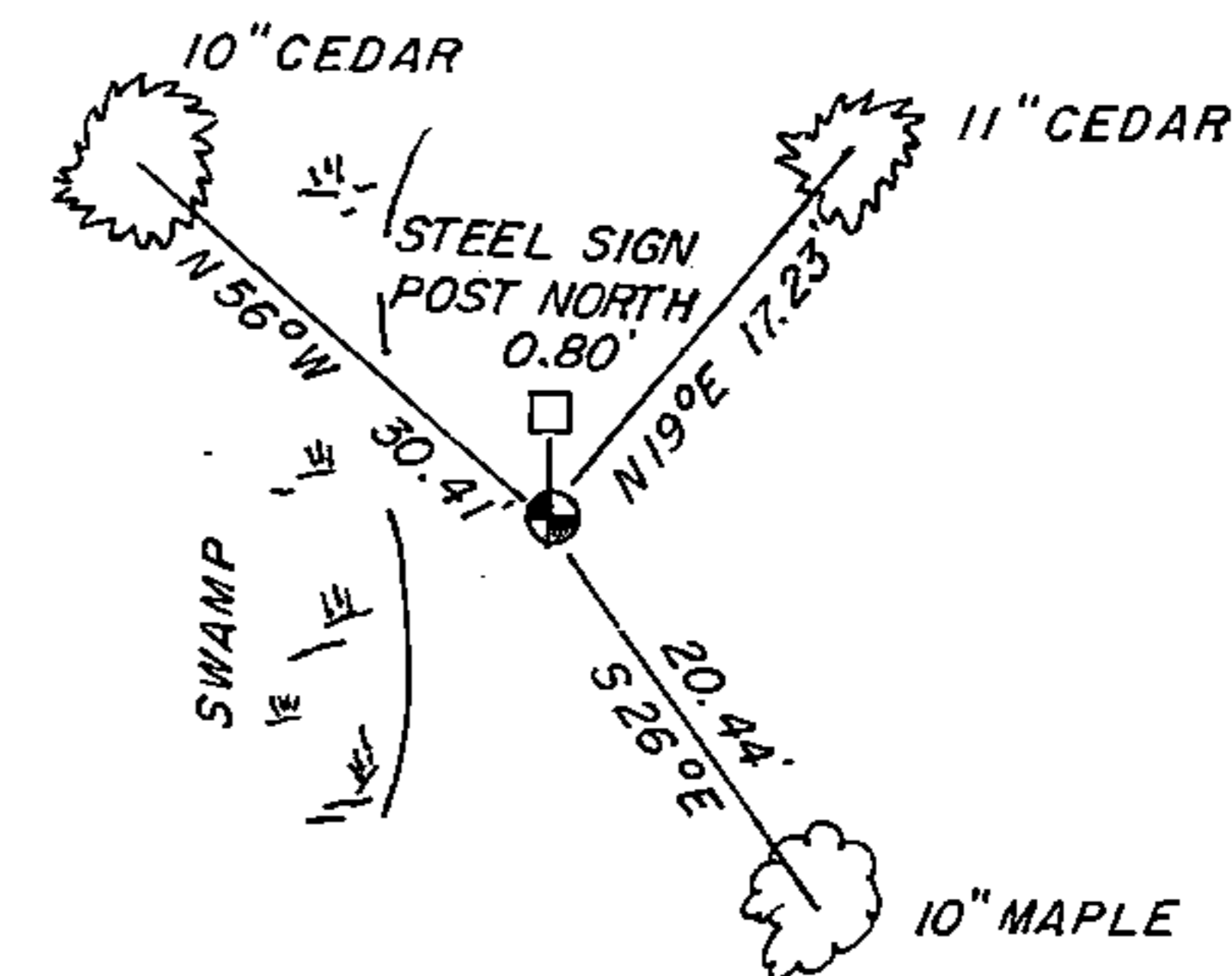

DOCUMENT NUMBER
143543

I, Kim H Pritzlaff, RLS 1259
(Type or print name) certify that the corner location shown on this record was determined by me or under my direction and control and that this U.S. Public Land Survey Monument Record is correct and complete to the best of my knowledge and belief.

Kim H. Pritzlaff
Signature

11/30/91
Date

REGISTER'S OFFICE
Forest County, Wis.
Received for record this 300 day
of JANUARY A.D. 1992 at
9:30 o'clock A.M. and recorded
in Vol. CRUISE RESTORATIONS
page G-21
Paul Schombrenner
Register of Deeds

43415112000