

CERTIFIED LAND CORNER RESTORATION

State of Wisconsin }
County of Forest } ss.

I William B. Cochrane, do hereby certify that on the 21st day of May, 19 80, I found evidence of the North quarter corner of Section 15 Township 36 North Range 15 East, Fourth Principal Meridian, as described hereon; and that from this evidence I established a new monument and accessories as described hereon to perpetuate the original location of this corner:

Description of original monument and accessories and subsequent restorations:

Surveyed in 1859 by James McBride.
West corrected between Sections 10 and 15, 40.00 chains set quarter section post.
Sugar, 12 inches, N35W, 28 links
Aspen, 8 inches, S26E, 32 links.

Description of corner evidence found:

2 inch iron pipe, 4 feet long. Old post lying next to the pipe.
N35W, 28 links hardwood stump hole.
No evidence of the aspen bearing tree
Connor Forest Industries knows this corner to have been in place for at least 30 years or longer.

Description of monument and accessories I established to perpetuate the location of this corner:

I replaced the iron pipe with a 2 1/2 inch diameter aluminum pipe, 3 feet long, with an aluminum cap stamped:
T36N, R15E, 1/4, S10, S15, S-1107.

Blazed and scribed the following new bearing trees:
Maple, 8 inches, N12E, 21.57 feet
R. Pine, 8 inches, S22E, 14.93 feet.

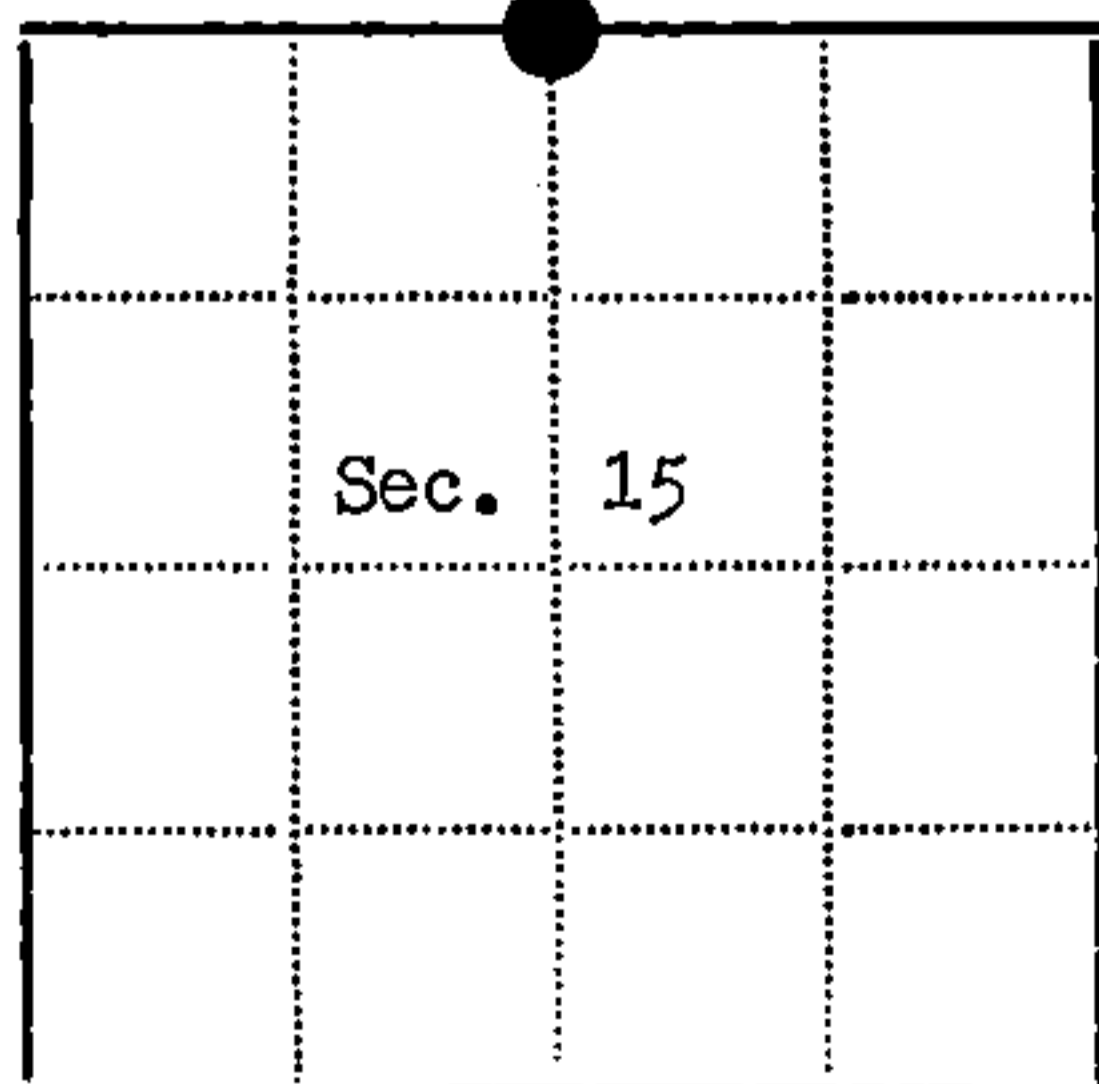
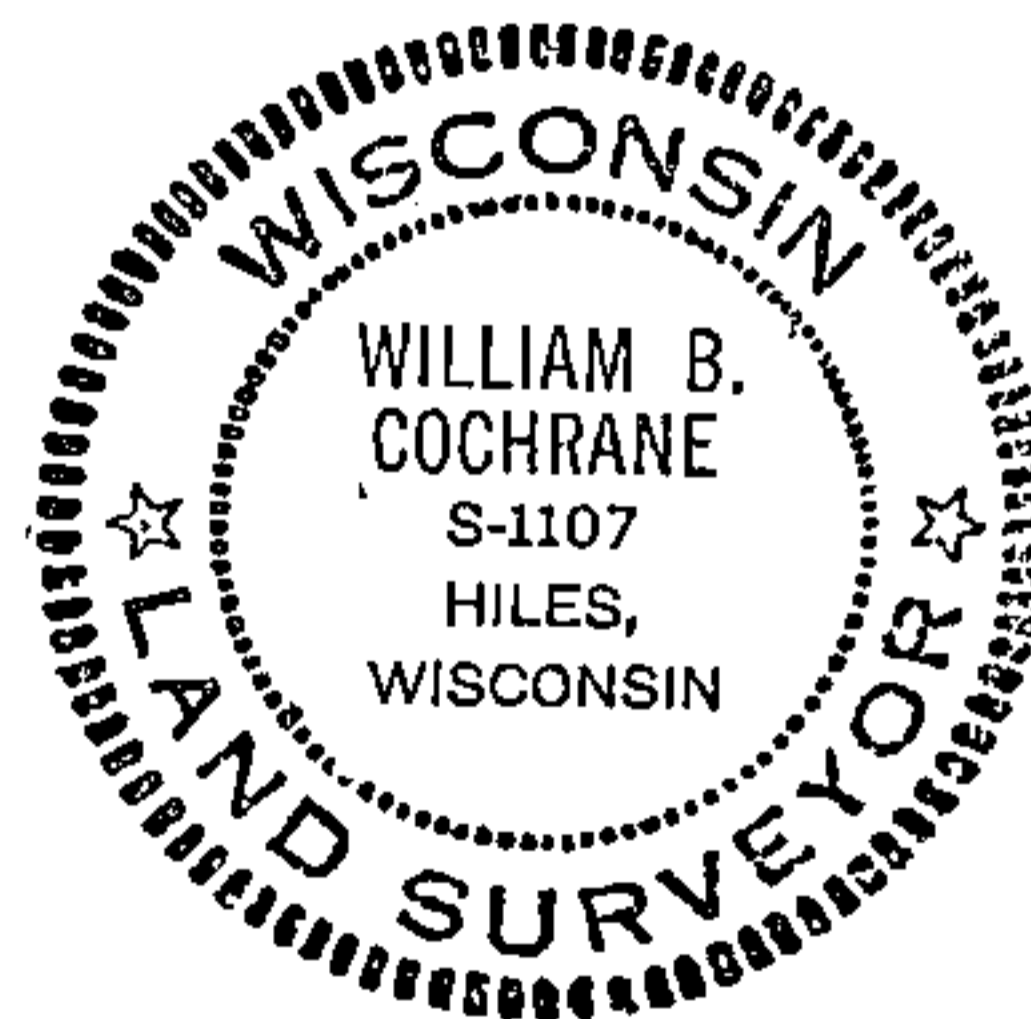

● - Corner monument restored
□ -

Resident witnesses.....

Dated at Laona Wisconsin, this 27th day of May 19 80.

Signature William B. Cochrane Title Land Surveyor
(County Surveyor, Registered Land Surveyor, or other duly authorized official)

Surveyors Registration No. S-1107 DOCUMENT NO. 118070
Office of Register of Deeds County of Forest

I hereby certify that the within instrument was filed in this office for record on the 9th day of June, 19 80, and was filed in Book No. Page No. of County Records.

Signature Sharon Mueller Title Deputy

Township 36 North, Range 15 East, Section 15, Index No. J-15, Page No.