

CERTIFIED LAND CORNER RESTORATION

State of Wisconsin }  
County of Forest } ss.

I, William B. Cochrane, do hereby certify that on the 12th day of May, 1980, I found evidence of the Northeast Section corner of Section 15 Township 36 North Range 15 East, Fourth Principal Meridian, as described hereon; and that from this evidence I established a new monument and accessories as described hereon to perpetuate the original location of this corner:

Description of original monument and accessories and subsequent restorations:

Surveyed in 1859 by James McBride.  
North between sections 14 and 15, 80.00 chains set post for corner of Sections 10, 11, 14 and 15.  
Sugar, 8 inches, N29W, 4 links  
Sugar, 12 inches, N52E, 15 links  
Sugar, 12 inches, S45E, 60 links  
Sugar, 12 inches, S76W, 18 links.

Description of corner evidence found:

3 inch iron pipe, 4 feet long, in a mound of stone. Old decayed wood lying alongside the pipe.  
Sugar Stump, S45E, 60 links.  
This corner was identified as being in place by the Connor Co. for 30 years or longer.

Description of monument and accessories I established to perpetuate the location of this corner:

I replaced the iron pipe with a 2 1/2 inch diameter aluminum pipe, 3 feet long, with an aluminum cap stamped:  
T36N, R15E, S10, S11, S14, S15, 1980, S-1107

Blazed and scribed the following new bearing trees:  
Basswood, 9 inches, N20E, 15.33 feet  
Cherry, 14 inches, S2W, 21.44 feet.

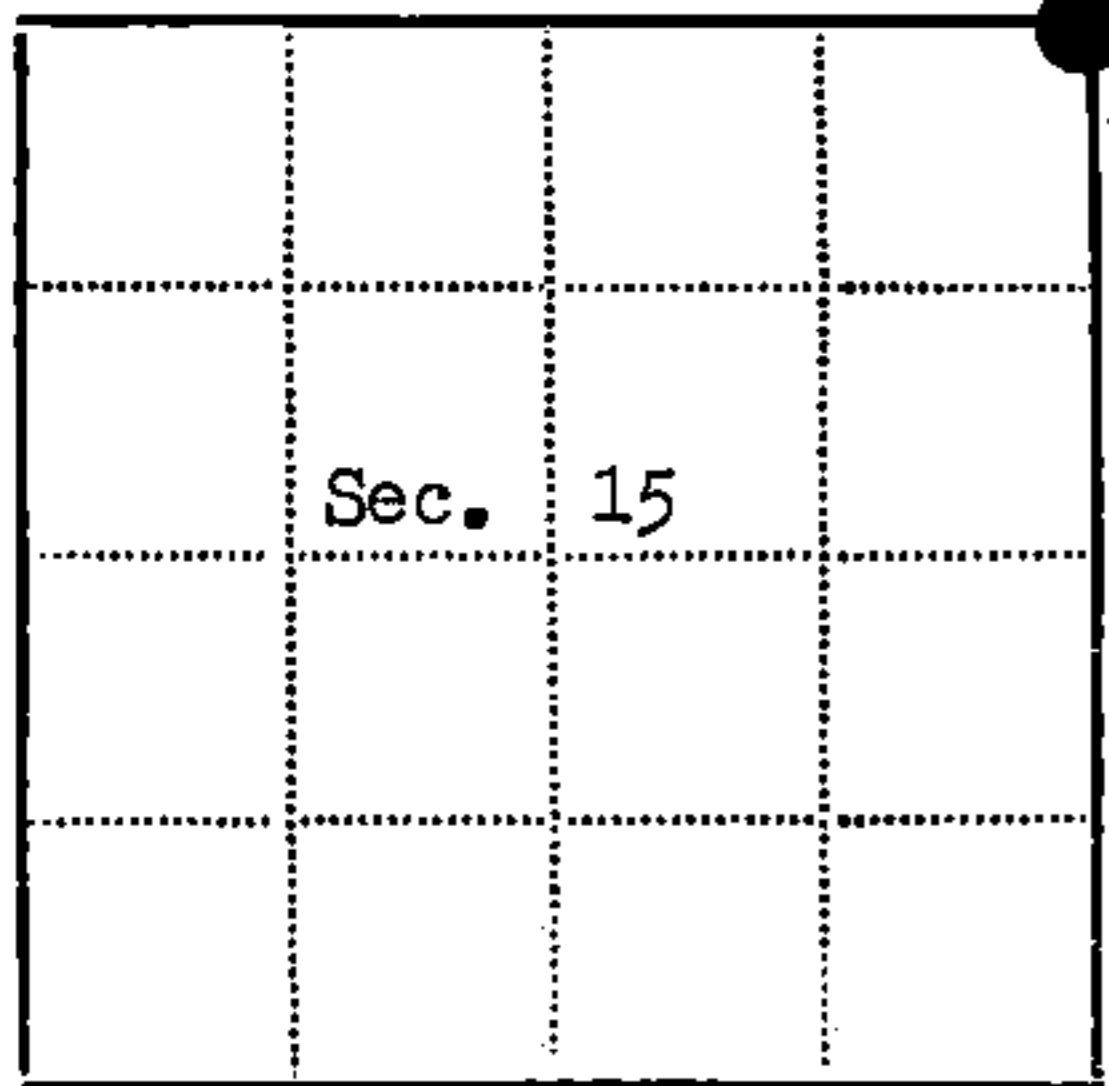
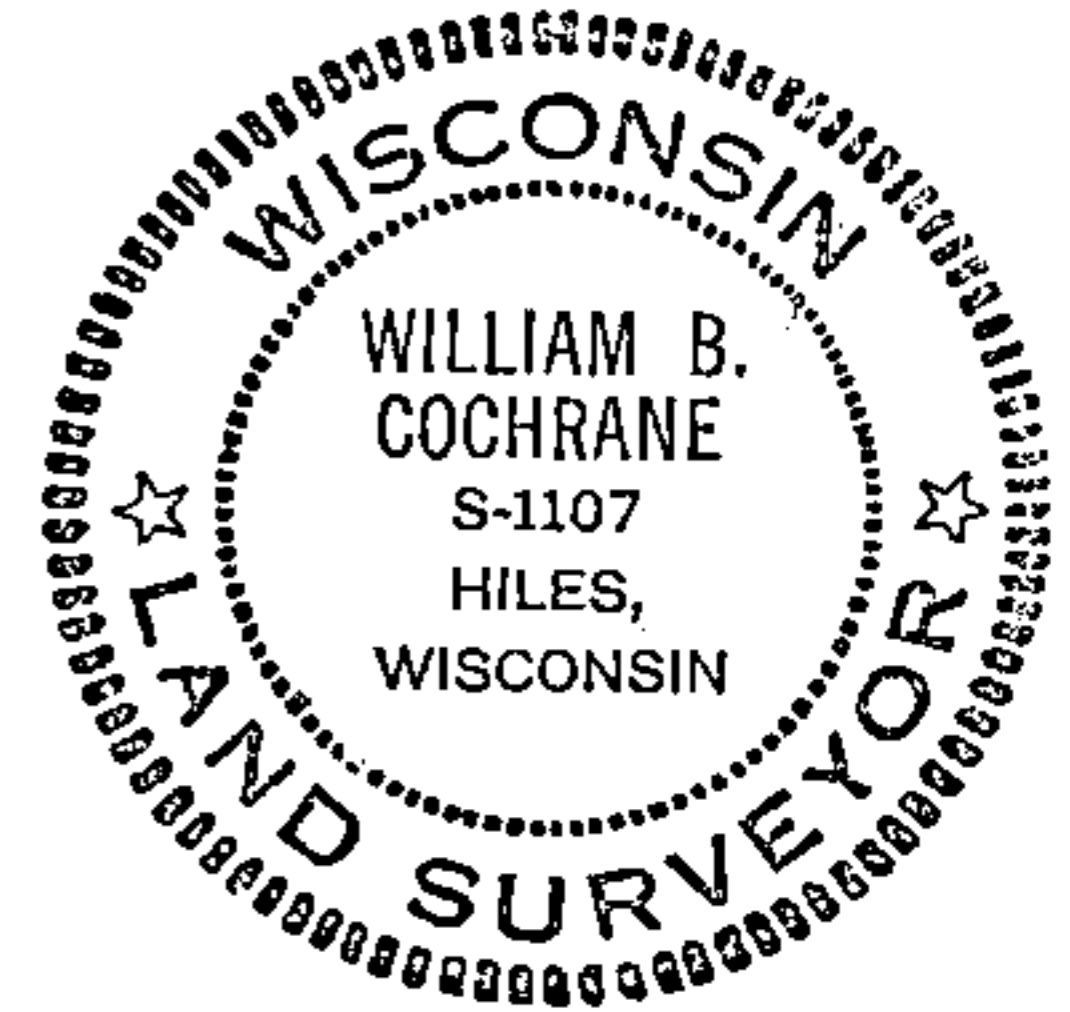

Resident witnesses.....

Dated at Laona Wisconsin, this 28th day of May 1980.

Signature William B. Cochrane Title Land Surveyor  
(County Surveyor, Registered Land Surveyor, or other duly authorized official)

Surveyors Registration No. S-1107 DOCUMENT NO. 118071

Office of Register of Deeds County of Forest

I hereby certify that the within instrument was filed in this office for record on the 9th day of June 1980, and was filed in Book No. Page No. of County Records.

Signature Sharon Mueller Title Deputy

Township 36 North Range 15 East Section 15 Index No. J-17 Page No.

5 17

# U. S. PUBLIC LAND SURVEY MONUMENT RECORD

INDEX NO. J-17

Section \_\_\_\_\_ Corner to Section 10 11 T 36N, R 15E  
 (Section/Quarter) 14 15

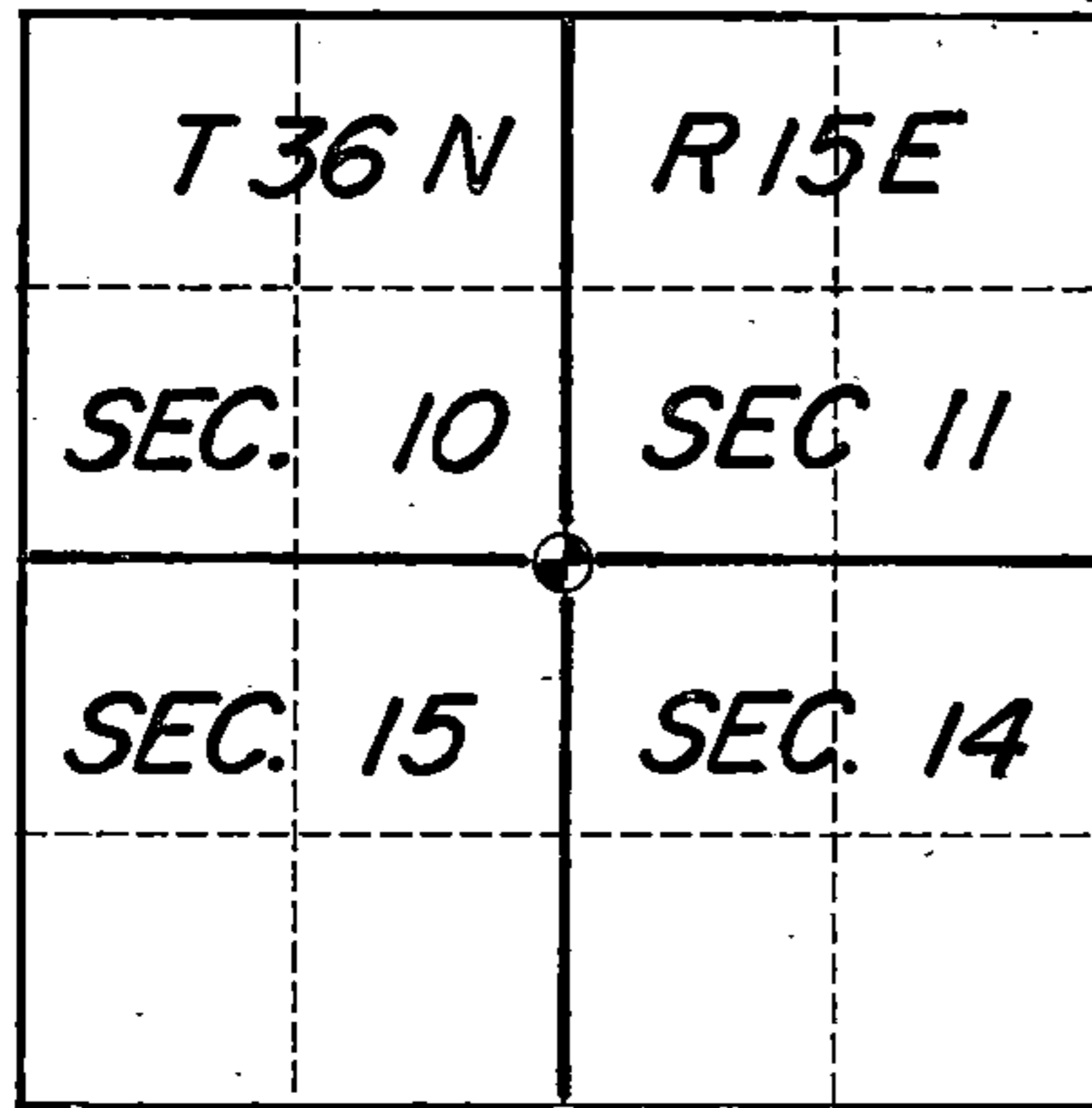

Show distances and bearings if set by proportional measurement.

History of original corner establishment, record evidence, monument evidence, occupational evidence, testimonial evidence or any other material evidence, and what you found and how the monument was set.

In 1859 James McBride set a wood post at this corner location and scribed the following bearing trees:

- Sugar 8" N 29°W 4 links
- Sugar 12" N 52°E 15 links
- Sugar 12" S 45°E 60 links
- Sugar 12" S 76°W 18 links

In 1980, Bill Cochran found a 3" iron pipe in a mound of stone and a decayed Sugar stump S 45°E 60 links. He set a 2½" aluminum post with cap stamped for the corner in place of the iron pipe and marked a 9" Basswood and a 14" Cherry.

I found Cochran's monument in good condition with the Basswood now a 14" tree and the Cherry a 16" tree. I scribed and blazed two more trees as shown below.

In the plan view drawing below, provide reference ties to at least 4 witness monuments, or, if the location is within a municipality, to at least 2 witness monuments. (Witness monuments shall be made of concrete, natural stone, iron or other equally durable material, except wood other than bearing trees.) Also, show any material discrepancies between the corner restored or re-established and the location of any other previous corner location or occupation.

○ = Corner monument restored.

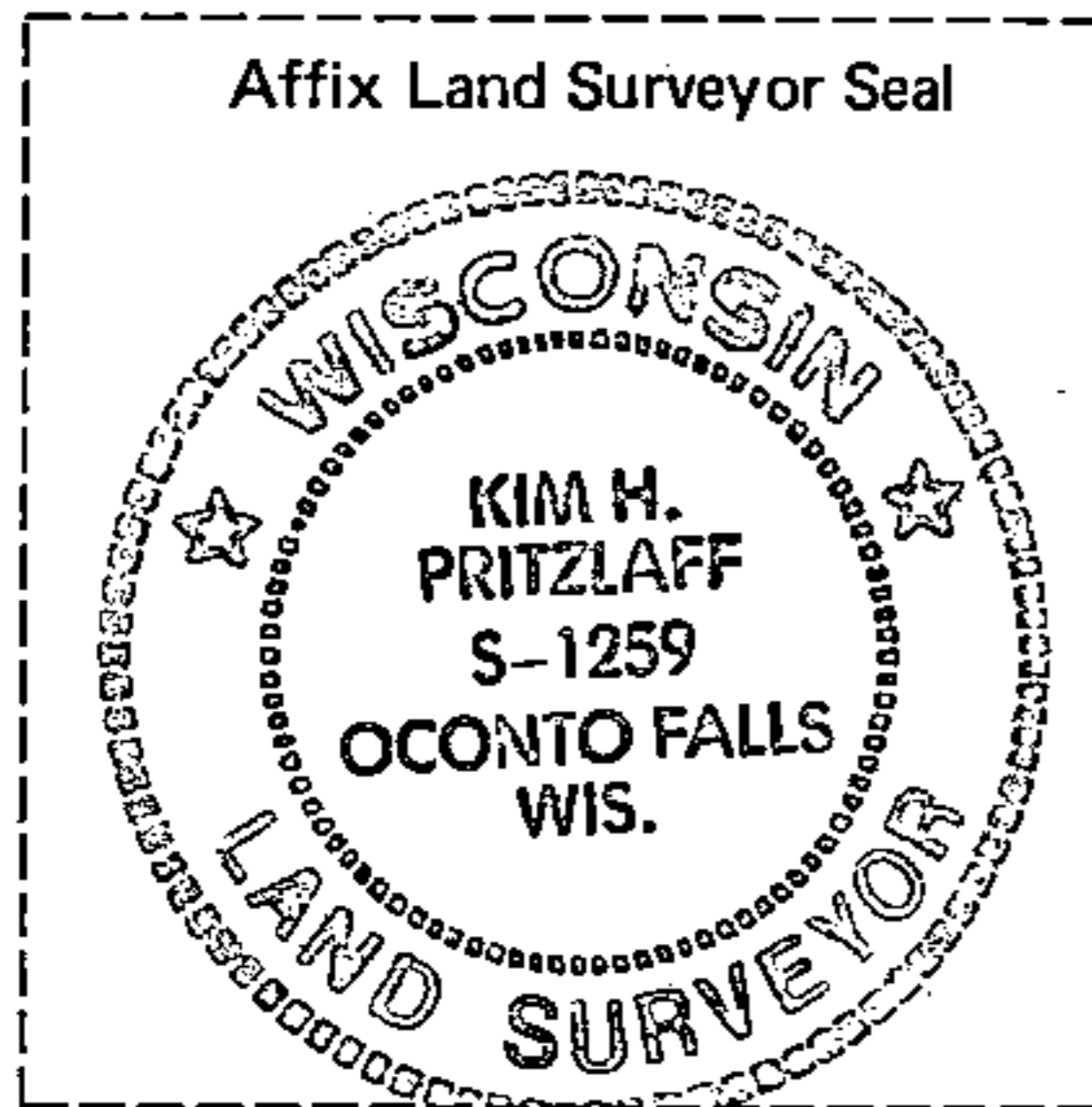

The monument consists of a 2½" aluminum post with cap stamped for the corner. Distances are to nails in the tree centers which trees are blazed and scribed. Bearings are magnetic.

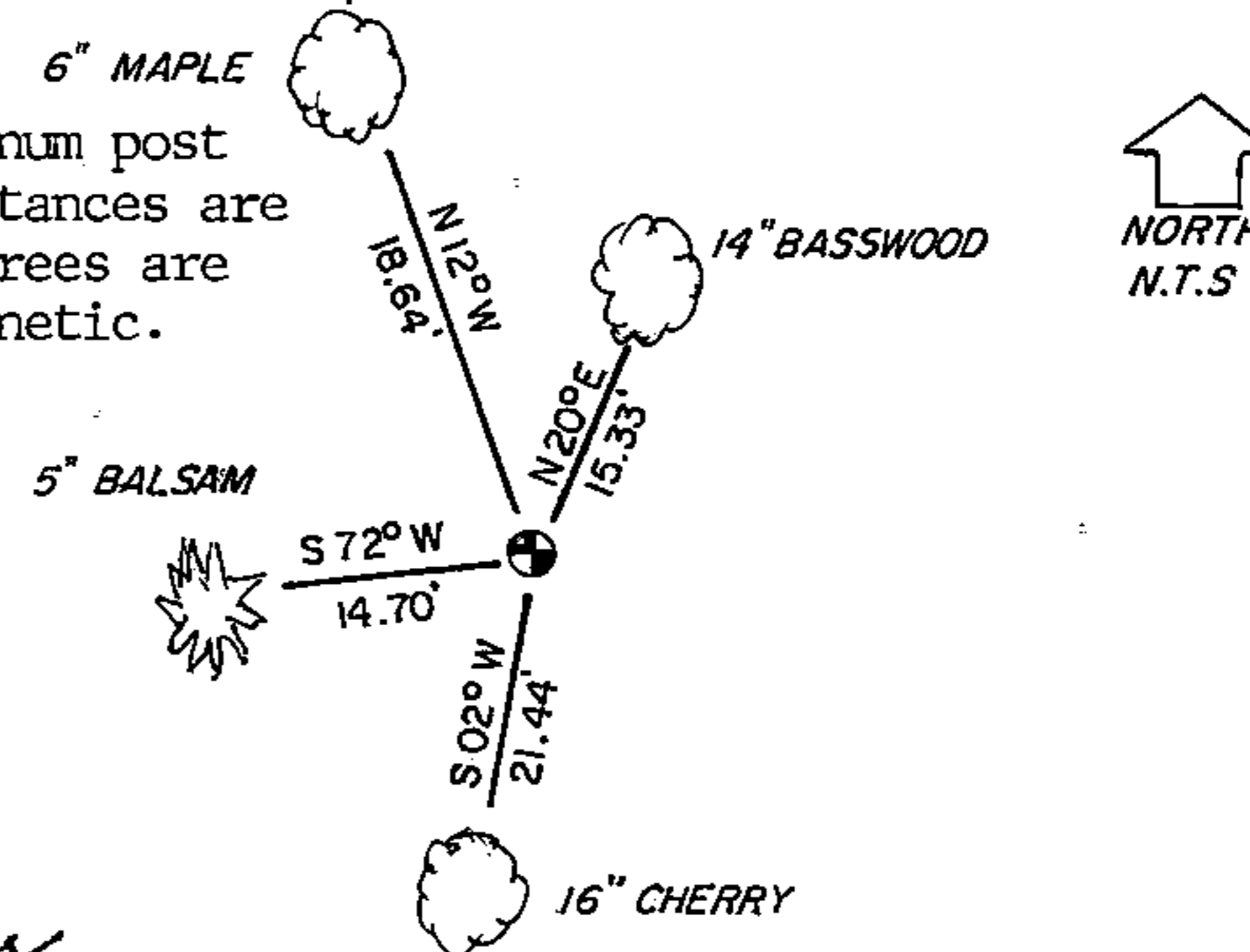

REGISTER'S OFFICE }  
 Forest County, Wis.  
 Received for record this 3RD day  
 of JANUARY A.D. 1992 at  
9:30 o'clock A.M. and recorded  
 in Vol. CORNER RESTORATIONS  
 page J-17  
*Paul Aschauer*  
 Register of Deeds

I, Kim H Pritzlaff, Contractor with the USFS  
 (Type or print name) certify that the corner location shown on this record  
 was determined by me or under my direction and control and that this  
 U.S. Public Land Survey Monument Record is correct and complete to the  
 best of my knowledge and belief.

*Kim H Pritzlaff*  
 Signature

11/30/91  
 Date

DOCUMENT NUMBER  
**143548**

4301510000

J-17