

CERTIFIED LAND CORNER RESTORATION

Index No. E-17

State of Wisconsin }  
County of Forest } ss.

I Gary L. Pisoni, do hereby certify that on the 4th day of October, 1994, I found evidence of the Southwest Section corner of Section 2 Township 36, North, Range 15 East, Fourth Principal Meridian, as described hereon; and that from this evidence I established a new monument and accessories as described hereon to perpetuate the original location of this corner.

Resident witnesses:

.....  
.....  
.....

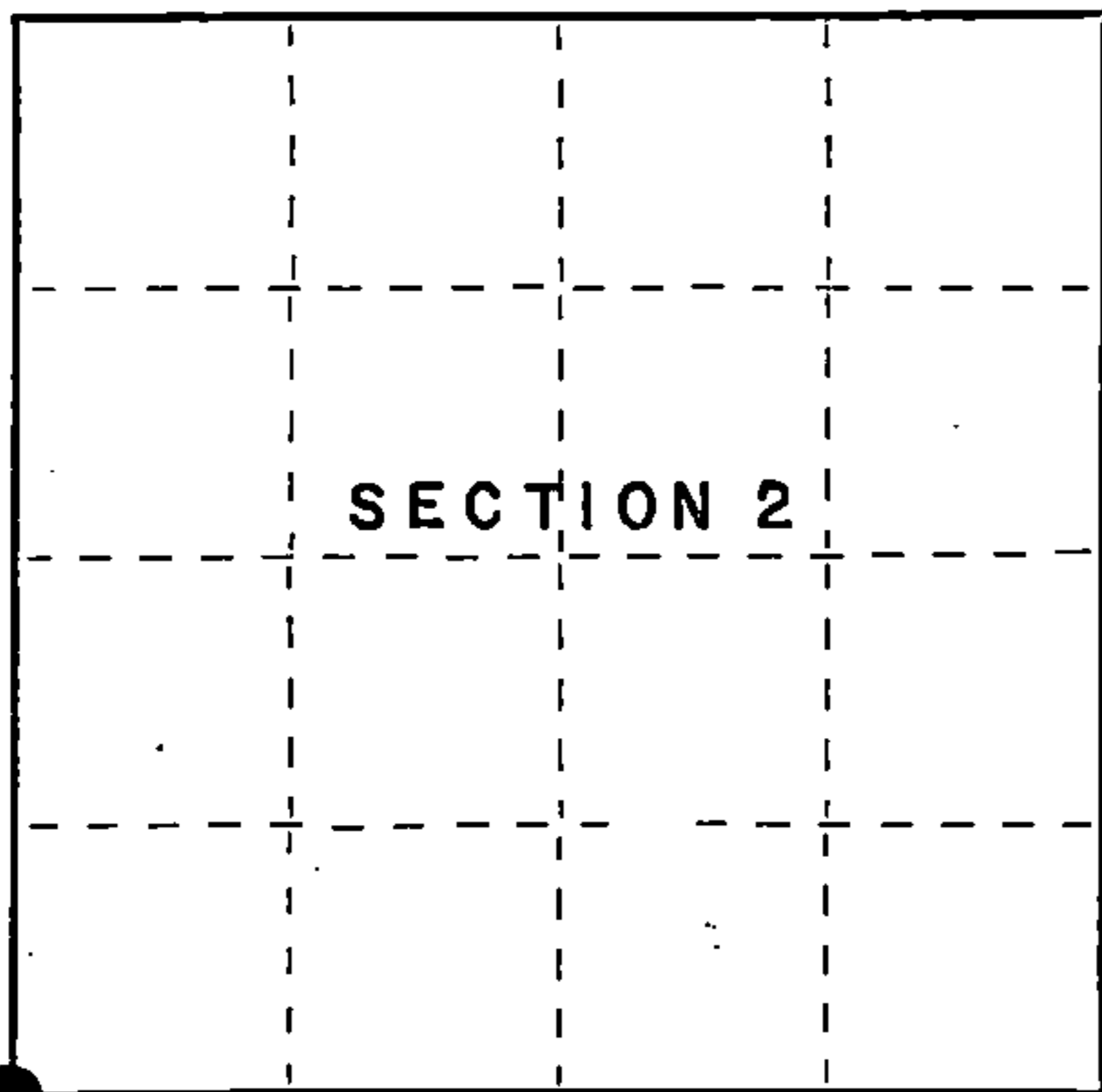

● = Corner monument restored.

History of original corner establishment:

Original Government Survey in 1859 by James McBride. North between Sections 10 and 11, at 80.00 chains, set Section corner post to Sections 2, 3, 10 and 11, from which the following bear:

Tamarack	8"	N 17° W	214 lks.
Tamarack	10"	N 46° E	274 lks.
Tamarack	8"	S 56° E	310 lks.
Tamarack	8"	S 76° W	147 lks.

Description of corner evidence found:

No original corner evidence was recovered.

I re-established the corner position by double proportionate measurements between the Northwest corner of Section 10 and the Southeast corner of Section 2; and between the Northwest corner of Section 2 and the East quarter corner of Section 10.

Description of monument and accessories I established to perpetuate the original location of this corner.

At the corner position, set a 2½ inch diameter aluminum pipe monument, 5 feet long, 6 inches above the ground surface, with an aluminum cap stamped: T36N, R15E, S-3, S-2, S-10, S-11, 1994, S-1634; from which the following new blazed and scribed bearing trees bear: (all measurements taken to a nail in side of tree)

Steel sign post	North	1.35 feet
Steel sign post	South	1.13 feet
Steel sign post	East	1.30 feet

Dated at Iron River, MI, ~~Wis.~~, this 8th day of April, 1995

Signature Gary L. Pisoni Title Land Surveyor Registration No. S-1634  
(County Surveyor, Registered Land Surveyor, or other duly authorized official)

Office of Register of Deeds, County of Forest, I hereby certify that the within instrument was filed in this office for record on the 10th day of March, 1997 at 1:30 o'clock P M.

(Register of Deeds)

By Paul Tamburic Deputy

FORM NO. 985-A.



Stock No. 26273

158110

43015030000

Describe any material discrepancy between the location of the corner as restored or reestablished and the location of that corner as previously restored or reestablished by distance and direction. Show the discrepancy on the plan view drawing under (d), above. Show the distances between the corner as previously restored or reestablished and (1) the corner as restored or reestablished, and (2) to at least 2 of the witness monuments shown on the drawing in (d), above.

None

(f) Was the corner restored through acceptance of (1) an obliterated evidence location, or, (2) a found perpetuated location?

Restored through lost corner proportionate methods.

(g) Was the corner reestablished through lost corner proportionate methods? If so, show the method, including the directions and distances to other public land survey corners used as evidence or used for proportioning in determining the corner location?

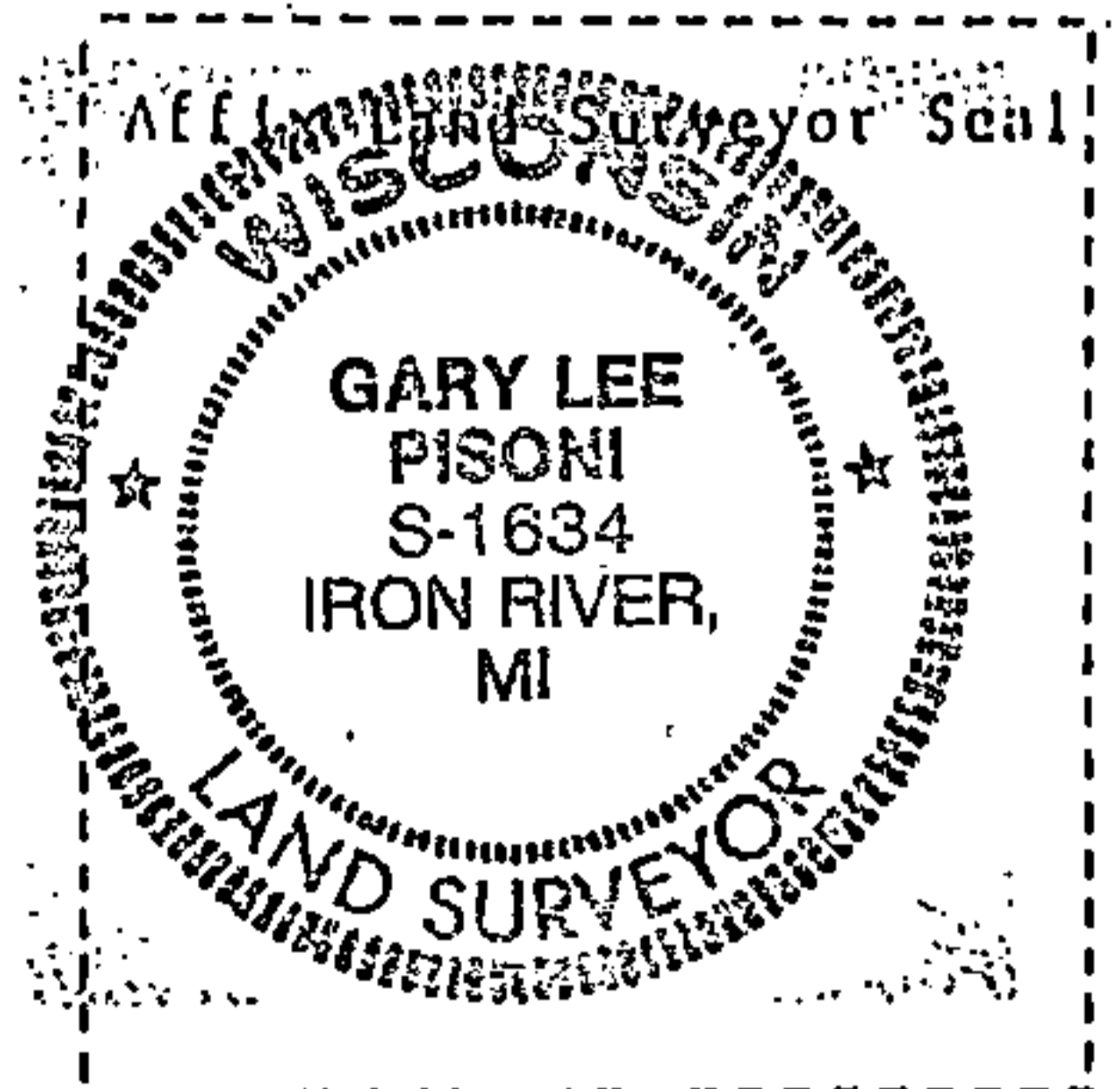
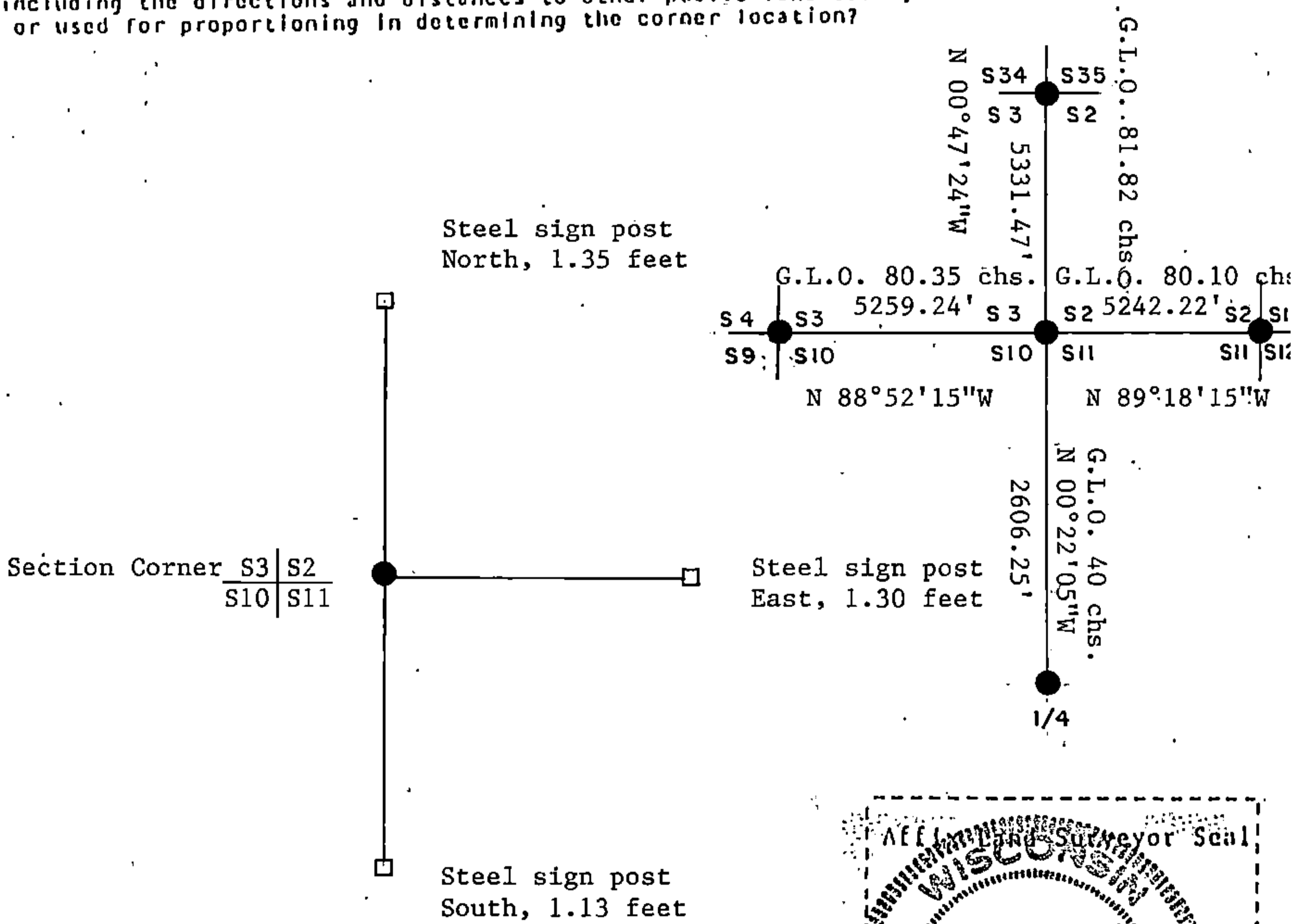

(i) I, Gary L. Pisoni  
 [type or print name] certify that the corner location shown on this record was determined by me or under my direction and control and that this U.S. Public Land Survey Monument Record is correct, and complete to the best of my knowledge and belief.

Gary L. Pisoni 11-17-95  
 Signature Date

Survey requested by: \_\_\_\_\_  
 District Ranger Date