

CERTIFIED LAND CORNER RESTORATION

Index No. E-25

State of Wisconsin }
County of Forest } ss.

I Philip T. Hansen, do hereby certify that on the 13th day of December, 19 76, I found evidence of the Section corner of Sec. 1, 6, 7, 12 Township 36, North, Range 15 & 16 East, Fourth Principal Meridian, as described hereon; and that from this evidence I established a new monument and accessories as described hereon to perpetuate the original location of this corner.

Resident witnesses:

Glen Barker

Jim Claflin

Herb Wagoner

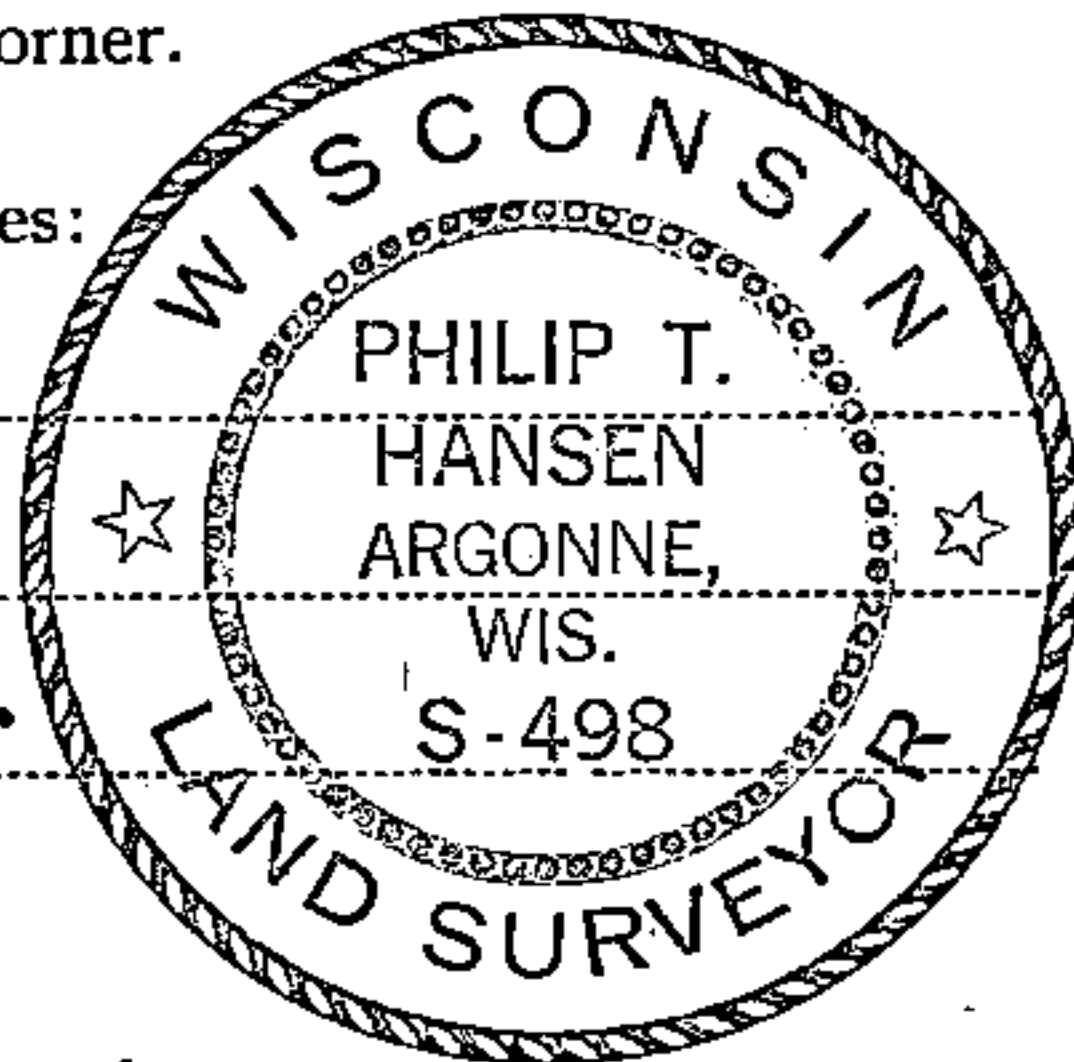

FORM 985, H. C. MILLER CO., MILWAUKEE

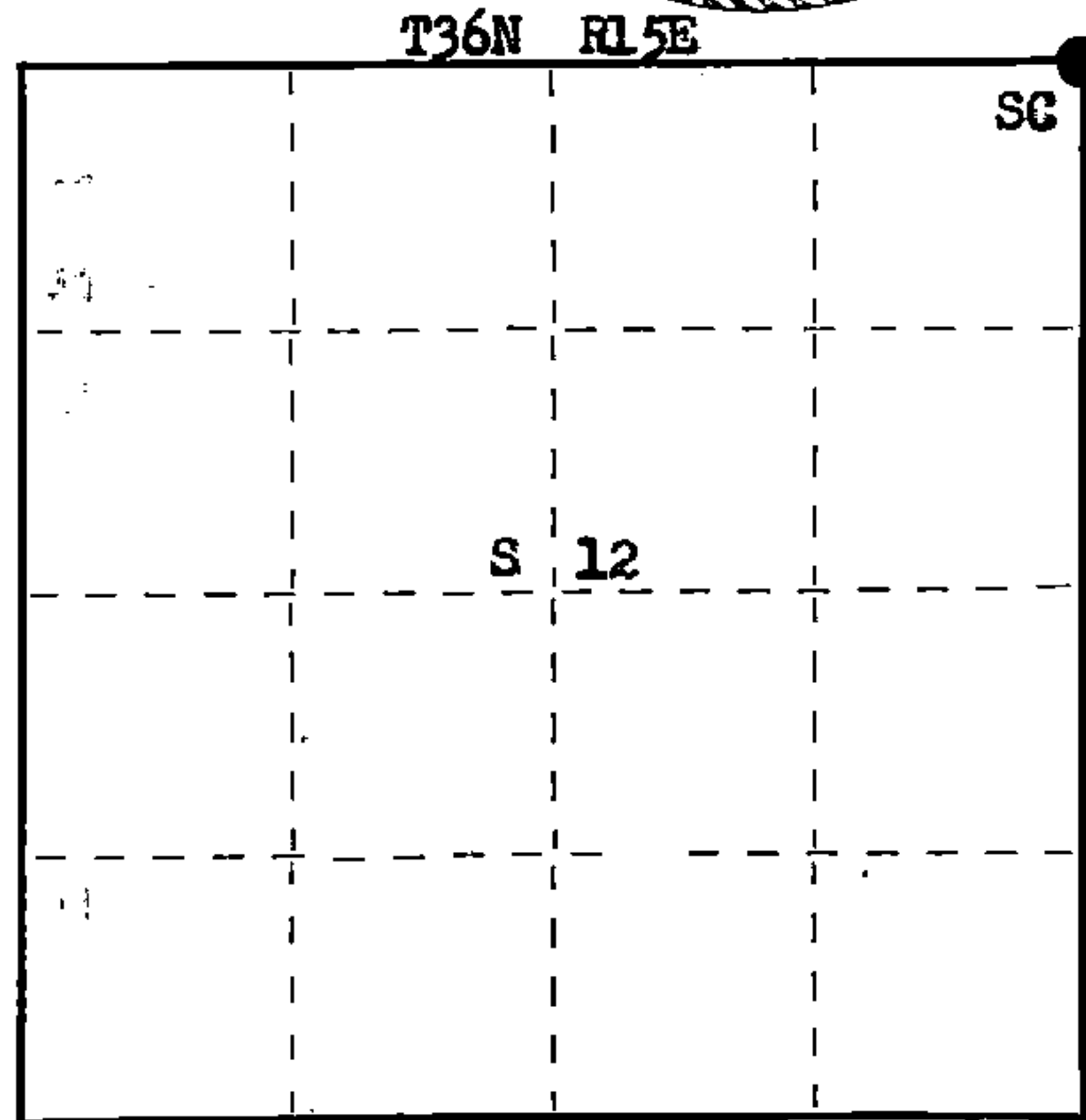

○ = Corner monument restored.

History of original corner establishment:

Original corner established by A. Curtis, Deputy Surveyor, in 1858 from which Tamarack 18" bears S 38° W 19 links, Cedar 9" bears N 54° W 18 links, Tamarack 16" bears N 72° E 21 links and Cedar 12" bears S 72° E 50 links.

Description of corner evidence found:

Recovered an old squared cedar post, lying down, covered with moss. Found the old point still intact in the muck.

Found an old Forest Service location poster on a 14" cedar identifying the corner to be N 87° E 26 links to Section Corner. Bearings and distance checked to old point.

Poster dated 10/28/36 H.C.P.

Recovered OBT - Cedar 10" N 28° W 14.8 links, scribed SI BT. No records on this BT.
Cedar 14" S 10° E 25.7 links, scribed SI BT. No records on this BT.

Description of monument and accessories I established to perpetuate the original location of this corner.

Replaced point of old post with 2 1/2" Berntsen A-1 Federal Monument, aluminum with magnet in cap and base. Cap stamped:

Monument projects 12" above ground.

NBT - Cedar 10" S 44° W 24.2 links, scribed SC BT.

Cedar 12" N 84° W 21.7 links, scribed SC BT.

R T36N R
15 1 | 6 16
E 12 | 7 E
S498-1976

Dated at Rhineland, Wis., this 5th day of January, 1977

Signature Philip T. Hansen Title Registered Land Surveyor Registration No. S-498
(County Surveyor, Registered Land Surveyor, or other duly authorized official)

Office of Register of Deeds, County of Forest, I hereby certify that the within instrument was filed in this office for record on the 21st day of January, 1977 at 4:00 o'clock P. M.

Eugene Deatney
(Register of Deeds)
By _____ Deputy

DOCUMENT NUMBER 110883

43015010000

U. S. PUBLIC LAND SURVEY MONUMENT RECORD

INDEX NO. E- 25

Section 1 Corner to Section 12 T 36N, R 15E
(Section/Quarter) 6 7 16

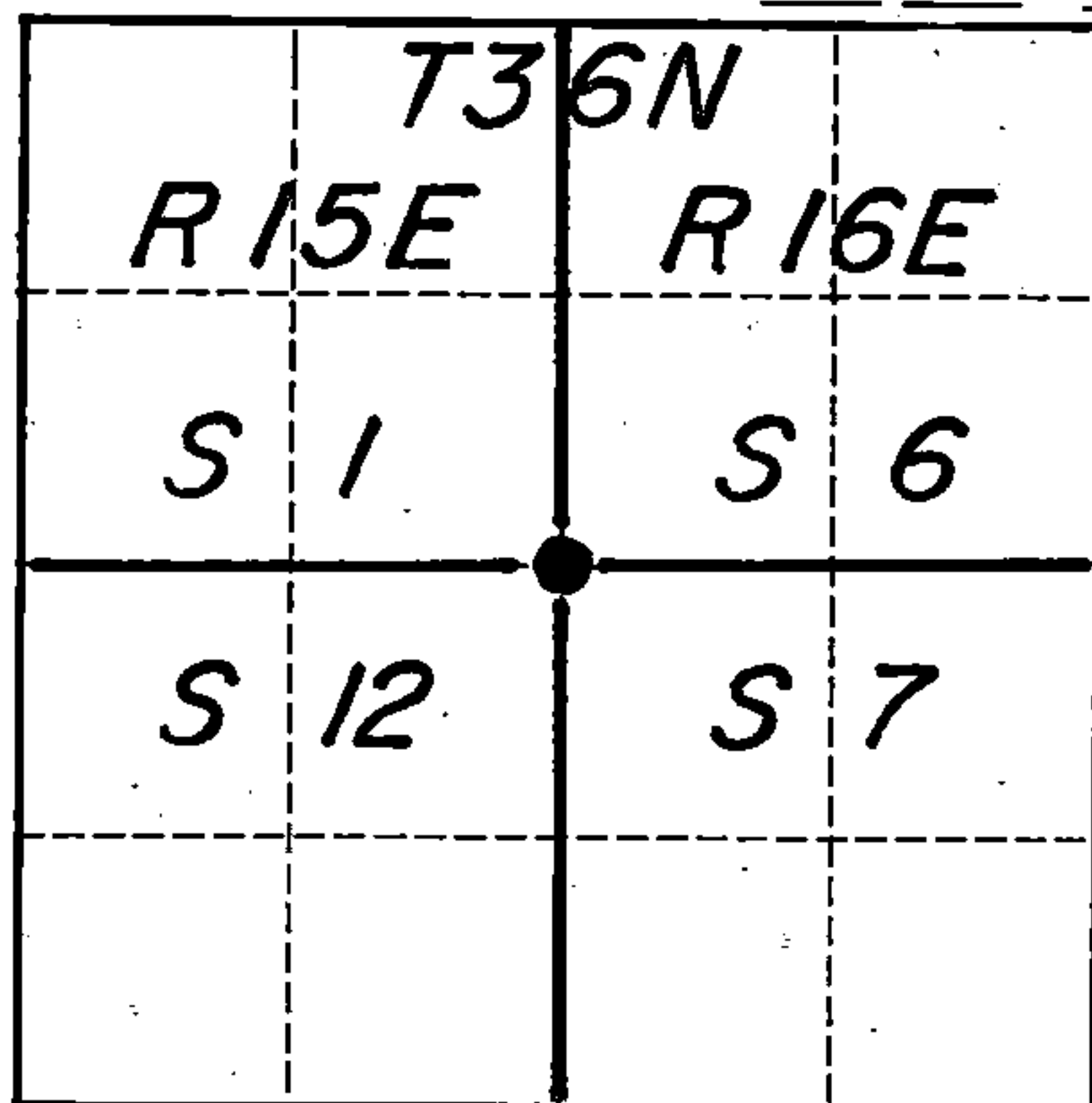

Show distances and bearings if set by proportional measurement.

○ = Corner monument restored.

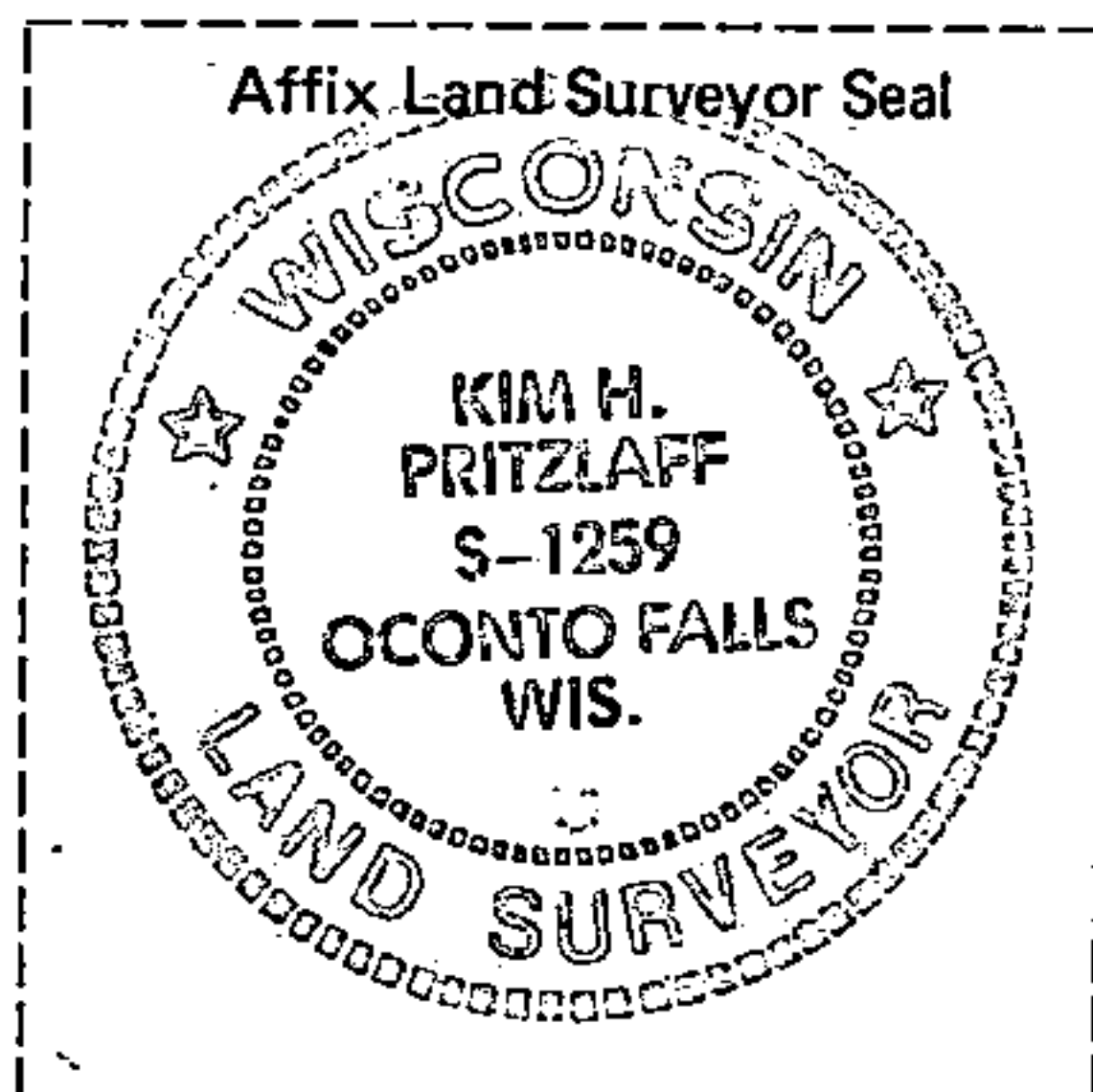

I, Kim H Pritzlaff, Contractor with USFS
 (Type or print name) certify that the corner location shown on this record was determined by me or under my direction and control and that this U.S. Public Land Survey Monument Record is correct and complete to the best of my knowledge and belief.

Kim H. Pritzlaff
 Signature

11/30/91
 Date

History of original corner establishment, record evidence, monument evidence, occupational evidence, testimonial evidence or any other material evidence, and what you found and how the monument was set.

In 1857 Artemus Curtis set a wood post at this corner location and scribed the following trees:

Tamarack	18"	S 38°W	19 links
Cedar	9"	N 54°W	18 links
Tamarack	16"	N 72°E	21 links
Cedar	12"	S 72°E	50 links

In 1977 Philip Hansen found an old squared wood post and Forest Service CCC tag from 1936. He also recovered two old BTs with no record of distances, bearings or who scribed them. He replaced the cedar post with an aluminum Forest County monument and marked two new Cedar BTs.

I found Hansen's monument and the BTs at this corner location with distances all checking as he stated. The monument was unstable, however, and I replaced it with a pointed aluminum monument 2½'x 36" long with stamped cap. One of his Cedar trees was found cut so I replaced the tie with another Cedar BT and a steel sign post as shown below.

In the plan view drawing below, provide reference ties to at least 4 witness monuments, or, if the location is within a municipality, to at least 2 witness monuments. (Witness monuments shall be made of concrete, natural stone, iron or other equally durable material, except wood other than bearing trees.) Also, show any material discrepancies between the corner restored or re-established and the location of any other previous corner location or occupation.

The corner consists of a 2½'x 36" aluminum monument set 3" protruding from the swamp floor with a cap stamped for the corner. Distances are to nails driven into the tree centers which were all scribed and blazed, painted and signed to USFS standard. Bearings are magnetic.

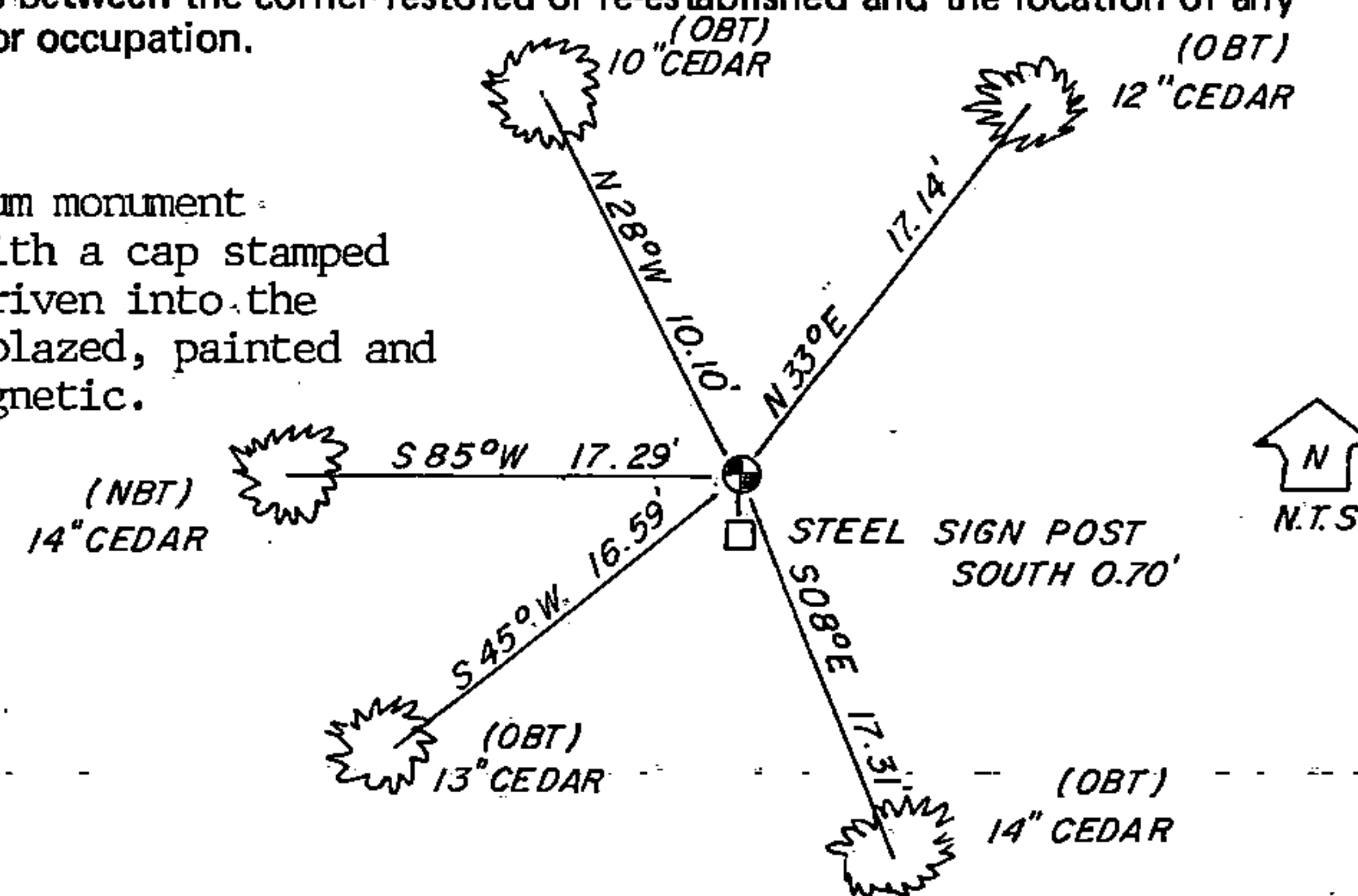

REGISTER'S OFFICE
 -Forest County, Wis.

Received for record this 30 day
 of JANUARY A.D., 1992 at
9:30 o'clock A.M. and recorded
 in Vol Corner Restorations
 page E-25

Paul Scheepers
 Register of Deeds



DOCUMENT NUMBER
143546

4421015101547