

224825

RS-7150-11 (9/1/66)

CERTIFIED LAND CORNER RESTORATION

State of Wisconsin }
County of Forest } ss.

I Randy R. Erickson, do hereby certify that on the 6th day of April, 2012, I found evidence of the Northeast corner of Section 30 Township 36 North, Range 14 East, Fourth Principal Meridian, as described hereon; and that from this evidence I established a new monument and accessories as described hereon to perpetuate the original location of this corner.

Description of original monument and accessories and subsequent restorations:

1859 James McBride set a wood post and marked Bearing Trees:

Table with 4 columns: Tree type, Diameter, Bearing, Distance. Includes Sugar (12", N 61° W, 13 lks), Elm (18", N 71° E, 17 lks), Elm (14", S 76° E, 31 lks), Sugar (12", S 44° W, 57 lks).

Found no other records of subsequent perpetuations.

Description of corner evidence found:

Found a 1 1/2" x 48" iron pipe. Believe it was set many years ago by Conner Lumber Company. Accepted pipe as best evidence of Corner.

Description of monument and accessories I established to perpetuate the location of this corner:

Replace pipe with a 2 1/2" x 36" aluminum monument set 30 inches in the ground with an aluminum cap stamped to identify the corner. Marked bearing trees:

Table with 4 columns: Tree type, Diameter, Bearing, Distance. Includes Sugar (9", N 88° W, 49.25 feet), Sugar (13", N 20° E, 6.11 feet), Sugar (6", N 32° W, 23.89 feet), Sugar (15", S 16° E, 34.28 feet), Steel Sign Post (West, 0.65 feet).

Established Wisconsin North Zone State Plane Coordinates for Corner:

N 152833.74 E 2281446.33 Nad 83 1991, U.S. Foot

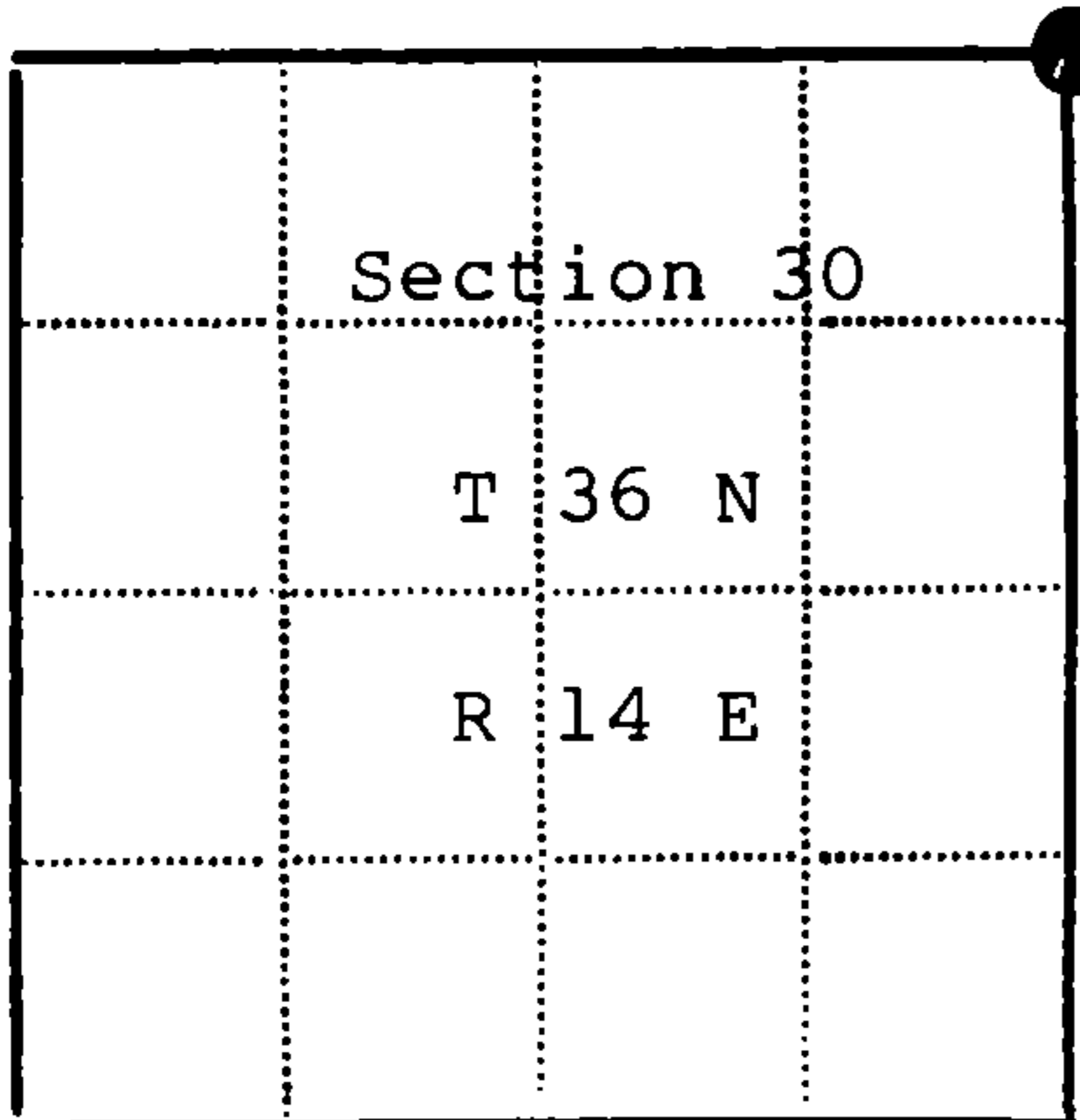
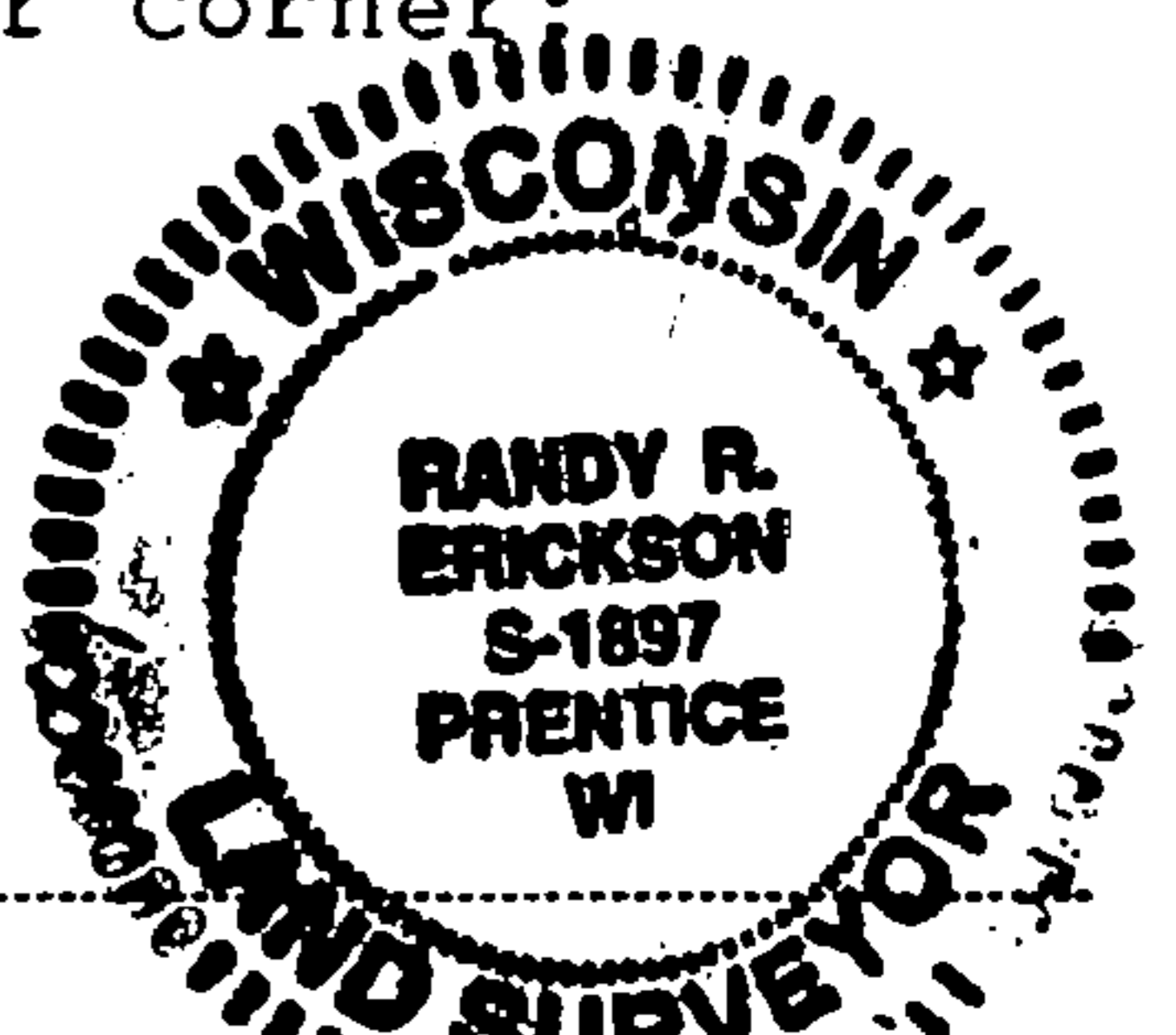

Legend: Black dot = Corner monument restored; Square =

Resident witnesses

Dated at Park Falls Wisconsin, this 13 day of Nov 19 2014

Signature [Handwritten] Title P.L.S. (County Surveyor, Registered Land Surveyor, or other duly authorized official)

Surveyors Registration No. 1897

Office of REGISTER OF DEEDS County of FOREST

I hereby certify that the within instrument was filed in this office for record on the 12th day of MARCH 2012, and was filed in Book No. RESTRICTIONS Page No. R-5 of County Records.

Signature [Handwritten] Title REGISTER OF DEEDS

Township 36 North, Range 14 East, Section 30, Index No. R-5, Page No.