

U. S. PUBLIC LAND SURVEY MONUMENT RECORD

INSTRUCTIONS:

This record shall show the location of the corner and shall include all of the following nine elements (a through i).

- (a) Identify the corner by reference to the U.S. public land survey system.
- = Corner monument restored.

Quarter corner to Sections 7 & 8,  
T36N, R14E

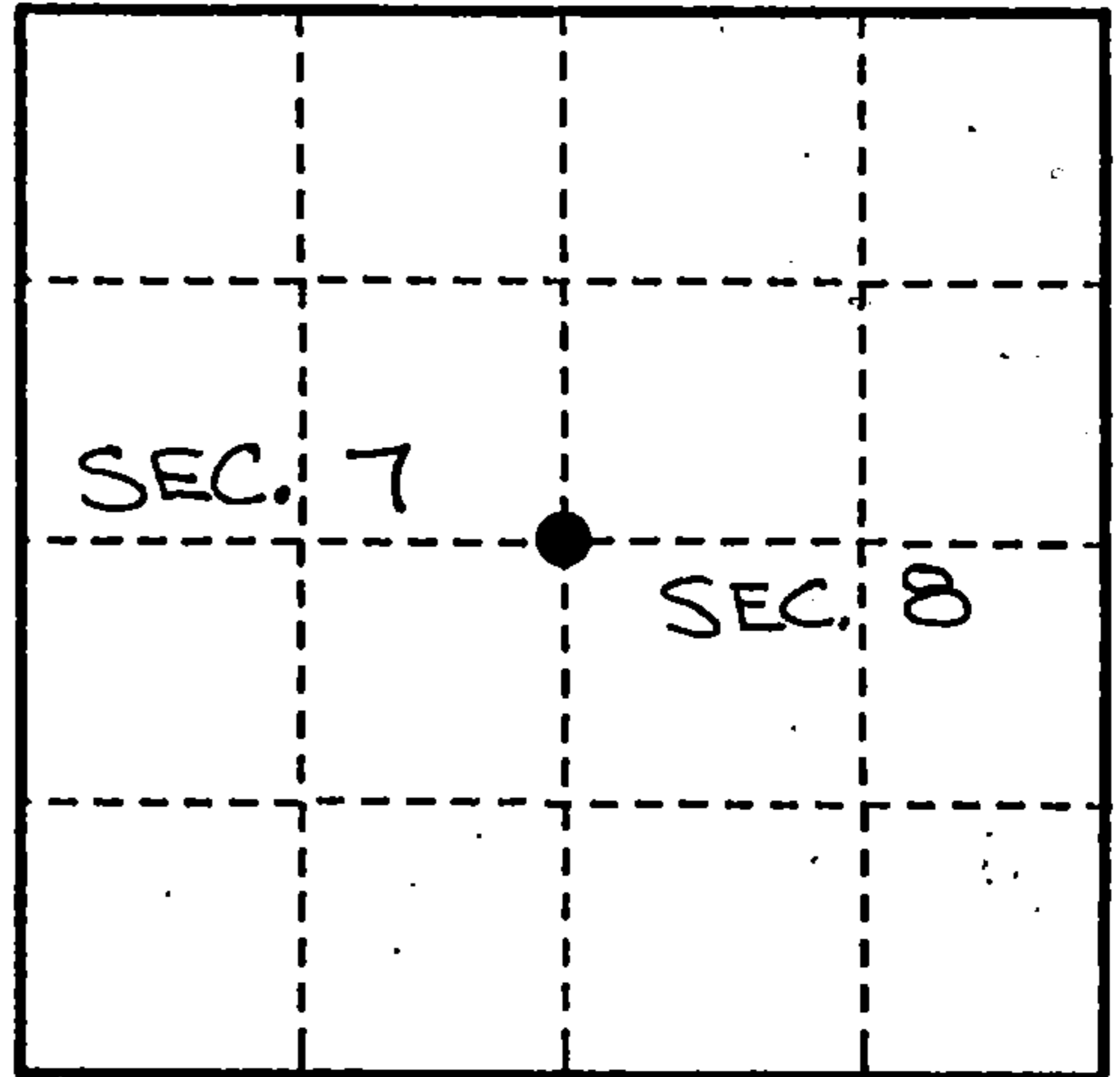

- (b) Describe any record evidence, monument evidence, occupational evidence, testimonial evidence or any other material evidence you considered, and whether the monument was found or placed.

Original corner set by James McBride in July 1859.

Original Bearing Trees:

- Cedar - 14" - N75°W - 10 links (6.60')
- Cedar - 14" - S45°E - 17 links (11.22')

I positioned the corner at a proportionate location from which to search. The corner falls in a very thick cedar swamp. I could find no evidence of the original bearing trees and could not make the natural feature ties from the original notes coincide with a satisfactory location from the math point.

I monumented the proportionate location after a thorough search of the area could reveal no original evidence. Our position falls on the edge of an old trail running S5°E.

- (c) In the plan view drawing below, provide reference ties to at least 4 witness monuments, or, if the location is within a municipality, to at least 2 witness monuments. (witness monuments shall be made of concrete, natural stone, iron or other equally durable material.)

- (d) Show a plan view drawing depicting the relevant monuments and reference ties which is sufficient in detail to enable accurate relocation of the corner monument if the corner monument is disturbed. Indicate north.

Set a 2 1/4" diameter x 5' long aluminum monument w/a 3 1/4" diameter tablet marked: 1/4, S7, S8, T36N, R14E, 1992, S1685

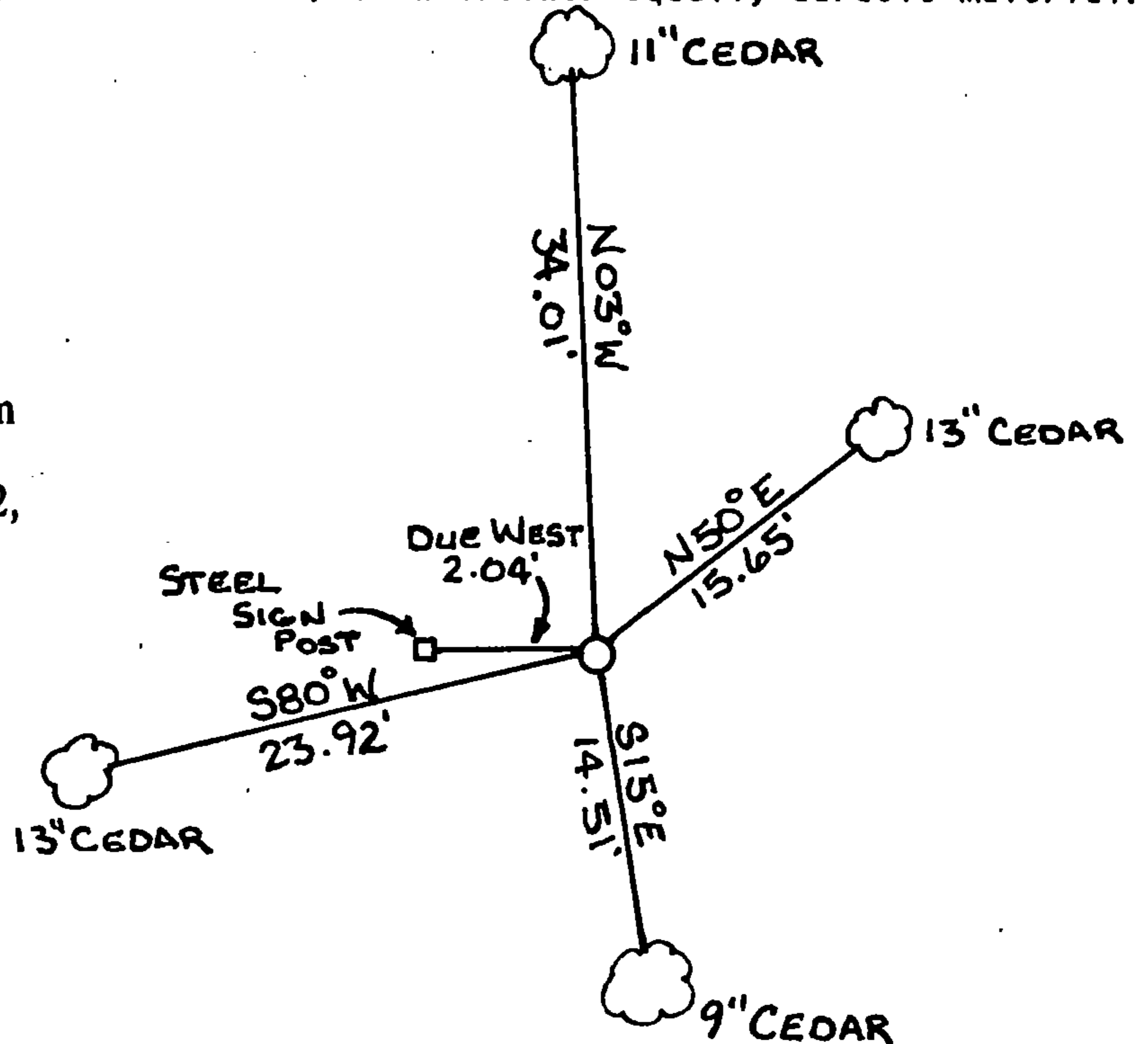

REGISTER'S OFFICE  
Forest County, Wis.  
Received for record this 2nd day  
of June A.D. 1993 at  
12 o'clock P.M. and recorded  
in Vol. 65 and recorded  
page 65  
*Paul Chitko, Deputy*  
Register of Deeds

(e) Describe any material discrepancy between the location of the corner as restored or reestablished and the location of that corner as previously restored or reestablished by distance and direction. Show the discrepancy on the plan view drawing under (d), above. Show the distances between the corner as previously restored or reestablished and (1) the corner as restored or reestablished, and (2) to at least 2 of the witness monuments shown on the drawing in (d), above.

(f) Was the corner restored through acceptance of (1) an obliterated evidence location, or, (2) a found perpetuated location?

(g & h) Was the corner reestablished through lost corner proportionate methods? If so, show the method, including the directions and distances to other public land survey corners used as evidence or used for proportioning in determining the corner location?

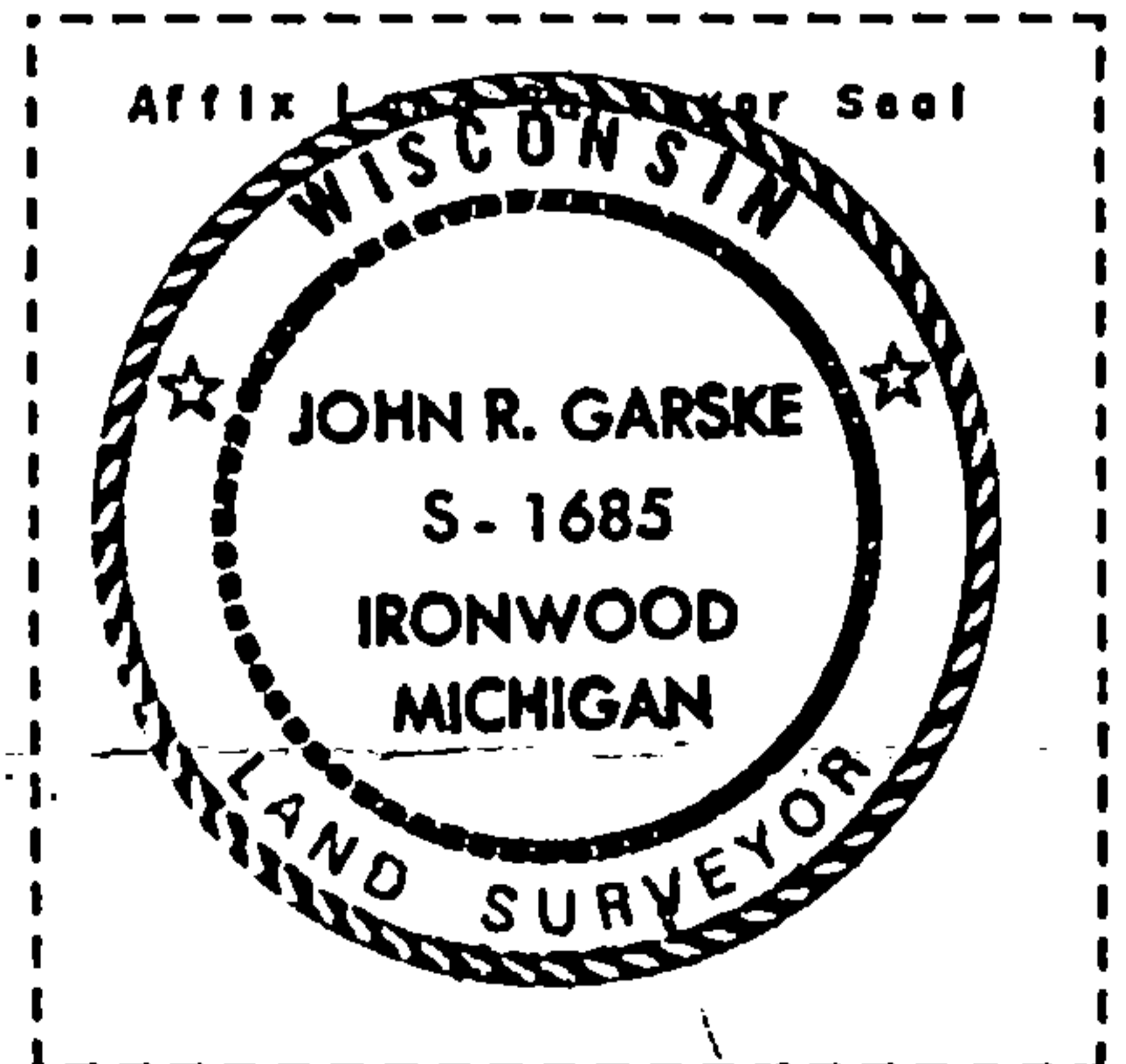
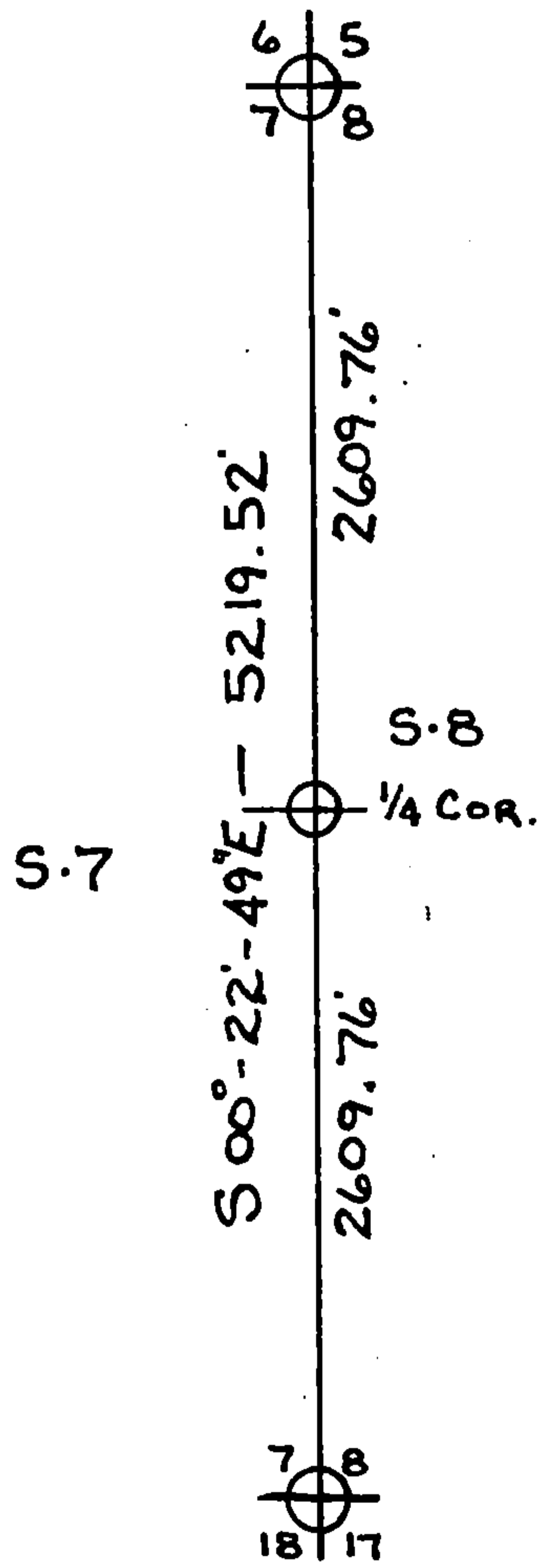

(1) I, John R. Garske

(type or print name) certify that the corner location shown on this record was determined by me or under my direction and control and that this U.S. Public Land Survey Monument Record is correct and complete to the best of my knowledge and belief.

John R. Garske  
Signature

1-13-93  
Date

CERTIFICATE READY FOR FILING:

Sue Vap  
District Ranger