

CERTIFIED LAND CORNER RESTORATION

Index No. **E 5**

State of Wisconsin }
County of Forest } ss.

I Philip T. Hansen, do hereby
certify that on the 15th day
of December, 1975, I found
evidence of the Section
corner of S5, 6, 7, and 8
Township 36, North, Range
14 East, Fourth Principal Meridian,
as described hereon; and that from this evidence
I established a new monument and accessories
as described hereon to perpetuate the original
location of this corner.

Resident witnesses:

Glen Barker

Jim Claflin

Tom Jewell

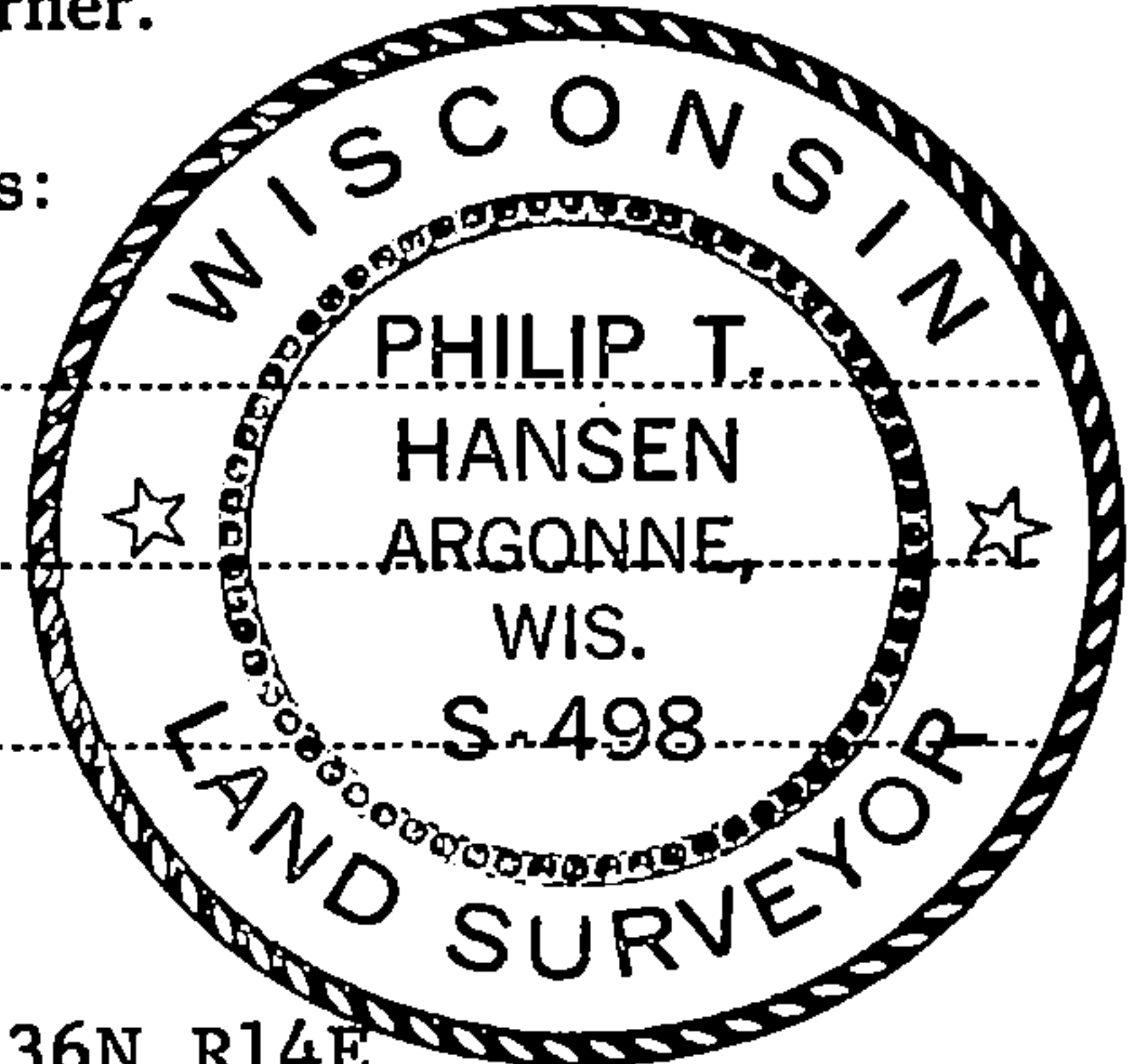

T36N R14E

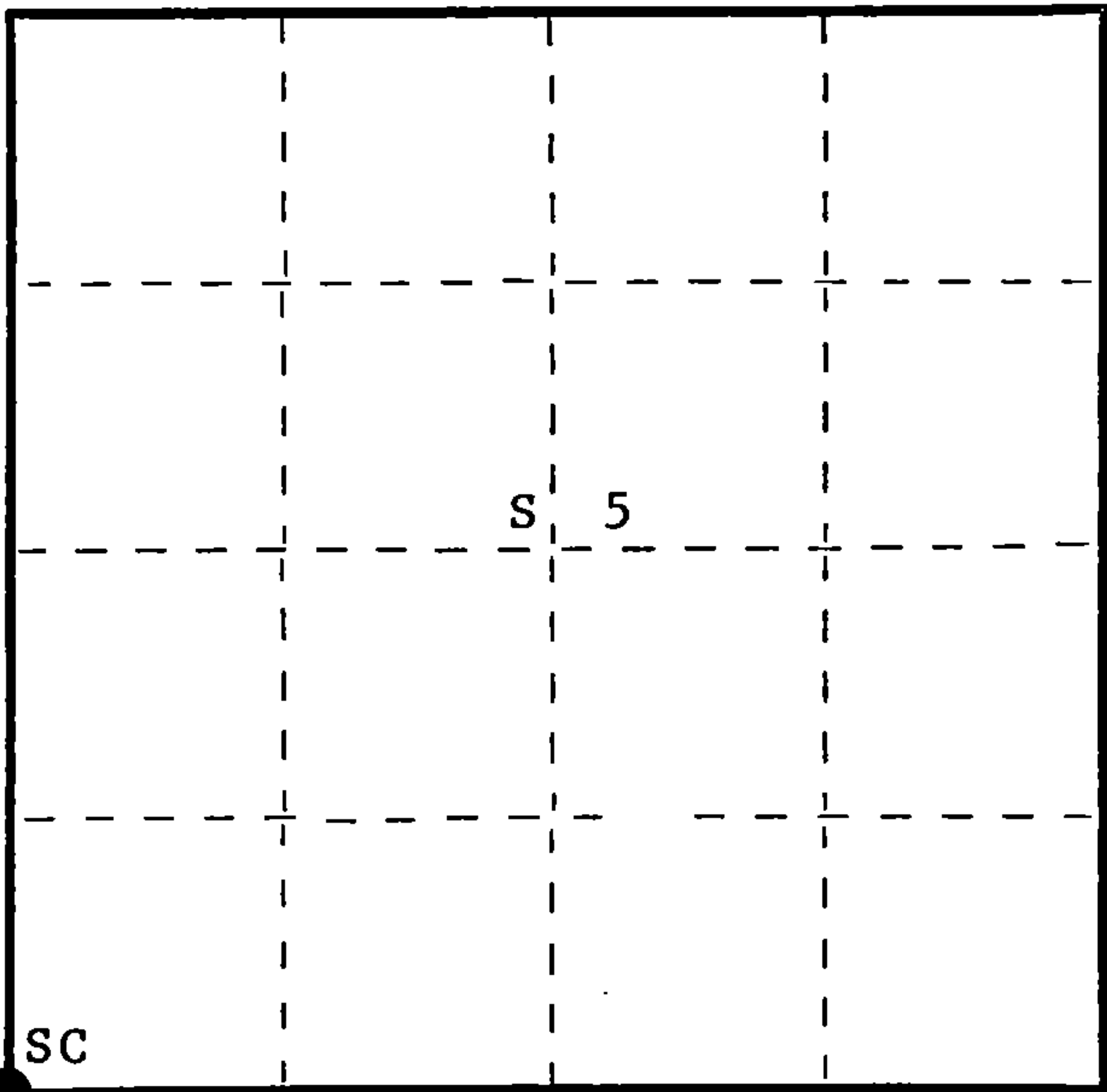

○ = Corner monument restored.

History of original corner establishment: Original corner established by James McBride, Deputy Surveyor, in 1859, from which sugar 7" bears N46°W 24 links, sugar 7" bears N26°E 34 links, birch 10" bears S67°E 15 links, and sugar 14" bears S15°W 40 links. This corner recovered by Ray Leigh about 1945. Recovered old wooden post. Set 1½" iron pipe to preserve it.

Description of corner evidence found: Recovered 4" squared wooden post, no scribing visible, and 1½" iron pipe setting beside it. Post scribed S5, S6, S7, and S8 in poor condition. Unable to locate any evidence of OBT's.

Description of monument and accessories I established to perpetuate the original location of this corner.

Replaced old wood post with 2½" Berntsen A-1 Federal Monument, aluminum, with magnet installed in cap and base. Pipe projects 18" above ground. Cap stamped -

Set 1½" iron pipe beside new pipe.

NBT's - Sugar 12" S53°E 70 links, scribed SC BT.
Sugar 6" N23°W 59.7 links, scribed SC BT.
Elm 8" N83°E 84.1 links, scribed SC BT.

Pipe and NBT's painted blue.

Dated at Argonne, Wis., this 22nd day of December, 1975.

Signature Philip T. Hansen Title Registered Land Surveyor Registration No. S-498
(County Surveyor, Registered Land Surveyor, or other duly authorized official)

Office of Register of Deeds, County of Forest, I hereby certify that the within
instrument was filed in this office for record on the 5th day of January, 1976
at 2:45 o'clock P.M.

EUGENE STATEZNY
(Register of Deeds)

DOCUMENT NUMBER 108493

By Eileen Schmidt Deputy

FORM 985 H. C. MILLER CO., MILWAUKEE

4361460000