

CERTIFIED LAND CORNER RESTORATION

Index No. E-9

E 9

State of Wisconsin }
County of Forest } ss.

I Glen Barker, do hereby certify that on the 5th day of November, 1982, I found evidence of the Section corner of Sections 4-5-8-9 Township 36, North, Range 14 East, Fourth Principal Meridian, as described hereon; and that from this evidence I established a new monument and accessories as described hereon to perpetuate the original location of this corner.

Resident witnesses:

Jim Claflin, Reg. Land Surveyor

H. Wagoner

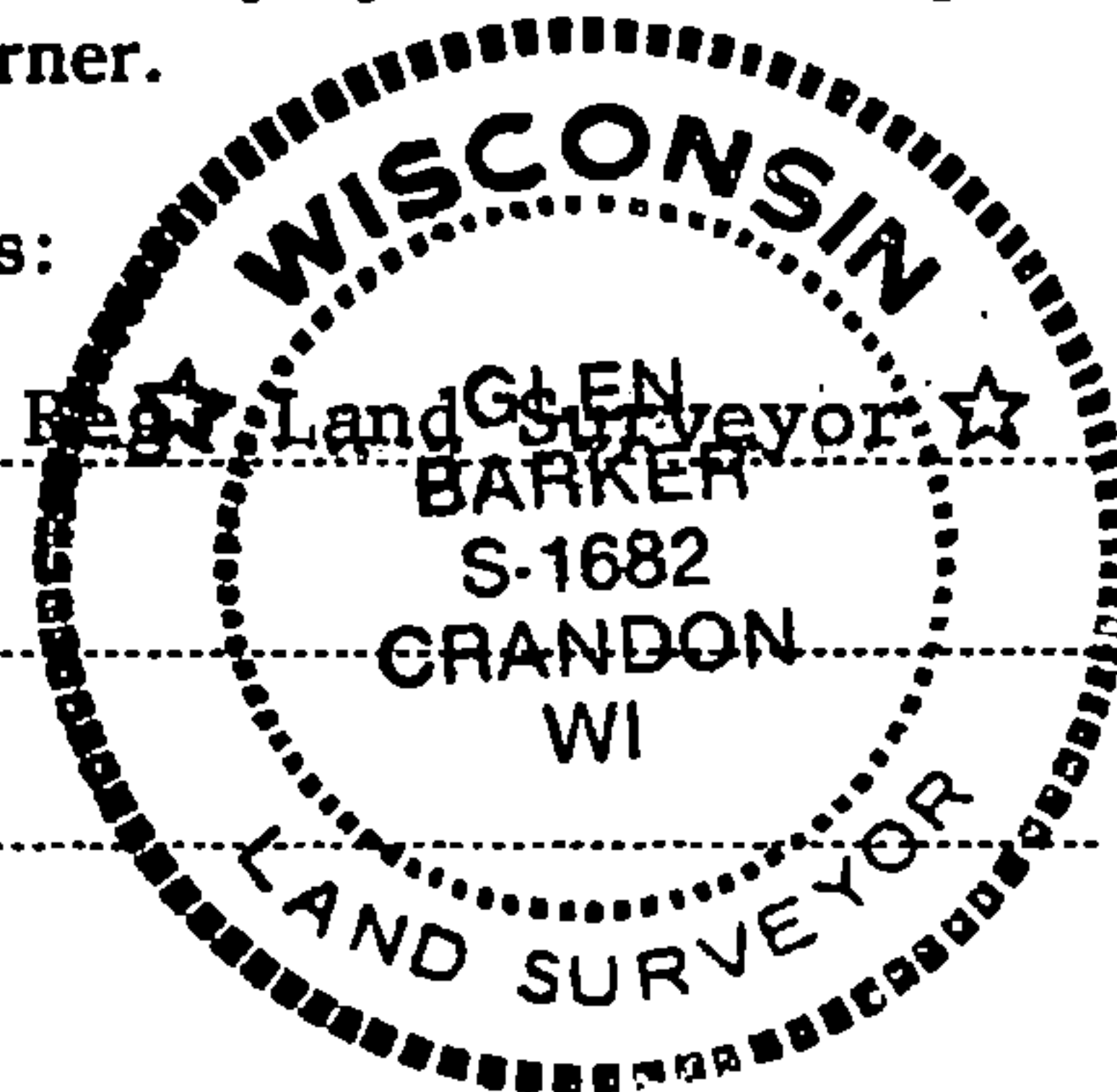

T36N R14E

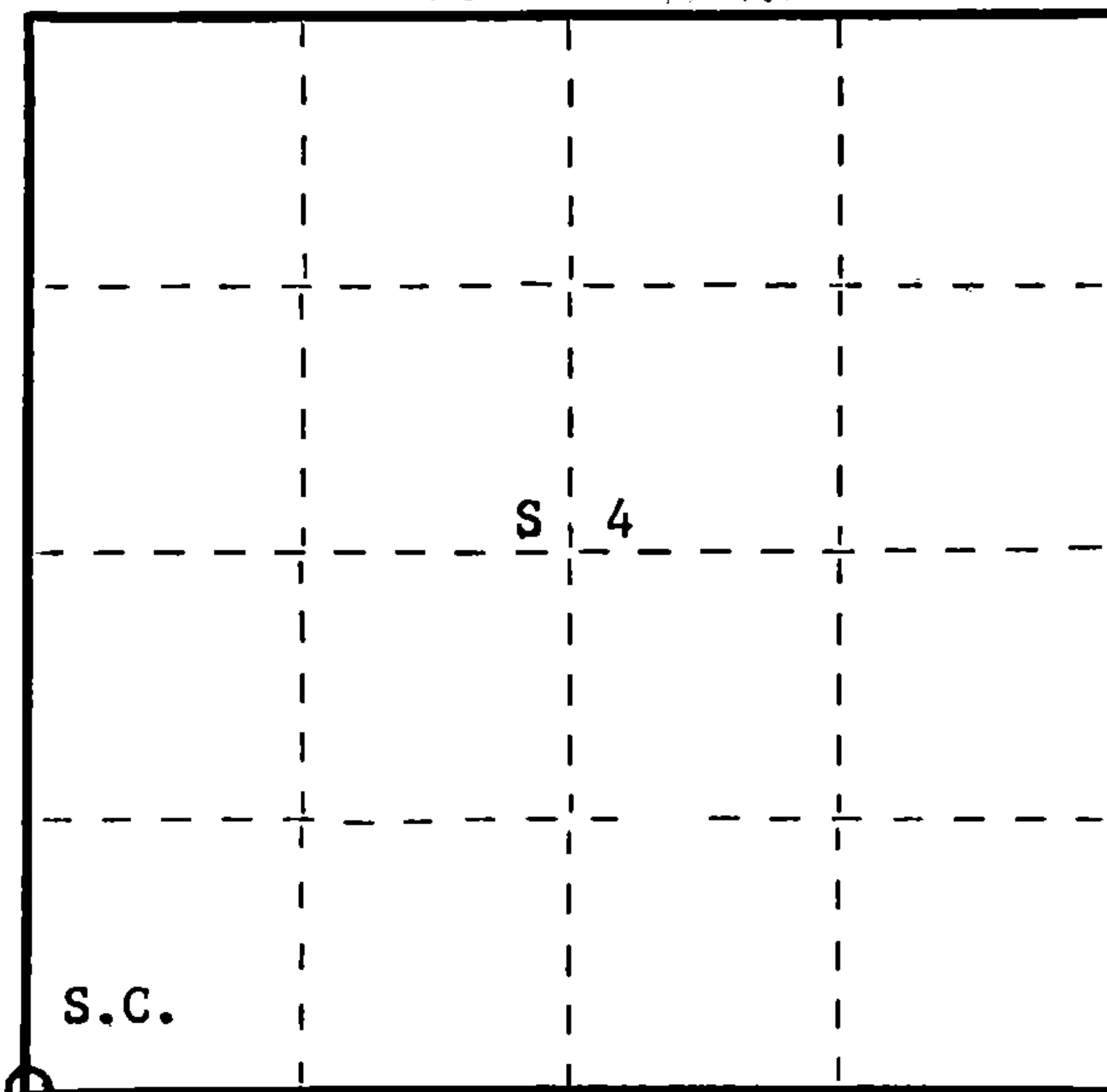

○ = Corner monument restored.

History of original corner establishment:

Original corner established by James McBride, government deputy surveyor, in 1859 from which Tamarack 52" bears N17W 30 links; Cedar 10" N5°E 14 links; Cedar 6" S88E 18 links and Fir 5" S25W 22 links.

Description of corner evidence found:

Recovered a very old 1-1/2" squared cedar post badly decayed, also an old 3" squared cedar post laying down under moss and muck in cedar blow down.

Original B.T.:

Tamarack 52" N17W 30 links
now a rotted stump

Description of monument and accessories I established to perpetuate the original location of this corner.

Placed a 2-1/2" A-1 Forest County monument in position of old post point, stamped: Monument projects 12" above ground.

Marked NBT's:

Cedar 6" S11W 25.42 feet
Cedar 10" S42E 28.75 feet
Cedar 12" S84E 27.0 feet
scribed S.C. - B.T.

T36N R14E
S.C. $\frac{5}{8} + \frac{4}{9}$
S1682-1982

Dated at Rhinelander, Wis., this 21st day of March, 1983

Signature Glen Barker Title Registered Land Surveyor Registration No. S-1682
(County Surveyor, Registered Land Surveyor, or other duly authorized official)

Office of Register of Deeds, County of Forest, I hereby certify that the within instrument was filed in this office for record on the 7th day of April, 1983 at 9:30 o'clock A. M.

Eugene Starynski
(Register of Deeds)
By.....Deputy

DOCUMENT NO. **123143**

Stock No. 26272

FORM 985

43614051010