

U.S. PUBLIC LAND SURVEY MONUMENT RECORD

Index No. E-19

State of Wisconsin

County of Forest ss.

I Gary L. Pisoni do hereby certify that on the 30th day of August, 1994, I found evidence of the North Quarter corner of Section 11 Township 36 North, Range 14 East, Fourth Principal Meridian, as described hereon; and that from this evidence I established a new monument and accessories as described hereon to perpetuate the original location of this corner.

Resident witnesses:

History of original corner establishment:

Original Government Survey in 1859 by James McBride, deputy surveyor. West corrected at 39.80 chs. between Sections 2 and 11, set Quarter Section post from which the following bear: Tamarack, 8", N 14° W, 20 lks; Birch, 10", S 43° E, 70 lks.

In 1985, Glen Barker RLS, found two old squared cedar stakes and three old cedar points buried in muck. Replaced old stakes with a 2 1/2" dia. aluminum Forest County monument with and aluminum cap from which the following bear:

Hemlock 8"	N 22° E	13.60 feet	Hemlock 15"	S 72° E	35.28 feet
Hemlock 8"	S 06° E	37.72 feet	Cedar 7"	N 30° W	21.30 feet

Description of corner evidence found:

Found the monument and bearing trees as described above:

Hemlock 11"	N 22° E	13.91 feet
Hemlock 16"	S 71° E	35.19 feet
Hemlock 11"	S 05° E	37.31 feet
Cedar 9"	N 32° W	25.58 feet

Description of monument and accessories I established to perpetuate the original location of this corner.

Set an additional assessorary at the corner position:

Steel sign post	N 85° W	1.0 feet
-----------------	---------	----------

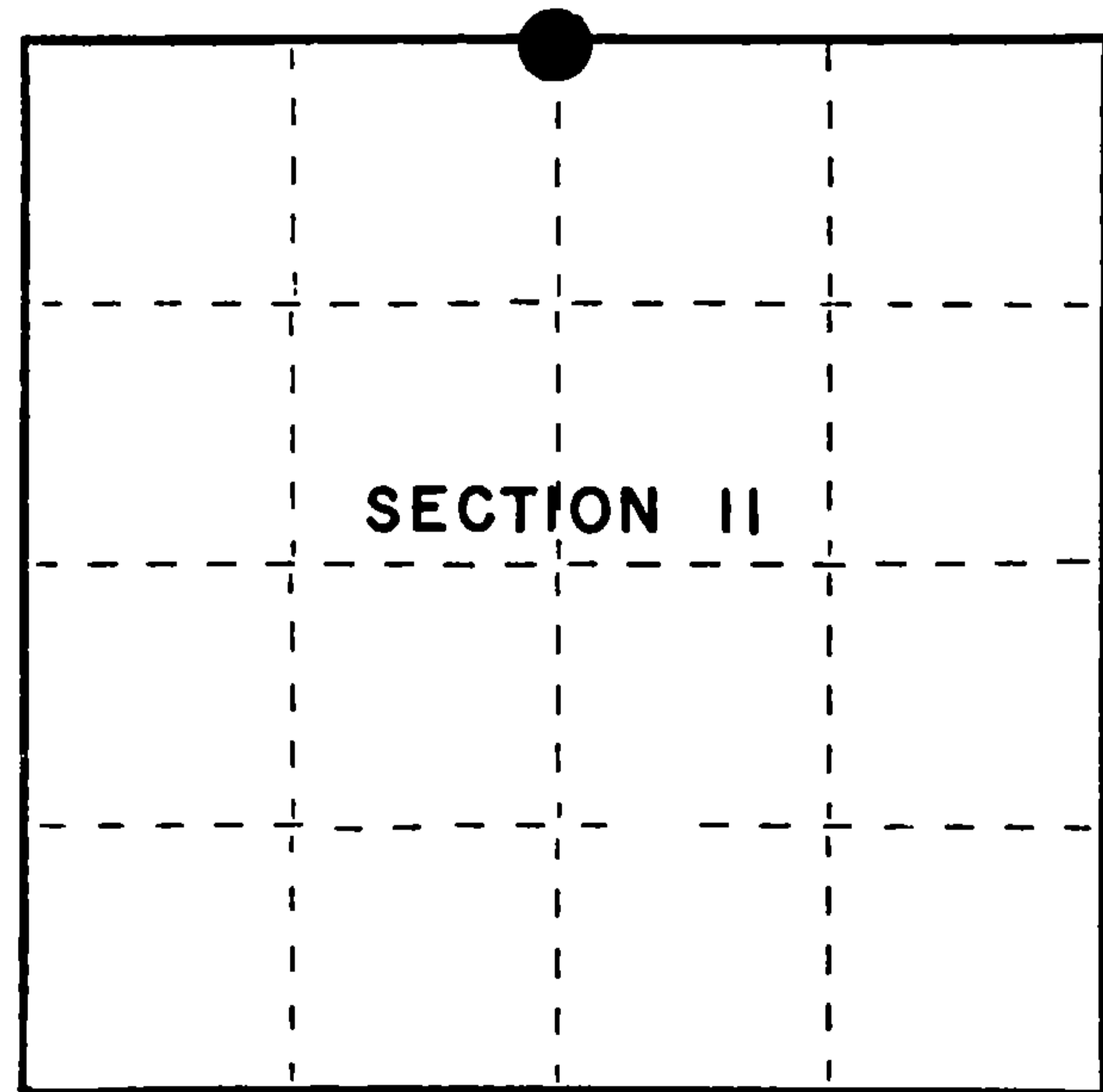

● = Corner monument restored.

Dated at Iron River, MI, this 12th day of June, 1995

Signature Gary L. Pisoni Title Land Surveyor Registration No. S-1634 (County Surveyor, Registered Land Surveyor, or other duly authorized official)

Office of Register of Deeds, County of Forest, I hereby certify that the within instrument was filed in this office for record on the 20th day of March, 1997 at 1:30 o'clock P.M.

(Register of Deeds) By [Signature] Deputy

FORM NO. 985-A



Stock No. 26273

158092

43614020020

(e) Describe any material discrepancy between the location of the corner as restored or reestablished and the location of that corner as previously restored or reestablished by distance and direction. Show the discrepancy on the plan view drawing under (d), above. Show the distances between the corner as previously restored or reestablished and (1) the corner as restored or reestablished, and (2) to at least 2 of the witness monuments shown on the drawing in (d), above.

None

(f) Was the corner restored through acceptance of (1) an obliterated evidence location, or, (2) a found perpetuated location?

Restored through acceptance of a found perpetuated location.

(g&h) Was the corner reestablished through lost corner proportionate methods? If so, show the method, including the directions and distances to other public land survey corners used as evidence or used for proportioning in determining the corner location?

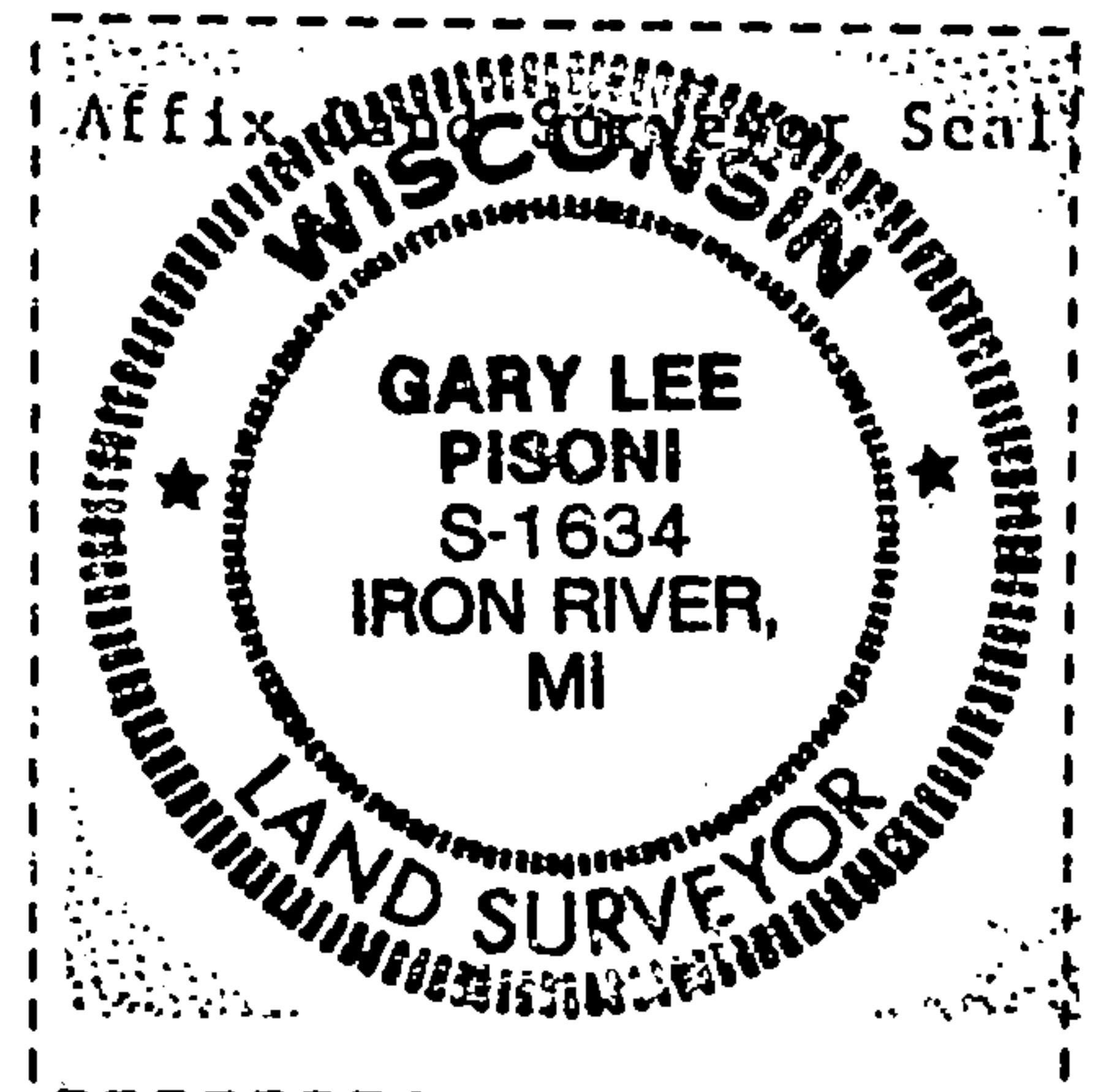
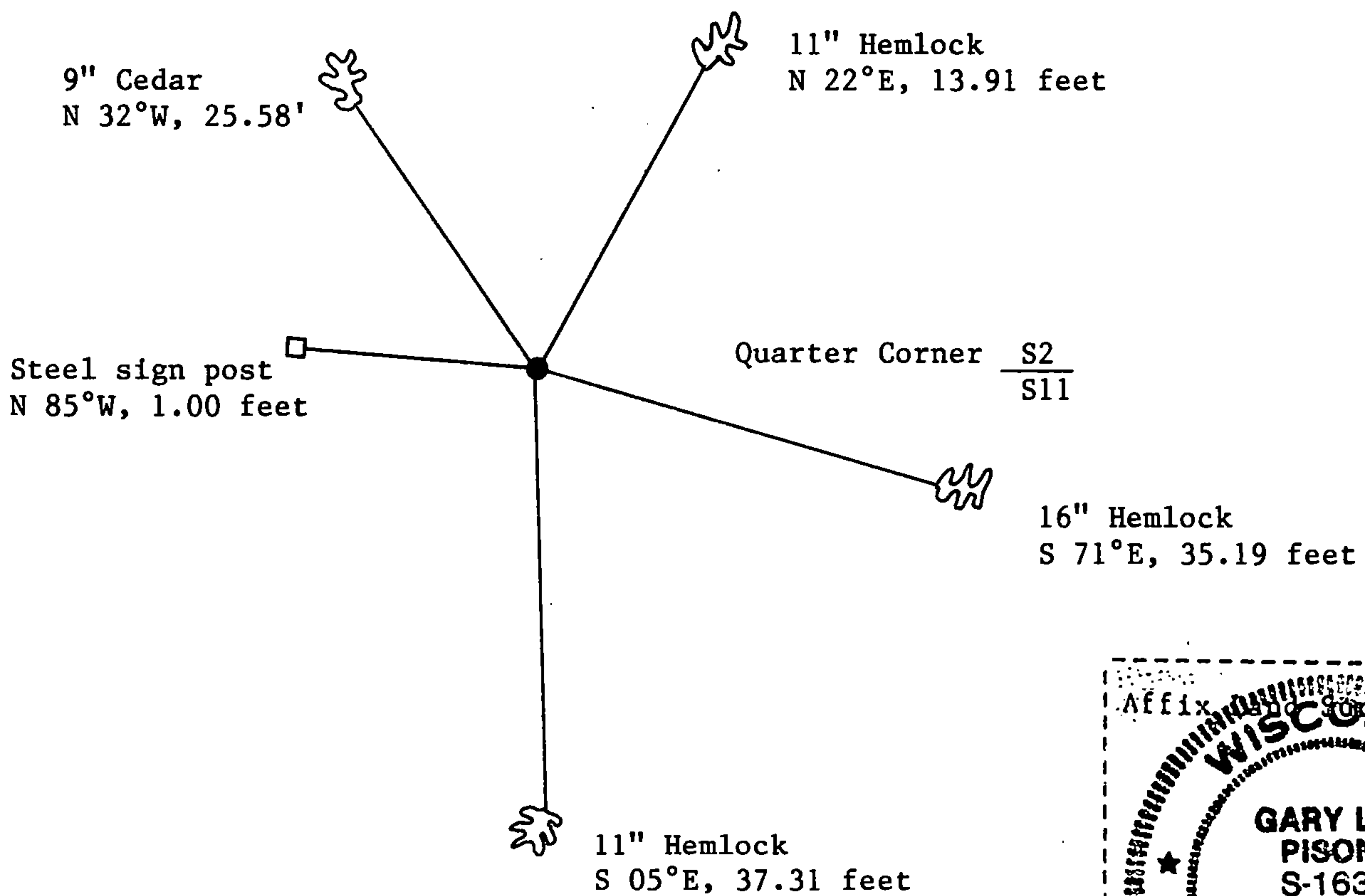

(i) I, Gary L. Pisoni  
(type or print name) certify that the corner location shown on this record was determined by me or under my direction and control and that this U.S. Public Land Survey Monument Record is correct and complete to the best of my knowledge and belief.

Gary L. Pisoni Signature 6-24-95 Date