

CERTIFIED LAND CORNER RESTORATION

Index No. E-21

State of Wisconsin }
County of Forest } ss.

I Gary L. Pisoni, do hereby certify that on the 19th day of August, 1993, I found evidence of the Northwest Section corner of Section 12 Township 36, North, Range 14 East, Fourth Principal Meridian, as described hereon; and that from this evidence I established a new monument and accessories as described hereon to perpetuate the original location of this corner.

Resident witnesses:

History of original corner establishment:

Original Government Survey in 1859 by James McBride, deputy surveyor. West corrected between Sections 1 and 12 at 79.80 chains, set Section corner post from which the following bear: Hemlock, 12", N 36°W, 28 lks; Hemlock, 16", N 38°E, 17 lks; Cedar, 12", S 61°E, 31 lks; Hemlock, 10", S 53°W, 60 lks.

In 1982, Daniel K. Pleoger RLS, found an old post point and an old Forest Service location tag on a nearby tree. He accepted the post point as the best available evidence for restoring the corner position. Replaced post point with a 2½" dia. aluminum pipe monument with an aluminum cap from which the following bear:

Description of corner evidence found:

Sugar	5"	N 67°E	8.30 feet
Sugar	8"	S 24°W	12.23 feet
Sugar	7"	N 61°W	23.98 feet

Found the monument and bearing trees as described above:

Sugar Maple	4"	N 68°E	8.49 feet
Sugar Maple	12"	S 25°W	12.90 feet
Sugar Maple	11"	N 60°W	23.44 feet

Description of monument and accessories I established to perpetuate the original location of this corner.

Blazed and scribed the following new bearing trees: (Measurements taken to a nail in side of tree)

Basswood	11"	S 68°W	25.71 feet
Steel sign post		N 14°W	1.24 feet

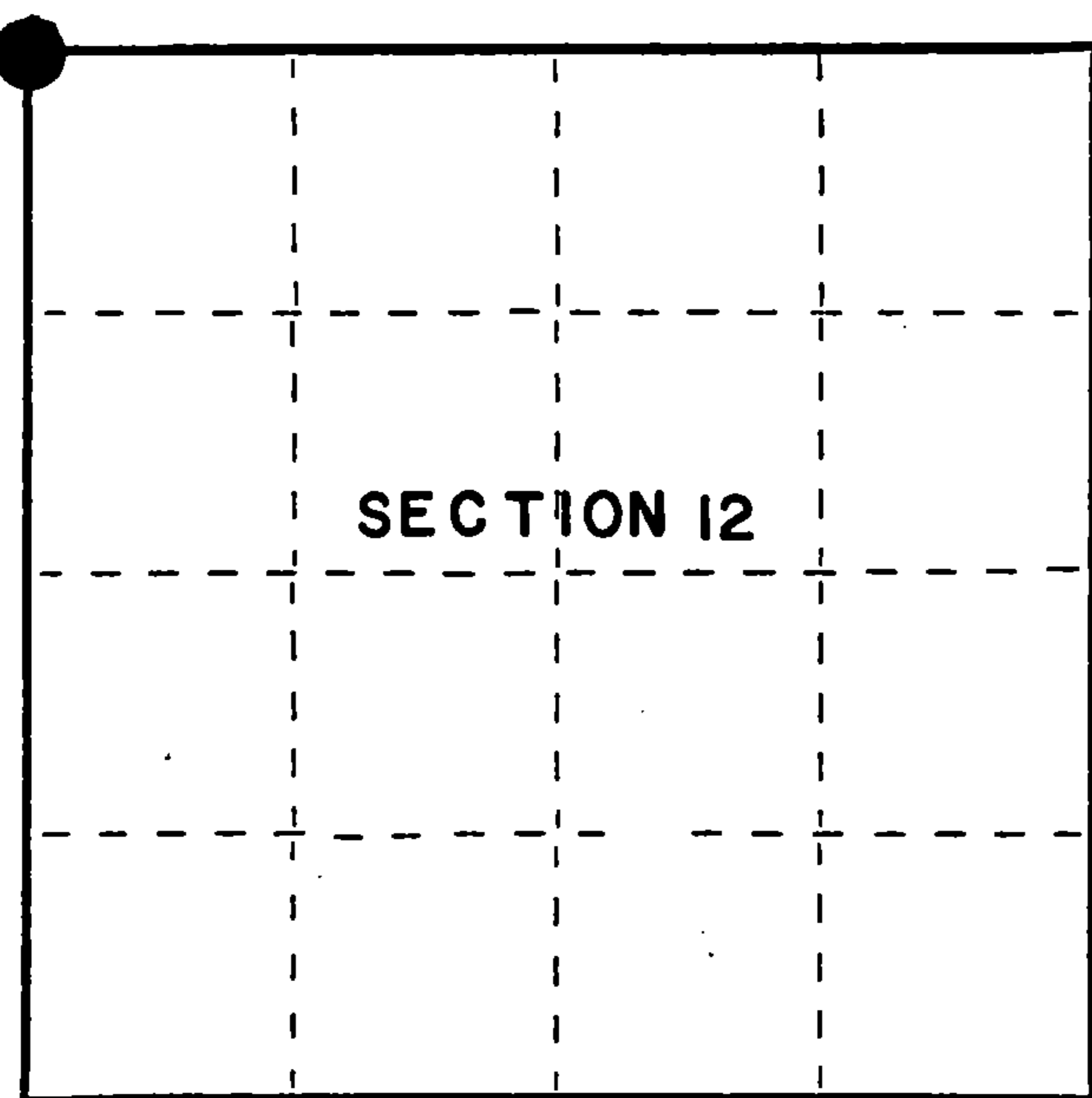

● = Corner monument restored.

Dated at Iron River, MI, this 12th day of June, 1995

Signature Gary L. Pisoni Title Land Surveyor Registration No. S-1634
(County Surveyor, Registered Land Surveyor, or other duly authorized official)

Office of Register of Deeds, County of Forest, I hereby certify that the within instrument was filed in this office for record on the 20th day of March, 1997 at 1:30 o'clock P. M.

(Register of Deeds)

By Paul Tamburic Deputy

FORM NO. 985-A



Stock No. 26273

158093

1301402000

(d) Describe any material discrepancy between the location of the corner as restored or reestablished and the location of that corner as previously restored or reestablished by distance and direction. Show the discrepancy on the plan view drawing under (d), above. Show the distances between the corner as previously restored or reestablished and (1) the corner as restored or reestablished, and (2) to at least 2 of the witness monuments shown on the drawing in (d), above.

None

(f) Was the corner restored through acceptance of (1) an obliterated evidence location, or, (2) a found perpetuated location?

Restored through acceptance of a found perpetuated location.

(g/h) Was the corner reestablished through lost corner proportionate methods? If so, show the method, including the directions and distances to other public land survey corners used as evidence or used for proportioning in determining the corner location?

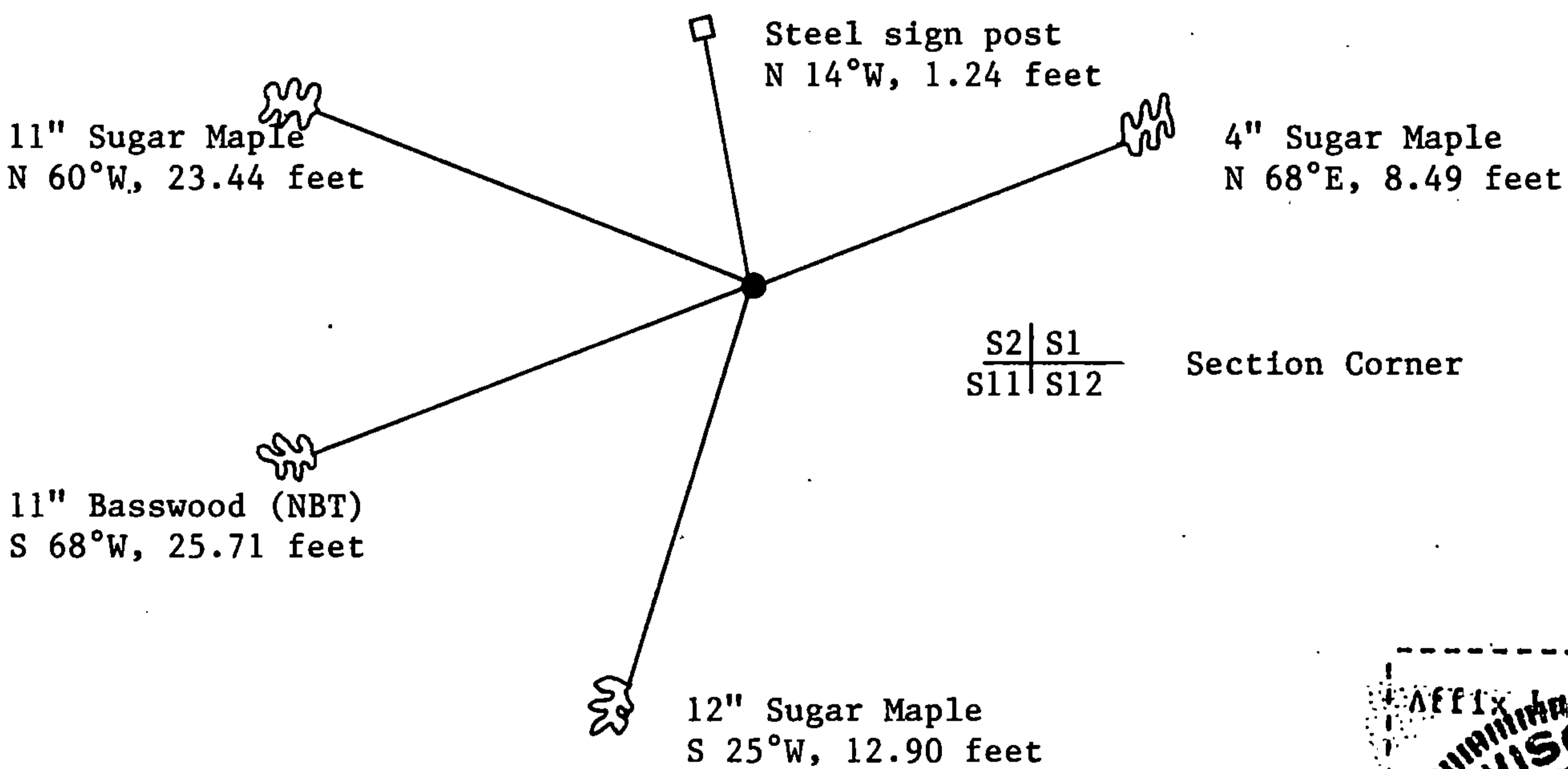

(i) I, Gary L. Pisoni
(type or print name) certify that the corner location shown on this record was determined by me or under my direction and control and that this U.S. Public Land Survey Monument Record is correct and complete to the best of my knowledge and belief.

Gary L. Pisoni 6-24-95
Signature Date

Survey requested by: _____
District Ranger Date