

CERTIFIED LAND CORNER RESTORATION

Index No. Y-18

Y18

State of Wisconsin }
County of Forest } ss.

I Glen Barker, do hereby certify that on the 24th day of August, 1982, I ~~found~~ ~~found~~ evidence of the SW 1/16 corner of Section 35 Township 36, North, Range 12 East, Fourth Principal Meridian, as described hereon; and that from this evidence I established a new monument and accessories as described hereon to perpetuate the original location of this corner.

History of original corner establishment:
No evidence of any previous corner.

Description of corner evidence found:
Corner established by subdivision of the SW 1/4. Location of SW 1/16 is N89-25-18W 1293.17 ft. of SC 1/16 and S2-20-38W 1348.29 ft. of WC 1/16.

Resident witnesses:

J. Claflin - R12E

H. Wagoner

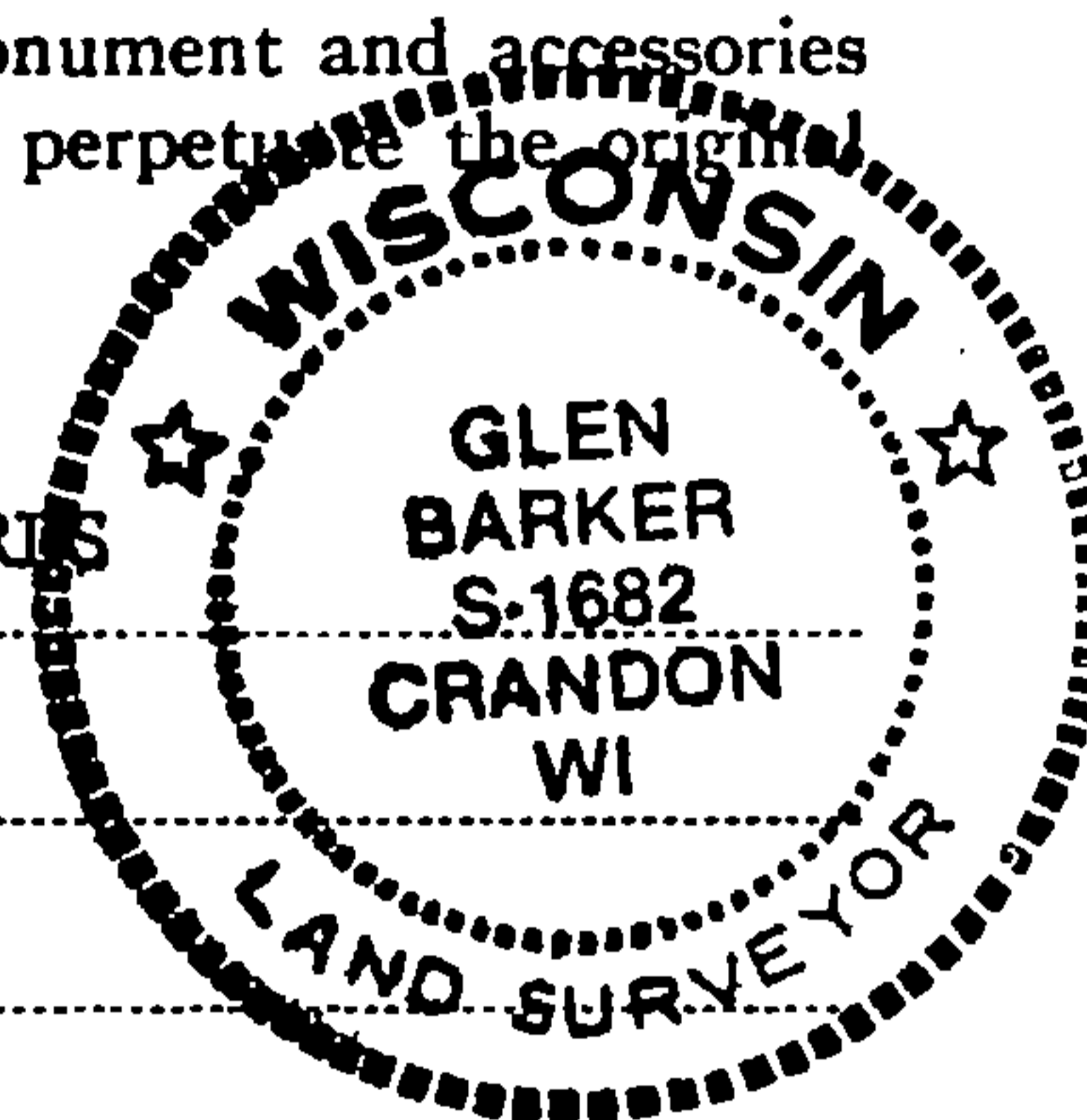

Description of monument and accessories I established to perpetuate the original location of this corner.
Set a 1" iron pipe with 2" diameter alloy cap stamped:

Monument projects 18" above ground.

Marked NBTs: Sugar 6" S80W 69.62 ft.
Sugar 4" S36W 76.0 ft.

S1682
T36N R12E

S 35
SW 1/16

CPI - 1982

FORM 985 M. C. MILLER CO., MILWAUKEE

T36N R12E

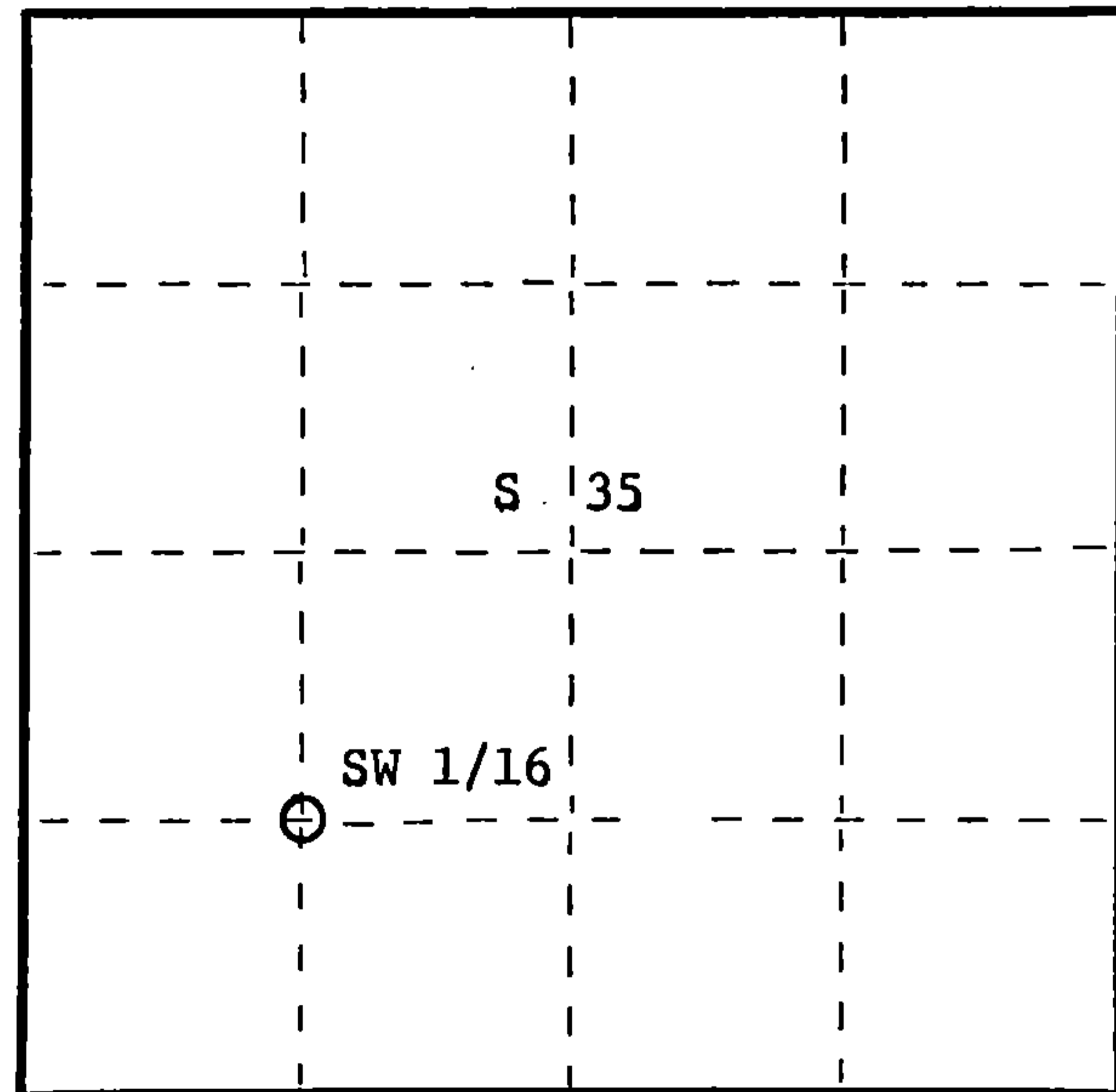

○ = Corner monument restored.

Dated at Rhineland, Wis., this 28th day of October, 1982

Signature Glen Barker Title Registered Land Surveyor Registration No. S1682
(County Surveyor, Registered Land Surveyor, or other duly authorized official)

Office of Register of Deeds, County of Forest I hereby certify that the within instrument was filed in this office for record on the 16th day of February, 1983 at 10:30 o'clock A. M.

Eugene Staszny
(Register of Deeds)
By _____ Deputy

DOCUMENT NO. **122923**

43612351030