

CERTIFIED LAND CORNER RESTORATION

Index No. Y-17

State of Wisconsin }
County of Forest } ss.

I Philip T. Hansen, do hereby certify that on the 17th day of August, 1977, I ~~found~~ established ~~the~~ S 1/16 corner of Section 34 & 35 Township 36, North, Range 12 East, Fourth Principal Meridian, as described hereon; and that from this evidence I established a new monument and accessories as described hereon to perpetuate the original location of this corner.

Resident witnesses:

Glen Barker

Jim Claflin

Herb Wagoner

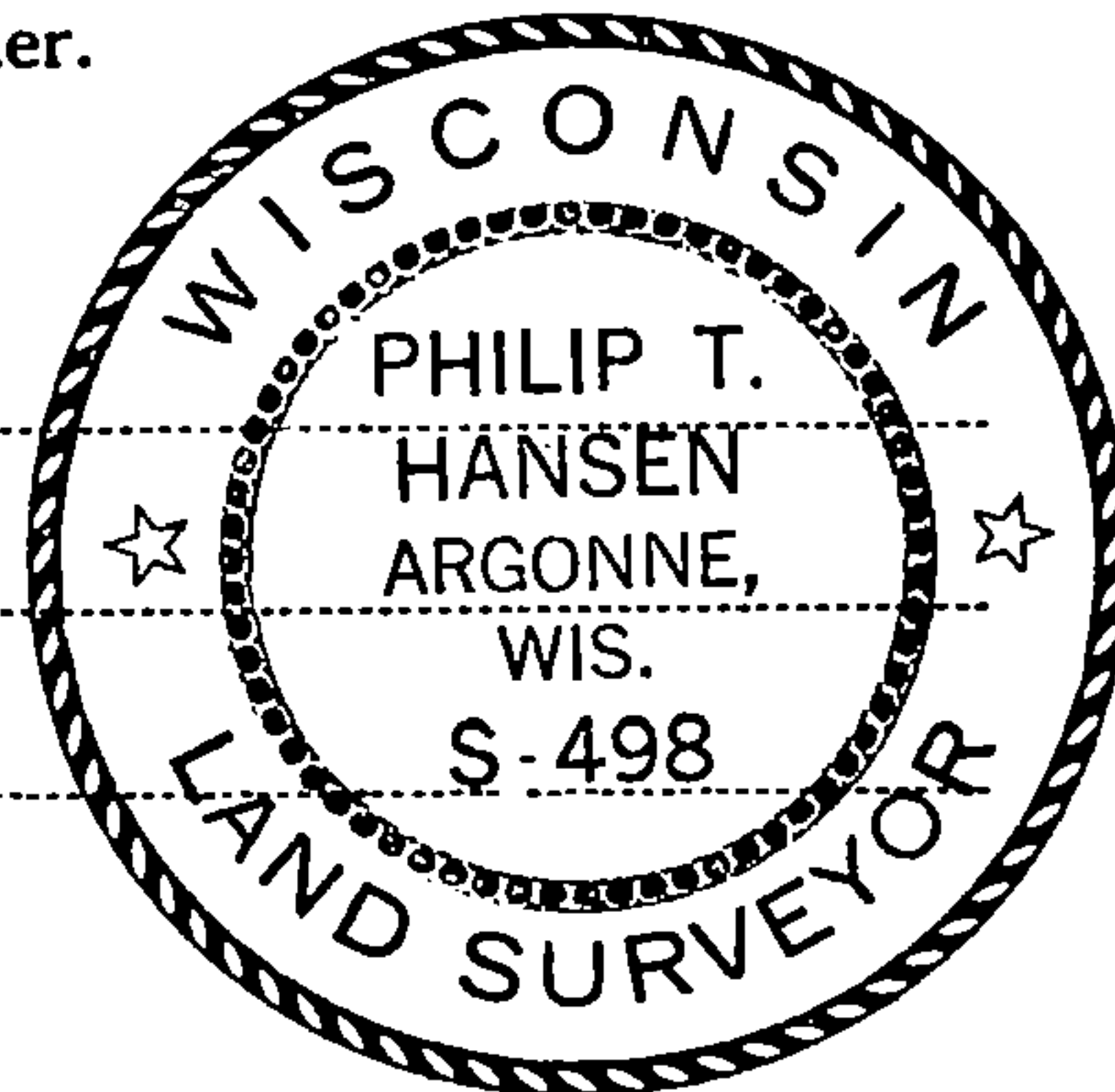

FORM 985 H. C. MILLER CO., MILWAUKEE

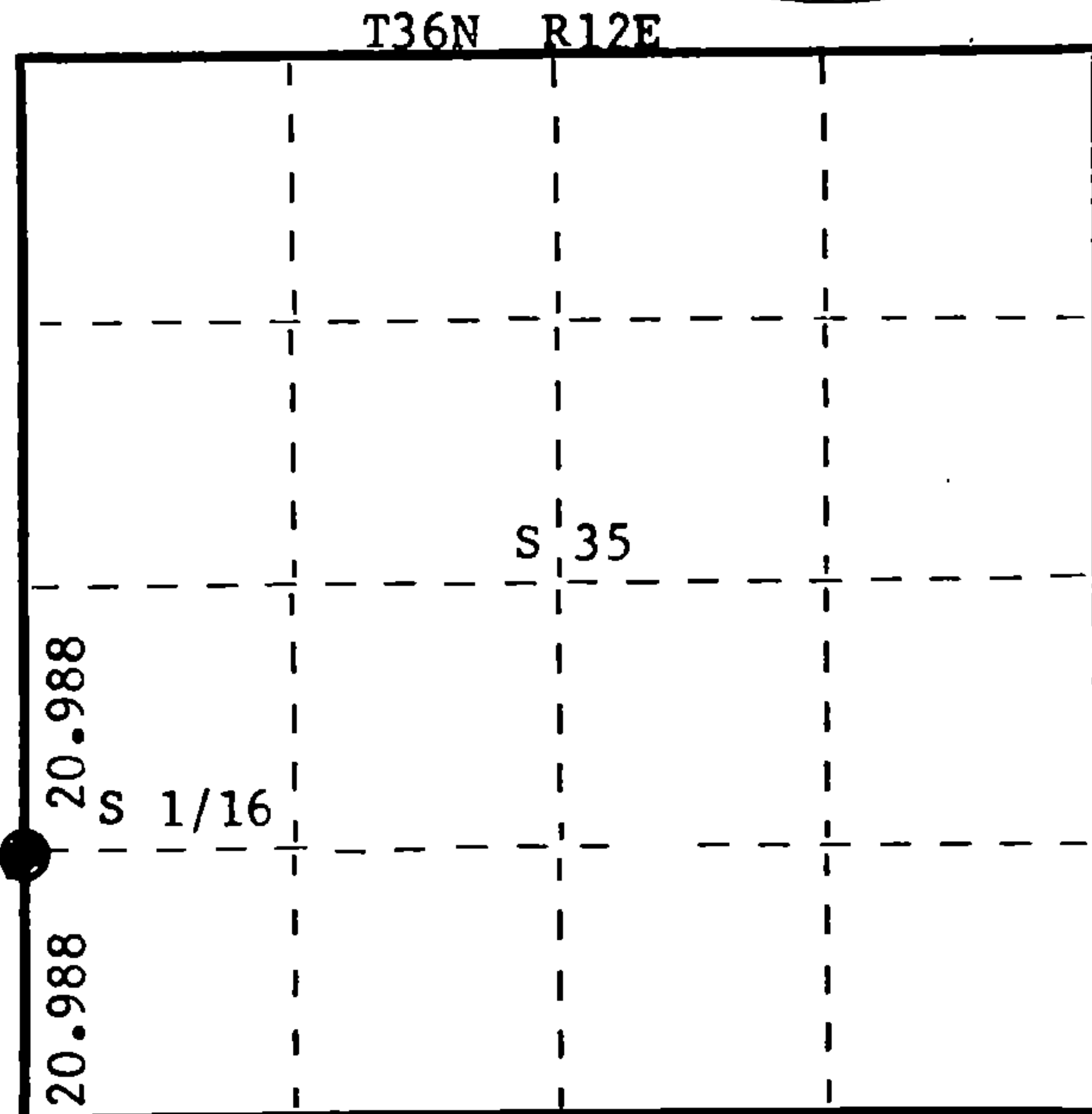

○ = Corner monument restored.

History of original corner establishment:

No record of any previous survey.

Description of corner evidence found:

No evidence of any corner recovered. Set corner by proportion. Ran traverse between Section Corner 26, 27, 34 & 35 to Section Corner 34, 35, 3 & 2. Computed distance 83.951 chains at bearing S 2° 41' 29" W. Set 1/4 corner at 41.9754 chains intermediate. Set S 1/16 at 20.988 chains intermediate between 1/4 corner and section corner.

Description of monument and accessories I established to perpetuate the original location of this corner.

Set 1 1/2" iron pipe with 2" brass cap, projecting 24" above ground. Cap stamped:

Marked NBTs - Sugar 7" S71°E, 48.6 links, scribed 1/16 BT.
Sugar 6" S61°W, 41.8 links, scribed 1/16 BT.

S498
T36N R12E
S 1/16 34 35
CPI-1977

Dated at Rhineland, Wis., this 19th day of August, 1977.

Signature Philip T. Hansen Title Registered Land Surveyor Registration No. S-498
(County Surveyor, Registered Land Surveyor, or other duly authorized official)

Office of Register of Deeds, County of Forest, I hereby certify that the within instrument was filed in this office for record on the 22nd day of AUGUST, 1977 at 3:30 o'clock P. M.

Eugene Stutzman
(Register of Deeds)
By _____ Deputy

DOCUMENT NUMBER **112167**

H3012341000