

CERTIFIED LAND CORNER RESTORATION

Index No. W-10

State of Wisconsin }
County of Forest } ss.

I Philip T. Hansen, do hereby
certify that on the 10th day
of March, 1977, I ~~took~~
established ~~corner~~ of the NW 1/16
corner of Section 33
Township 36, North, Range
12 East, Fourth Principal Meridian,
as described hereon; and that from this evidence
I established a new monument and accessories
as described hereon to perpetuate the original
location of this corner.

Resident witnesses:

Glen Barker

Jim Claflin

Herb Wagoner

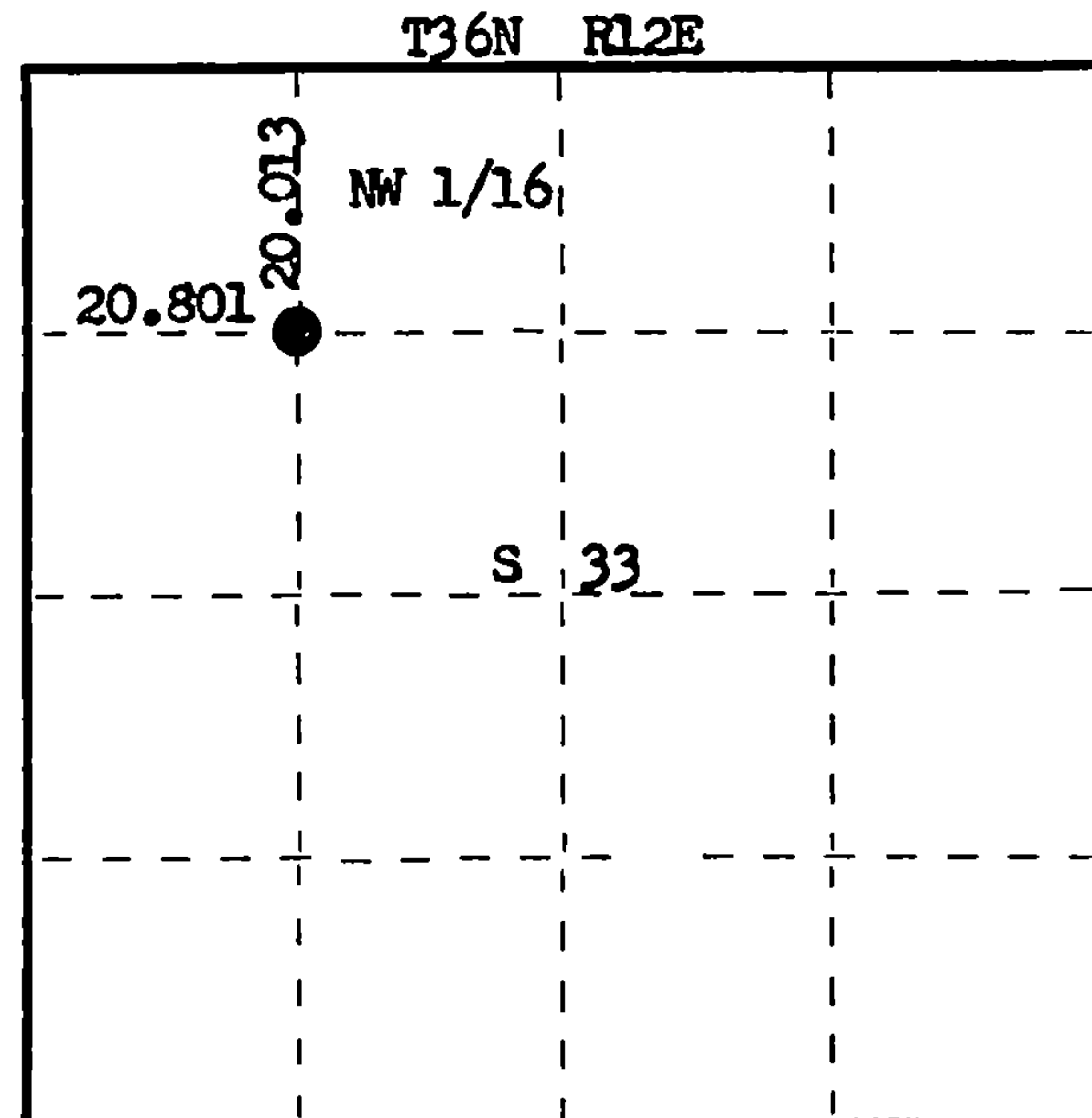
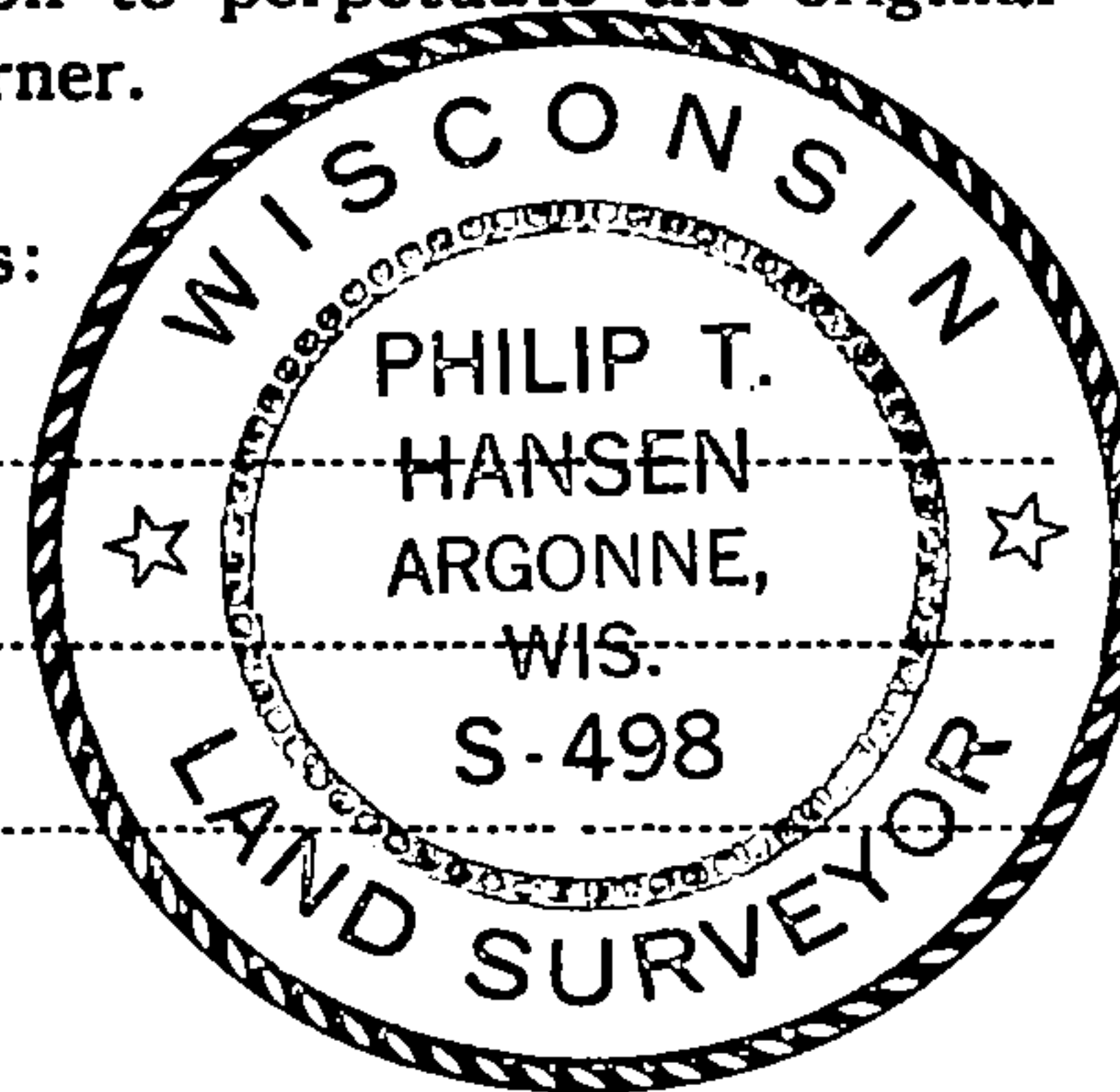

○ = Corner monument restored.

History of original corner establishment:

No record or evidence of survey of prior establishment of this corner.

Description of corner evidence found:

Established Corner by proportional measurement from traverse of previously established corners. Set corner by traverse from W 1/16 corner between N 1/16 corner between Section 32 and 33 and W 1/16 corner between Section 4 and 33. Corner set N 84° 17' 32" E, 20.801 chains from N 1/16 and S 3° 03' 33" W, 20.013 chains from W 1/16 corner.

Description of monument and accessories I established to perpetuate the original location of this corner.

Set 1½" iron pipe with 2" brass cap projecting 24" above ground, cap stamped:

Marked NBTs - Sugar 10" S 61° E, 48.6 links.
Sugar 7" N 8° E, 24.7 links, scribed 1/16 BT.

S498
T36N R12E
NW 1/16 S 33
CPL-1977

Dated at Rhineland, Wis., this 6th day of April, 1977

Signature Philip T. Hansen Title Registered Land Surveyor Registration No. S-498
(County Surveyor, Registered Land Surveyor, or other duly authorized official)

Office of Register of Deeds, County of Forest, I hereby certify that the within
instrument was filed in this office for record on the 5th day of May, 1977
at 4:00 o'clock P. M.

Eugene J. Statyn
(Register of Deeds)

By.....Deputy

DOCUMENT NUMBER
111374