

CERTIFIED LAND CORNER RESTORATION

Index No. X-13

State of Wisconsin }
County of Forest } ss.

I Philip T. Hansen, do hereby certify that on the 28th day of January, 1977, I ~~was~~ established ~~corner~~ of the Quarter corner of Section 33 - 34 Township 36, North, Range 12 East, Fourth Principal Meridian, as described hereon; and that from this evidence I established a new monument and accessories as described hereon to perpetuate the original location of this corner.

Resident witnesses:

Glen Barker

Jim Claflin

Herb Wagoner

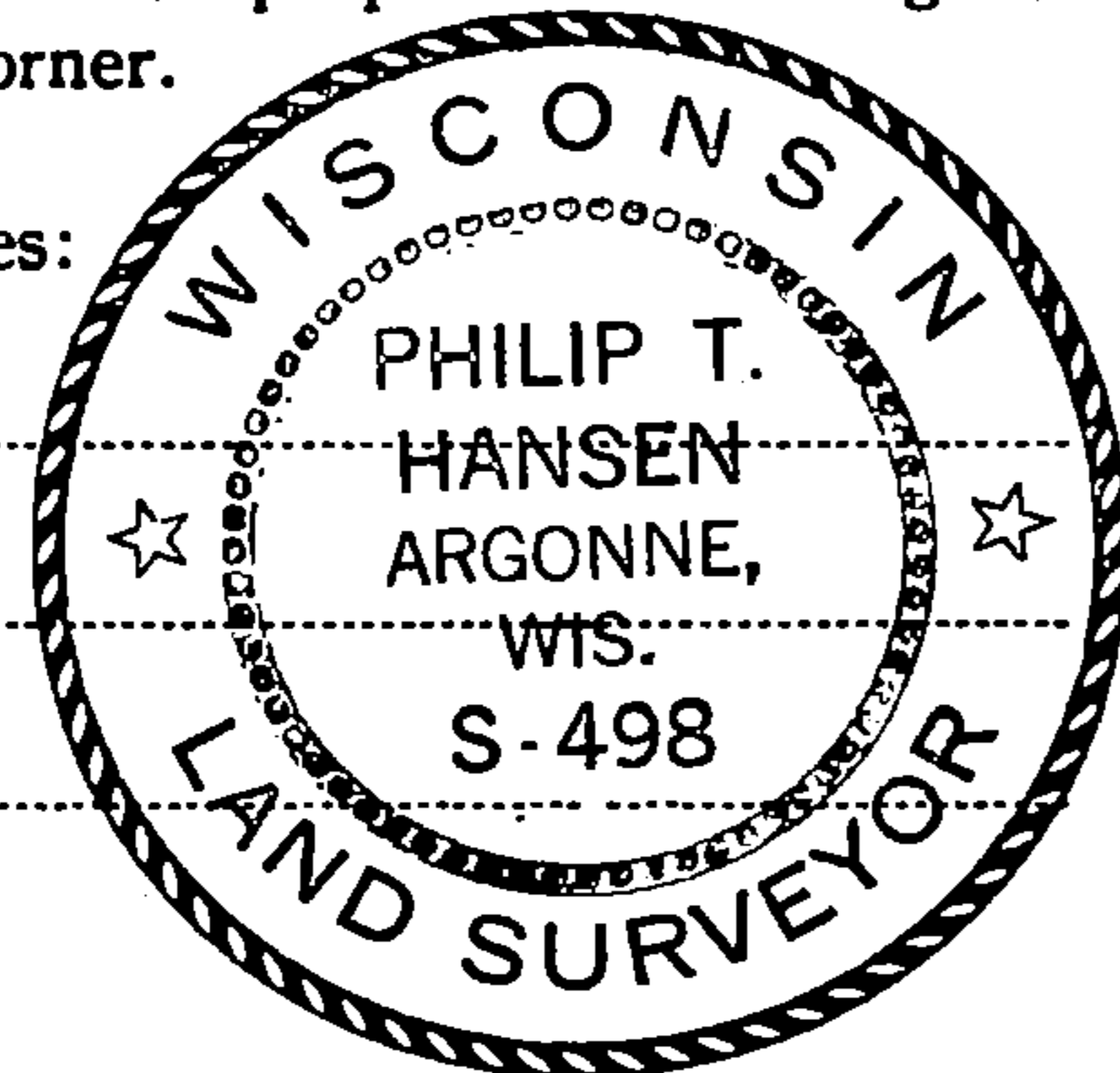

FORM 985
Wisconsin Planning & Surveying Co.
Madison, Wisconsin

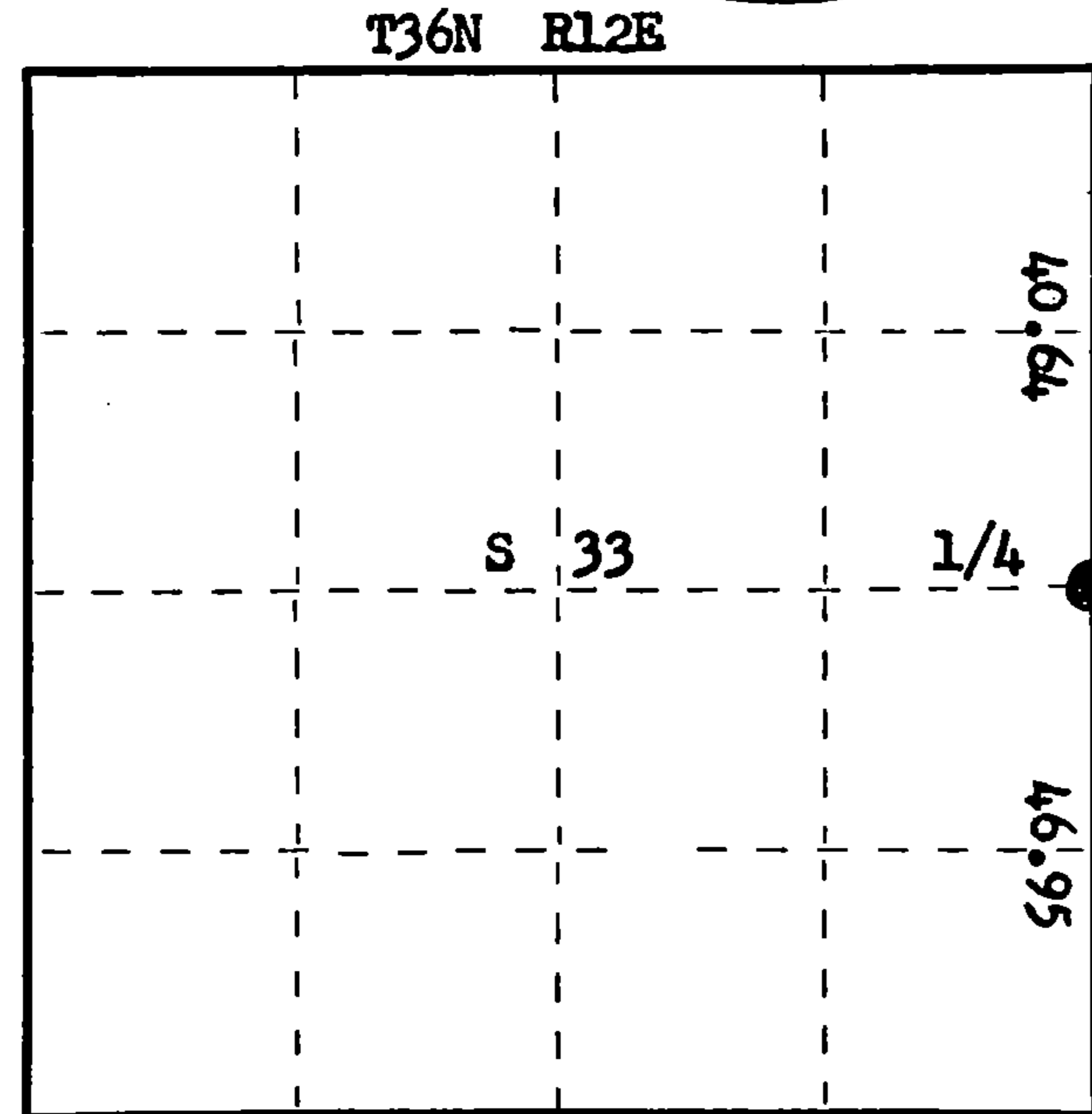

○ = Corner monument restored.

History of original corner establishment:

Original Corner established by J.L. Nowlin, Deputy Surveyor, in 1859, from which Birch 12" bears S47°E, 14 links and Birch 10" bears N84°W, 18 links.

Description of corner evidence found:

No evidence of any original corner or BTs. George C. Ison, local land owner, and his father before him witnessed the position that we accepted for this corner. It sets at the northern end of old section line road which turns and runs northwesterly. There is also evidence of an old fence line running west from this point.

This corner tied in with traverse from Section Corner 27, 28, 33, 34. Sets S 0° 15' 24" W at 40.64 chains and 46.95 chains N 9° 31' 33" E of Section Corner 33, 34, 3 & 4.

Description of monument and accessories I established to perpetuate the original location of this corner.

Set a 2 1/2" Berntsen A-1 Federal Monument, aluminum with magnet installed in cap and base. Monument projects 12" above ground. Cap stamped:

NBTs - Sugar 30" N2°E, 167.9 links, scribed 1/4 BT.
Tamarack 8" N30°E, 148.8 links, scribed 1/4 BT.
Tamarack 6" S13°E, 88 links, scribed 1/4 BT.

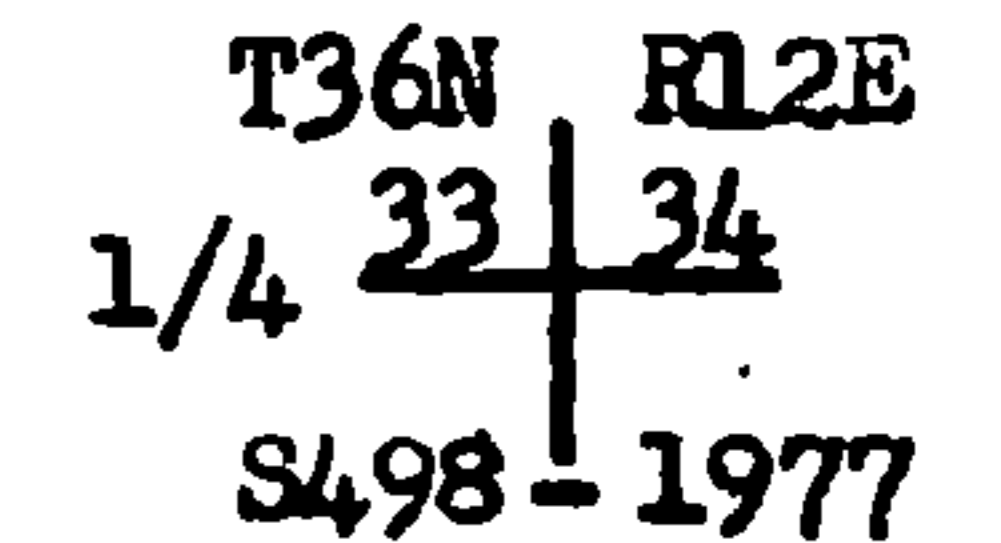

Dated at Rhineland, Wis., this 5th day of April, 1977

Signature Philip T. Hansen Title Registered Land Surveyor Registration No. S-498
(County Surveyor, Registered Land Surveyor, or other duly authorized official)

Office of Register of Deeds, County of Forest, I hereby certify that the within instrument was filed in this office for record on the 5th day of May, 1977 at 4:00 o'clock P. M.

Eugene Stapp
(Register of Deeds)

By.....Deputy

DOCUMENT NUMBER
111359

43612 332000