

CERTIFIED LAND CORNER RESTORATION

Index No. Y-13

State of Wisconsin }  
County of Forest } ss.

I Philip T. Hansen, do hereby certify that on the 28th day of January, 1977, I ~~found~~ established ~~the~~ S 1/16 corner of Sec. 33 and 34 Township 36, North, Range 12 East, Fourth Principal Meridian, as described hereon; and that from this evidence I established a new monument and accessories as described hereon to perpetuate the original location of this corner.

Resident witnesses:

Glen Barker

Jim Claflin

Herb Wagoner

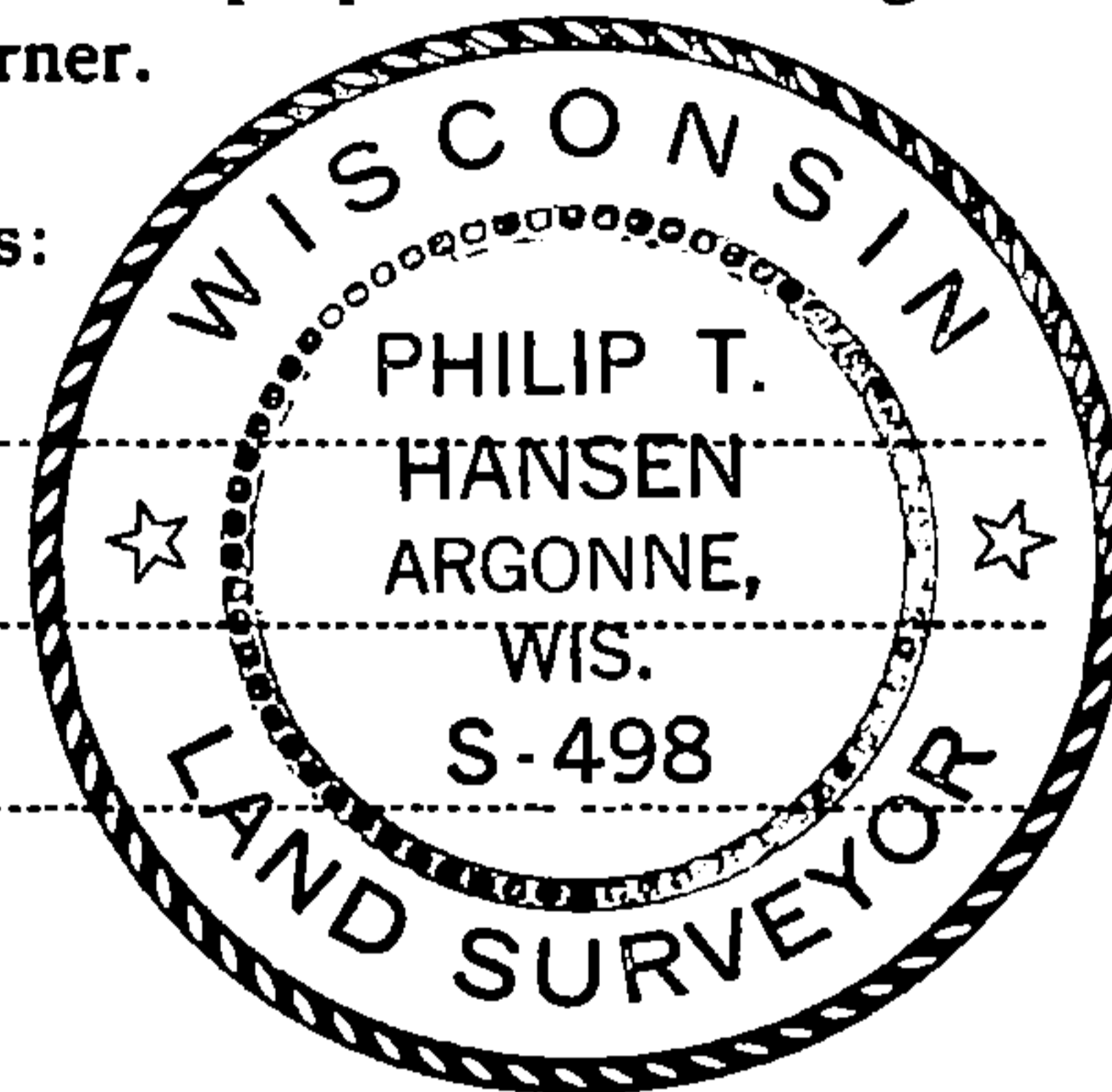

FORM 985

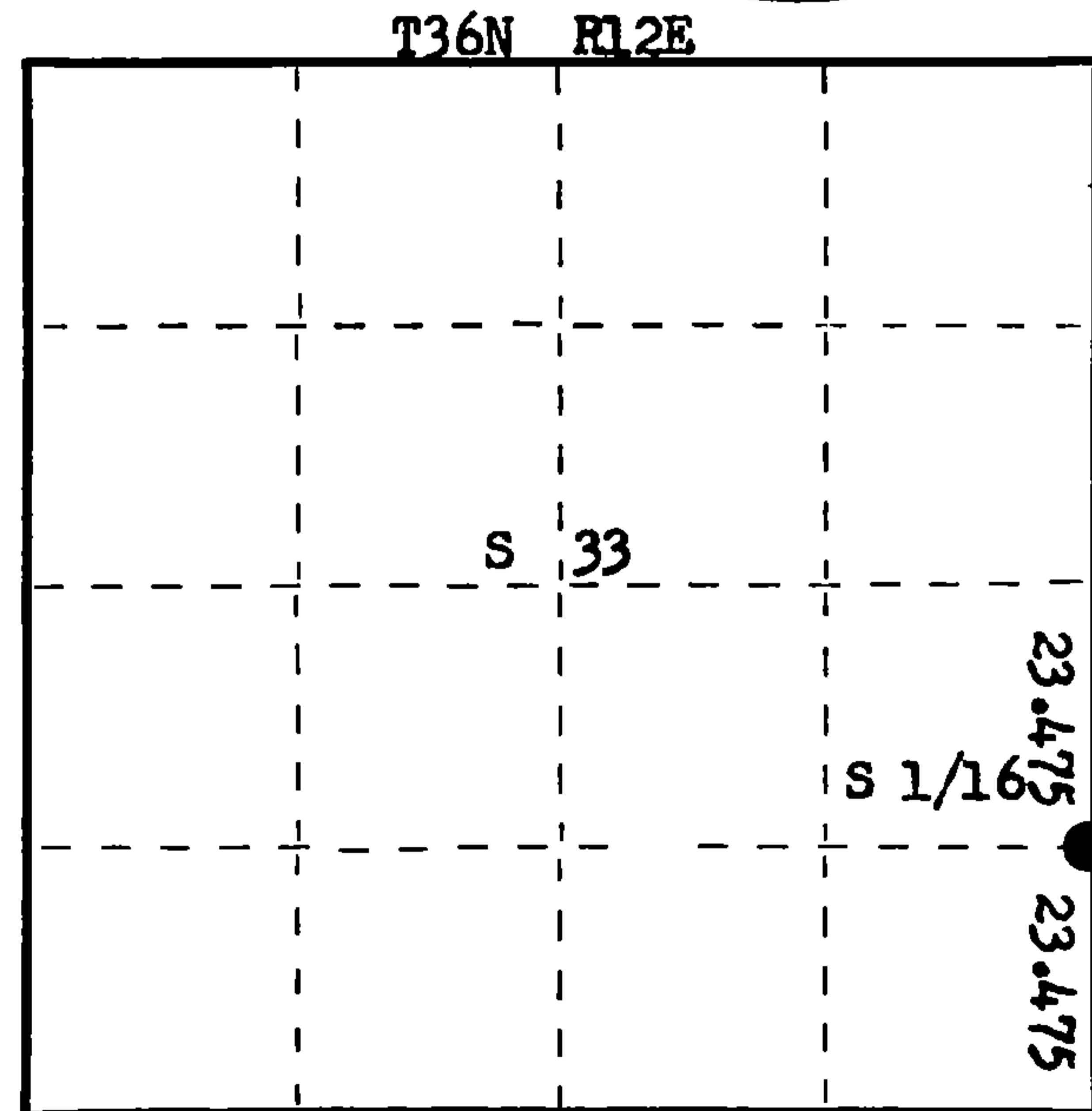

○ = Corner monument restored.

History of original corner establishment:  
No record of any previous survey to establish this corner.

Description of corner evidence found:

Corner established by proportionate measurement. Ran a traverse from the east 1/4 corner Section 33 to the Section Corner 33, 34, 4 and 3. Computed distance 46.95 chains, bearing S 9° 31' 33" E. Set the S 1/16 corner at 23.475 chains intermediate.

Description of monument and accessories I established to perpetuate the original location of this corner.

Set a 1 1/2" x 12" iron pipe on the west edge of the Walnut Hill Road, 4" below the surface for true corner.

Set a 1 1/2" iron pipe with 2" brass cap, 54 links west for a Witness Corner.

Monument projects 24" above ground. Cap stamped:

Marked BTs - Sugar 8" S66°W, 70.2 links.

Sugar 6" N58°W, 82.2 links, scribed 1/16 BT.

S498  
T36N R12E  
S 1/16 33 | 34 W.C.  
E. 54 lks.  
CPI-1977

Dated at Rhineland, Wis., this 6th day of April, 1977.

Signature Philip T. Hansen Title Registered Land Surveyor Registration No. S-498  
(County Surveyor, Registered Land Surveyor, or other duly authorized official)

Office of Register of Deeds, County of Forest, I hereby certify that the within instrument was filed in this office for record on the 5th day of May, 1977 at 4:00 o'clock P. M.

Eugene Staszny  
(Register of Deeds)

By \_\_\_\_\_ Deputy

DOCUMENT NUMBER  
**111380**

430612331000