

CERTIFIED LAND CORNER RESTORATION

Index No. Y-5

State of Wisconsin }
County of Forest } ss.

I Philip T. Hansen, do hereby certify that on the 9th day of August, 1976, I ~~found~~ established ~~evidence of the~~ S 1/16 corner of Section 31 and 32 Township 36, North, Range 12 East, Fourth Principal Meridian, as described hereon; and that from this evidence I established a new monument and accessories as described hereon to perpetuate the original location of this corner.

Resident witnesses:

Glen Barker

Jim Clafin

Herb Wagoner

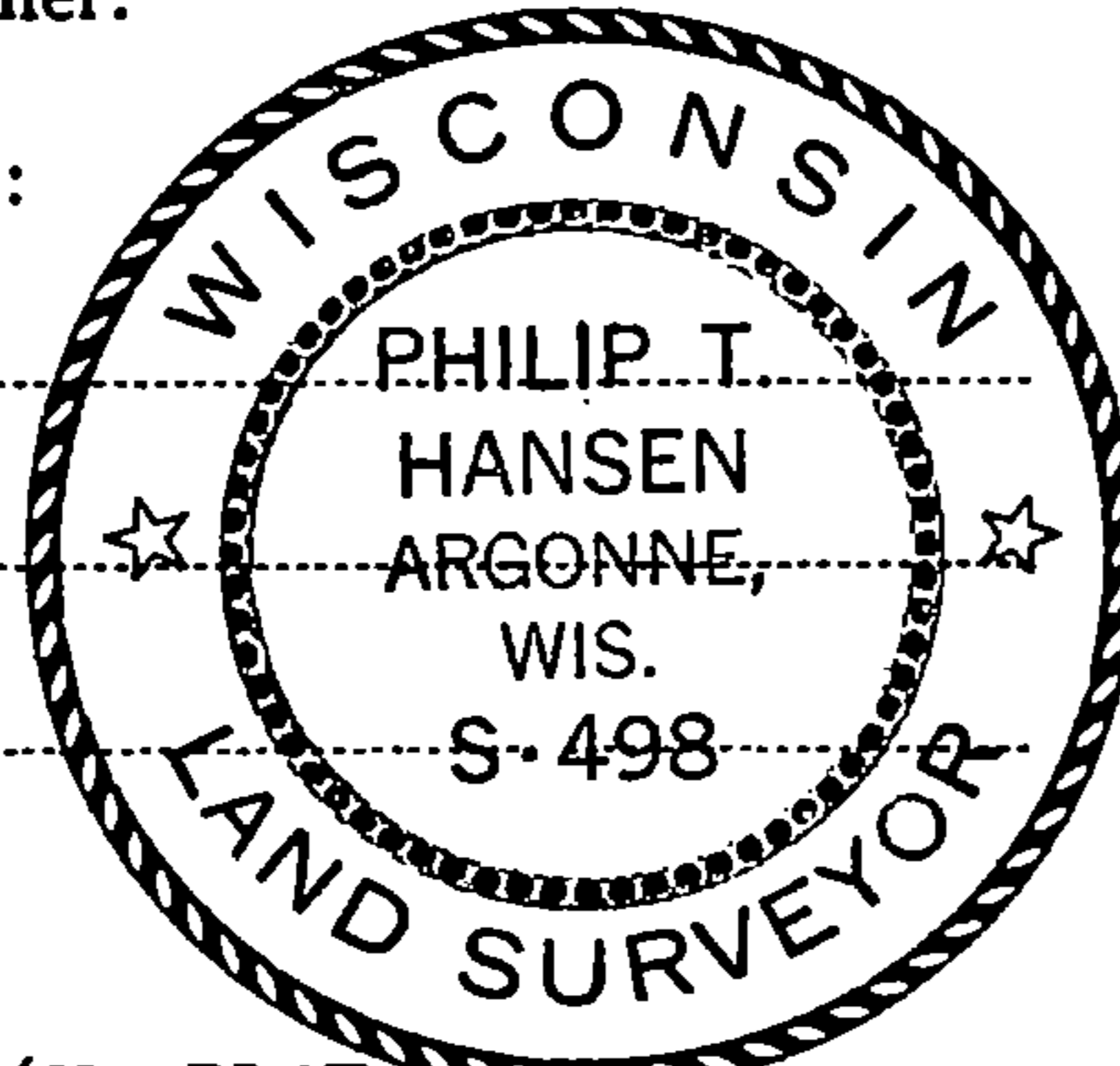

FORM 985 W. C. MILLER CO., MILWAUKEE

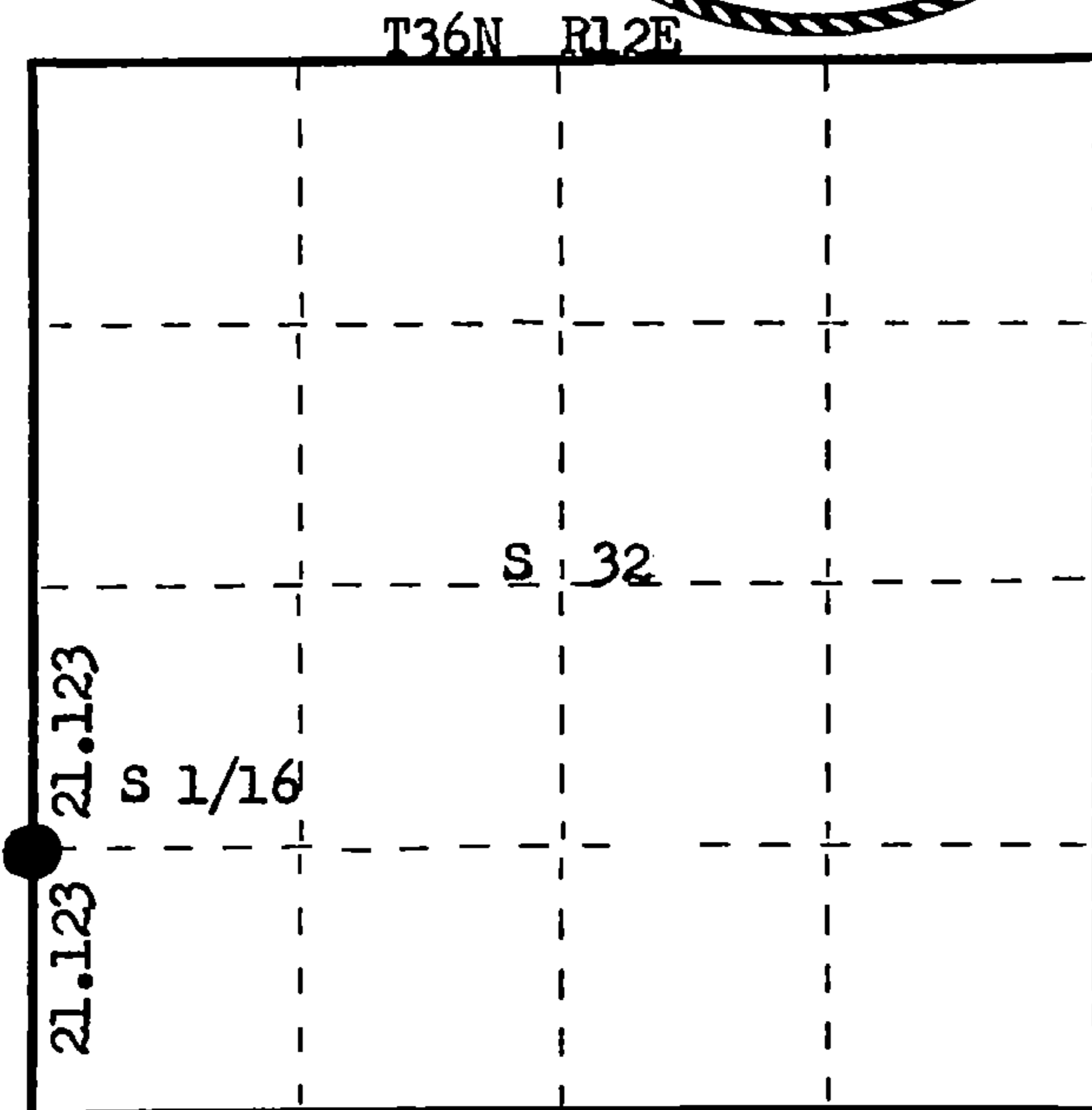

○ = Corner monument restored.

History of original corner establishment:
No evidence of any corner found.

Description of corner evidence found: Corner re-established by proportional measurement by traverse run between Section Corner 5, 6, 31 and 32 and the 1/4 corner between Section 31 and 32, previously re-established and restored. Computed distance 42.246 chains, at bearing N 0° 37' 05" W. Established Corner on line, equidistant at 21.123 chains. Point fell in the east ditch line of Cole Road.

Description of monument and accessories I established to perpetuate the original location of this corner. Set a 1" x 24" iron pipe for true corner, 4" below ground level. Set a 1 1/2" iron pipe with brass cap for Witness Corner 25 lks east. Monument projects 2 1/2 ft. above ground - cap stamped. NBTs - Sugar 7" N 74° W 58 lks, scribed 1/16 BT. Sugar 5" N 40° E 73.5 lks, scribed 1/16 BT. Measurements and bearings to BTs from true corner. W.M. and BTs painted blue.

S498
T36N R12E
S 1/16 31 | 32 W.C.
W.25 lks
CPI-1976

Dated at Rhineland, Wis., this 10th day of August, 1976.

Signature Philip T. Hansen Title Registered Land Surveyor Registration No. S-498
(County Surveyor, Registered Land Surveyor, or other duly authorized official)

Office of Register of Deeds, County of Forest, I hereby certify that the within instrument was filed in this office for record on the 8th day of September, 1976 at 10 o'clock A. M.

Eugene Stateguy
(Register of Deeds)
By _____ Deputy

DOCUMENT NUMBER **110113**

000116210124