

CERTIFIED LAND CORNER RESTORATION

State of Wisconsin }
County of Forest } ss.

I, Jean F. Resvick, do hereby certify that on the 29th day of April, 1975, I found evidence of the South Sixteenth corner of Sections 25 and 30 Township 35 North, Range 16 East, Fourth Principal Meridian, as described hereon; and that from this evidence I established a new monument and accessories as described hereon to perpetuate the original location of this corner:

Description of original monument and accessories and subsequent restorations:

Surveyed in December 1934 and July 1935 by JJ Jenkins, Menominee County Surveyor. N00°15'E between sections 25 and 30. 19.97 chains set a 4" cedar post for 1/16 corner.

Description of corner evidence found:

20.0 chains south from quarter corner between sections 25 and 30, found a 4" scribed cedar post lying on the ground and the post point.

Description of monument and accessories I established to perpetuate the location of this corner:

Replaced the post point with a 2 inch inside diameter, galvanized pipe, 5 feet long, filled with concrete, with a brass cap stamped:
T35N, R16E, R17E, S 1/16, S25, S30, 1976, S-802.
Blazed and scribed the following new bearing trees:
Aspen, 6", N15°W, 42.50 feet
Aspen, 9", N60°E, 9.54 feet
Set a steel sign post east of the monument, 0.50 ft.

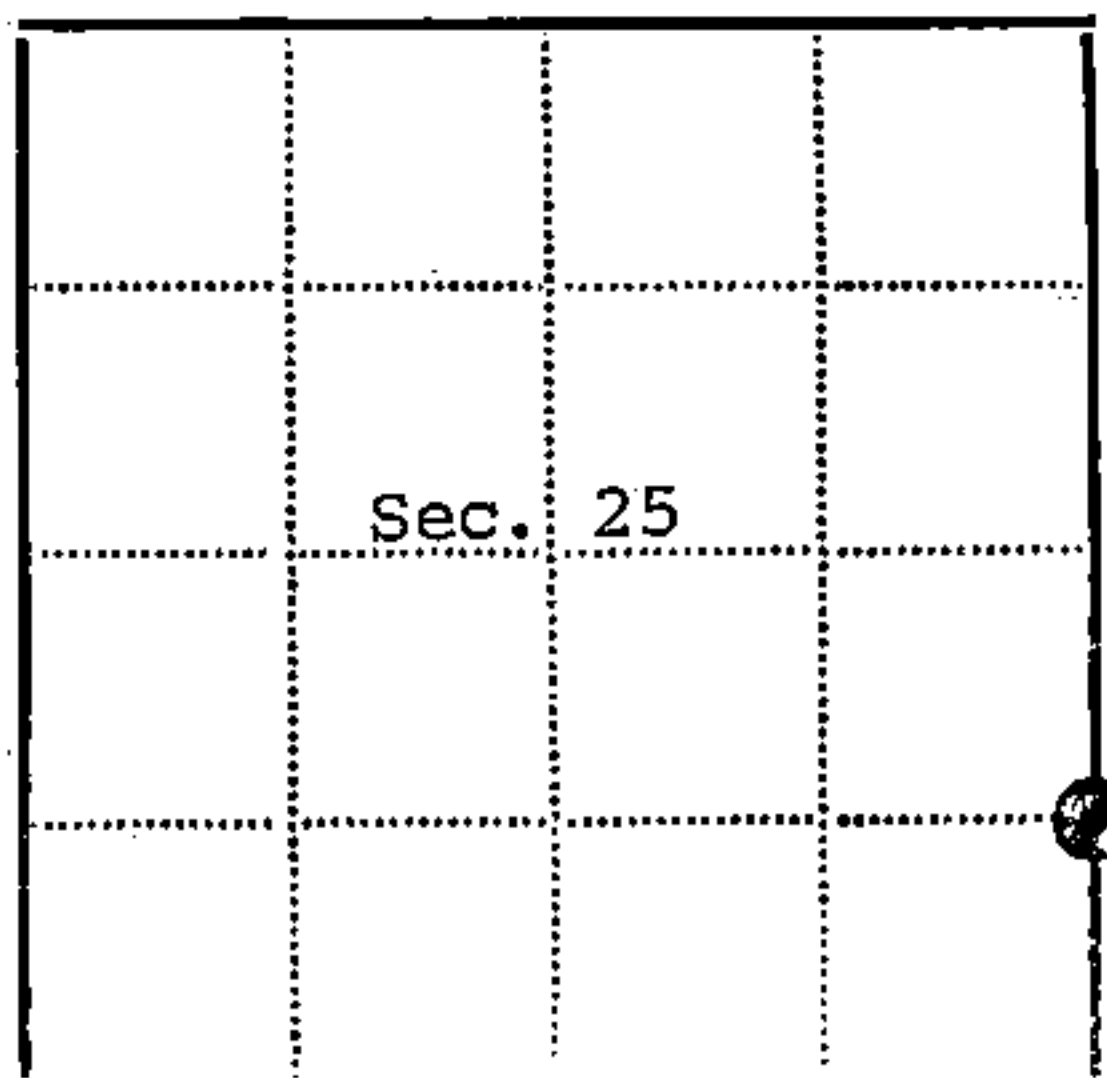
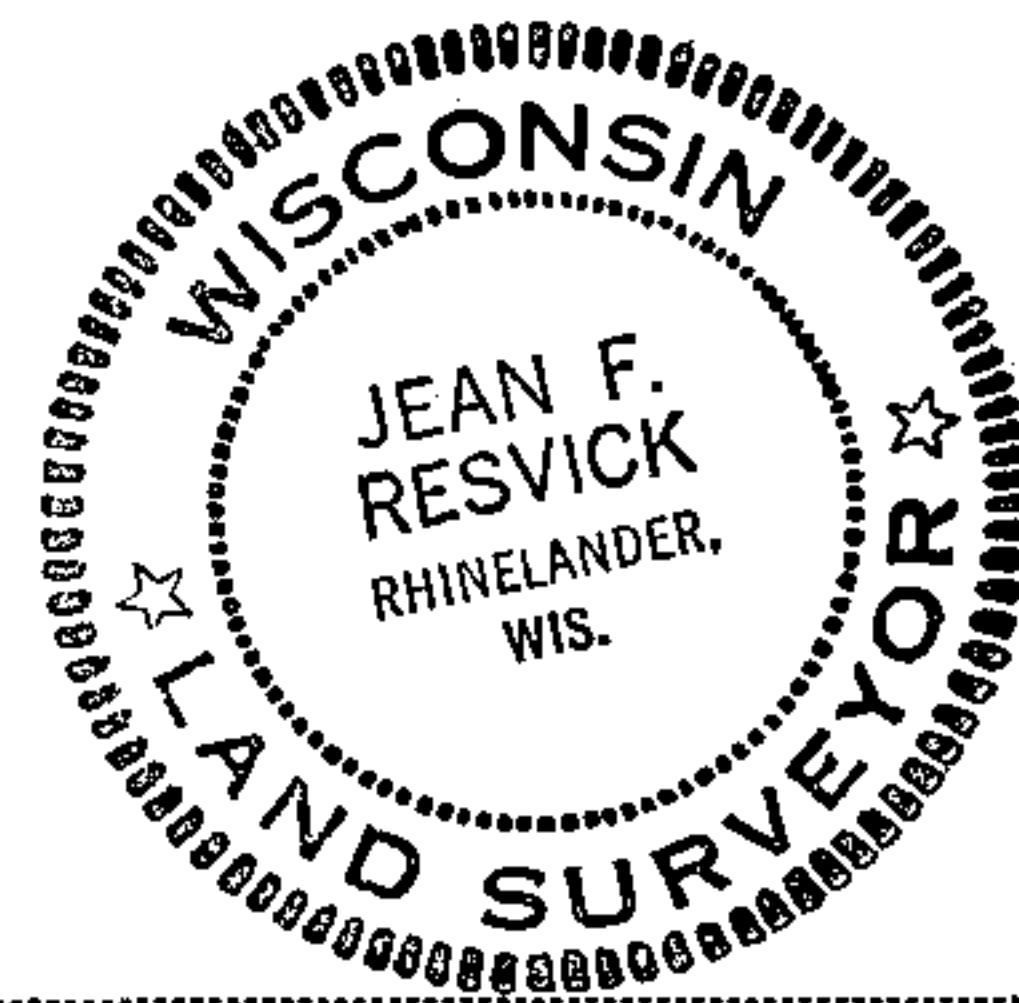

● - Corner monument restored
□ -

Resident witnesses.....

Dated at Rhinelander Wisconsin, this 15 day of June 1976.

Signature Jean F. Resvick Title Land Surveyor
(County Surveyor, Registered Land Surveyor, or other duly authorized official)

Surveyors Registration No. S-802 DOCUMENT NUMBER 109585

Office of Register of Deeds County of Forest

I hereby certify that the within instrument was filed in this office for record on the 2nd day of July 1976, and was filed in Book No. Page No. of County Records.

Signature Eugene Statyns Title Register of Deeds

Township 35 North, Range 16 East, Section 25, Index No. U-25, Page No.

43516251000

U-25