

U. S. PUBLIC LAND SURVEY MONUMENT RECORD

INSTRUCTIONS:

This record shall show the location of the corner and shall include all of the following nine elements (a through i).

- (a) Identify the corner by reference to the U.S. public land survey system.
○ = Corner monument restored.

Section Corner to Sections 13, 18, 19 and 24,
T35N, R16 - 17E, 4th P.M.

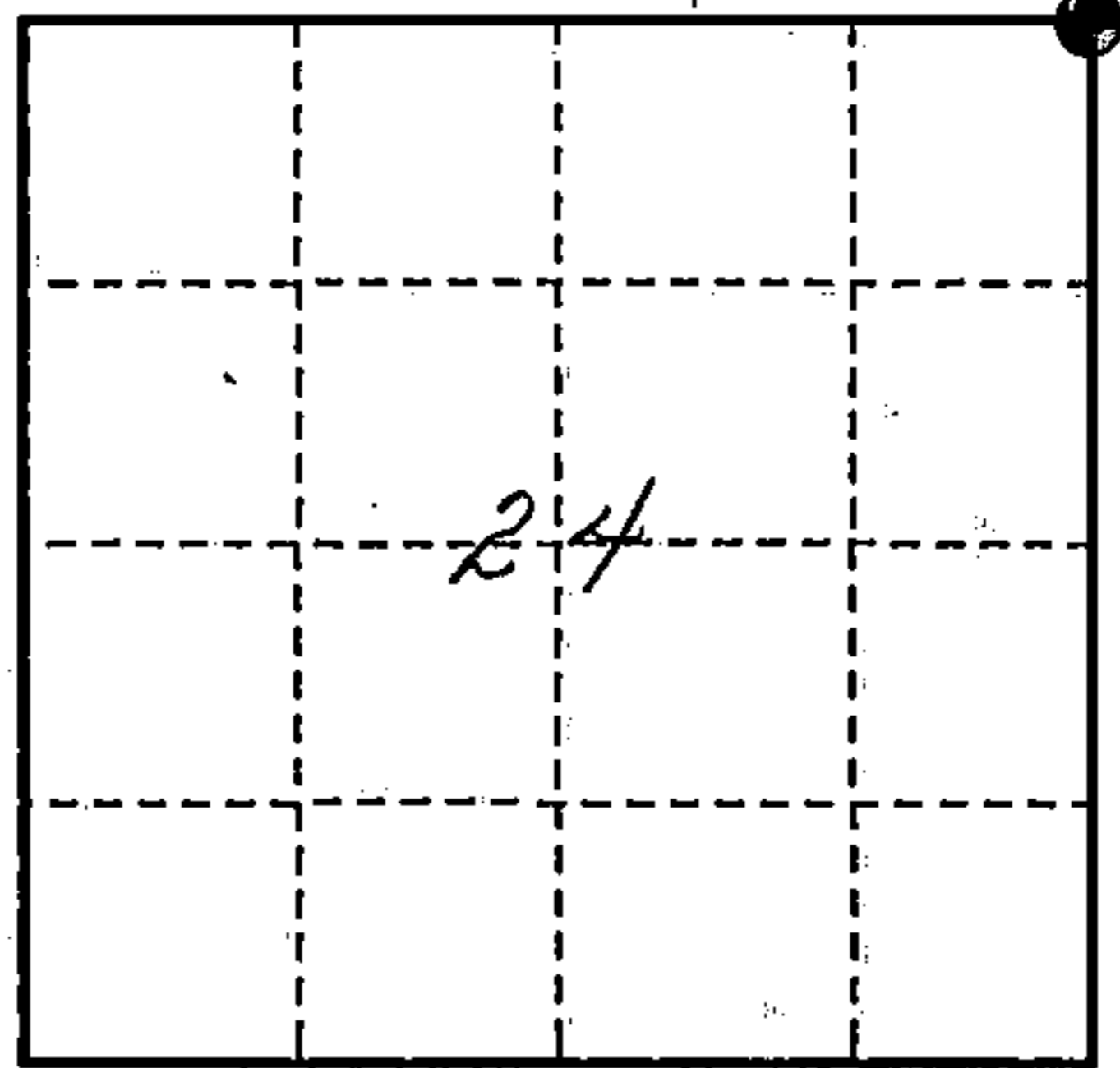

REGISTER'S OFFICE
Forest County, Wis.

Received for record this 20th day
of November A.D., 1990 at
1:00 o'clock P.M. and recorded

In Vol. Corner Restorations
page 25
Paul H. Schenker
Register of Deeds

- (b) Describe any record evidence, monument evidence, occupational evidence, testimonial evidence or any other material evidence you considered, and whether the monument was found or placed.

In 1857 Artemas Curtis established this corner at 80 chains North, and set a wood post. Bearing Trees:

| | |
|-----------------------------------|----------------------------------|
| Yellow Birch 20", S47°W, 25 Links | Elm 12", N62°W, 75 Links |
| Hemlock 12", N32°E, 14 Links | Sugar Maple 16", S38°E, 56 Links |

1935 - J. J. Jenkins restored corner by setting a 4" iron post with brass cap.

1969 - Jean F. Resvick found the iron post by Jenkins and placed four new Bearing Trees and filed certificate in Forest County, Document No. 98045. Bearing Trees:

| | |
|-----------------------|-------------------------------|
| Elm 6", N43°E, 38.98' | Elm 7", S08°E, 26.87' |
| Elm 4", S87°W, 40.97' | Scotch Pine 3", N36°W, 51.03' |

8/20/1990 - Milo E. Stefan found Jenkin's monument in good condition. Two Elm bearing trees dead and no sign post. We established two new bearing trees, took new distances to all bearing trees and placed a steel sign post.

- (c) In the plan view drawing below, provide reference ties to at least 4 witness monuments, or, if the location is within a municipality, to at least 2 witness monuments. (witness monuments shall be made of concrete, natural stone, iron or other equally durable material.)

- (d) Show a plan view drawing depicting the relevant monuments and reference ties which is sufficient in detail to enable accurate relocation of the corner monument if the corner monument is disturbed. Indicate north.

- 1) 4" x 36" Iron Post with Brass Cap, as set by Jenkins, Marinette County Monument
- 2) Rock Elm 5", N24°E, 16.56'
- 3) Rock Elm 8", N43°E, 39.29'
- 4) Rock Elm 4", S82°W, 35.99'
- 5) Red Pine 6", N14°W, 53.72'
- 6) Steel Sign Post, Northwest, 1.4'

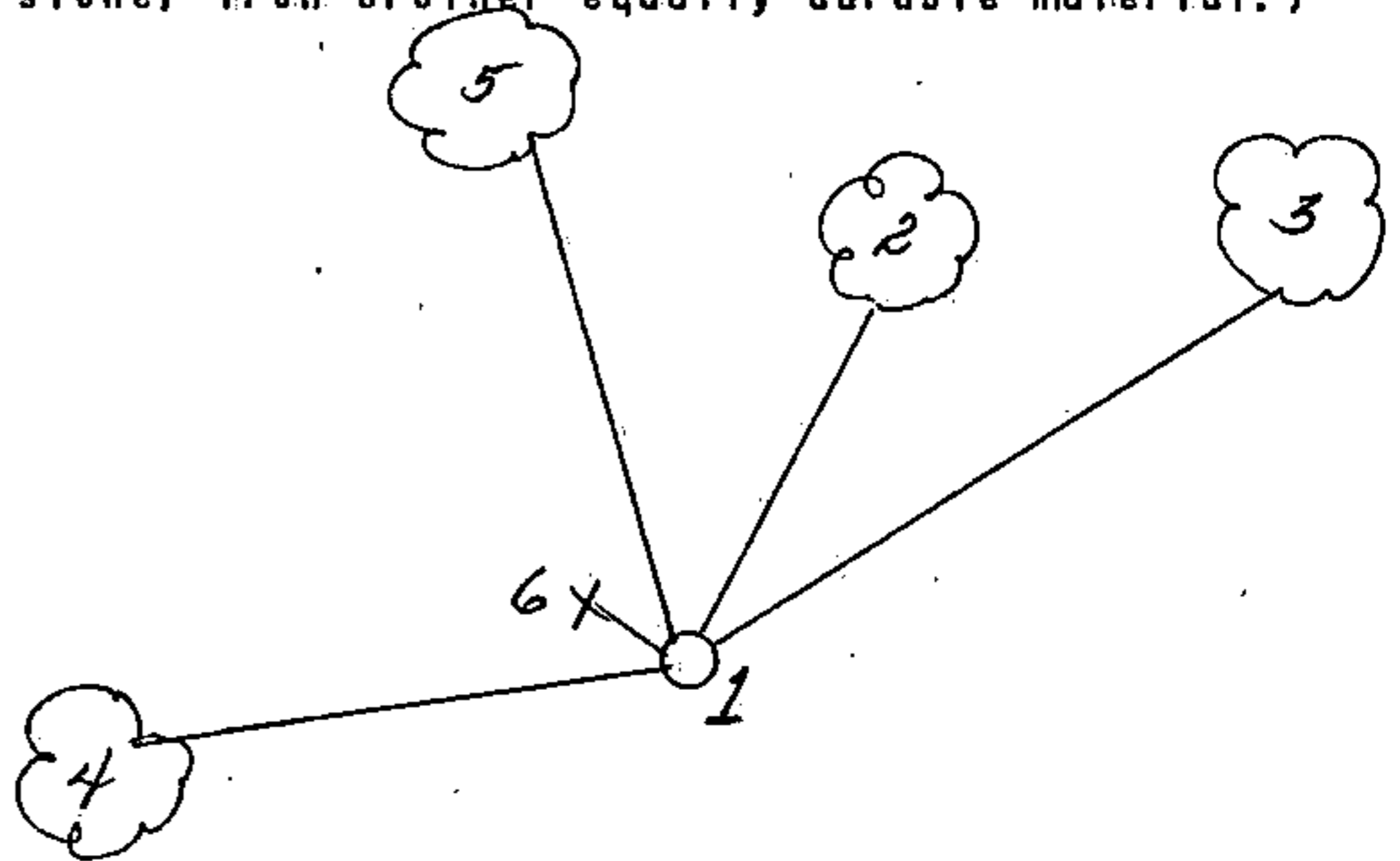

(e) Describe any material discrepancy between the location of the corner as restored or reestablished and the location of that corner as previously restored or reestablished by distance and direction. Show the discrepancy on the plan view drawing under (d), above. Show the distances between the corner as previously restored or reestablished and (1) the corner as restored or reestablished, and (2) to at least 2 of the witness monuments shown on the drawing in (d), above.

None

(f) Was the corner restored through acceptance of (1) an obliterated evidence location, or, (2) a found perpetuated location?

Found perpetuated location.

(g & h) Was the corner reestablished through lost corner proportionate methods? If so, show the method, including the directions and distances to other public land survey corners used as evidence or used for proportioning in determining the corner location?

(1) I, Milo E. Stefan
(type or print name) certify that the corner location shown on this record was determined by me or under my direction and control and that this U.S. Public Land Survey Monument Record is correct and complete to the best of my knowledge and belief.



Milo E. Stefan
Signature

August 29, 1990
Date

CERTIFICATE READY FOR FILING:

Dale W. Staeger
District Ranger

CERTIFIED LAND CORNER RESTORATION

State of Wisconsin }
County of Forest } ss.

I Jean F. Resvick, do hereby certify that on the 30th day of June, 19 69, I found evidence of the Northeast Section corner of Section 24 Township 35 North, Range 16 East, Fourth Principal Meridian, as described hereon; and that from this evidence I established a new monument and accessories as described hereon to perpetuate the original location of this corner:

Description of original monument and accessories and subsequent restorations:

Surveyed in 1857 by Artemas Curtis.
80.00 ch. north between sections 19 and 24.
Set wood post.
Yellow Birch 20, bears S47W, 25 lks.
Elm 12, bears N62W, 75 lks.
Hemlock 12, bears N32E, 14 lks.
Sugar 16, bears S38E, 56 lks.
Marinette County survey in 1935 and 1935 by J.J. Jenkins. Recorded in Marinette County. Set 4 inch diameter iron post for corner to sections 13, 18, 19 and 24.

Description of corner evidence found:

4 inch diam. iron post with brass cap marked.

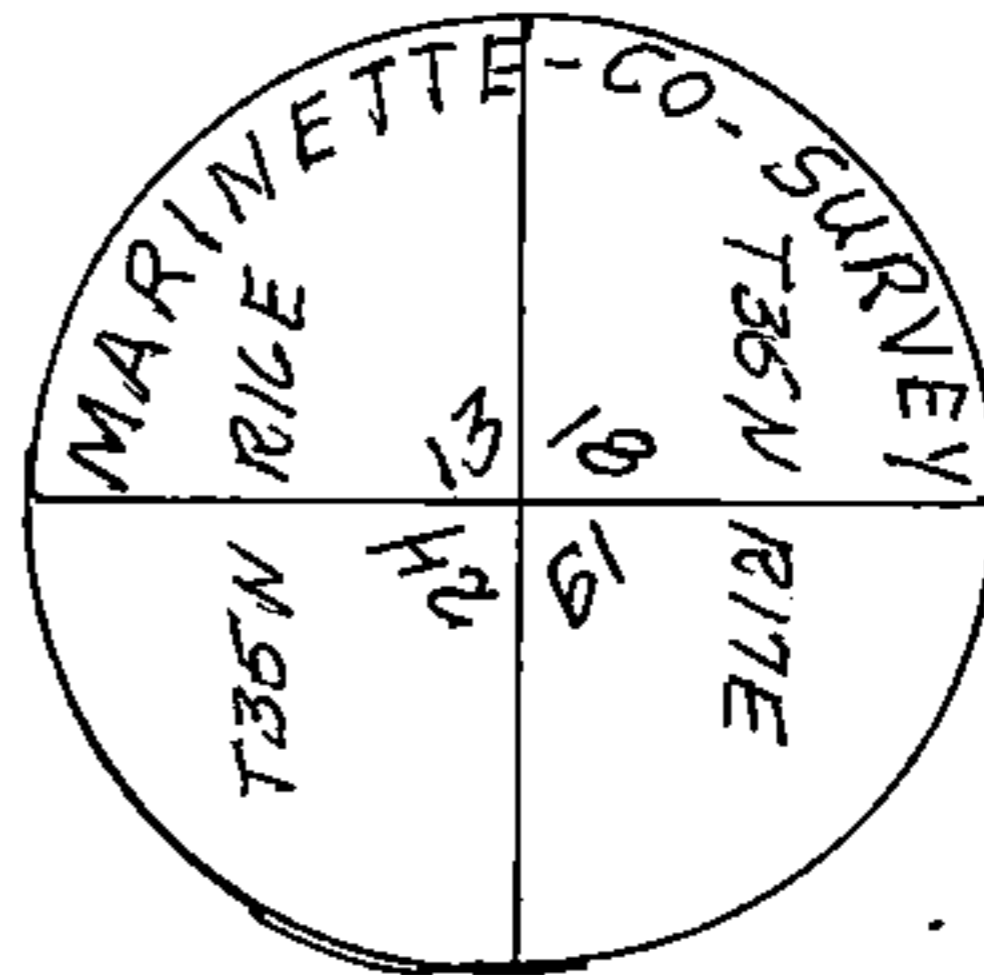

Description of monument and accessories I established to perpetuate the original location of this corner:

Blazed and scribed the following new bearing trees.
Elm 6, bears N43E, 38.98 ft. or 59.060 lks.
Elm 7, bears S 8E, 26.87 ft. or 40.712 lks.
Elm 4, bears S87W, 40.97 ft. or 62.076 lks.
Scotch Pine 3, bears N36W, 51.03 ft. or 77.318 lks.



Handwritten number: 43516130000

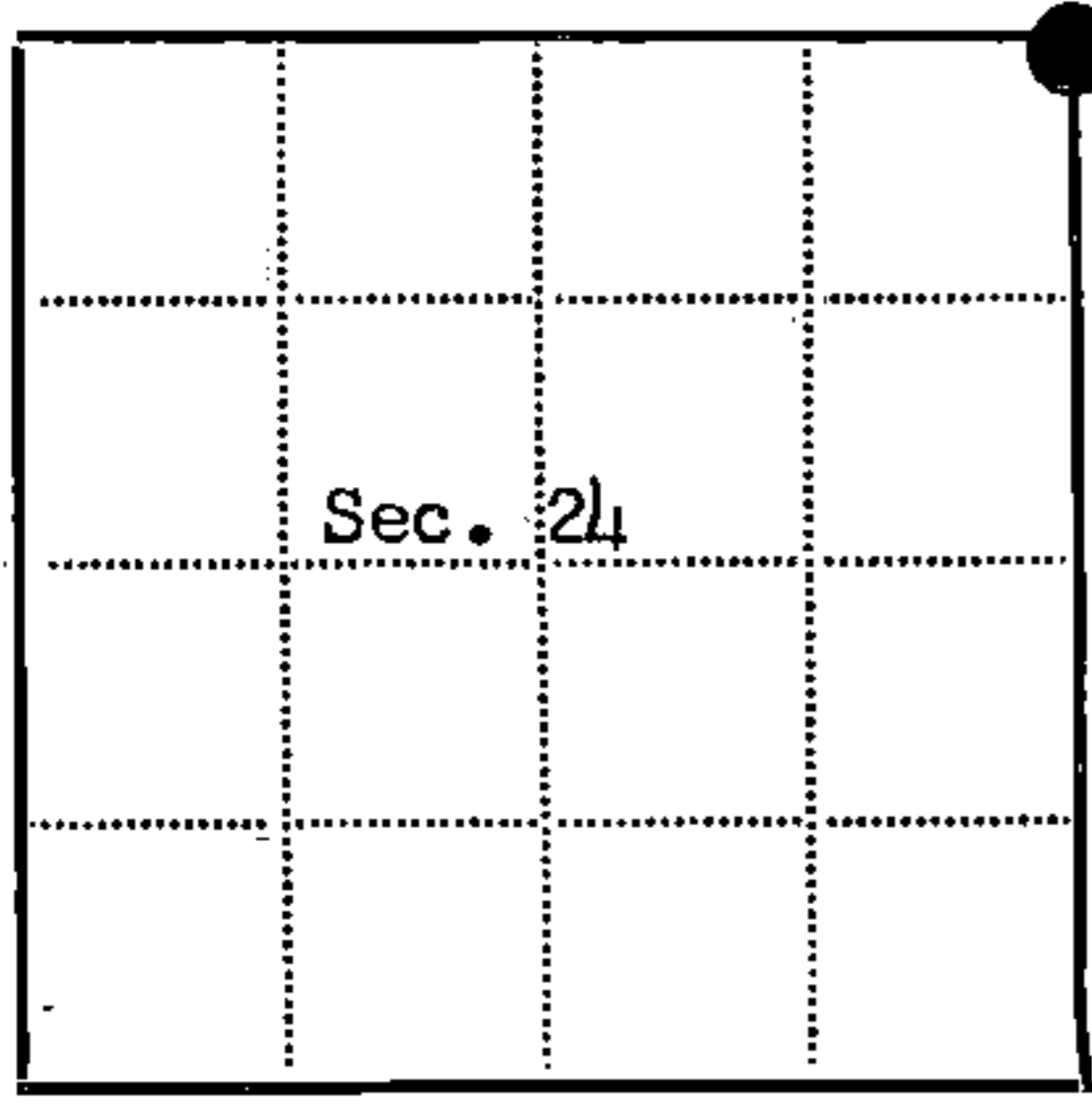

Legend: Circle with dot = Corner monument restored; Square =

Resident witnesses.....

Dated at Rhinelander Wisconsin, this.....day of 19 69..

Signature Jean F. Resvick Title Cadastral surveyor (County Surveyor, Registered Land Surveyor, or other duly authorized official)

Surveyors Registration No. S-802 DOCUMENT No. 98045

Office of Register of Deeds County of Forest

I hereby certify that the within instrument was filed in this office for record on the 22nd day of May 19 70, and was filed in Book No. Page No. N-25 of County Records.

Signature Eugene Staszny Title Register of Deeds

Township 35 North, Range 16 E., Section 24, Index No. N-25, Page No.

Vertical stamp: N 25