

U. S. PUBLIC LAND SURVEY MONUMENT RECORD

INSTRUCTIONS: This record shall show the location of the corner and shall include all of the following nine elements (a through i).

- (a) Identify the corner by reference to the U.S. public land survey system.
- = Corner monument restored.

Quarter corner to Sections 12 and 13,
Township 35 North, Range 16 East,
Forest County, Wisconsin

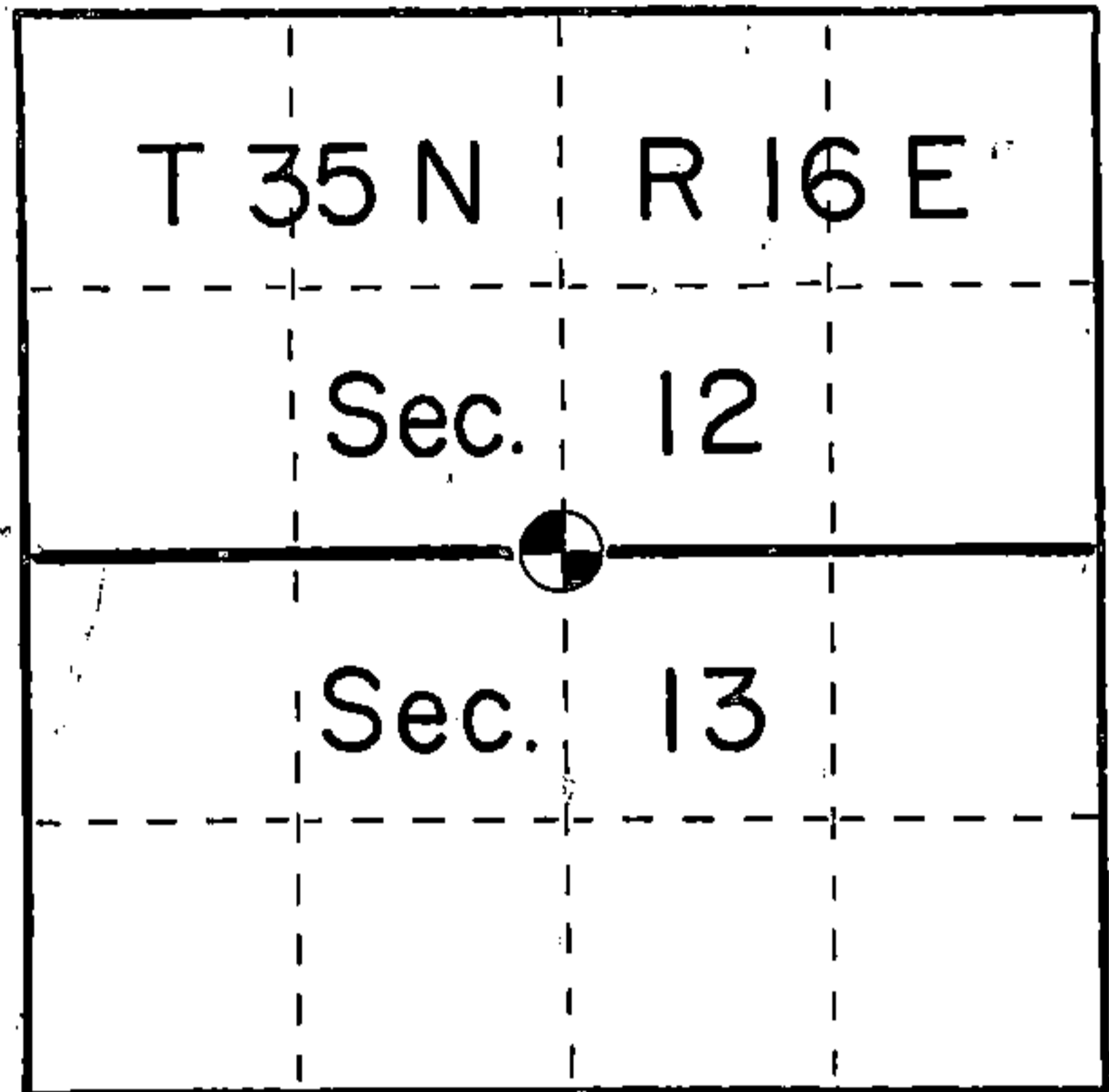

- (b) Describe any record evidence, monument evidence, occupational evidence, testimonial evidence or any other material evidence you considered, and whether the monument was found or placed.

In 1858 James McBride set a wood post at the corner position with:
Hemlock 12" S18W 40 links
Ironwood 5" N11W 13 links

Located a plantation post with 1 1/4" iron pipe set adjacent to it. This post fit stream calls to east well and from the post S 18W 26.4 ft/ located a Hemlock stump. The Hemlock stump helped verify the corner position and the post was therefore monumented using the original stump call.

- (c) In the plan view drawing below, provide reference ties to at least 4 witness monuments, or, if the location is within a municipality, to at least 2 witness monuments. (Witness monuments shall be made of concrete, natural stone, iron or other equally durable material.) Describe witness monuments.

- (d) Show a plan view drawing depicting the relevant monuments and reference ties which is sufficient in detail to enable accurate relocation of the corner monument if the corner monument is disturbed. Indicate north.

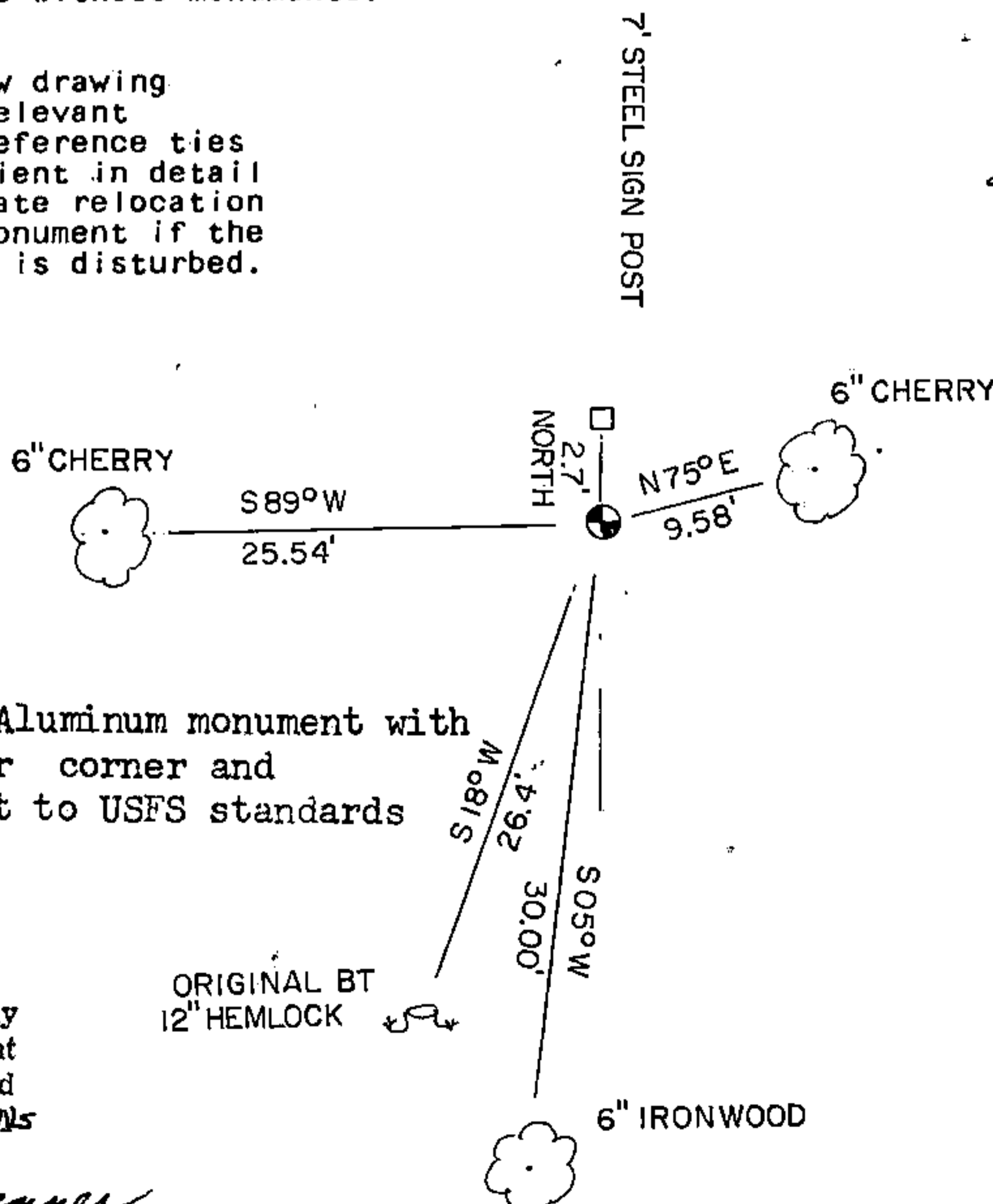

Set a 2"x 30" Aluminum monument with cap stamped for corner and accessories set to USFS standards

REGISTER'S OFFICE }
Forest County, Wis. }
Received for record this 7th day
of August A.D., 1985 at
3:00 o'clock P.M. and recorded
in Vol. CORNER RESTORATIONS
page J-23

Paul Aschenbrenner
Register of Deeds

INDEX NO. J-23

14 3516 12 00 20

(e) Describe any material discrepancy between the location of the corner as restored or reestablished and the location of that corner as previously restored or reestablished by distance and direction. Show the discrepancy on the plan view drawing under (d), above. Show the distances between the corner as previously restored or reestablished and (1) the corner as restored or reestablished, and (2) to at least 2 of the witness monuments shown on the drawing in (d), above.

No discrepancy

(f) Was the corner restored through acceptance of (1) an obliterated evidence location, or, (2) a found perpetuated location?

Found perpetuated location

(g&h) Was the corner reestablished through lost corner proportionate methods? If so, show the method, including the directions and distances to other public land survey corners used as evidence or used for proportioning in determining the corner location?

No

Kim H Pritzlaff

(i) I, Kim H Pritzlaff (type or print name) certify that the corner location shown on this record was determined by me or under my direction and control and that this U.S. Public Land Survey Monument Record is correct and complete to the best of my knowledge and belief.

Signature

Date

Kim H Pritzlaff

5-13-85



U. S. PUBLIC LAND SURVEY MONUMENT RECORD

INSTRUCTIONS:

This record shall show the location of the corner and shall include all of the following nine elements (a through i).

- (a) Identify the corner by reference to the U.S. public land survey system.
○ = Corner monument restored.

Quarter Corner Common to Sections 12 and 13, T.35N., R.16E., Forest County, Wisconsin

State Plane Coordinates

N - 133126.80
E - 2369336.72

Geographic Coordinates

N - 45-31-15.35
W - 88-26-10.14

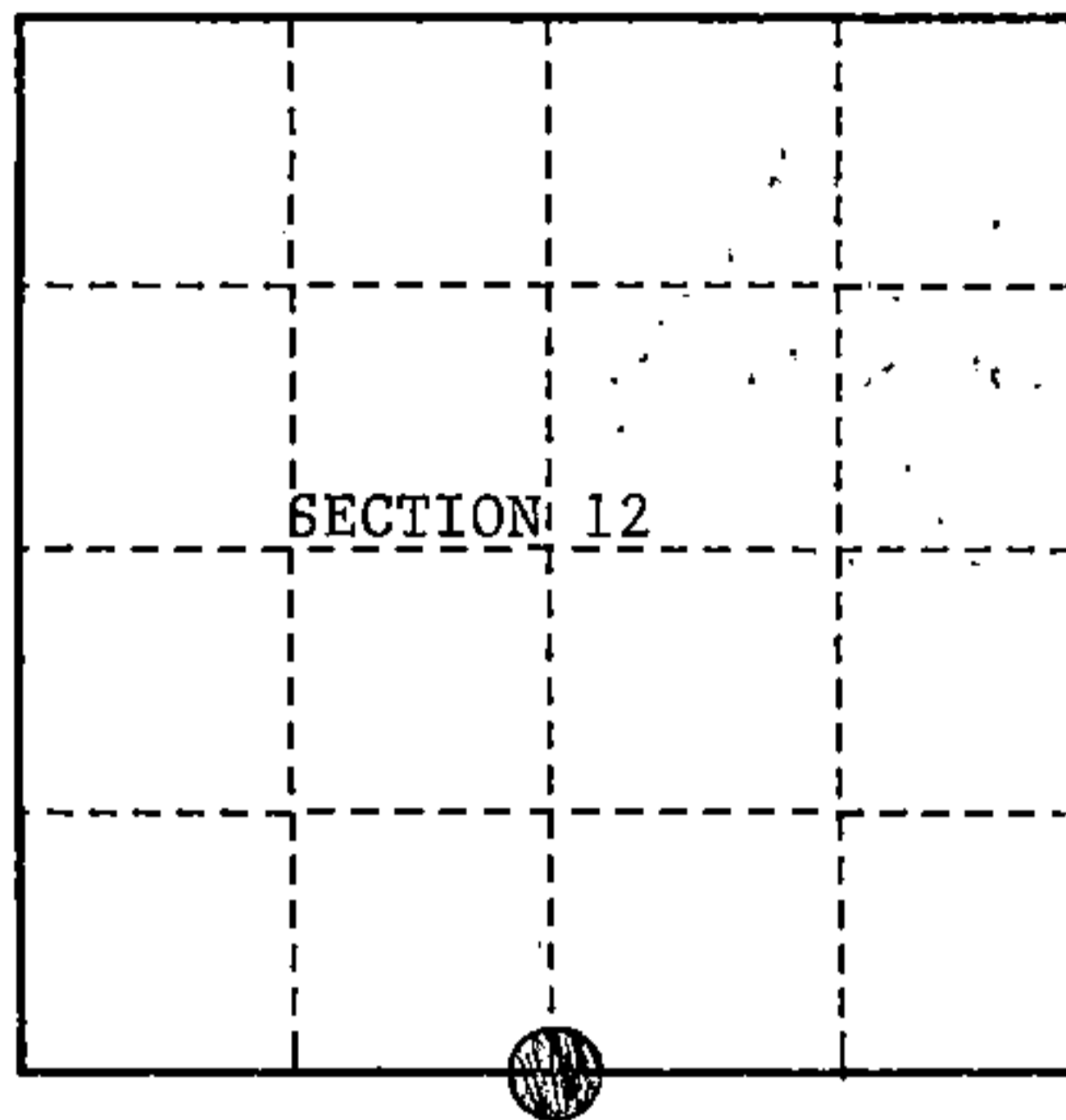

- (b) Describe any record evidence, monument evidence, occupational evidence, testimonial evidence or any other material evidence you considered, and whether the monument was found or placed.

In 1858 James McBride set a wood post at the corner position with: Hemlock 12" S.18°W., 40 links, Ironwood 5" N.11°W., 13 links.

In 1985, Kim Pritzlaff, R.L.S., located a plantation post with 1½" iron pipe set adjacent to it. This post fit stream calls to east well and from the post S.18°W., 26.4 feet, located a Hemlock stump. The Hemlock stump helped verify the corner position and the post was therefore monumented using the original stump call.

In 1998, Alan Harrison, R.L.S., found monument and bearing trees as described. Cut down all bearing trees for G.P.S. observations. New bearing trees (NBT) as listed below.

REGISTER'S OFFICE
Forest County, Wis.
Received for record this 29th day
of March A.D., 2001 at
8:35 o'clock A.M. and recorded
to Vol. Corner Restorations
page J-23
Kay Swanson, Deputy
Register of Deeds

- (c) In the plan view drawing below, provide reference ties to at least 4 witness monuments, or, if the location is within a municipality, to at least 2 witness monuments. (witness monuments shall be made of concrete, natural stone, iron or other equally durable material.)

- (d) Show a plan view drawing depicting the relevant monuments and reference ties which is sufficient in detail to enable accurate relocation of the corner monument if the corner monument is disturbed. Indicate north.

1. 2" x 30" aluminum monument stamped to identify corner
2. Elm, 5", N.76°E., 37.01 feet (NBT)
3. Sugar, 9", S.63°E., 50.53 feet (NBT)
4. Basswood, 12", S.06°W., 40.13 feet (NBT)
5. Steel sign post, Northwest, 0.45 feet

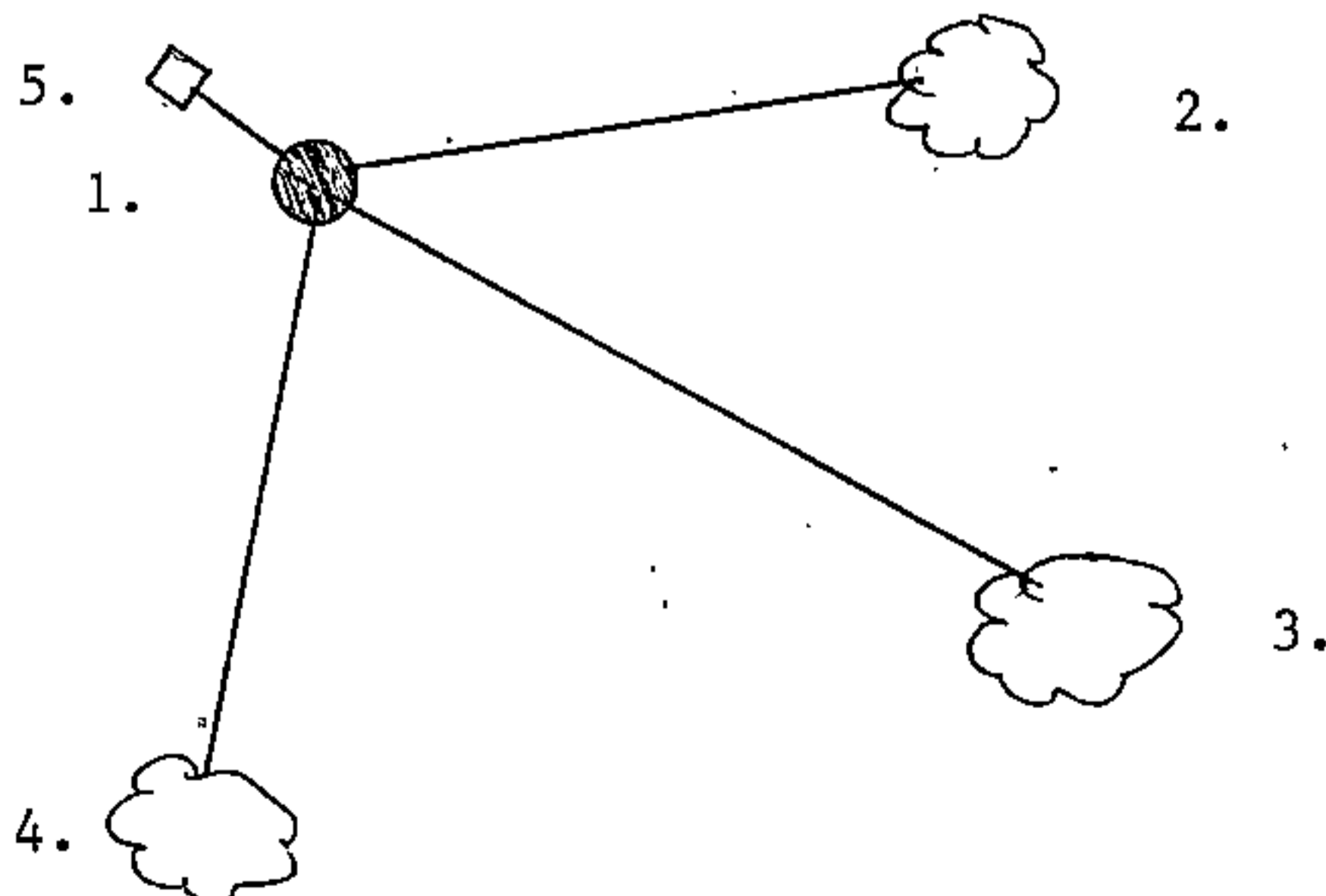

153
03

(e) Describe any material discrepancy between the location of the corner as restored or reestablished and the location of that corner as previously restored or reestablished by distance and direction. Show the discrepancy on the plan view drawing under (d), above. Show the distances between the corner as previously restored or reestablished and (1) the corner as restored or reestablished, and (2) to at least 2 of the witness monuments shown on the drawing in (d), above.

None

(f) Was the corner restored through acceptance of (1) an obliterated evidence location, or, (2) a found perpetuated location?

(2)

(g & h) Was the corner reestablished through lost corner proportionate methods? If so, show the method, including the directions and distances to other public land survey corners used as evidence or used for proportioning in determining the corner location?

No

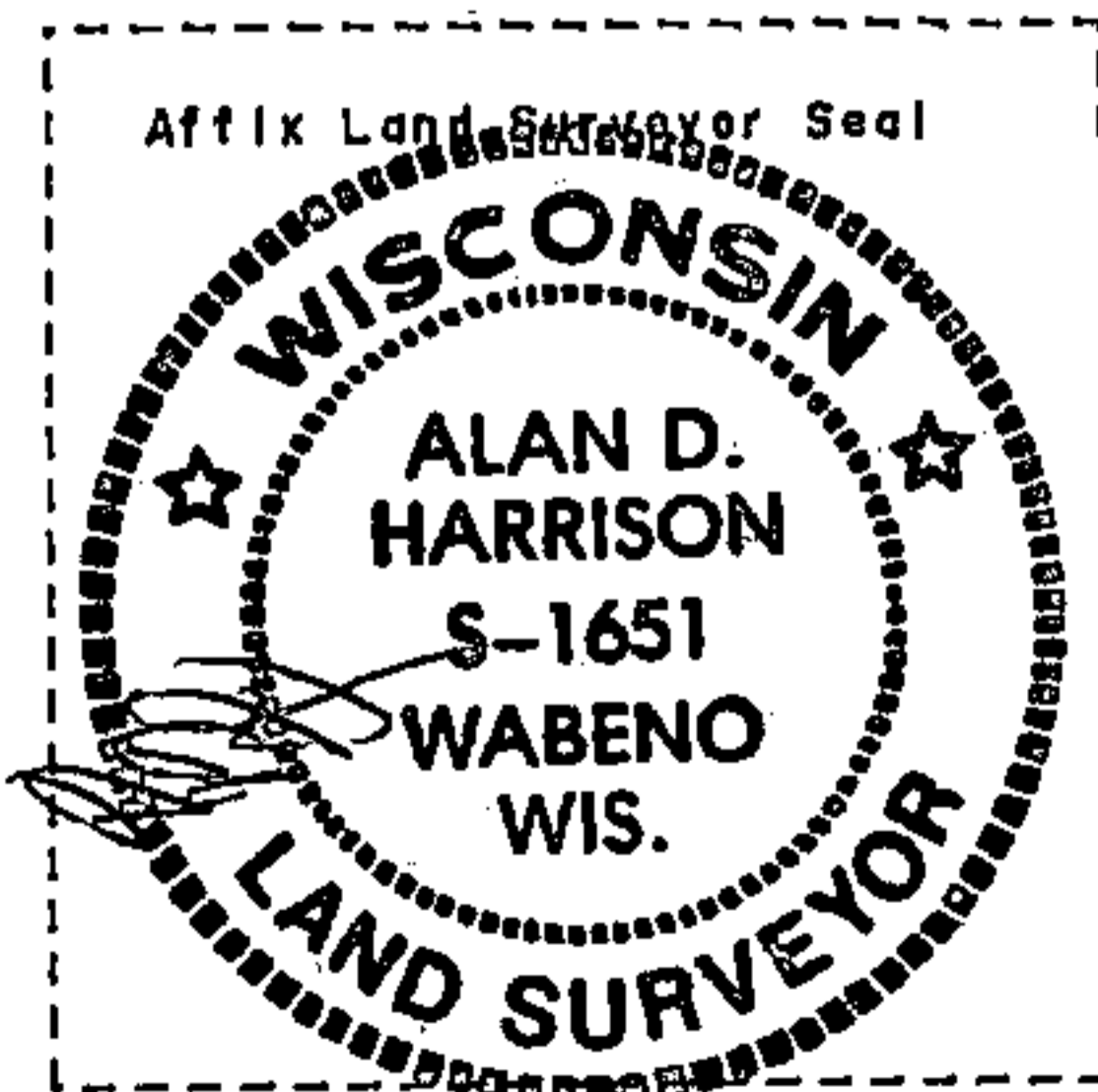

(1) I, Alan D. Harrison
(type or print name) certify that the corner location shown on this record was determined by me or under my direction and control and that this U.S. Public Land Survey Monument Record is correct and complete to the best of my knowledge and belief.

Alan D. Harrison 3/3/99
Signature Date

CERTIFICATE READY FOR FILING: [Signature] 3/25/99
District Ranger