

U. S. PUBLIC LAND SURVEY MONUMENT RECORD

INSTRUCTIONS: This record shall show the location of the corner and shall include all of the following nine elements (a through i).

- (a) Identify the corner by reference to the U.S. public land survey system.
- = Corner monument restored.

Quarter corner to Sections 11-12, Township 35 North, Range 16 East, Forest County, Wisconsin.

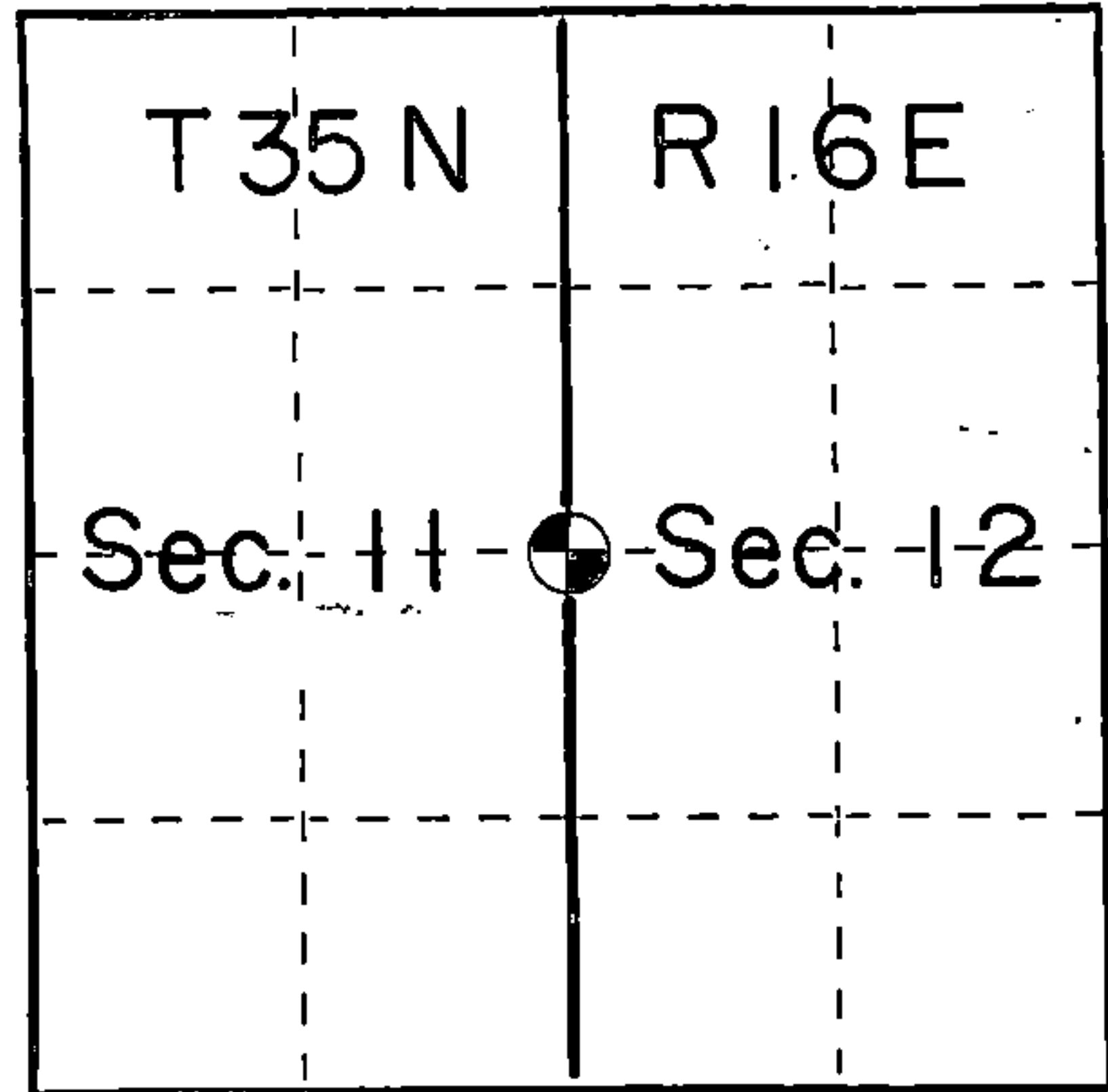

- (b) Describe any record evidence, monument evidence, occupational evidence, testimonial evidence or any other material evidence you considered, and whether the monument was found or placed.

In 1858 James McBride set a wood post at 40 chains with:
 Sugar 18" N83E 43 links
 Sugar 10" S45W 43 links

Located a 2" iron pipe set by Henry Gremmer, RLS from old wood post during a survey in 1967. Accepted this iron pipe position. No corner evidence around

- (c) In the plan view drawing below, provide reference ties to at least 4 witness monuments, or, if the location is within a municipality, to at least 2 witness monuments. (Witness monuments shall be made of concrete, natural stone, iron or other equally durable material.) Describe witness monuments.

- (d) Show a plan view drawing depicting the relevant monuments and reference ties which is sufficient in detail to enable accurate relocation of the corner monument if the corner monument is disturbed. Indicate north.

Set a 2"x 30" Aluminum monument with cap stamped for corner and accessories set to USFS standards.

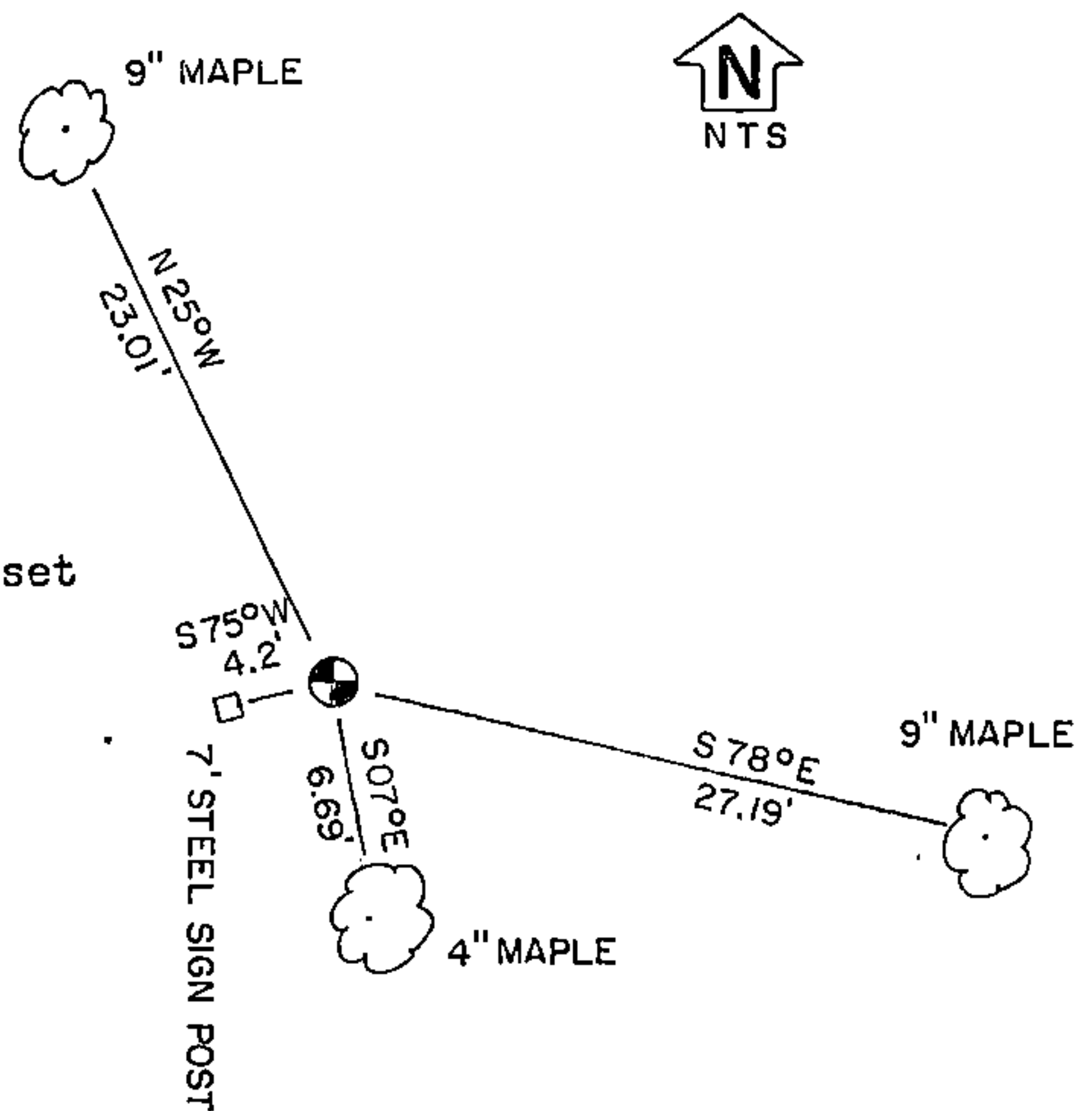

REGISTER'S OFFICE }
 Forest County, Wis. }
 Received for record this 7th day
 of August A.D., 1985 at
3:00 o'clock P.M. and recorded
 in Vol. CORNER RESTORATIONS
 page G-21
J. Aschwendt
 Register of Deeds

43516112000

(e) Describe any material discrepancy between the location of the corner as restored or reestablished and the location of that corner as previously restored or reestablished by distance and direction. Show the discrepancy on the plan view drawing under (d), above. Show the distances between the corner as previously restored or reestablished and (1) the corner as restored or reestablished, and (2) to at least 2 of the witness monuments shown on the drawing in (d), above.

No discrepancy

(f) Was the corner restored through acceptance of (1) an obliterated evidence location, or, (2) a found perpetuated location?

Found perpetuated position.

(g&h) Was the corner reestablished through lost corner proportionate methods? If so, show the method, including the directions and distances to other public land survey corners used as evidence or used for proportioning in determining the corner location?

No.

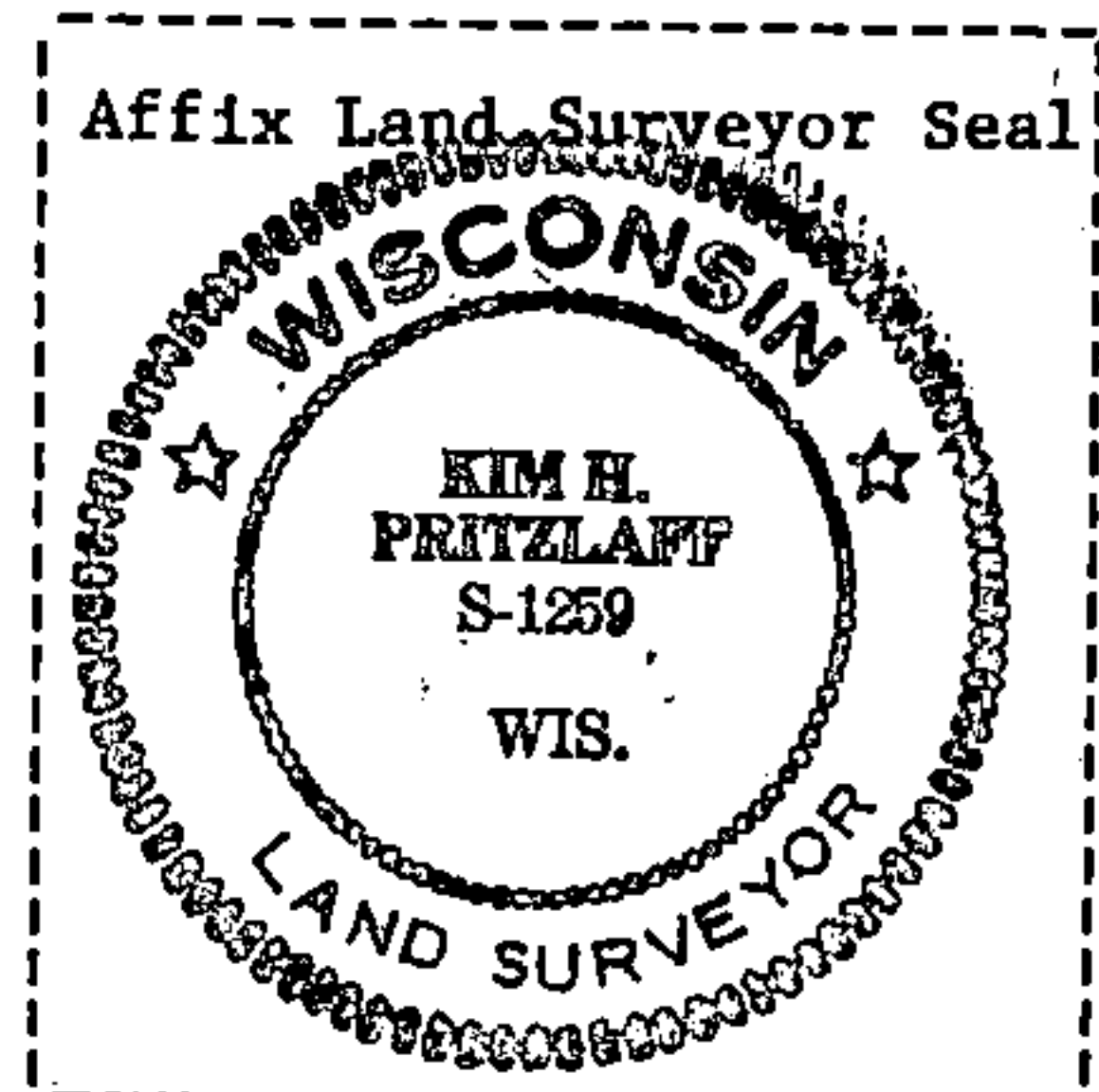
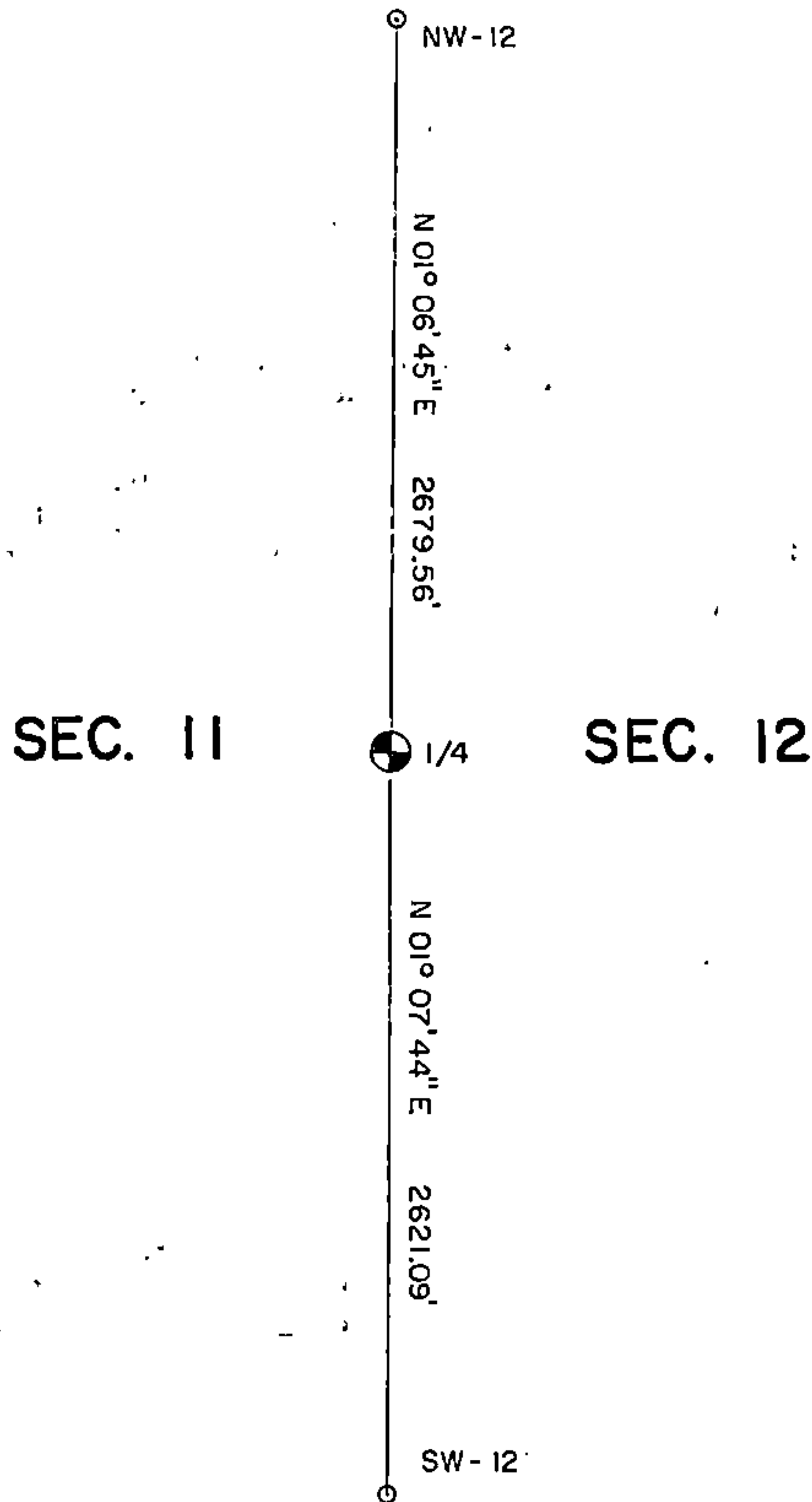

(i) I, Kim H Pritzlaff
 (type or print name) certify that the corner location shown on this record was determined by me or under my direction and control and that this U.S. Public Land Survey Monument Record is correct and complete to the best of my knowledge and belief.

Kim Pritzlaff
 Signature

5-16-85
 Date

U. S. PUBLIC LAND SURVEY MONUMENT RECORD

INSTRUCTIONS:

This record shall show the location of the corner and shall include all of the following nine elements (a through i).

- (a) Identify the corner by reference to the U.S. public land survey system.
- = Corner monument restored.

Quarter Corner Common to Sections 11 and 12, T.35., R.16E., Forest County, Wisconsin.

State Plane Coordinates
N - 135, 680.85
E - 2,366,642.59

Geographic Coordinates
N - 45-31-41.08
W - 88-26-47.27

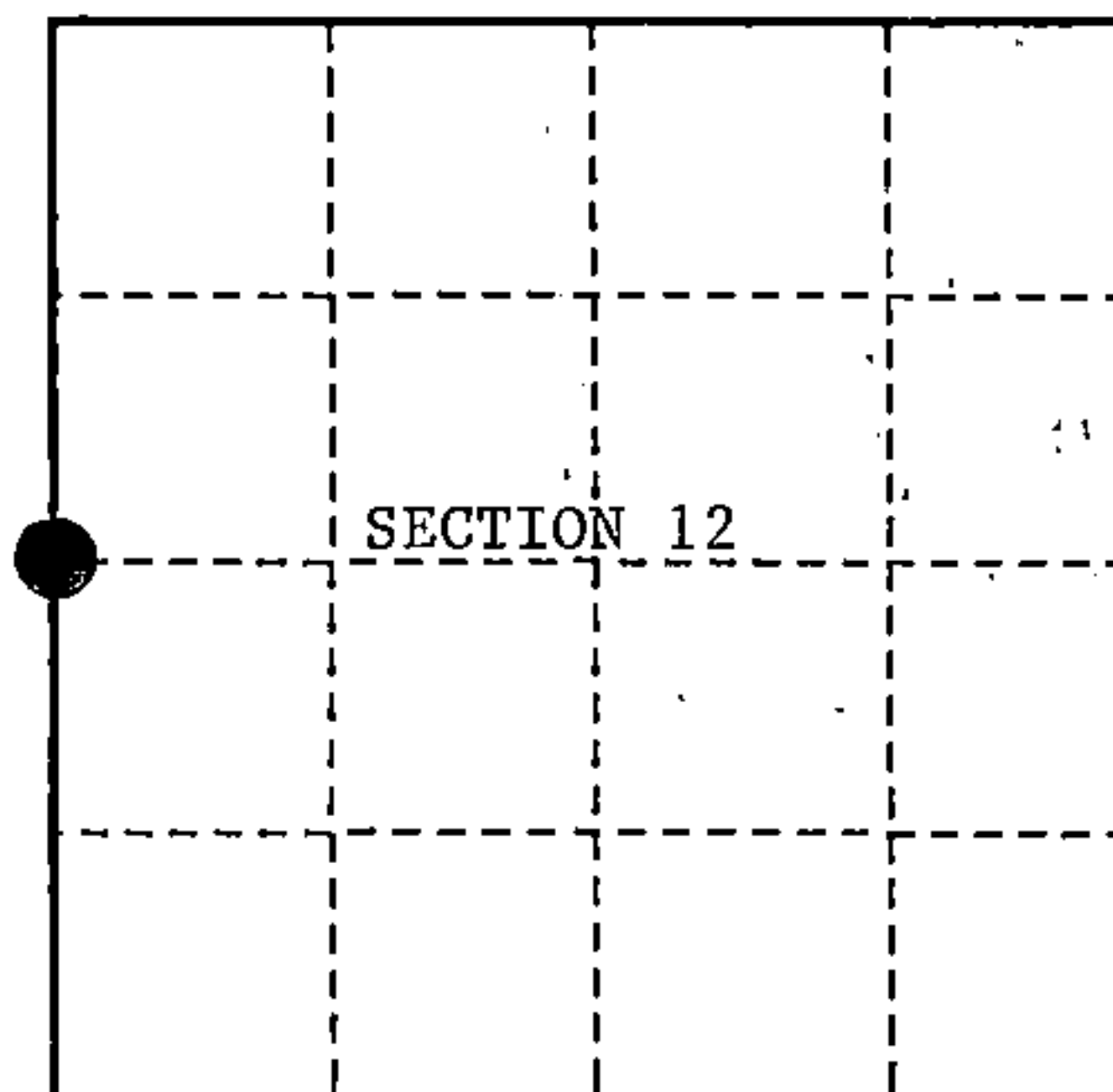

- (b) Describe any record evidence, monument evidence, occupational evidence, testimonial evidence or any other material evidence you considered, and whether the monument was found or placed.

In 1858, James McBride set a wood post at 40 chains with: Sugar, 18", N83°E., 43 links, Sugar, 10", S45°W., 43 links.

In 1985, Kim Pritzlaff, R.L.S., recovered an iron pipe set in 1967 by Henry Gremmer, R.L.S. Replaced pipe with a 2" x 30" aluminum monument and the bearing trees as described below.

In 1998, Alan Harrison, R.L.S., found a monument and B.T.s as set in 1985. Cut down Maple, S.07°E, 6.69 feet for G.P.S. observations. Made 1 new bearing tree (NBT) as shown below.

REGISTER'S OFFICE
Forest County, Wis.
Received for record this 24th day
of March A.D., 1999 at
1:15 o'clock P.M. and recorded
in Vol. CORNER RESTORATION
page G-21
Christie Ehlinger
Deputy Register of Deeds

- (c) In the plan view drawing below, provide reference ties to at least 4 witness monuments, or, if the location is within a municipality, to at least 2 witness monuments. (witness monuments shall be made of concrete, natural stone, iron or other equally durable material.)

- (d) Show a plan view drawing depicting the relevant monuments and reference ties which is sufficient in detail to enable accurate relocation of the corner monument if the corner monument is disturbed. Indicate north.

- 2" x 30" aluminum monument stamped to identify corner
- Sugar, 9", S.78°E., 27.19 feet
- Sugar, 12", S.23°W., 45.11 feet (NBT)
- Sugar, 7", S.75°W., 4.20 feet
- Sugar, 9", N.25°W., 23.01 feet
- Steel sign post S.75°W., 4.20 feet

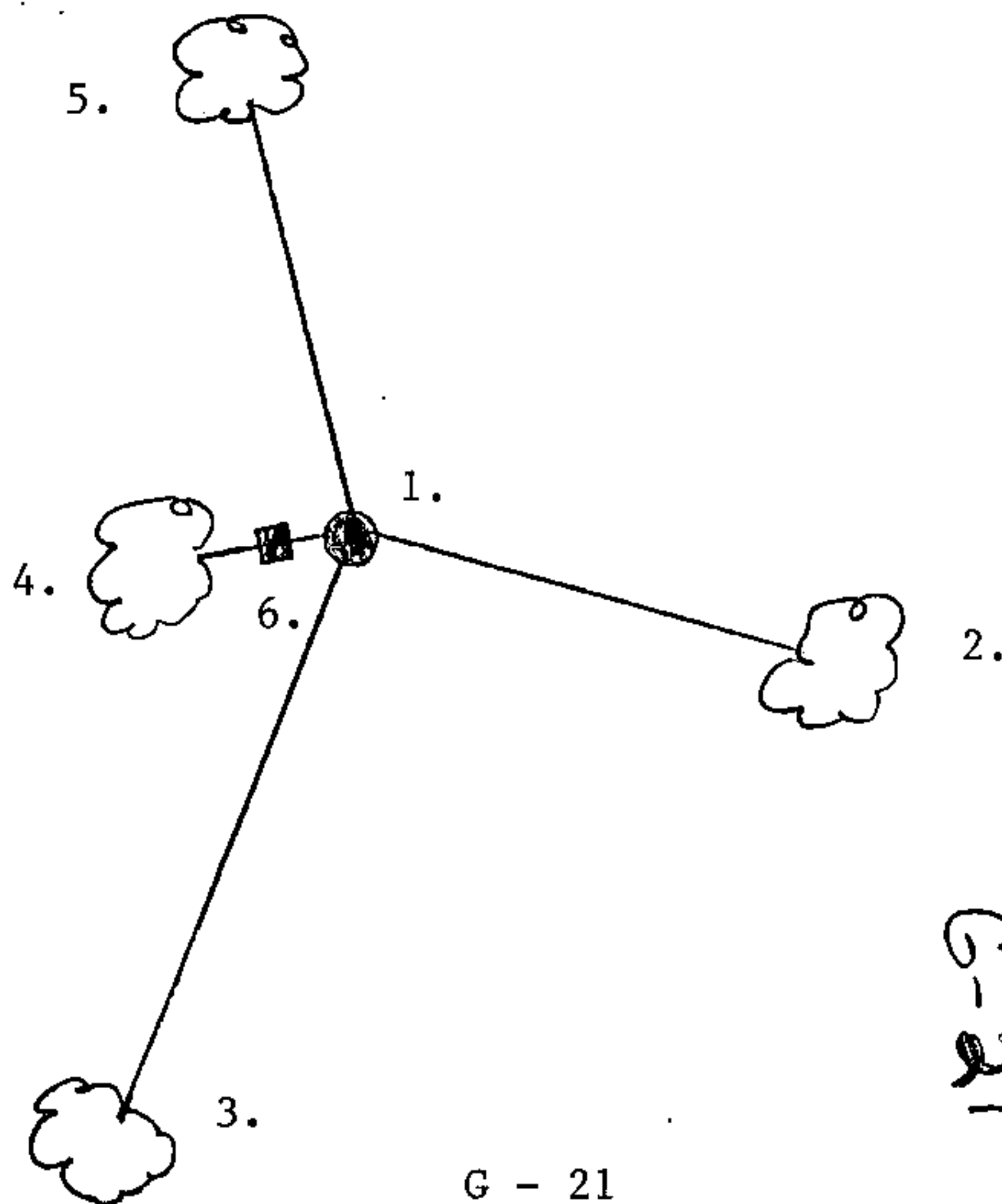

G-21

(e) Describe any material discrepancy between the location of the corner as restored or reestablished and the location of that corner as previously restored or reestablished by distance and direction. Show the discrepancy on the plan view drawing under (d), above. Show the distances between the corner as previously restored or reestablished and (1) the corner as restored or reestablished, and (2) to at least 2 of the witness monuments shown on the drawing in (d), above.

None

(f) Was the corner restored through acceptance of (1) an obliterated evidence location, or, (2) a found perpetuated location?

(2)

(g & h) Was the corner reestablished through lost corner proportionate methods? If so, show the method, including the directions and distances to other public land survey corners used as evidence or used for proportioning in determining the corner location?

No

(1) I, Alan D. Harrison

(type or print name) certify that the corner location shown on this record was determined by me or under my direction and control and that this U.S. Public Land Survey Monument Record is correct and complete to the best of my knowledge and belief.

Alan D. Harrison 3/16/99
Signature Date

CERTIFICATE READY FOR FILING:

[Signature]
District Ranger

