

# U. S. PUBLIC LAND SURVEY MONUMENT RECORD

INDEX NO. G-9

Quarter \_\_\_\_\_ Corner to Section 8 9 T 35N, R 16E  
(Section/Quarter)

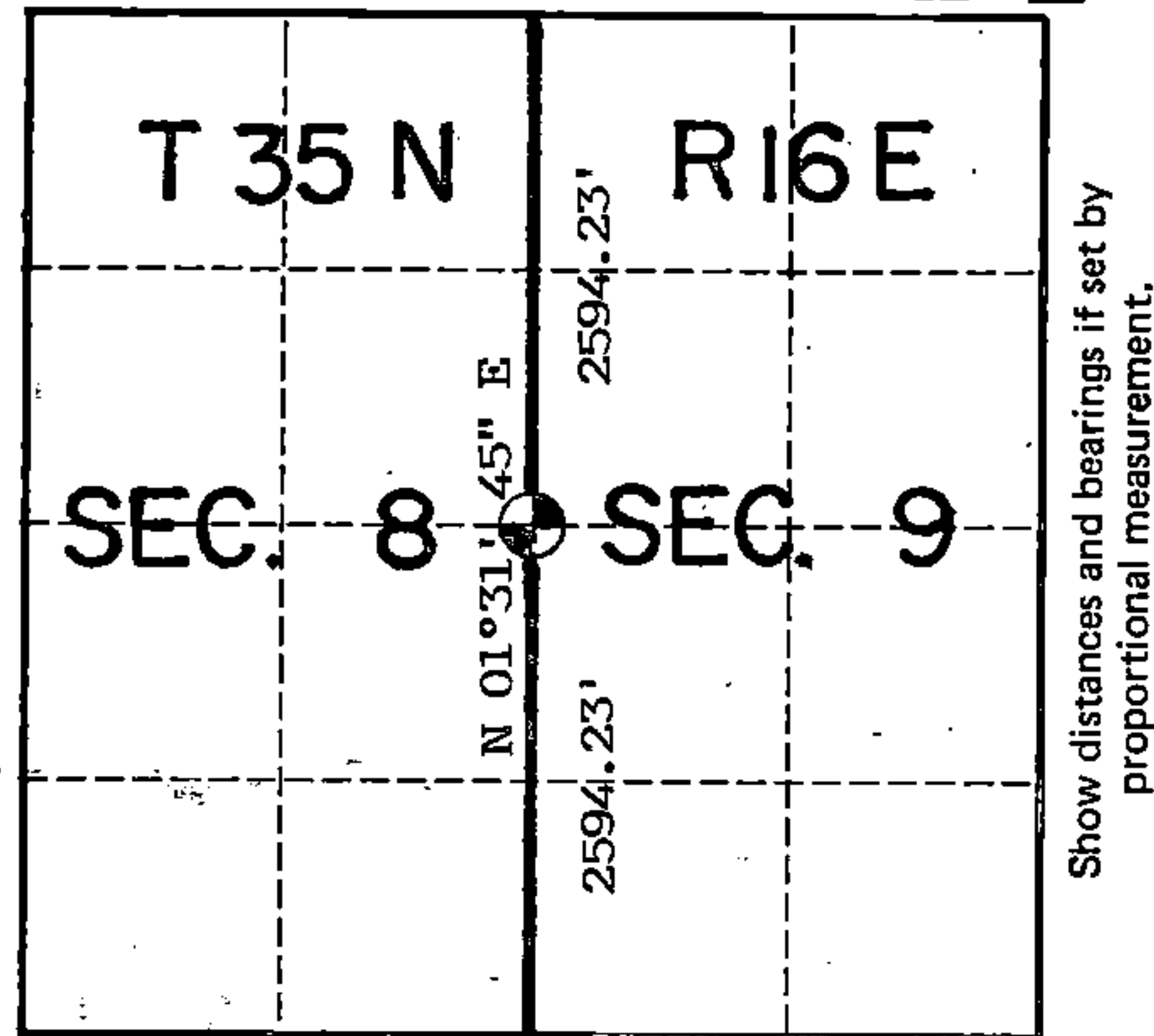

Show distances and bearings if set by proportional measurement.

○ = Corner monument restored.

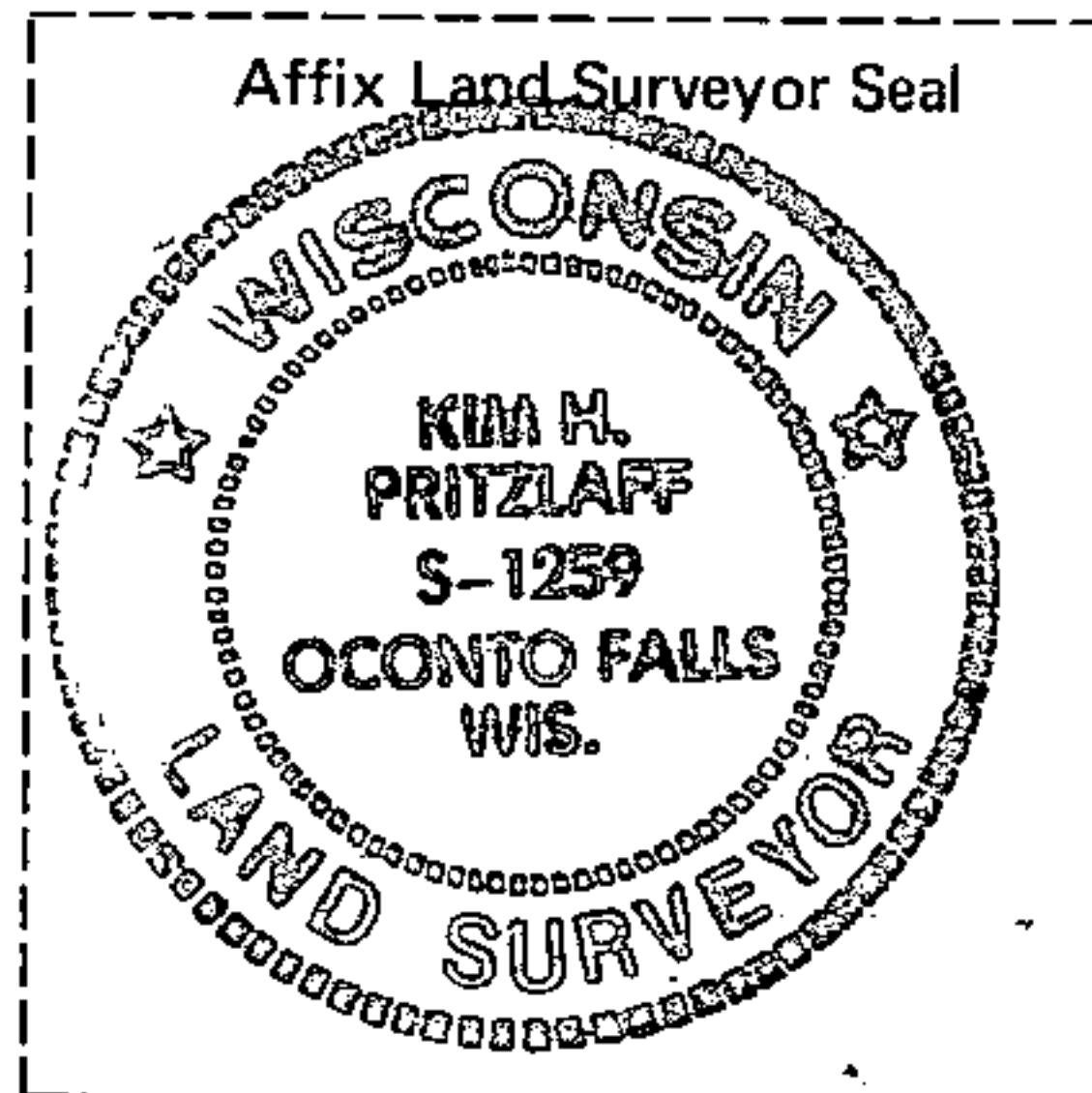

Set a 2"x 36" aluminum monument with cap stamped for corner. No suitable bearing trees fell within range, so four 1" x 24" iron pipe were set as shown with steel sign post adjacent to them. Bearings are magnetic.

I, Kim H Pritzlaff, RLS No. 1259  
(Type or print name) certify that the corner location shown on this record was determined by me or under my direction and control and that this U.S. Public Land Survey Monument Record is correct and complete to the best of my knowledge and belief.

*Kim H Pritzlaff*  
Signature

1993.  
Date

History of original corner establishment, record evidence, monument evidence, occupational evidence, testimonial evidence or any other material evidence, and what you found and how the monument was set.

In 1858 James McBride, contract surveyor, set this corner at 40 chains using the following bearing trees:

Fir	8"	N48W	4 links
Fir	8"	N67E	9 links

A search area for this corner was set up at single proportionate location. The corner position fell in recently logged Aspen slashing. No evidence of the corner or blazed lines were found. The corner was determined to be lost and was set at single proportionate measure.

In the plan view drawing below, provide reference ties to at least 4 witness monuments, or, if the location is within a municipality, to at least 2 witness monuments. (Witness monuments shall be made of concrete, natural stone, iron or other equally durable material, except wood other than bearing trees.) Also, show any material discrepancies between the corner restored or re-established and the location of any other previous corner location or occupation.

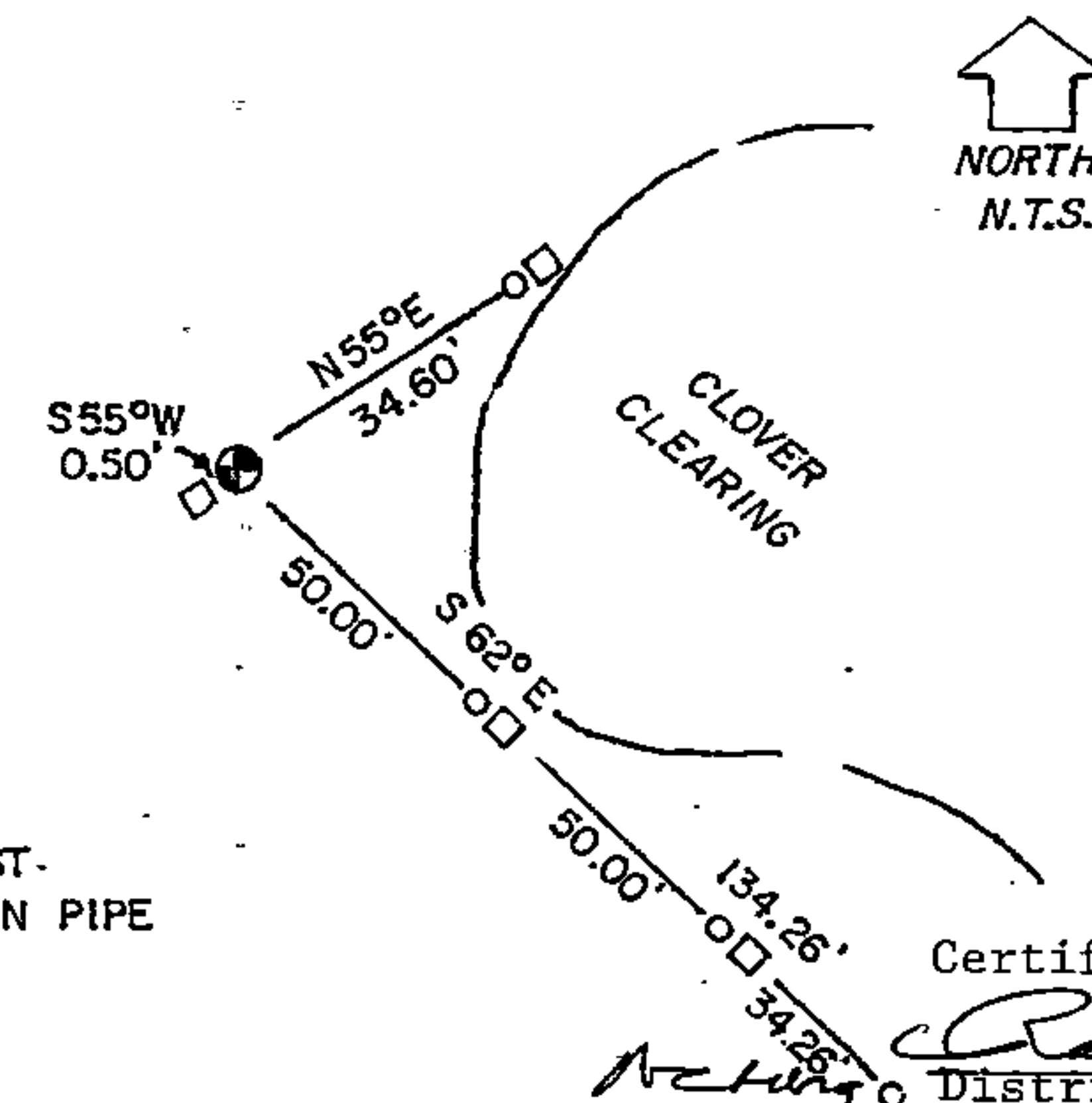

⊙ = USFS MON.  
□ = USFS SIGN POST.  
○ = SET 1" x 24" IRON PIPE

Certificate Ready For Filing  
*Ralph [Signature]*  
District Ranger

149054

4351608 2000

INDEX NO. \_\_\_\_\_

MAINTENANCE RECORD

Condition of Monument \_\_\_\_\_

Condition of Ties \_\_\_\_\_

New Ties, if any:

\_\_\_\_\_  
Date

\_\_\_\_\_  
Signature

Condition of Monument \_\_\_\_\_

Condition of Ties \_\_\_\_\_

New Ties, if any:

\_\_\_\_\_  
Date

\_\_\_\_\_  
Signature

Condition of Monument \_\_\_\_\_

Condition of Ties \_\_\_\_\_

New Ties, if any:

\_\_\_\_\_  
Date

\_\_\_\_\_  
Signature

REGISTER'S OFFICE  
FOREST COUNTY, WIS.

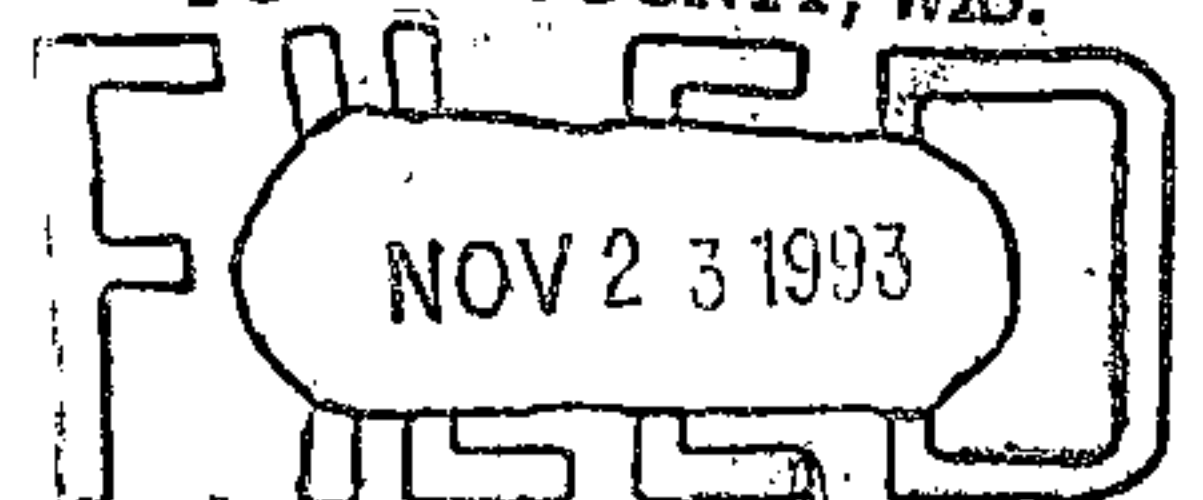

*Paul Ackermann* At 9 O'clock A.M.  
Register of Deeds