

# U. S. PUBLIC LAND SURVEY MONUMENT RECORD

INDEX NO. E-7

Quarter \_\_\_\_\_ Corner to Section 5 8 T35 N, R16 E  
(Section/Quarter)

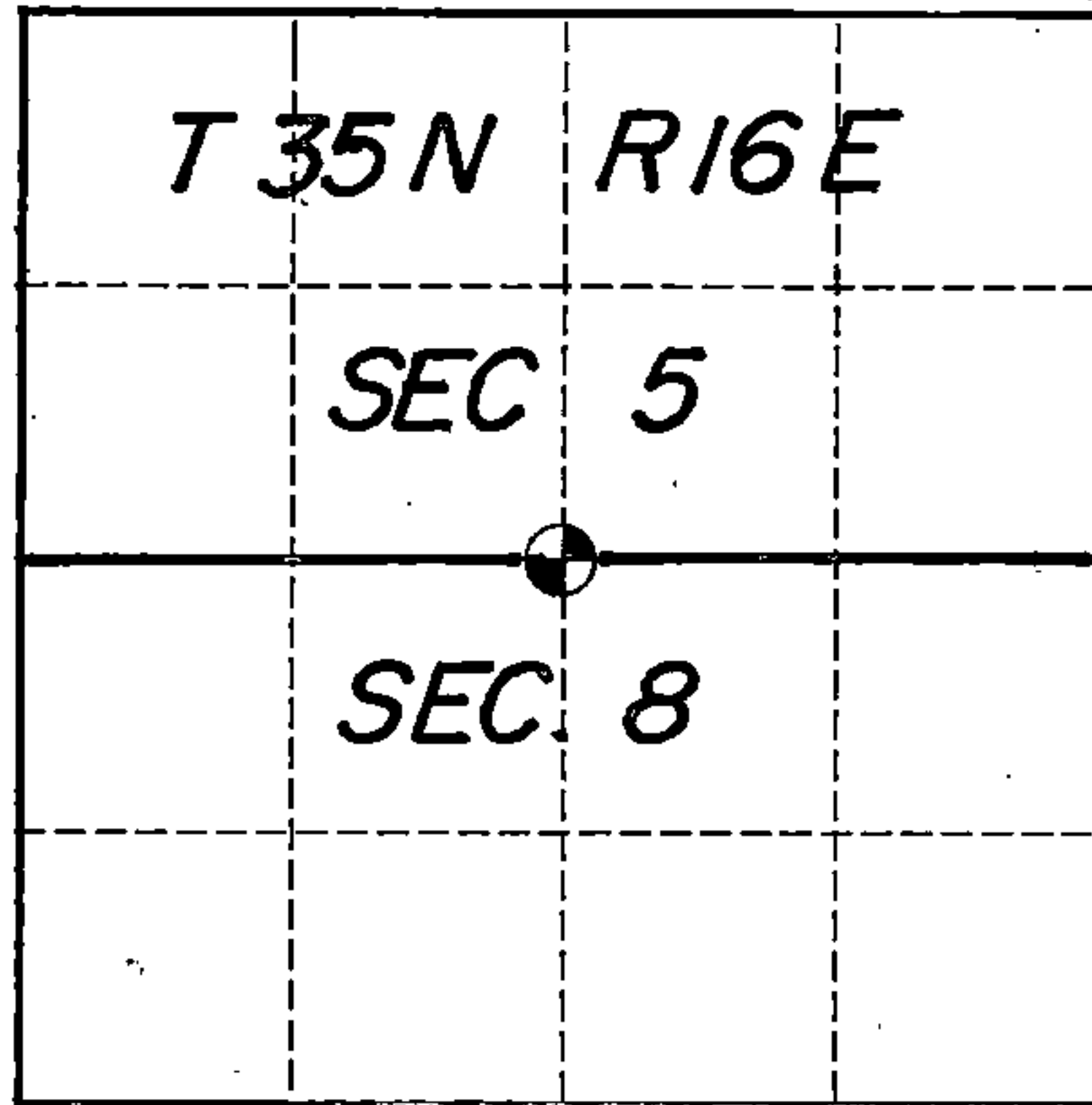

Show distances and bearings if set by proportional measurement.

○ = Corner monument restored.

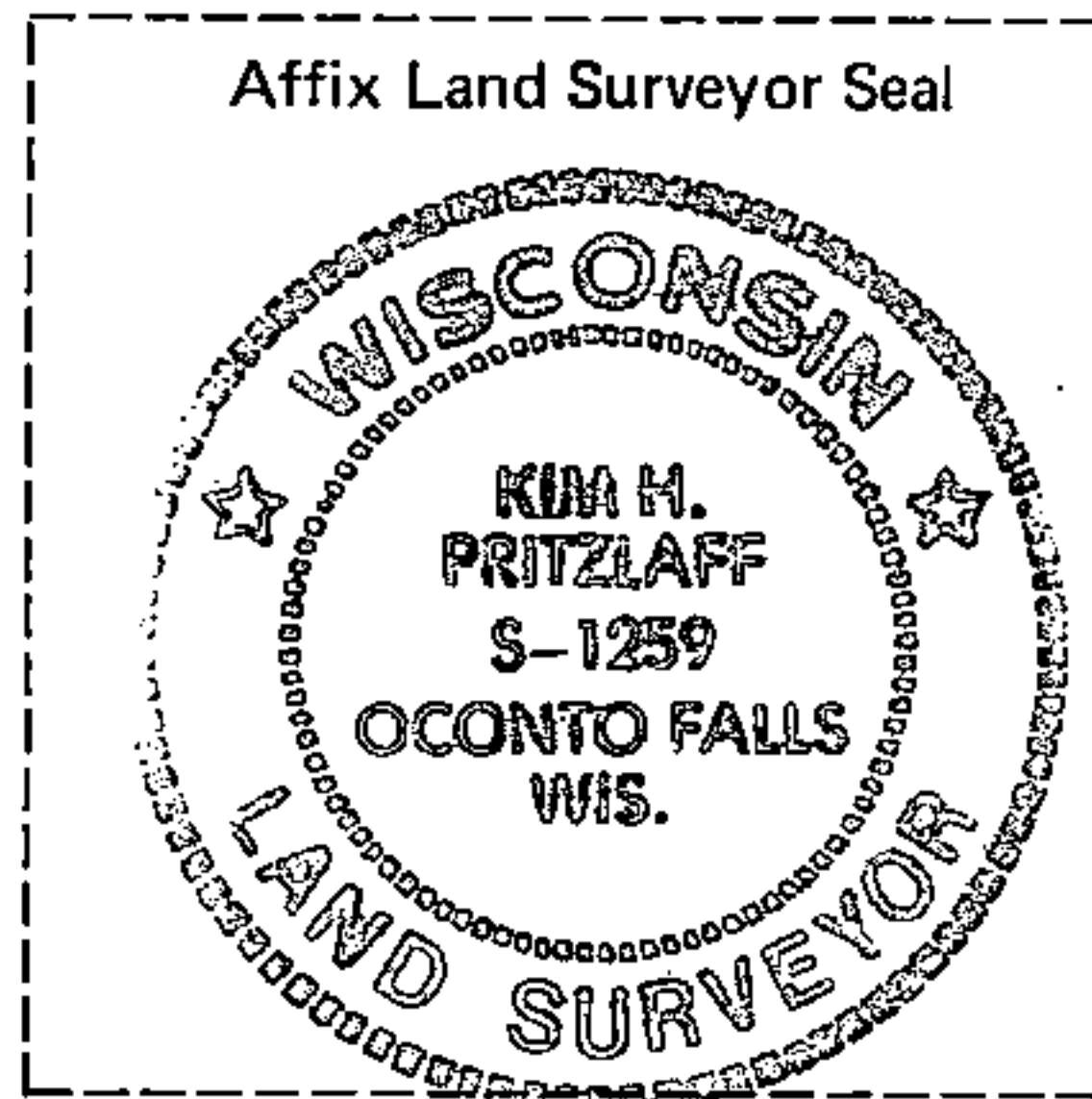

Set a 2"x36" Aluminum Post with cap stamped for corner in place of existing wood post. Bearings and distances shown are to nails driven into the tree centers with measurements to the nearest foot. Bearings are magnetic.

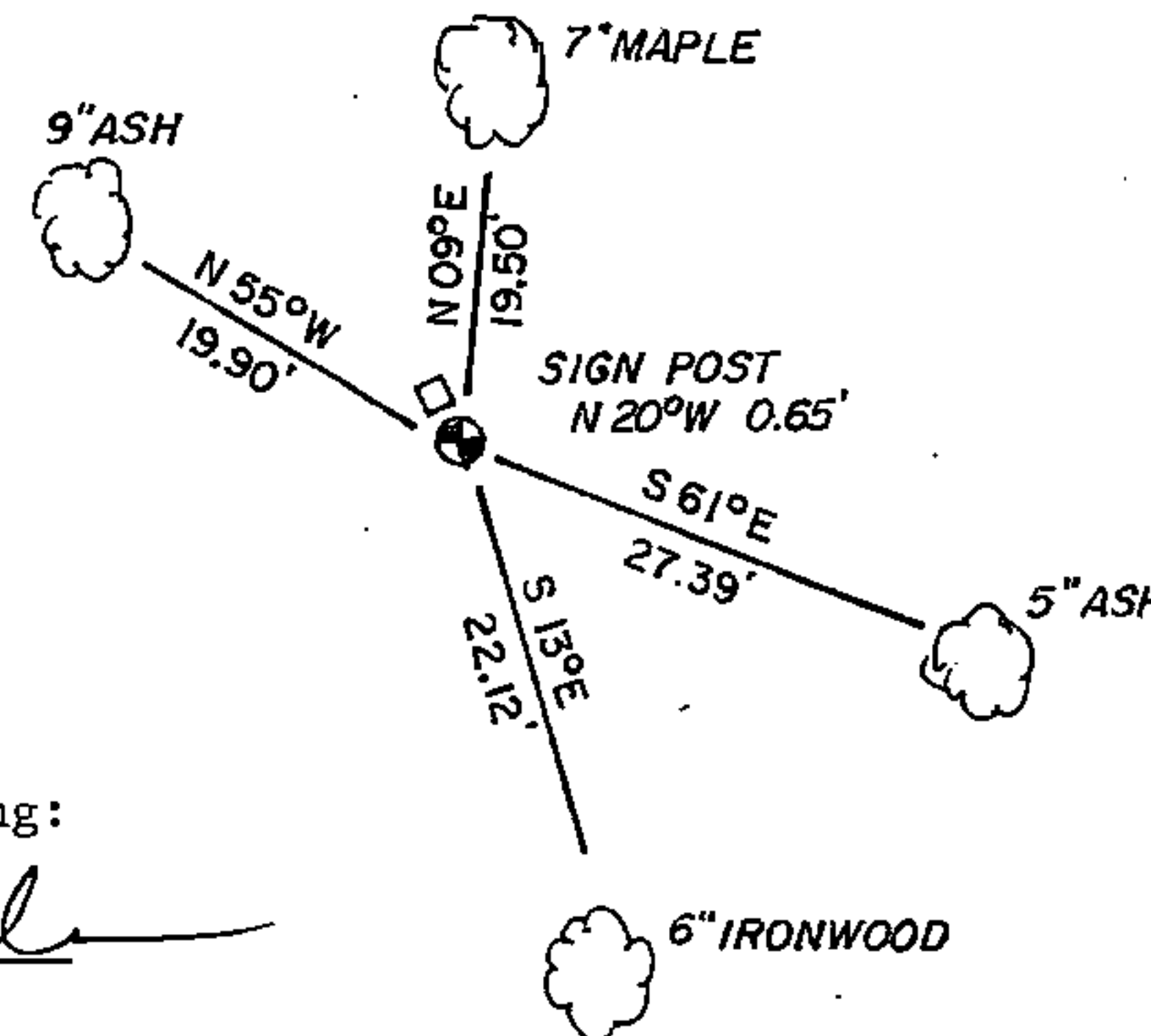

History of original corner establishment, record evidence, monument evidence, occupational evidence, testimonial evidence or any other material evidence, and what you found and how the monument was set.

In 1858, James McBride, contract surveyor, set this corner at 40 chains and marked the following bearing trees:

- Fir 8" N03W 3 links
- Hemlock 11" S10W 30 links

During a traverse of Section 8, a squared cedar post was found in a rock cairn approximately 2640 ft east of the section corner. A CCC tag was also found nailed to a nearby tree. I pulled S10W for 22 feet and found rotted Hemlock stump evidence. I accepted the post as the corner perpetuation and monumented same.

In the plan view drawing below, provide reference ties to at least 4 witness monuments, or, if the location is within a municipality, to at least 2 witness monuments. (Witness monuments shall be made of concrete, natural stone, iron or other equally durable material, except wood other than bearing trees.) Also, show any material discrepancies between the corner restored or re-established and the location of any other previous corner location or occupation.

149053

43516050020

I, Kim H Pritzlaff, RLS  
(Type or print name) certify that the corner location shown on this record was determined by me or under my direction and control and that this U.S. Public Land Survey Monument Record is correct and complete to the best of my knowledge and belief.

*Kim H Pritzlaff*  
Signature

1993  
Date

Plat Ready For Filing:

*Ralph Leibel*  
Acting District Ranger

INDEX NO. \_\_\_\_\_

MAINTENANCE RECORD

Condition of Monument \_\_\_\_\_

Condition of Ties \_\_\_\_\_

New Ties, if any:

\_\_\_\_\_ Date

\_\_\_\_\_ Signature

Condition of Monument \_\_\_\_\_

Condition of Ties \_\_\_\_\_

New Ties, if any:

\_\_\_\_\_ Date

\_\_\_\_\_ Signature

Condition of Monument \_\_\_\_\_

Condition of Ties \_\_\_\_\_

New Ties, if any:

\_\_\_\_\_ Date

\_\_\_\_\_ Signature

REGISTER'S OFFICE  
FOREST COUNTY, WIS.  
NOV 23 1993  
Paul A. [Signature] Register of Deeds