

LOCATION  
RESTORATION  
CERTIFIED LAND CORNER

State of Wisconsin

County of Forest

} ss.

I Jean F. Resvick, do hereby certify that on the 29 day of April, 19 77,  
~~I found evidence of the~~ located the East sixteenth corner ~~of~~ between sections 12 and 13  
 Township 35 North, Range 15 East, Fourth Principal Meridian, as described  
 hereon; and that ~~from this evidence~~ I established a new monument and accessories as described hereon to per-  
 petuate the ~~original~~ location of this corner:

Description of original monument and accessories and subsequent restorations:

None

Description of corner evidence found:

Location of corner set on line and at midpoint between the  
 section corner and quarter corner.

Section corner bears N89°14'E, 1288.32 ft.

Quarter corner bears S89°14'W, 1288.32 ft.

Description of monument and accessories I established to perpetuate the location of this corner:

At the corner position set a 2 inch inside diameter galvanized iron pipe,  
 3 feet long, filled with concrete, with brass cap stamped:

T35N, R15E, S12, E 1/16, S13, 1977, S-802

Corner buried in road.

Blazed and scribed the following bearing trees

Hemlock 8, N23E, 57.77 feet

Hemlock 21, S40E, 66.97 feet

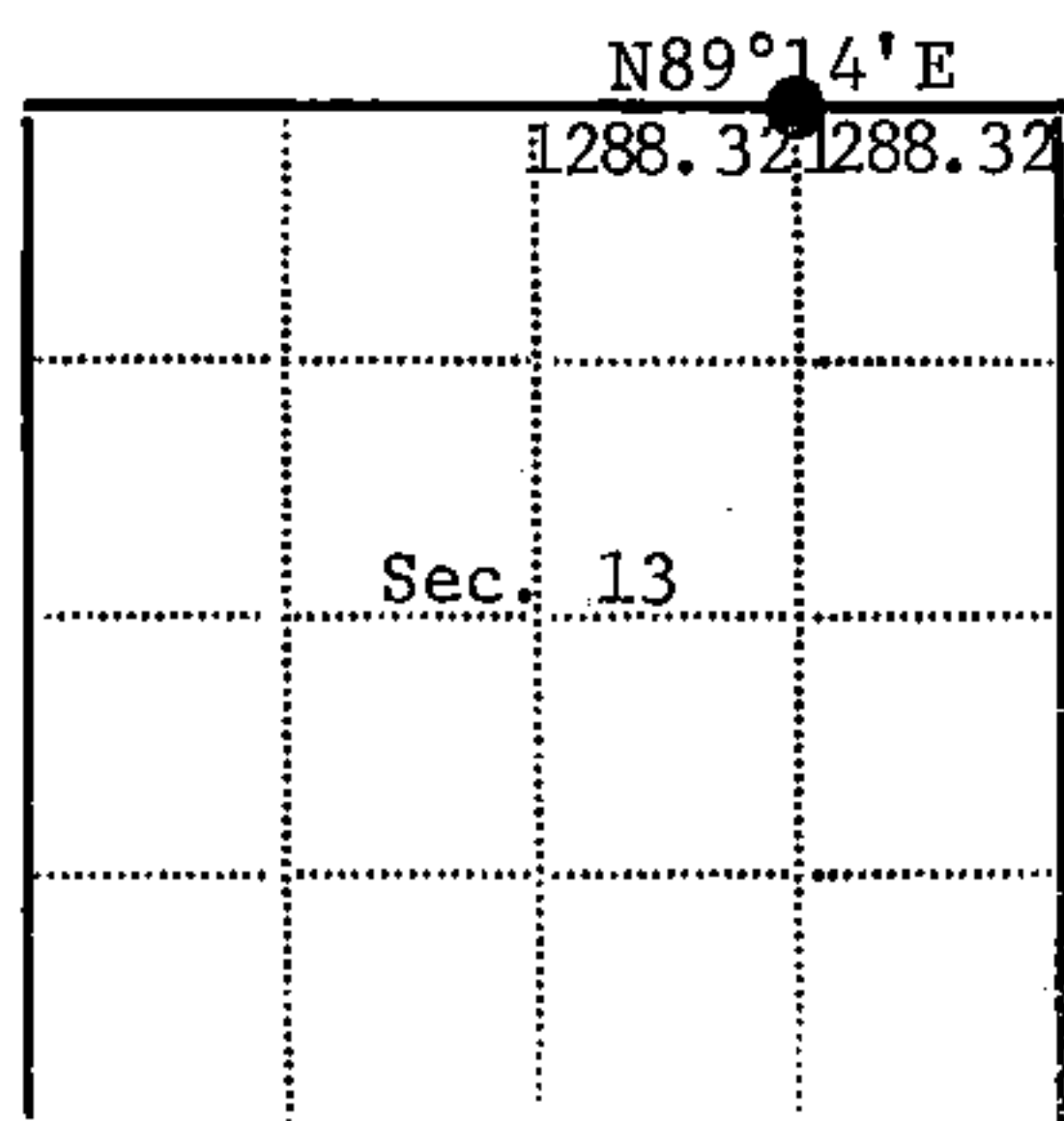
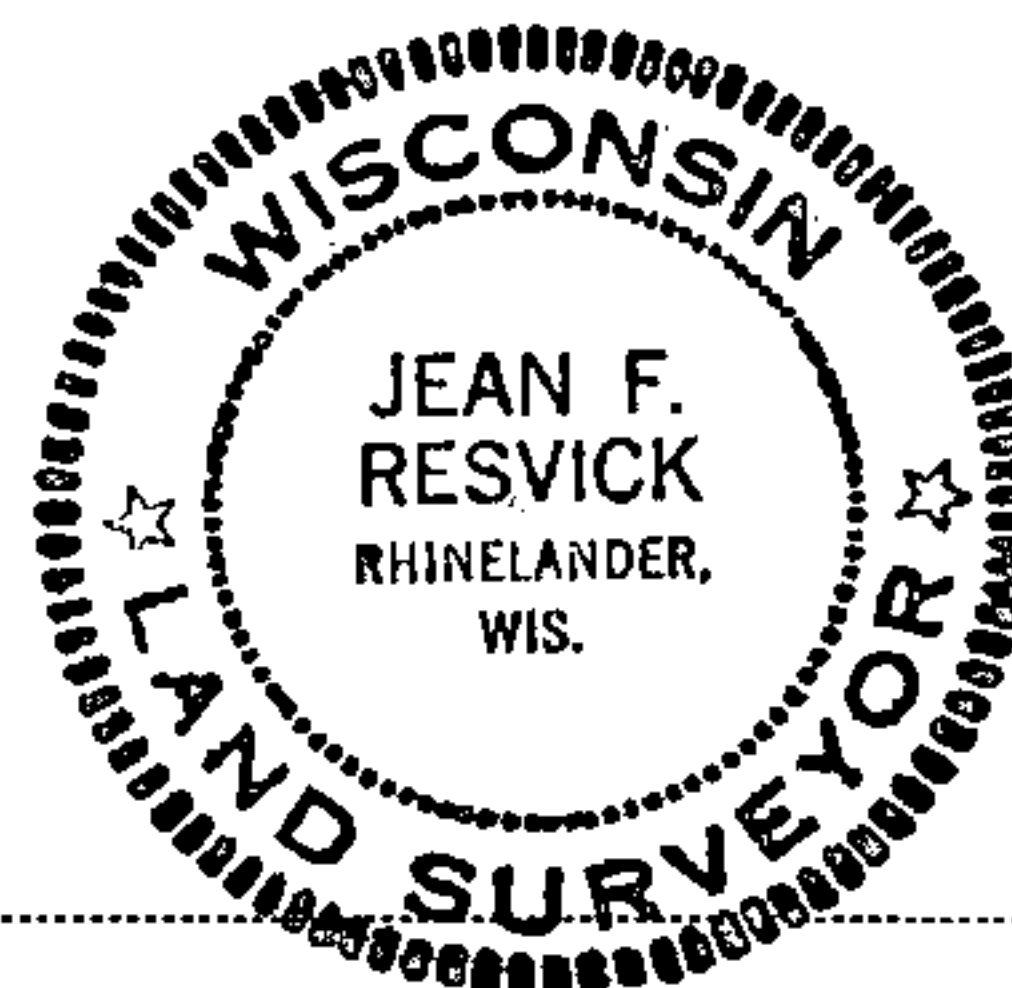

● - Corner monument restored

□ -

Resident witnesses \_\_\_\_\_

Dated at Rhineland Wisconsin, this 26 day of September  
 19 77.

Signature Jean F. Resvick Title Land Surveyor  
 (County Surveyor, Registered Land Surveyor, or other duly authorized official)

Surveyors Registration No. S-802 DOCUMENT NUMBER 113290

Office of Register of Deeds County of Forest

I hereby certify that the within instrument was filed in this office for record  
 on the 13th day of February, 19 78, and was filed in Book  
 No. \_\_\_\_\_ Page No. \_\_\_\_\_ of County Records.

Signature Eugene Staszny Title Register of Deeds

Township 35 North, Range 15 East, Section 13, Index No. J-24, Page No. \_\_\_\_\_

43515120010

J  
24

## U. S. PUBLIC LAND SURVEY MONUMENT RECORD

## INSTRUCTIONS:

This record shall show the location of the corner and shall include all of the following nine elements (a through i).

- (a) Identify the corner by reference to the U.S. public land survey system.  
 O = Corner monument restored.

East One - Sixteenth Corner between Sections 12 and 13, T.35N., R.15E., Forest County, Wisconsin.

State Plane Coordinates  
 Wisconsin North Zone  
 N - 132603.28249  
 E - 2338384.89547

Geographic Coordinates  
 N - 45 - 31 - 15.96679  
 W - 088 - 33 - 24.90382

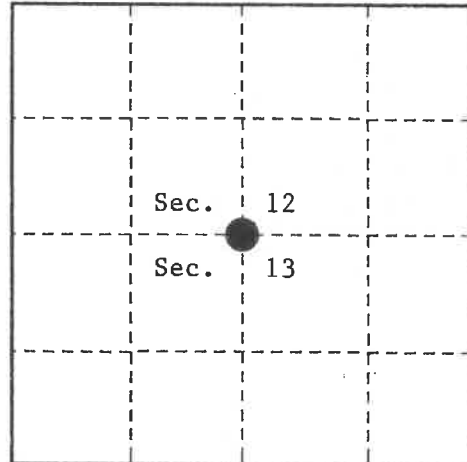

- (b) Describe any record evidence, monument evidence, occupational evidence, testimonial evidence or any other material evidence you considered, and whether the monument was found or placed.

In 1977, Jean Resvick, RLS, established the corner position at mid-point and on line between the Southeast Section Corner and the South Quarter Corner of Section 12. Set a 2" X 36" galvanized iron pipe with a brass cap stamped to identify corner. Made the following B.T.'s; Hemlock, 8", N.23°E., 57.77 feet, Hemlock, 21", S.40°E., 66.97 feet.

In 1994 Alan Harrison, RLS, found B.T.'s and monument below blacktop. The corner position was tied in to a 1994 G.P.S. survey of Section 12 and found to be out of position at a bearing of S.43° 24'44"E., 0.40 feet from the correct position. Moved the monument to its correct position and made new ties as noted below. Set railroad spike above monument.

- (c) In the plan view drawing below, provide reference ties to at least 4 witness monuments, or, if the location is within a municipality, to at least 2 witness monuments. (witness monuments shall be made of concrete, natural stone, iron or other equally durable material.)

- (d) Show a plan view drawing depicting the relevant monuments and reference ties which is sufficient in detail to enable accurate relocation of the corner monument if the corner monument is disturbed. Indicate north.

1. Railroad Spike in blacktop over 2" X 30" monument.
2. Hemlock, 8", N.23°E., 56.97 feet.
3. Hemlock, 21", S.40°E., 67.17 feet.
4. Steel Sign Post, North, 17.00 feet.
5. C/L of F.R. # 2136, South, 7.35 feet.

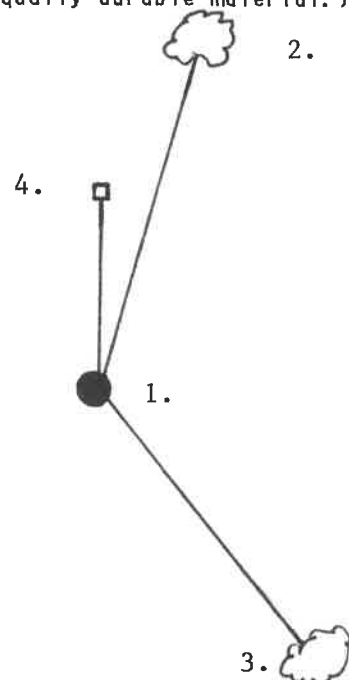

(e) Describe any material discrepancy between the location of the corner as restored or reestablished and the location of that corner as previously restored or reestablished by distance and direction. Show the discrepancy on the plan view drawing under (d), above. Show the distances between the corner as previously restored or reestablished and (1) the corner as restored or reestablished, and (2) to at least 2 of the witness monuments shown on the drawing in (d), above.

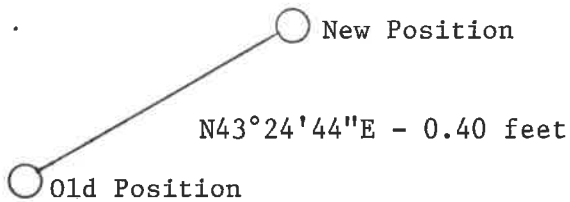

(f) Was the corner restored through acceptance of (1) an obliterated evidence location, or, (2) a found perpetuated location ?

(g & h) Was the corner reestablished through lost corner proportionate methods? If so, show the method, including the directions and distances to other public land survey corners used as evidence or used for proportioning in determining the corner location?

Established at mid-point and on line between the Southeast Section Corner and the South Quarter Corner of Section 12.

REGISTER'S OFFICE {  
Forest County, Wis.  
Received for record this 10<sup>th</sup> day  
of May, A.D., 19 95 at  
2:30 o'clock P.M. and recorded  
in Vol. Comm. Restorations  
page 35-15, 1-24  
Paul Chittie, Deputy  
Register of Deeds

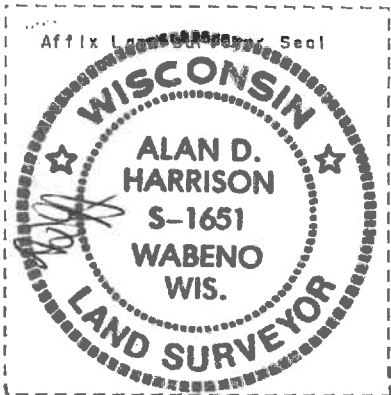

(1) I, Alan D. Harrison  
(type or print name) certify that the corner location shown on this record was determined by me or under my direction and control and that this U.S. Public Land Survey Monument Record is correct and complete to the best of my knowledge and belief.

Alan D. Harrison 4/25/95  
Signature Date

CERTIFICATE READY FOR FILING:

Greg Stucker  
District Ranger