

CERTIFIED LAND CORNER RESTORATION

State of Wisconsin

County of Forest

ss.

I Jean F. Resvick, do hereby certify that on the 28th day of July, 1969, I found evidence of the North quarter corner of Section 14 Township 35 North, Range 15 East, Fourth Principal Meridian, as described hereon; and that from this evidence I established a new monument and accessories as described hereon to perpetuate the original location of this corner:

Description of original monument and accessories and subsequent restorations:

Surveyed in 1859 by James McBride.

40:00 chains west corrected between sections 11 and 14. Set wood post.

Birch 12, bears S42E, 18 lks. Birch 14, bears N57E, 14 lks.

John Hammes on May 4, 1936 found cedar stake at ground level in center of road and a cedar post on the north side road.

Description of corner evidence found:

4 x 4 cedar post in mound of rock 33 ft. south of centerline of road. Post scribed $\frac{1}{4}$ S.

At a point 33 ft. north of post dug in road and found discoloration of post hole.



Description of monument and accessories I established to perpetuate the original location of this corner:

At post hole found set a 2 inch inside diameter, galvanized iron pipe, 5 feet long, 1 foot below surface of road. Blazed and scribed the following new bearing trees.

Jack Pine 13, bears N38E, 73.12 ft.

Jack Pine 10, bears N52W, 84.08 ft.

At 50 feet north and 50 feet south of corner set reference marks to corner. Reference marks are 2 inches inside diameter, galvanized wrought iron pipe 5 feet long filled with concrete, flanged on bottom with brass tablet stamped to identify corner.

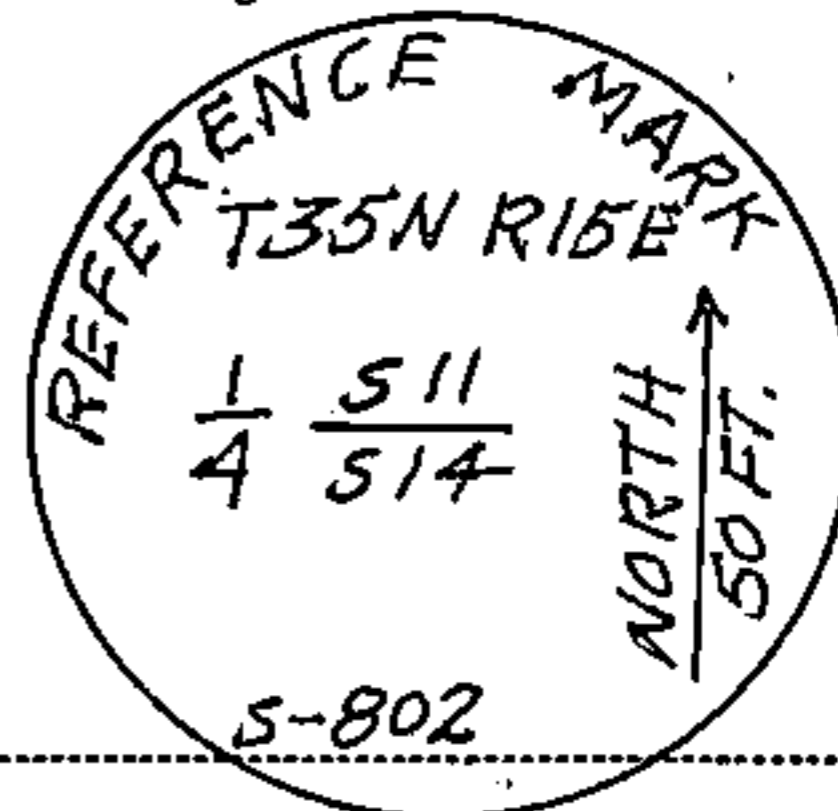
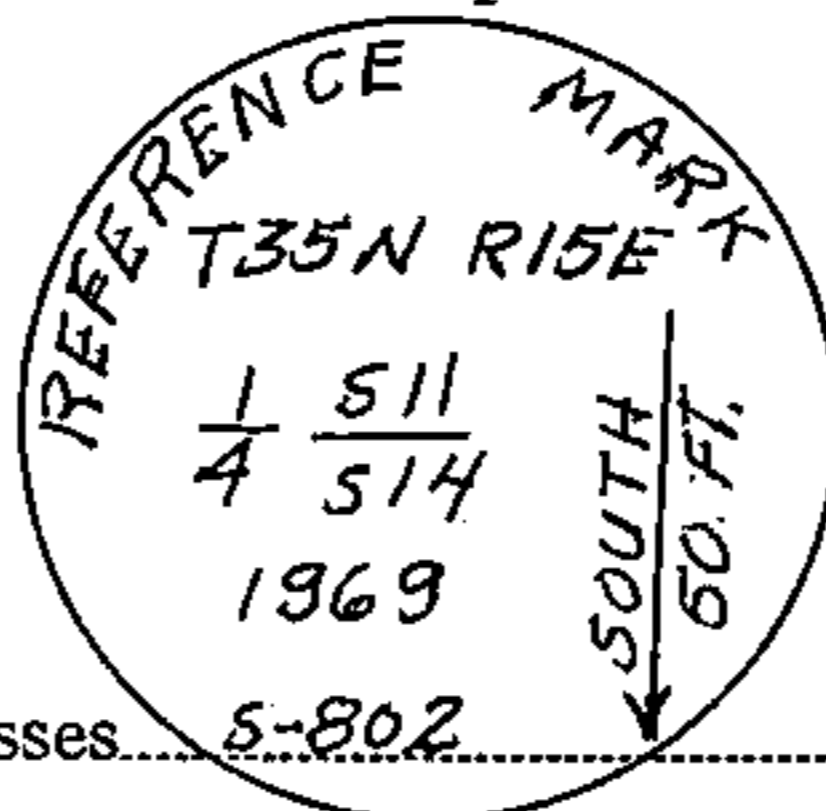
Resident witnesses S-802S-802Dated at Rhinelander, Wisconsin, this 24th day of Sept, 1969.Signature Jean F. Resvick Title Admitted Surveyor
(County Surveyor, Registered Land Surveyor, or other duly authorized official)Surveyors Registration No. S-802DOCUMENT Number 98039Office of Register of Deeds County of ForestI hereby certify that the within instrument was filed in this office for record on the 22nd day of May, 1970, and was filed in Book No. J-19 Page No. J-19 of County Records.Signature Eugene Stratney Title Register of DeedsTownship 35 North, Range 15 E, Section 14, Index No. J-19, Page No. 19

4351511007.0

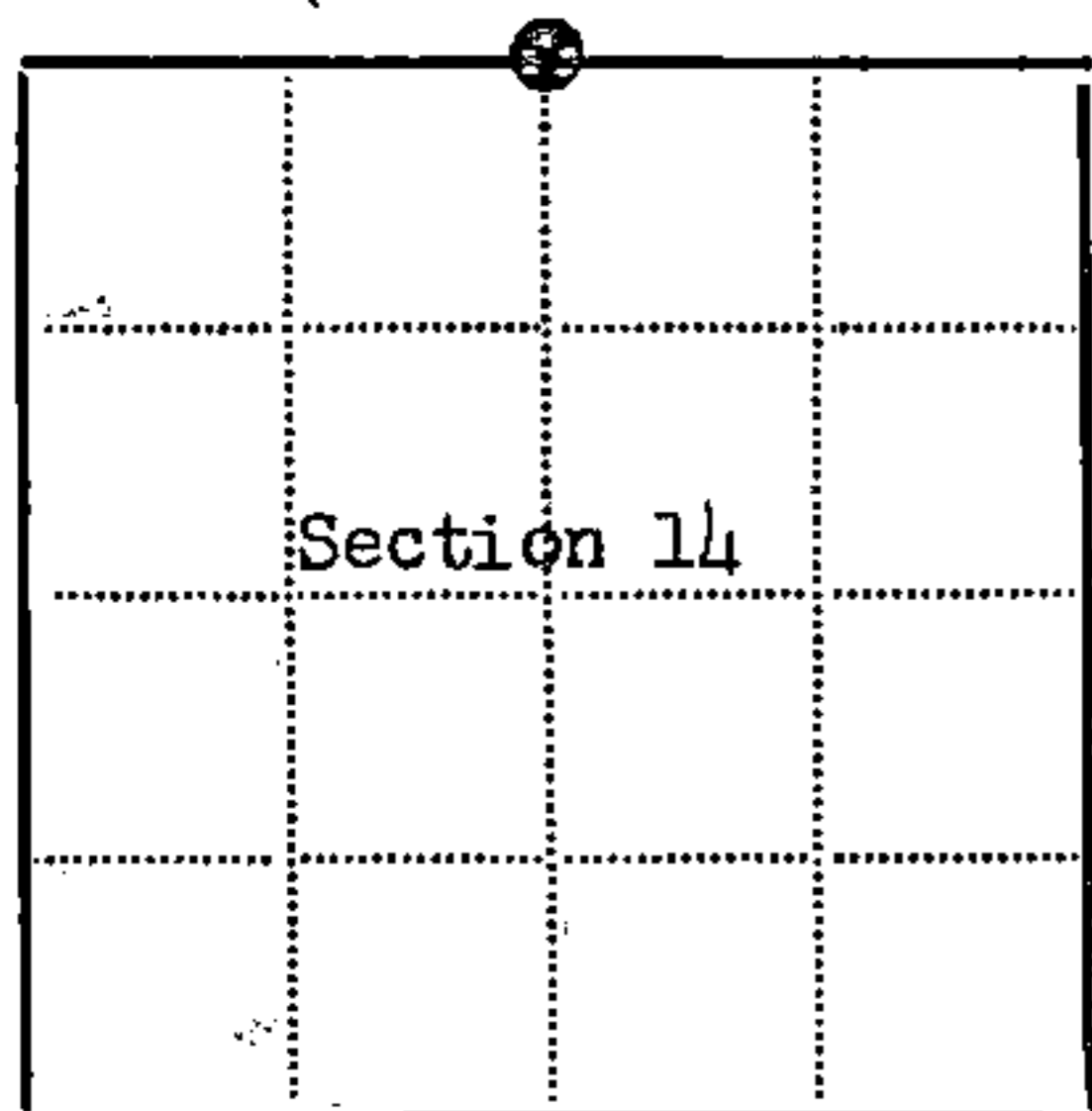

● = Corner monument restored

□ =

U. S. PUBLIC LAND SURVEY MONUMENT RECORD

INSTRUCTIONS:

This record shall show the location of the corner and shall include all of the following nine elements (a through i).

- (a) Identify the corner by reference to the U.S. public land survey system.

○ = Corner monument restored.

Quarter Corner to Sections 11 and 14, T.35N., R.15E.

REGISTER'S OFFICE
Forest County, Wis.

Received for record this 31st day
of March A.D., 1988 at

1:10 o'clock P.M. and recorded
in Vol. CORNER RESTORATIONS

page 19
Paul A. Schenck
Register of Deeds

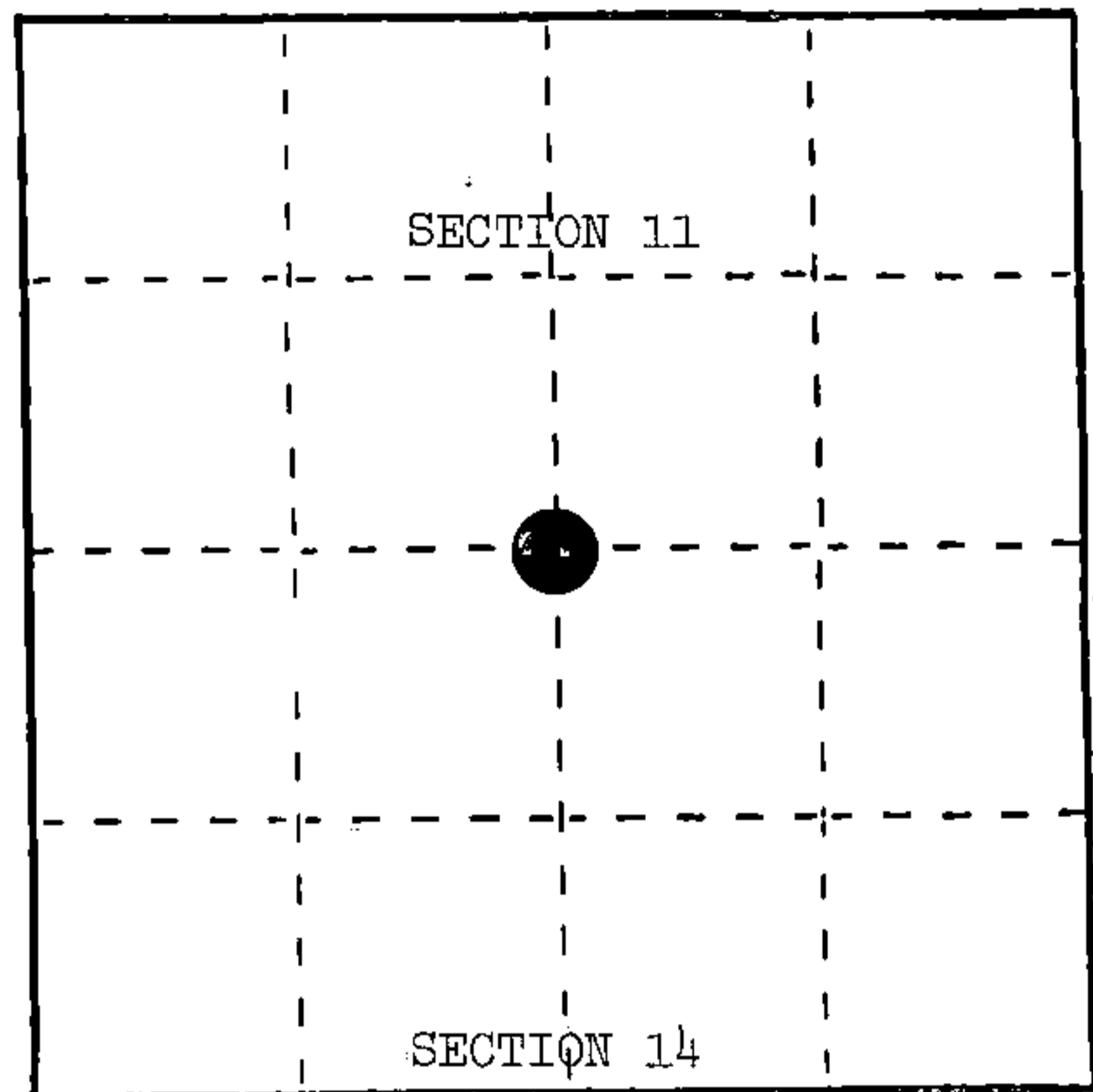

- (b) Describe any record evidence, monument evidence, occupational evidence, testimonial evidence or any other material evidence you considered, and whether the monument was found or placed.

In 1859, James McBride set a wood post with the following BTs: Birch, 12", S.42°E., 18 links; Birch, 14", N.57°E., 14 links. In 1904, N. Smith found original corner and witnesses to be okay. In 1908, J. Melendy found 4" x 4" Ironwood post from resurvey with the following original BTs: Birch, 14", S.24½°E., 18 links; Birch, 18", N.57°E., 13½ links. He then set a 5" x 5" Elm post in place of previous post. In 1936, John Hammes found a Cedar stake in good condition on north side of road. He did not believe stake to be original due to lack of any original evidence. In 1969, J. Resvick found Cedar post in mound of rock on south side of road. Set corner north, 33 feet from post found in road. In 1987, Alan Harrison (RLS) restored position by retracement of J. J. Melendy's survey from Center 1 through the CN 1/16. Corner position agrees with N. Smith's 1904 survey and J. Melendy's 1908 survey.

- (c) In the plan view drawing below, provide reference ties to at least 4 witness monuments, or, if the location is within a municipality, to at least 2 witness monuments. (Witness monuments shall be made of concrete, natural stone, iron or other equally durable material.)
Describe witness monuments.

- (d) Show a plan view drawing depicting the relevant monuments and reference ties which is sufficient in detail to enable accurate relocation of the corner monument if the corner monument is disturbed. Indicate north.

1. Railroad spike in road surface.
2. Jack Pine, 8", N.34°E., 73.81 feet
3. Sugar, 6", S.32°E., 70.30 feet
4. Jack Pine, 12", N.27°W., 56.75 feet
5. Steel Sign Post, North, 24.05 feet

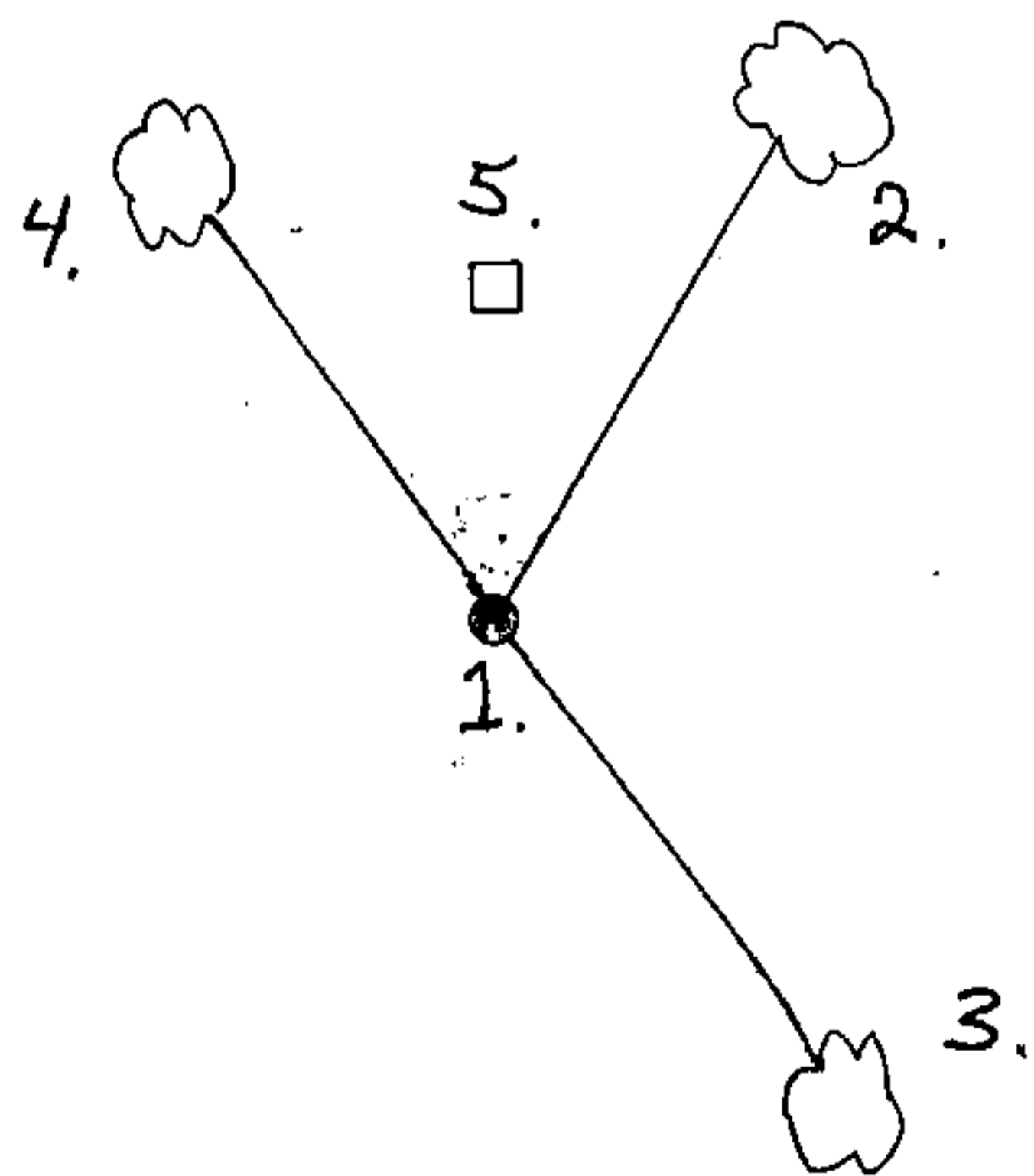

- (e) Describe any material discrepancy between the location of the corner as restored or reestablished and the location of that corner as previously restored or reestablished by distance and direction. Show the discrepancy on the plan view drawing under (d), above. Show the distances between the corner as previously restored or reestablished and (1) the corner as restored or reestablished, and (2) to at least 2 of the witness monuments shown on the drawing in (d), above.

Yes, corner by J. Resvick (1969), east, 104 feet.

- (f) Was the corner restored through acceptance of (1) an obliterated evidence location, or, (2) a found perpetuated location?

(1) an obliterated evidence location.

- (g&h) Was the corner reestablished through lost corner proportionate methods? If so, show the method, including the directions and distances to other public land survey corners used as evidence or used for proportioning in determining the corner location?

Yes.

- (i) I, Alan D. Harrison
(Type or print name) certify that the corner location shown on this record was determined by me or under my direction and control and that this U.S. Public Land Survey Monument Record is correct and complete to the best of my knowledge and belief.

Alan D. Harrison 3/28/88
Signature Date

Certificate ready for filing: Dale S. Stage
District Ranger

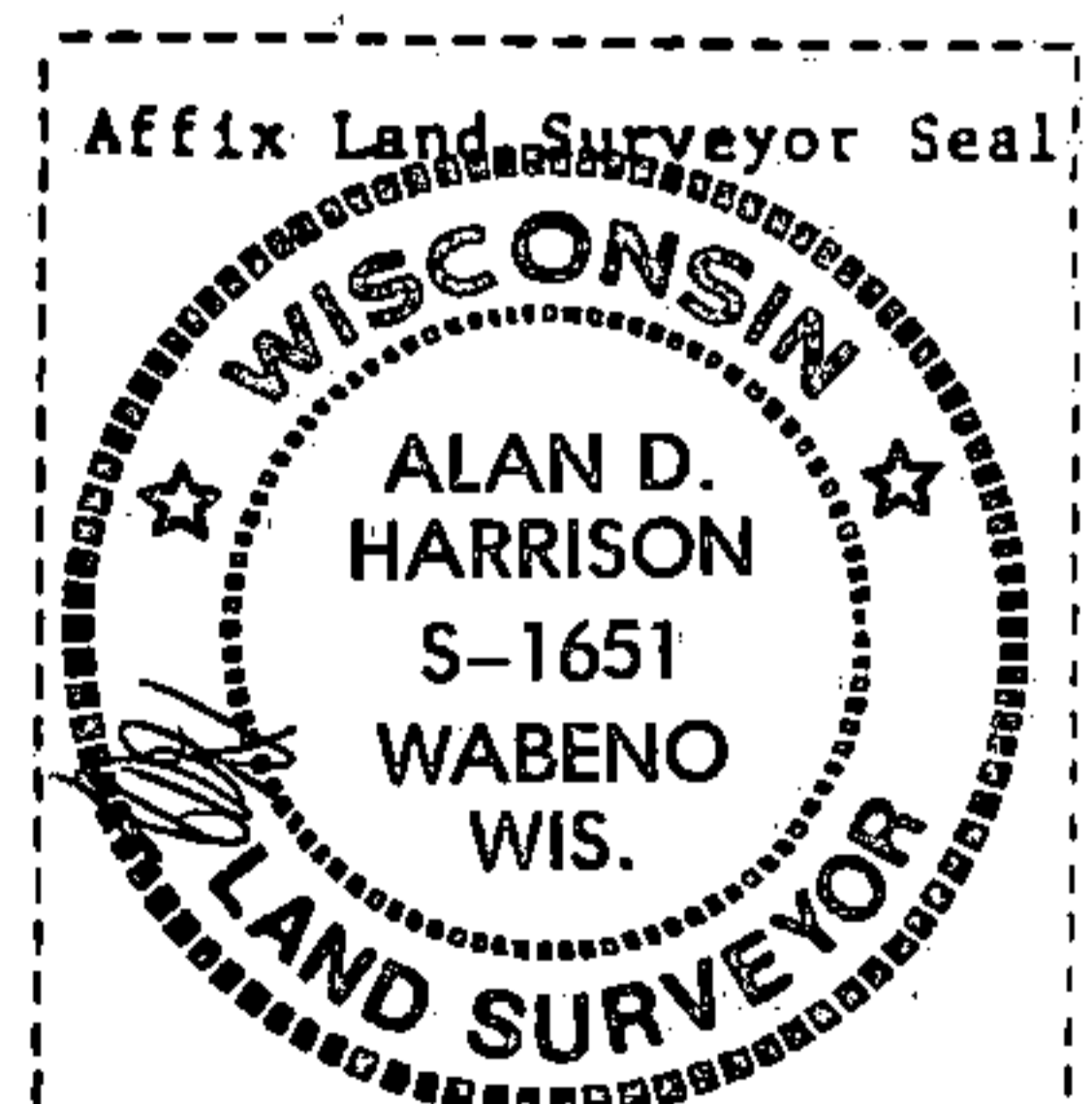

U. S. PUBLIC LAND SURVEY MONUMENT RECORD

INSTRUCTIONS:

This record shall show the location of the corner and shall include all of the following nine elements (a through i).

- (a) Identify the corner by reference to the U.S. public land survey system.
 O = Corner monument restored.

Quarter Corner Common to Sections 11 and 14,
 T.35N., R.15E., Forest County, Wisconsin.

State Plane Coordinates
 Wisconsin North Zone
 N - 132589.69166
 E - 2331753.61265

Geographic Coordinates
 N - 45 - 31 - 17.01140
 W - 088 - 34 - 58.02477

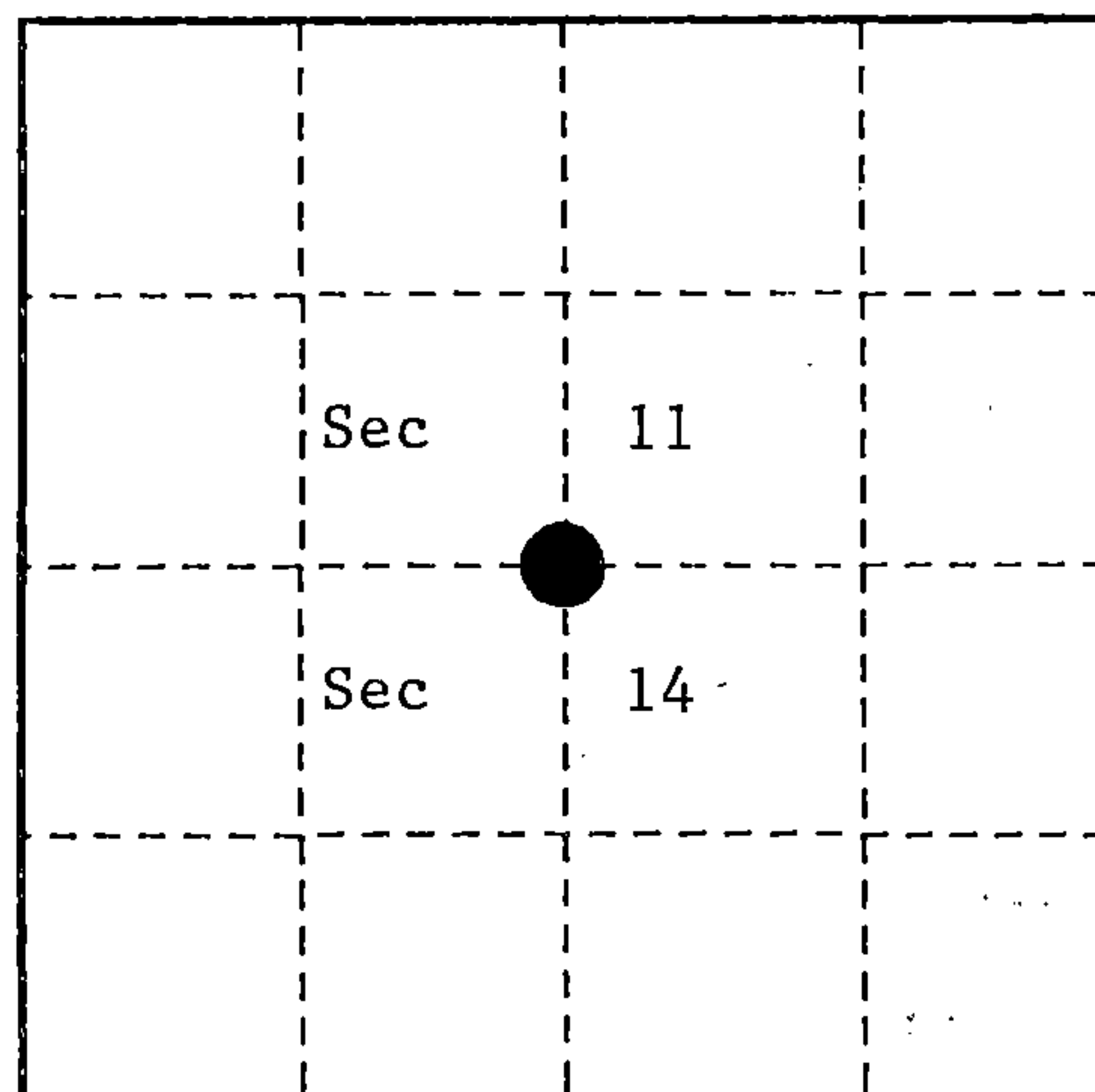

- (b) Describe any record evidence, monument evidence, occupational evidence, testimonial evidence or any other material evidence you considered, and whether the monument was found or placed.

In 1859, James McBride set a wood post with the following B.T.'s; Birch, 12", S.42°E., 18 links, Birch, 14", N.57°E., 14 links.

In 1904, N. Smith found original corner and witnesses to be okay.

In 1908, J. Melendy found 4" X 4" Ironwood post from resurvey with the following original B.T.'s; Birch, 14", S.24½°E., 18 links, Birch, 18", N.57°E., 13½ links. He then set a 5" X 5" Elm post in place of previous post.

In 1936, John Hammes found a Cedar stake in good condition on North side of road. He did not believe stake to be original due to lack of any original evidence.

In 1969, J. Resvick found Cedar post in mound of rock on South side of road. Set corner North, 33 feet from post found in road.

In 1987, Alan Harrison, RLS, restored position by retracement of J. Melendy's survey from Center ¼ through the CN 1/16. Corner position agrees with N. Smith's 1904 survey and J. Melendy's 1908 survey.

In 1994, Alan Harrison, RLS, found bearing trees as set in 1987. Northeast Jack Pine B.T. is dead. Road has been re-surfaced therefore railroad spike is below top surface. Set P.K. nail over railroad spike. Made a new bearing tree; White Spruce, 15", N.42°E., 64.30 feet.

- (c) In the plan view drawing below, provide reference ties to at least 4 witness monuments, or, if the location is within a municipality, to at least 2 witness monuments. (witness monuments shall be made of concrete, natural stone, iron or other equally durable material.)

- (d) Show a plan view drawing depicting the relevant monuments and reference ties which is sufficient in detail to enable accurate relocation of the corner monument if the corner monument is disturbed. Indicate north.

1. P.K. nail over railroad spike.
2. White Spruce, 15", N.42°E., 64.30 feet.
3. Sugar, 6", S.32°E., 70.30 feet.
4. Jack Pine, 12", N.27°W., 56.75 feet.
5. Steel Sign Post, North, 24.05 feet.
6. C/L F.R. # 2136, North, 4.00 feet.

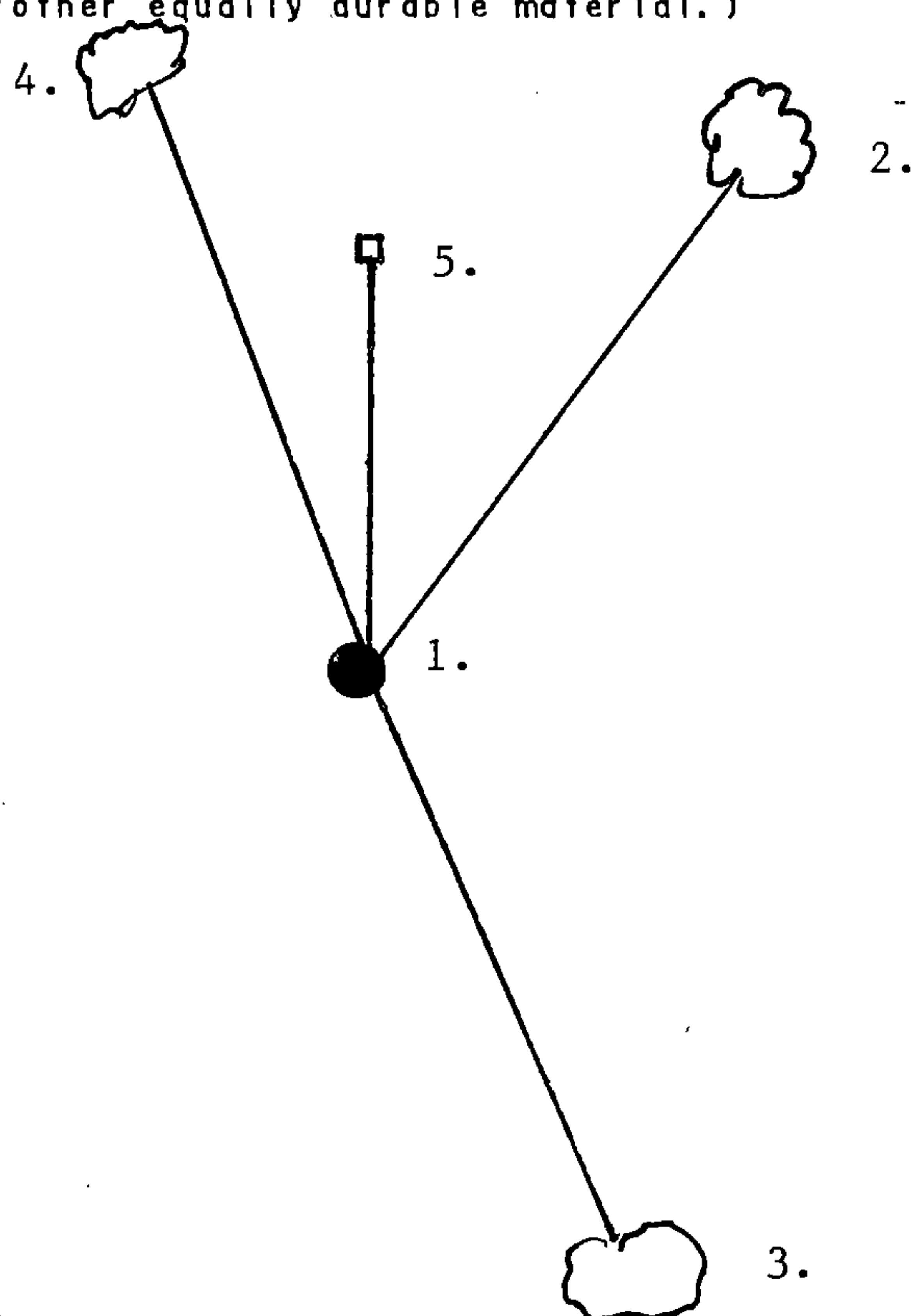

(e) Describe any material discrepancy between the location of the corner as restored or reestablished and the location of that corner as previously restored or reestablished by distance and direction. Show the discrepancy on the plan view drawing under (d), above. Show the distances between the corner as previously restored or reestablished and (1) the corner as restored or reestablished, and (2) to at least 2 of the witness monuments shown on the drawing in (d), above.

None

(f) Was the corner restored through acceptance of (1) an obliterated evidence location, or, (2) a found perpetuated location ?

(2)

(g & h) Was the corner reestablished through lost corner proportionate methods? If so, show the method, including the directions and distances to other public land survey corners used as evidence or used for proportioning in determining the corner location?

No

REGISTER'S OFFICE {
Forest County, Wis. {

Received for record this 10th day
of May A.D., 1995 at
8:30 o'clock A.M. and recorded
in Vol. Case Restoration
page 35-15, 1-19

Shirley Chittenden Deputy
Register of Deeds

(1) I, Alan D. Harrison

(type or print name) certify that the corner location shown on this record was determined by me or under my direction and control and that this U.S. Public Land Survey Monument Record is correct and complete to the best of my knowledge and belief.

Signature

Date

CERTIFICATE READY FOR FILING:

District Ranger

