

CERTIFIED LAND CORNER RESTORATION

State of Wisconsin

County of Forest

ss.

I Jean F. Resvick, do hereby certify that on the 30th day of July, 1969, I found evidence of the Northeast Section corner of Section 14 Township 35 North, Range 15 East, Fourth Principal Meridian, as described hereon; and that from this evidence I established a new monument and accessories as described hereon to perpetuate the original location of this corner:

Description of original monument and accessories and subsequent restorations:

Surveyed in 1859 by James McBride. 80 chains North between sections 13 and 14. Set wood post. Hemlock 18, bears N17W, 25 lks. Birch 18, bears N24E, 25 lks. Hemlock 16, bears S10E, 28 lks. Linn 16, bears S51W, 38 lks. 3 chains south enter swamp. 9.50 chs East enter swamp. John Hammes records on U.S. Forest Service Form, that on May 4, 1936 he found a cedar stake at ground level in center of road and a cedar post 33 feet North.

Description of corner evidence found:

Scribed 5 x 5 cedar post with metal location reading 5/5/1936 with initials J.H. on south side road. A 1½ inch pipe along side of post.

Scribed 4 x 4 cedar post with iron pipe along side of post on north side road. Post is scribed 2 rods S.

The road is in a cut and no evidence of stake in road was found. The distance between the two post found measured 1 chain.

Description of monument and accessories I established to perpetuate the original location of this corner:

At the Mid point between witness post found I set 2 inch inside diam., galvanized iron pipe 30 inches long, 6 inches below the surface of the road. From which the following blazed and scribed new bearing trees bear.

Yellow Birch 7, bears S38W, 77.36 ft.

Basswood 11, bears N35W, 83.12 ft.

At 50 feet North of section corner and 50 South of section corner, I set reference marks for section corner. Reference marks are 2 inches inside diam., galvanized wrought iron pipe 5 feet long, filled with concrete, flanged on bottom with brass tablets stamped to identify corner.

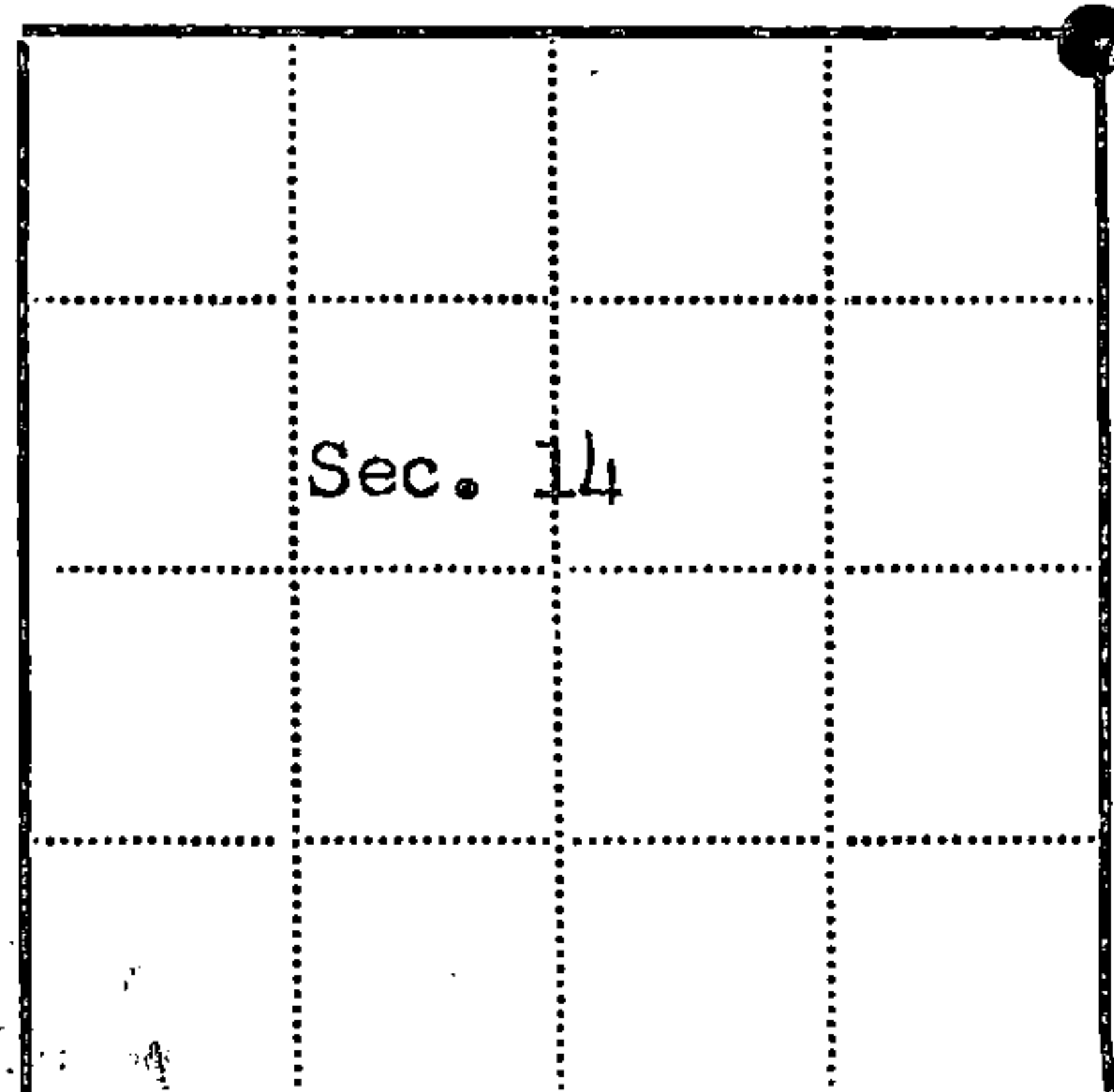

● = Corner monument restored

□ =

Resident witnesses

Dated at Rhineland
1969.

Signature Jean F. Resvick Title Cadastral surveyor
(County Surveyor, Registered Land Surveyor, or other duly authorized person)

Surveyors Registration No. S-802
DOCUMENT NUMBER 98037

Office of Register of Deeds County of Forest

I hereby certify that the within instrument was filed in this RECORD on the 22nd day of May, 1970, and was filed in Book WIS. No. J-21 Page No. J-21 of County Forest Records.

Signature Eugene Stutz Title Register of Deeds

Township 35 North, Range 15 East, Section 14, Index No. J-21, Page No. 21

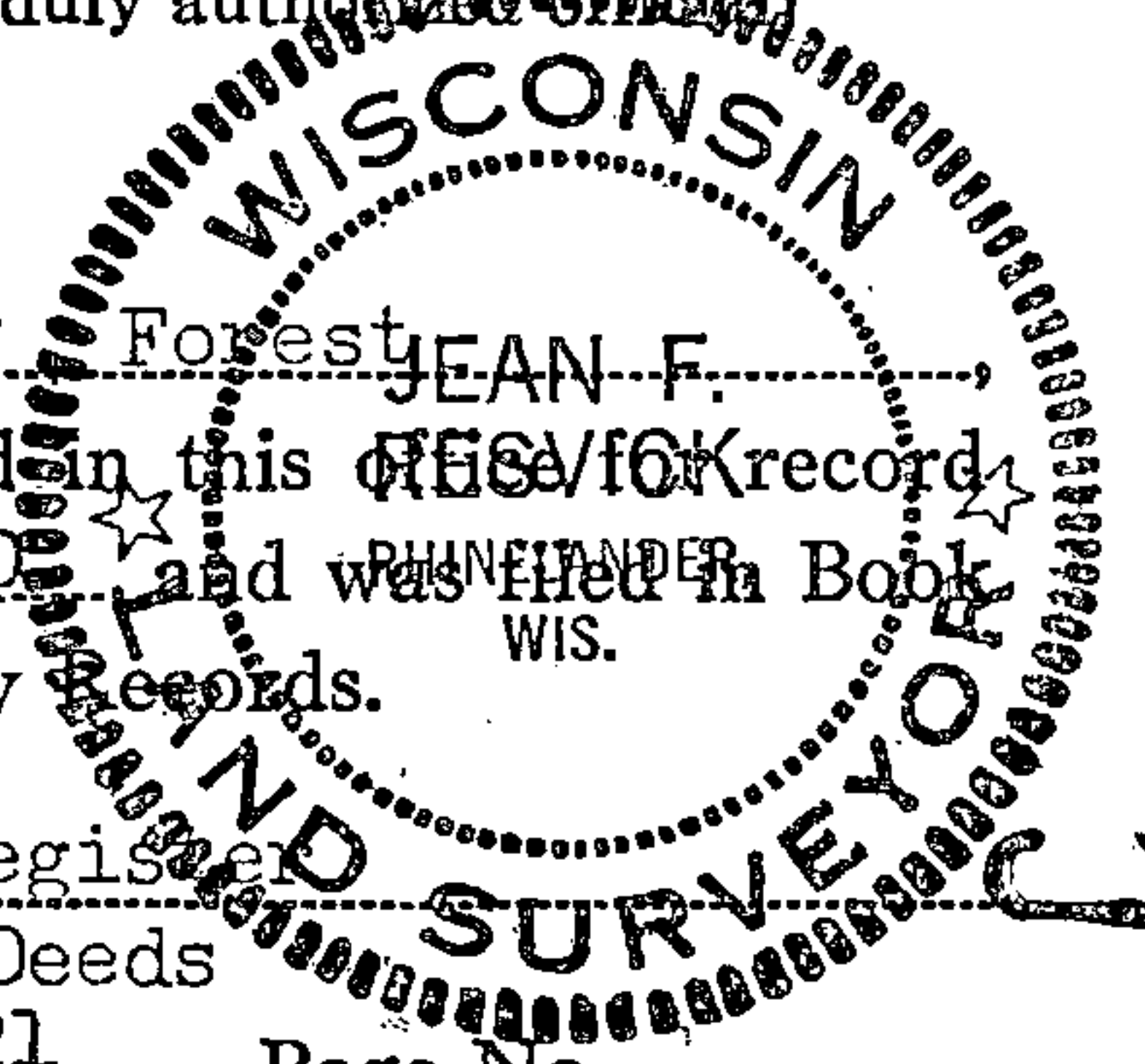
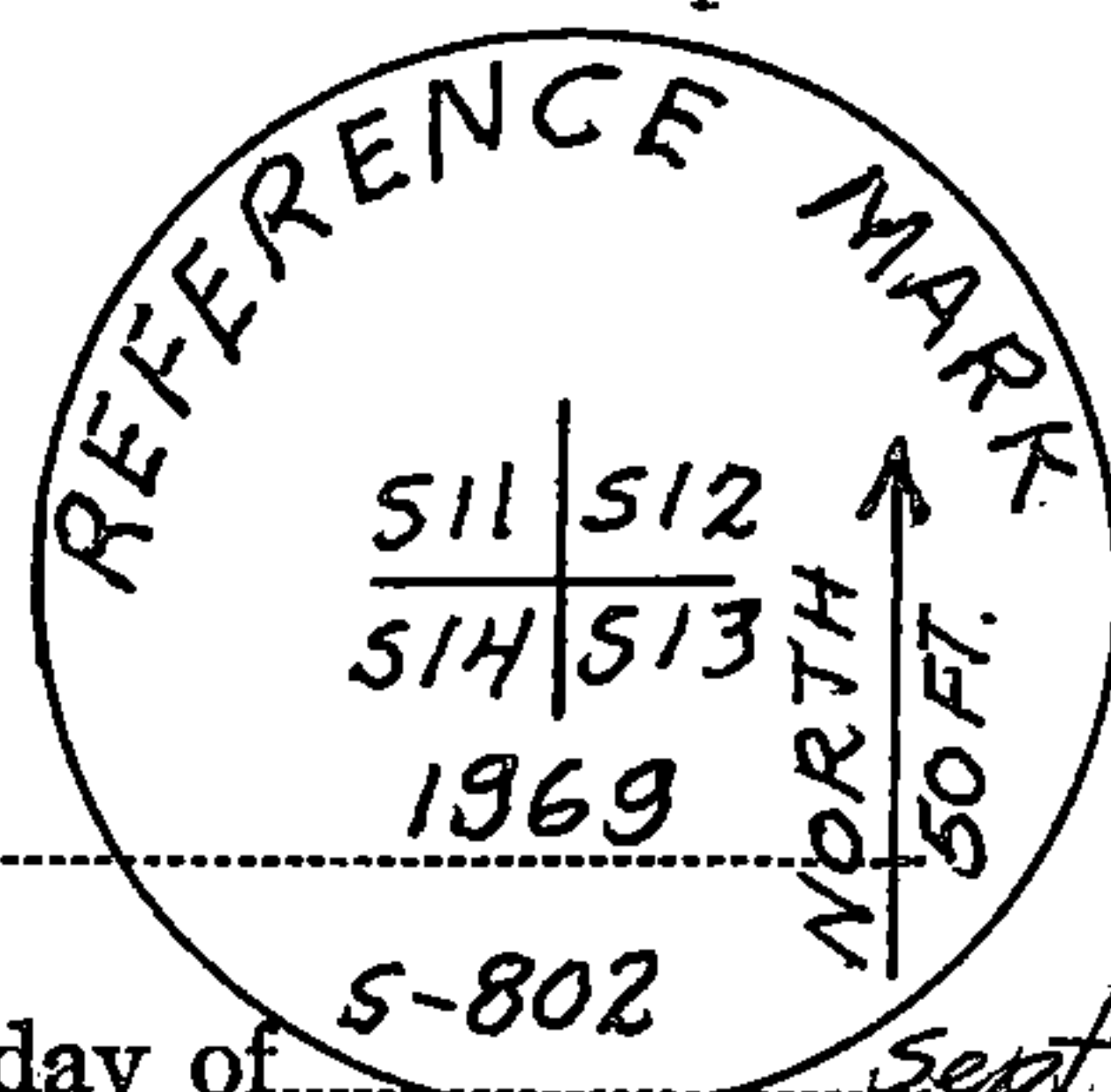
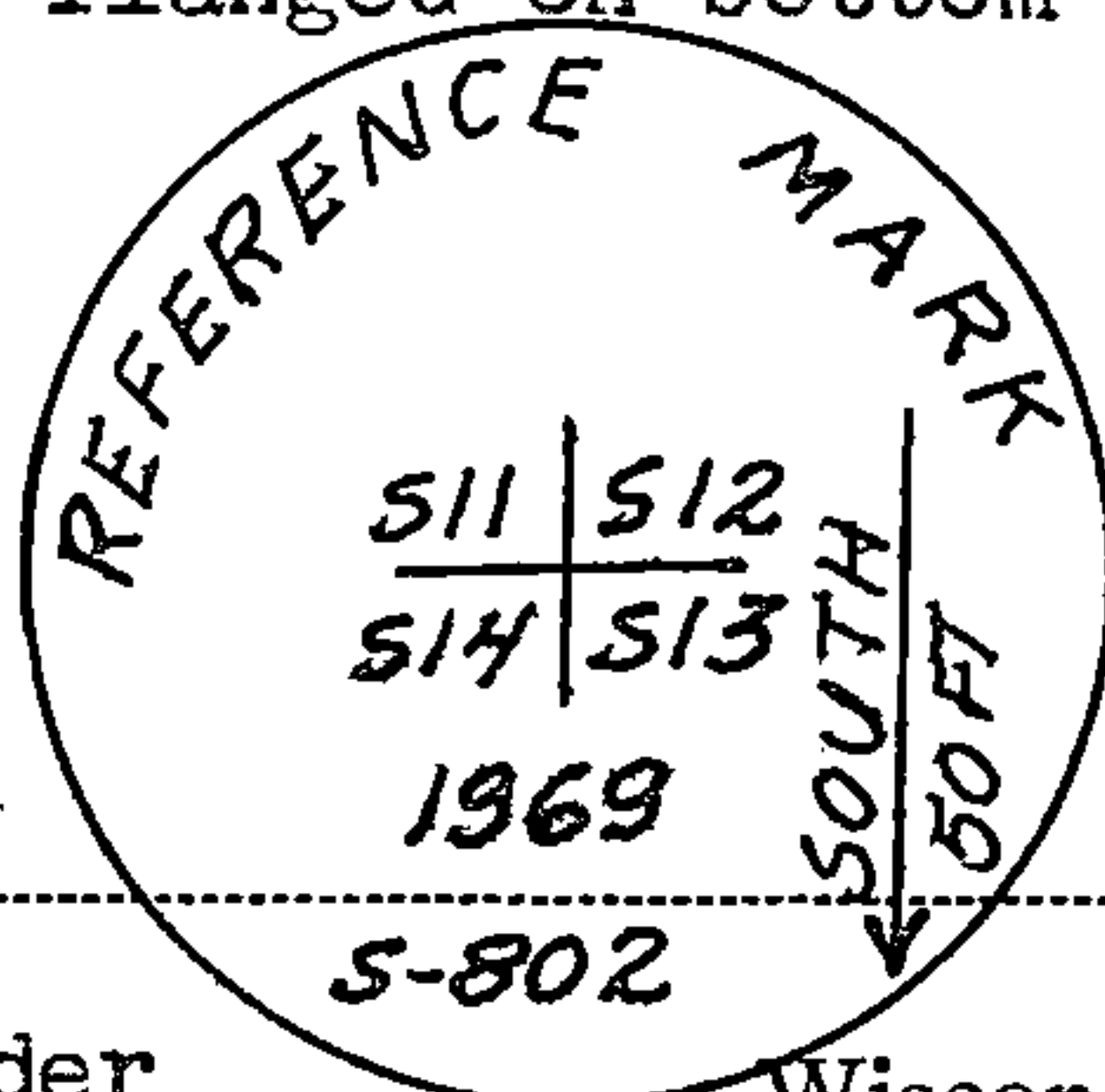

43515110000

U. S. PUBLIC LAND SURVEY MONUMENT RECORD

INSTRUCTIONS:

This record shall show the location of the corner and shall include all of the following nine elements (a through i).

- (a) Identify the corner by reference to the U.S. public land survey system.
 ○ = Corner monument restored.

Section Corner to Sections 11, 12, 13 and 14,
 T.35N., R.15E., Forest County, Wisconsin.

State Plane Coordinates
 Wisconsin North Zone
 N - 132550.68050
 E - 2334499.80447

Geographic Coordinates
 N - 45 - 31 - 16.14074
 W - 088 - 34 - 19.47204

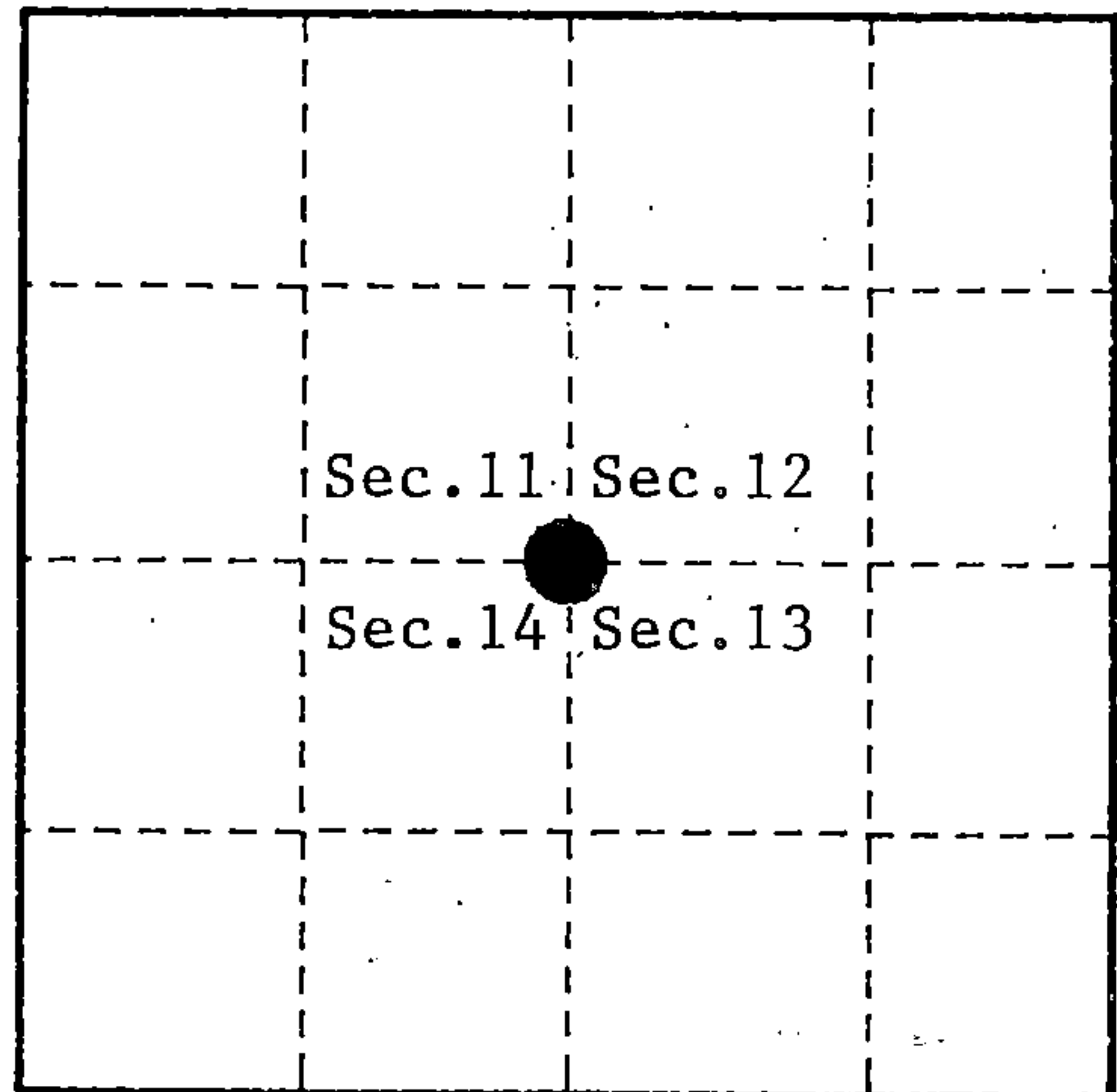

- (b) Describe any record evidence, monument evidence, occupational evidence, testimonial evidence or any other material evidence you considered, and whether the monument was found or placed.

In 1859 James McBride set wood post and the following B.T.'s; Hemlock, 18", N.17°W., 25 links, Birch, 18", N.24°E., 25 links, Hemlock, 16", S.10°E., 28 links, Linn, 16", S.51°W., 38 links South 3 chains enter swamp. East 9.50 chains, enter swamp.

In 1936, John Hammes found a cedar stake at ground level in center of road. Metal location poster on 3½" diameter cedar post, North, ½ chain.

In 1969, Jean Resvick, RLS, found a 5" X 5" cedar post with location tag on South side of road. Also found 4" X 4" cedar post North of road scribed "2 Rods South". Both posts are scribed with section numbers and have iron pipes alongside them. Resvick set a 2" X 30" galvanized iron pipe with brass cap stamped to identify corner. Blazed and scribed new B.T.'s; Yellow Birch, 7", S.38°W., 77.36 feet, Basswood, 11", N.35°W., 83.12 feet. Also set reference monuments North and South, 50.00 feet from corner.

In 1994, Alan Harrison, RLS, found monument below road surface. Set a railroad spike in new blacktop above monument. Found reference monuments and Yellow Birch B.T., Basswood B.T. is dead and down. Blazed and scribe a new B.T. and replaced damaged reference monument to the South.

- (c) In the plan view drawing below, provide reference ties to at least 4 witness monuments, or, if the location is within a municipality, to at least 2 witness monuments. (Witness monuments shall be made of concrete, natural stone, iron or other equally durable material.)

- (d) Show a plan view drawing depicting the relevant monuments and reference ties which is sufficient in detail to enable accurate relocation of the corner monument if the corner monument is disturbed. Indicate north.

1. Railroad Spike in blacktop above 2" X 30" monument.
2. 2" X 60" Reference Monument North, 50.00 feet.
3. Sugar, 8", S.13°E., 44.95 feet.
4. 2½" X 36" Reference Monument South, 50.00 feet.
5. Yellow Birch, 7", S.38°W., 77.36 feet.
6. C/L F.R. # 2136, North, 4.40 feet.
7. Steel Sign Post, North, 2.00 feet, from North Reference Monument.
8. Steel Sign Post, South, 2.50 feet, from South Reference Monument.

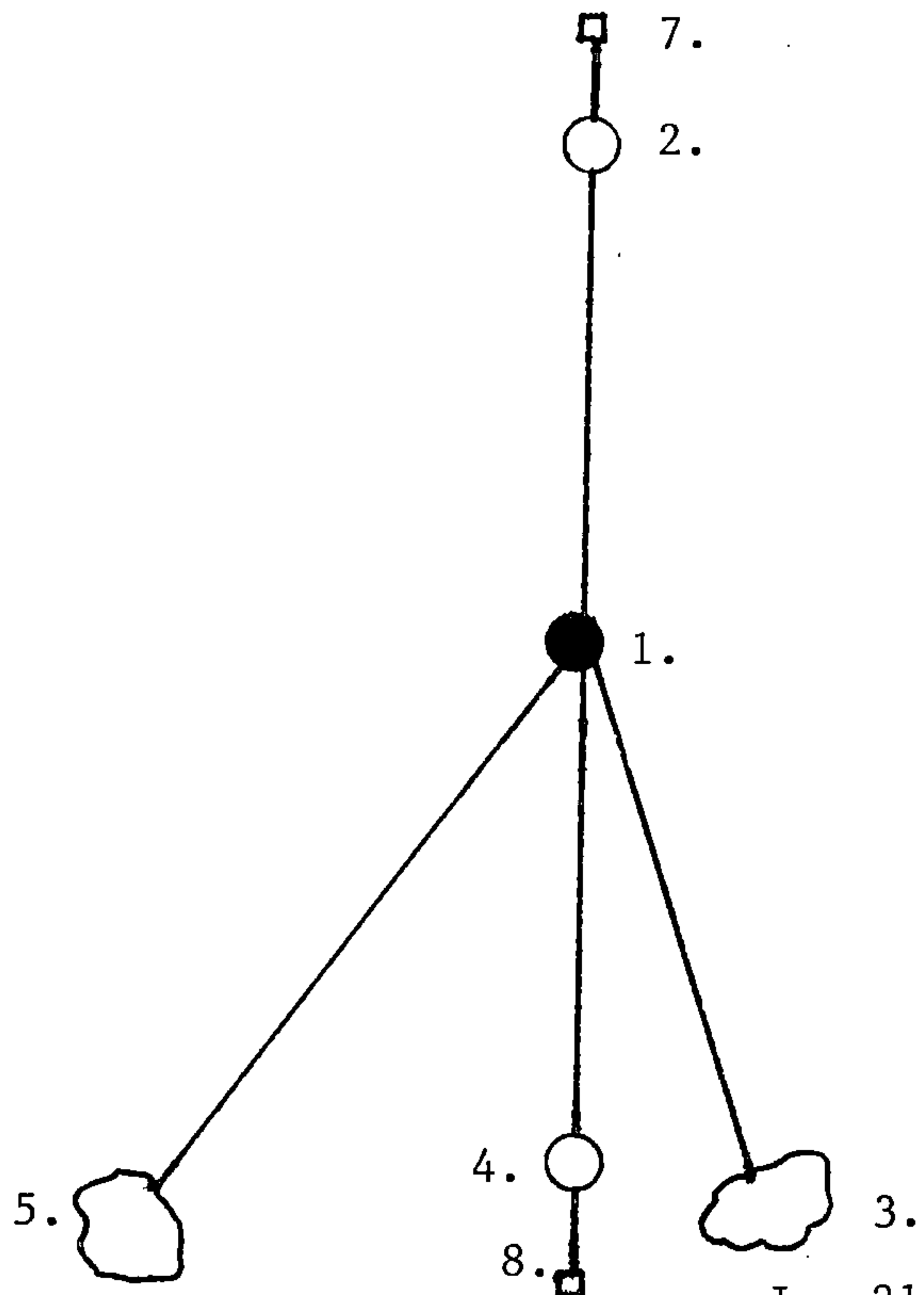

(e) Describe any material discrepancy between the location of the corner as restored or reestablished and the location of that corner as previously restored or reestablished by distance and direction. Show the discrepancy on the plan view drawing under (d), above. Show the distances between the corner as previously restored or reestablished and (1) the corner as restored or reestablished, and (2) to at least 2 of the witness monuments shown on the drawing in (d), above.

None

(f) Was the corner restored through acceptance of (1) an obliterated evidence location, or, (2) a found perpetuated location?

(2)

(g & h) Was the corner reestablished through lost corner proportionate methods? If so, show the method, including the directions and distances to other public land survey corners used as evidence or used for proportioning in determining the corner location?

No

REGISTER'S OFFICE
Forest County, Wis.

Received for record this 10th day
of May A.D., 1995 at
8:30 o'clock A.M. and recorded
in Vol. Land Restorations
page 35-15-1-21

Paul Chitt Deputy
Register of Deeds

(1) I, Alan D. Harrison

(type or print name) certify that the corner location shown on this record was determined by me or under my direction and control and that this U.S. Public Land Survey Monument Record is correct and complete to the best of my knowledge and belief.

Alan D. Harrison

Signature

4/25/95

Date

CERTIFICATE READY FOR FILING:

Tracy Shaker
District Ranger

