

## U. S. PUBLIC LAND SURVEY MONUMENT RECORD.

## INSTRUCTIONS:

This record shall show the location of the corner and shall include all of the following nine elements (a through i).

- (a) Identify the corner by reference to the U.S. public land survey system.

● - Corner monument restored.

Section Corner to Sections 24, 25, 19 and 30, T35N, R14-15E, 4th P.M.

REGISTER'S OFFICE  
Forest County, Wis.

Received for record this 16<sup>th</sup> day  
of Sept, A.D., 1989 at

10:25 o'clock A.M. and recorded

in Vol. 1 **CORNER RESTORATIONS**

page 1  
Paul A. Schenck  
Register of Deeds

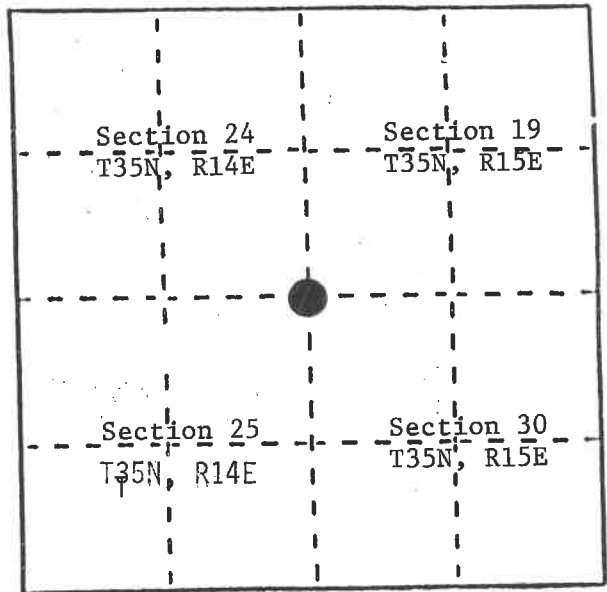

- (b) Describe any record evidence, monument evidence, occupational evidence, testimonial evidence or any other material evidence you considered, and whether the monument was found or placed.

In 1857 Artemas Curtis established this corner. All evidence being destroyed by construction and reconstruction of State Highway #32 over the years.

In 1965 Forest Service surveyor Jean Resvick perpetuated this corner and placed a brass capped 2" x 60" iron pipe, N47°12'E, 70.00' from the corner.

On 7/10/85 the DOT filed with the County Clerk a "Preservation of Landmark" from whereby four additional Witness Corners were set.

On 6/28/89 I placed a railroad spike in the surface of the blacktop road for the Section Corner. We also placed a steel sign post northwest of DOT, W.C. #3, .68 feet.

- (c) In the plan view drawing below, provide reference ties to at least 4 witness monuments, or, if the location is within a municipality, to at least 2 witness monuments. (Witness monuments shall be made of concrete, natural stone, iron or other equally durable material.) Describe witness monuments.

- (d) Show a plan view drawing depicting the relevant monuments and reference ties which is sufficient in detail to enable accurate relocation of the corner monument if the corner monument is disturbed. Indicate north.

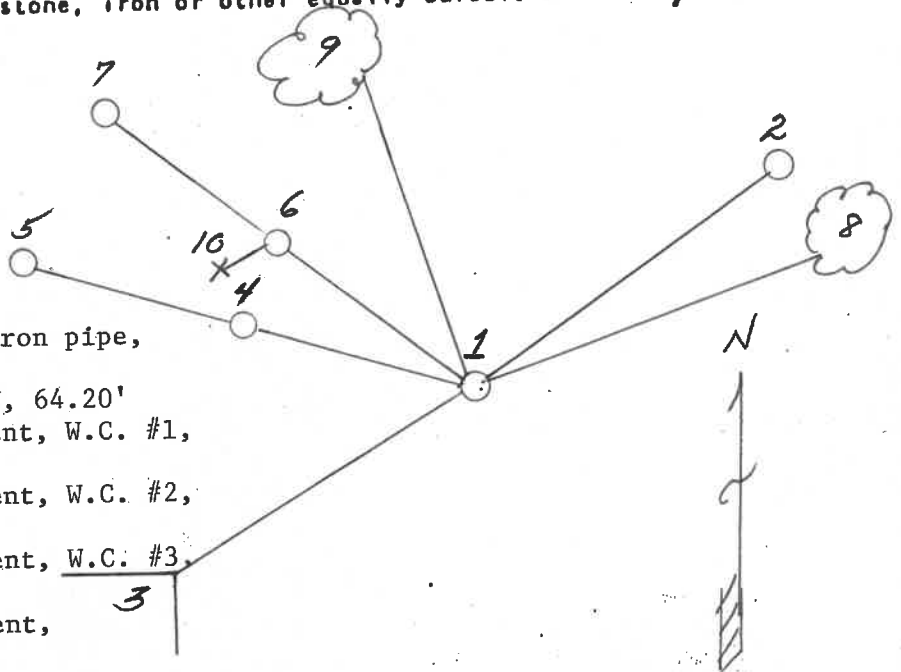

- 1) Railroad spike
- 2) Brass tablet on a 2" x 60" iron pipe, N47°-12'E, 70.00'
- 3) NE corner of building, S63°W, 64.20'
- 4) DOT Berntsen aluminum monument, W.C. #1, NW, 41.52'
- 5) DOT Berntsen aluminum monument, W.C. #2, NW, 66.91'
- 6) DOT Berntsen aluminum monument, W.C. #3, NW, 53.84'
- 7) DOT Berntsen aluminum monument, W.C. #4, NW, 75.17'
- 8) 18" Basswood, N63°E, 89.12'
- 9) 10" Basswood, N34°W, 73.80'
- 10) Steel sign post, NW of DOT W.C. #3, .68'

43514240000

- (e) Describe any material discrepancy between the location of the corner as restored or reestablished and the location of that corner as previously restored or reestablished by distance and direction. Show the discrepancy on the plan view drawing under (d), above. Show the distances between the corner as previously restored or reestablished and (1) the corner as restored or reestablished, and (2) to at least 2 of the witness monuments shown on the drawing in (d), above.

None

- (f) Was the corner restored through acceptance of (1) an obliterated evidence location, or, (2) a found perpetuated location?

A perpetuated location

- (g&h) Was the corner reestablished through lost corner proportionate methods? If so, show the method, including the directions and distances to other public land survey corners used as evidence or used for proportioning in determining the corner location?

- (i) I, Milo E. Stefan  
(Type or print name) certify that the corner location shown on this record was determined by me or under my direction and control and that this U.S. Public Land Survey Monument Record is correct and complete to the best of my knowledge and belief.

Milo E. Stefan  
Signature

July 7, 1989  
Date

CERTIFICATE READY FOR FILING:

Dale B. Staeger  
District Ranger

