

CERTIFIED LAND CORNER RESTORATION

Index No. **Y-20**

State of Wisconsin }  
County of Forest } ss.

History of original corner establishment:  
No evidence of any previous corner.

I Glen Barker, do hereby certify that on the 31st day of March, 1983, I ~~found~~ ~~evidence of the~~ SE 1/16 corner of Section 35 Township 35 13 East, North, Range 13 East, Fourth Principal Meridian, as described hereon; and that from this evidence I established a new monument and accessories as described hereon to perpetuate the original location of this corner.

Resident witnesses:

J. Claflin - R. 13E  
H. Wagoner

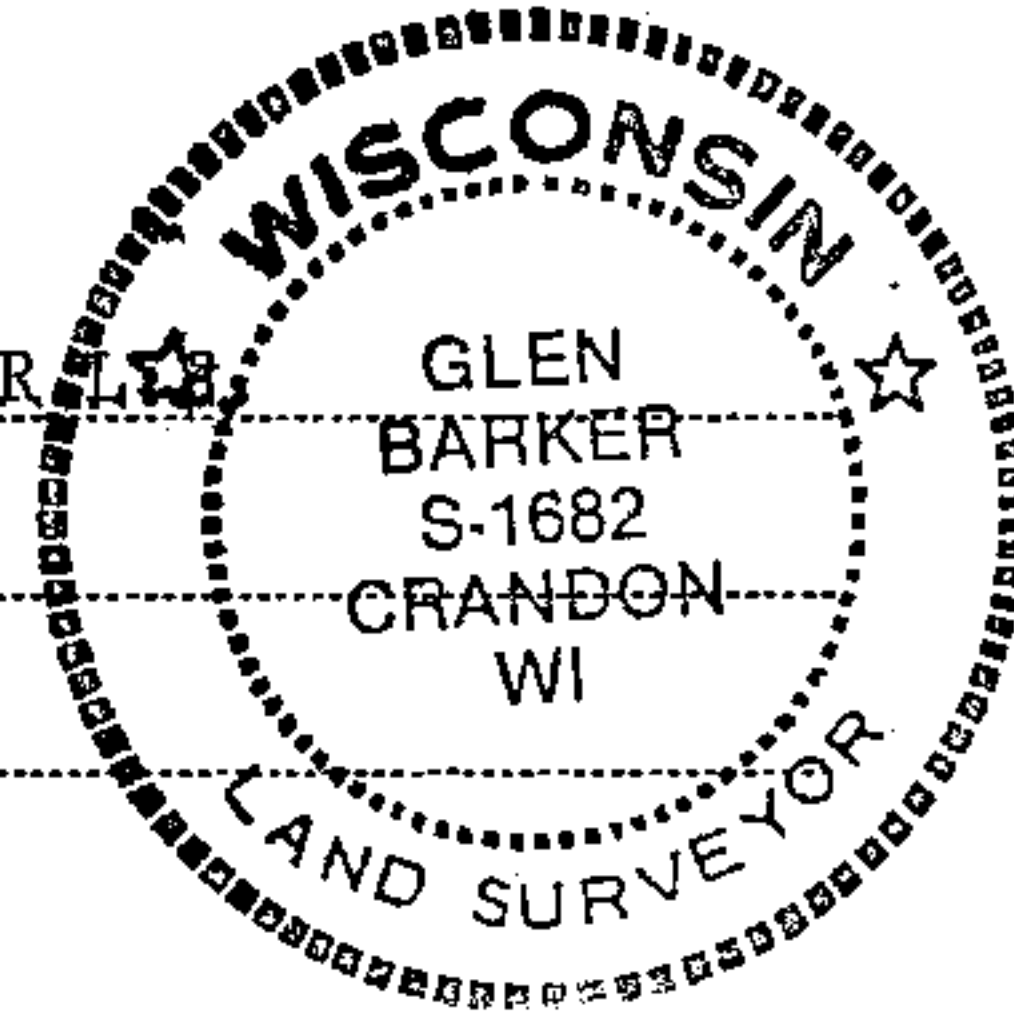

Description of corner evidence found:

Corner established by subdivision of SE 1/4.  
SE 1/16 sets 1314.54 ft. of SC 1/16 and 1316.13 ft. of EC 1/16.

Description of monument and accessories I established to perpetuate the original location of this corner.

Set a 1" iron pipe with 2" diameter alloy cap stamped:  
Monument projects 18" above ground.

Marked NBTs

Maple 5" N47E 20.85 ft.  
Maple 5" S75W 13.36 ft.  
Scribed 1/16 - B.T.

S1682

T35N R13E

S 35

SE 1/16

CPI - 1983

T35N R13E

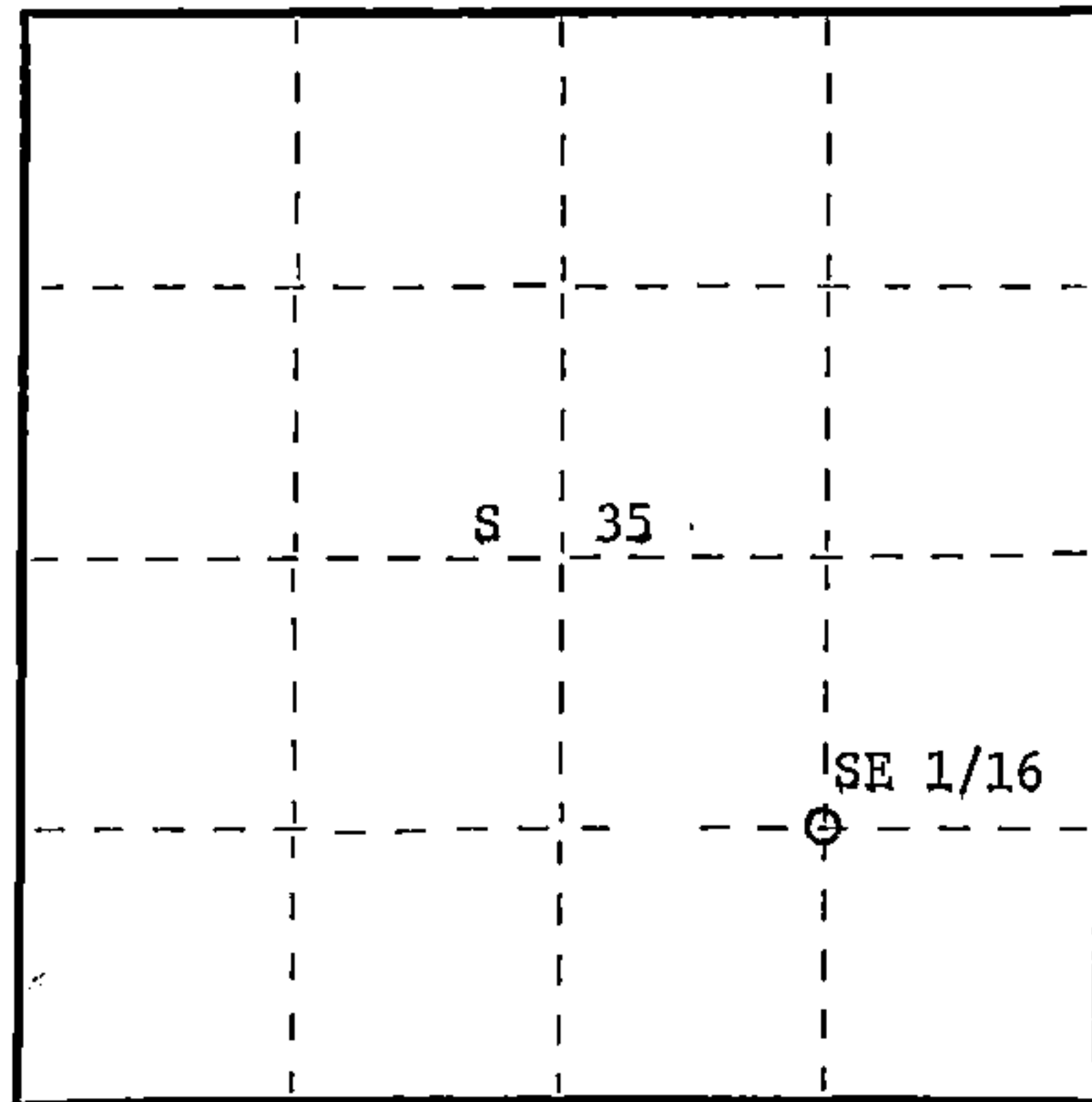

○ = Corner monument restored.

Dated at Rhineland, Wis., this 6th day of May, 1983.

Signature Glen Barker Title Registered Land Surveyor Registration No. S1682  
(County Surveyor, Registered Land Surveyor, or other duly authorized official)

Office of Register of Deeds, County of Forest, I hereby certify that the within instrument was filed in this office for record on the 19th day of May, 1983 at 3:00 o'clock P. M.

Eugene Stegemyer  
(Register of Deeds)

By..... Deputy

DOCUMENT NO.  
**123420**

43513351818

Stock No. 26272  
FORM 985