

State of Wisconsin
County of FOREST

} ss. ESTABLISHMENT OF QUARTER - QUARTER SECTION CORNER BETWEEN
ORIGINAL GOVERNMENT SURVEY CORNERS.

I NEAL SPERHAKE, do hereby certify that on the THIRTIETH day of SEPTEMBER,
19 64, I established the NORTH ONE SIXTEENTH CORNER BETWEEN SECTIONS 34 & 35, TOWNSHIP 35,
NORTH, RANGE 13 EAST, Fourth Principal Meridian,
as described hereon.

History: There is no record of this corner having ever been previously established.

Description of monument and accessories I established to perpetuate the location of this corner:

At the point determined for the location of the corner I emplaced a:

GALVANIZED IRON PIPE, THREE FEET LONG, ONE INCH IN DIAMETER, WITH ALUMINUM CAP DENOTED AS,
"KIMBERLY CLARK CORP. T35N N 1/16 BTWN. 34 & 35 R13E SPERHAKE RLS 463 9/30/64."

The pipe is witnessed by:

B. Cherry 5 N 73°W 10 (SCRIBED S34 BT).
Maple 6 S 50°E 31 (SCRIBED S35 BT).

Description as to how corner was located: Since both the quarter section corner $\frac{1}{4}$ mile south
and the section corner $\frac{1}{4}$ mile north have been previously established
with a distance between them of 40.23 $\frac{1}{2}$ chains, the N 1/16th. corner
was set 20.11 $\frac{3}{4}$ chains from either corner and on a straight line
between them.

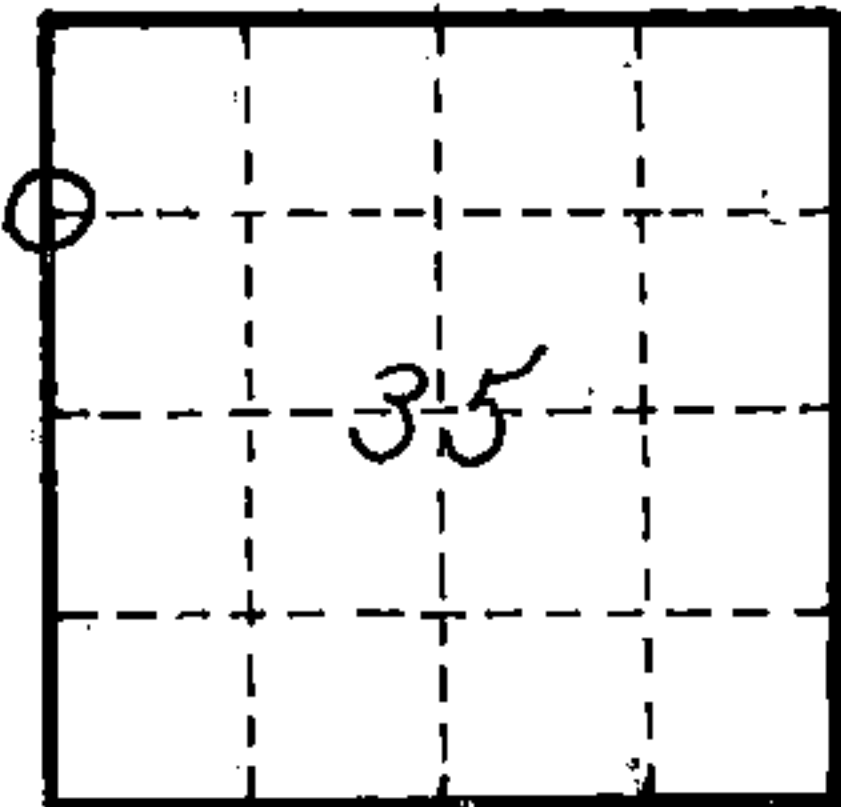

0 = Corner monument
restored

89617

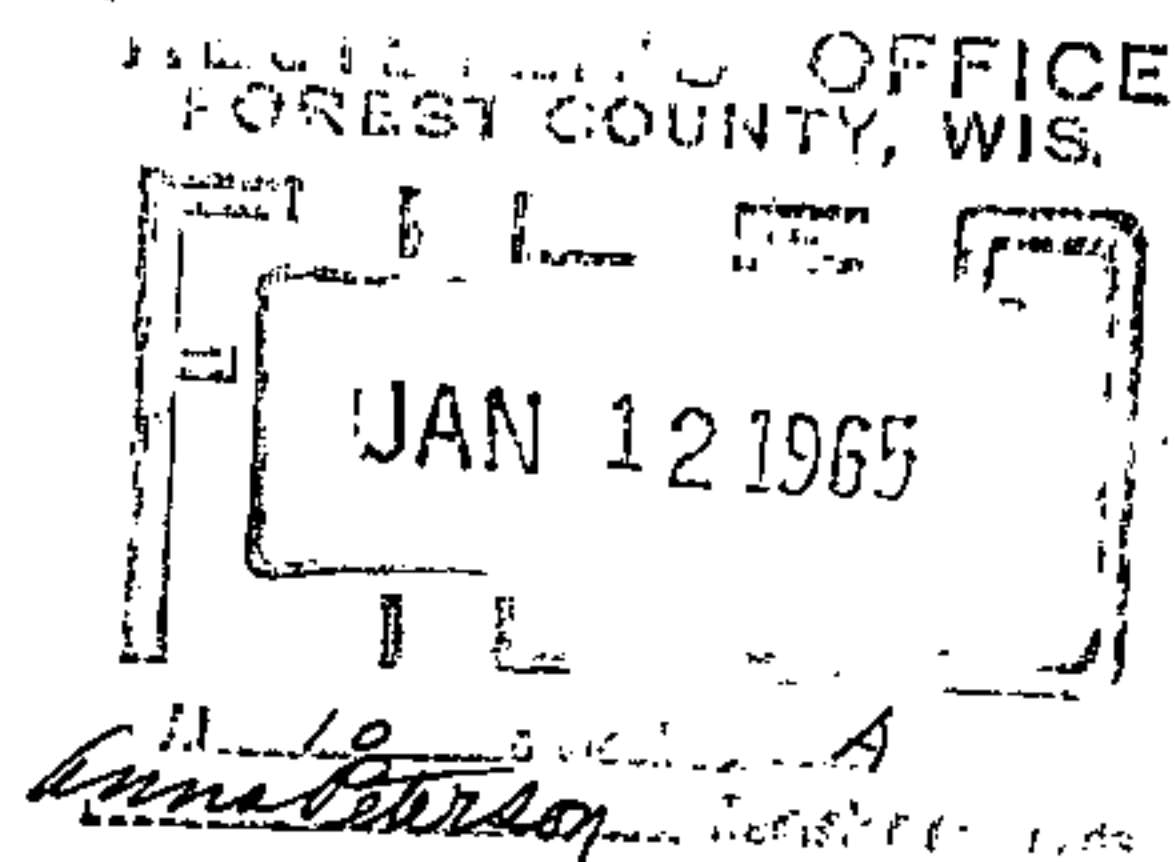

Resident witnesses _____

Dated at Crandon, Wisconsin, this 12th
day of January, 1965.

Signature Neal Sperhake

Title Registered Land Surveyor Registration No. 463

Office of Forest County of Wisconsin

I hereby certify that the within instrument was ~~filed in the~~
~~office for record~~ on the 12th day of January
19 65, and was ~~filed in Book No.~~ signed and ~~Page No.~~ sworn to
~~of County Records.~~ before me.

Surveyor's Seal

Signature Anna Peterson Title Notary Public

43513343000

Index No. 117

CERTIFIED LAND CORNER RESTORATION

Index No. **W17**

State of Wisconsin }
County of Forest } ss.

I Glen Barker, do hereby
certify that on the 29th day
of March, 1983, I found
evidence of the N 1/16
corner of Sections 34 & 35
Township 35, North, Range
13 East, Fourth Principal Meridian,
as described hereon; and that from this evidence
I established a new monument and accessories
as described hereon to perpetuate the original
location of this corner.

Resident witnesses:

J. Claflin -
H. Wagoner

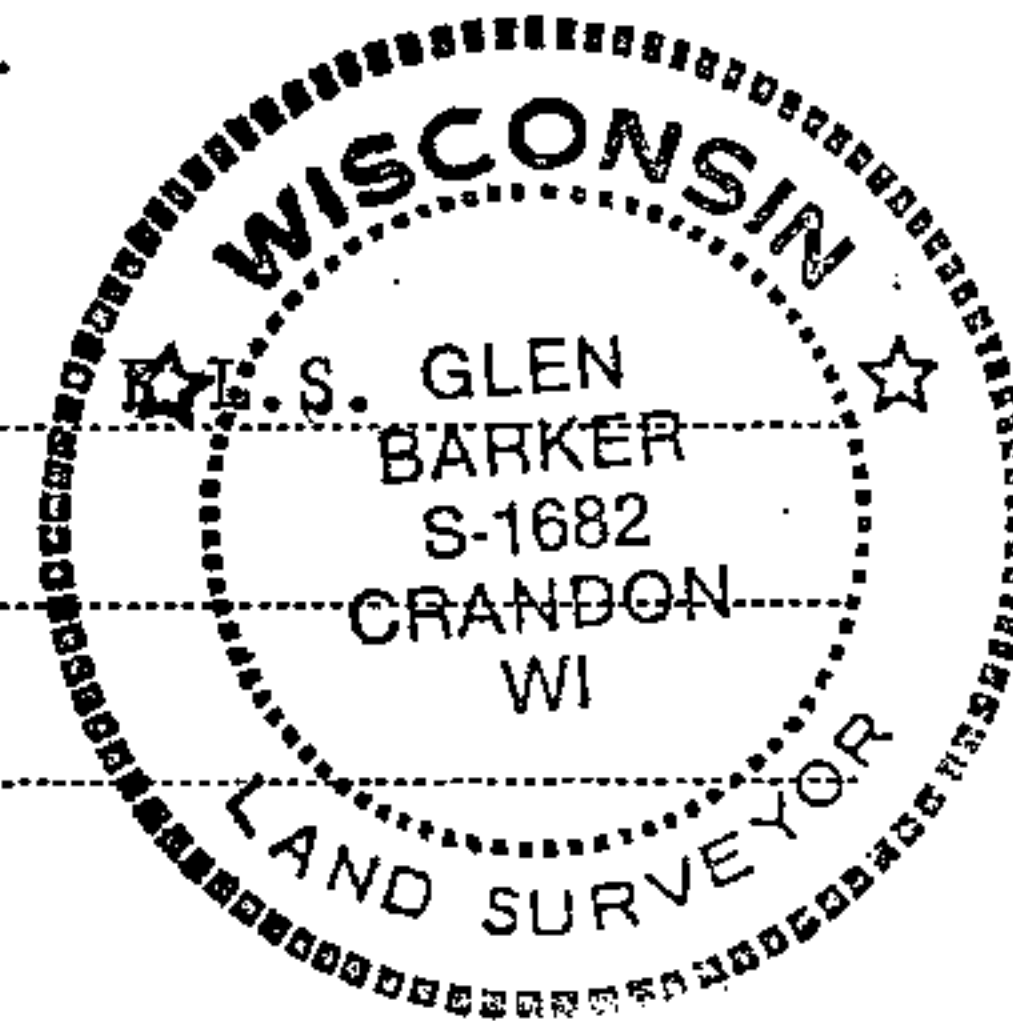

T35N R13E

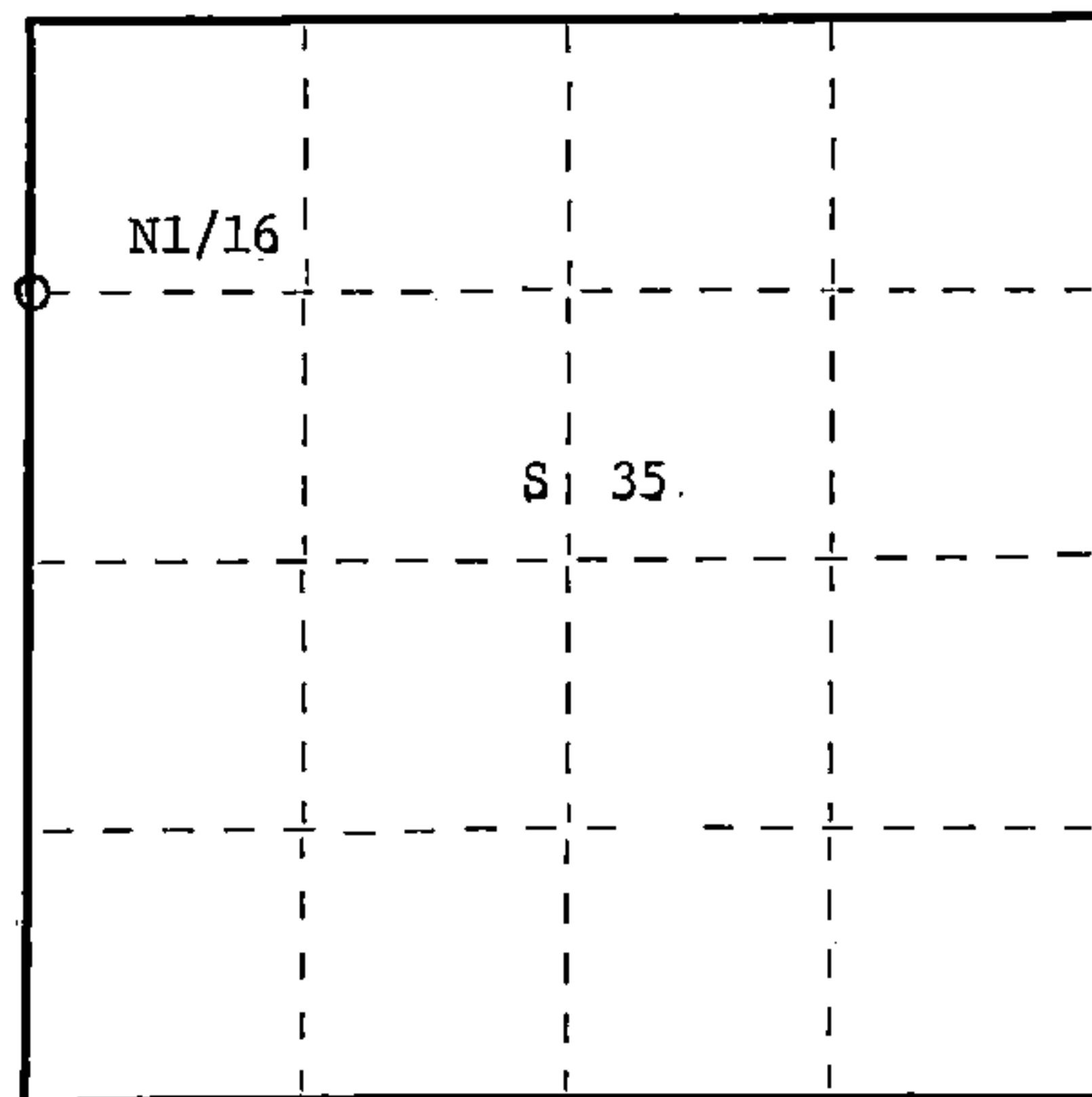

○ = Corner monument restored.

History of original corner establishment:

Corner previously established by Neal Sperhake, Registered Land Surveyor in 1964.

Description of corner evidence found:

Total distance from section corner 26-27-34-35 to 1/4 corner between section 34 & 35 is 2652.15 ft.

Set N 1/16 1326.075 ft. intermediate.

Recovered Sperhake's 1" iron pipe with 4" diameter alloy cap 3.05 ft. of our position.

Description of monument and accessories I established to perpetuate the original location of this corner.

Set a 1" iron pipe with 2" diameter alloy cap stamped:

Monument projects 18" above ground

Marked NBTs

Black cherry 8" N71W 4.20 ft

Previously scribed S34 B.T.

Maple 5" N83E 30.55 ft.

Scribed 1/16 - B.T.

S1682
T35N R13E

N 1/16 34 35

CPI - 1983

Dated at Rhinelander, Wis., this 6th day of May, 1983

Signature *Glen Barker* Title Registered Land Surveyor Registration No. S1682
(County Surveyor, Registered Land Surveyor, or other duly authorized official)

Office of Register of Deeds, County of Forest, I hereby certify that the within instrument was filed in this office for record on the 19th day of May, 1983 at 3:00 o'clock P. M.

Eugene Stagny
(Register of Deeds)

By Deputy

DOCUMENT NO.
123414

Stock No. 26272

HC Miller Company
Manufacturing, Wisconsin

FORM 985

435 13 34 3000