

Stock No. 26272

H.C. Miller Company
Milwaukee, Wisconsin

FORM 985

State of Wisconsin } ss.
County of Forest

I, Glen Barker, do hereby
certify that on the 19th day
of November, 19 82, I ~~found~~
~~established~~ N 1/16
corner of Sections 27 & 28
Township 35, North, Range
13 East, Fourth Principal Meridian,
as described hereon; and that from this evidence
I established a new monument and accessories
as described hereon to perpetuate the original
location of this corner.

Resident witnesses:

J. Claflin, Reg. Land Surveyor

H. Wagoner

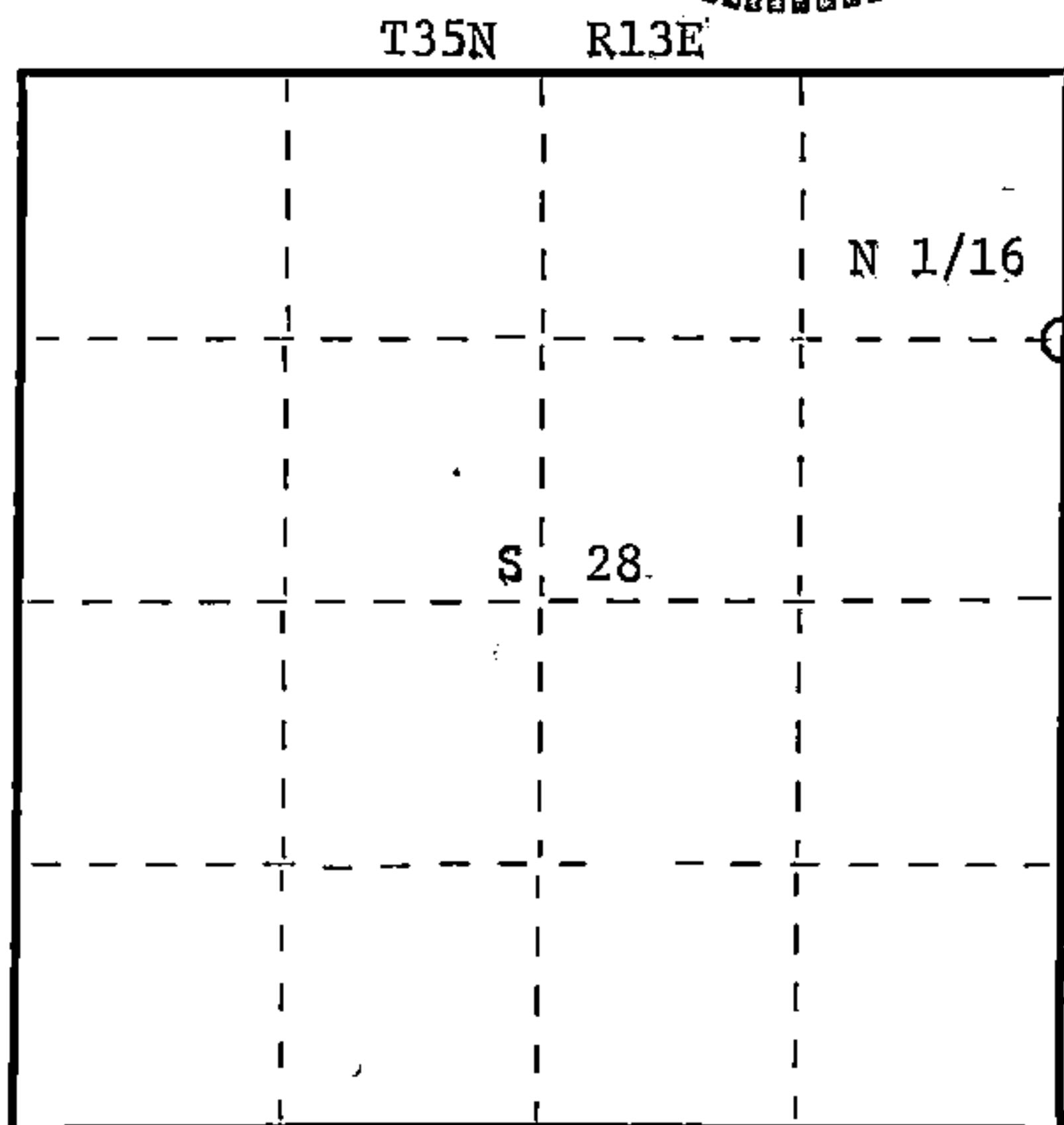
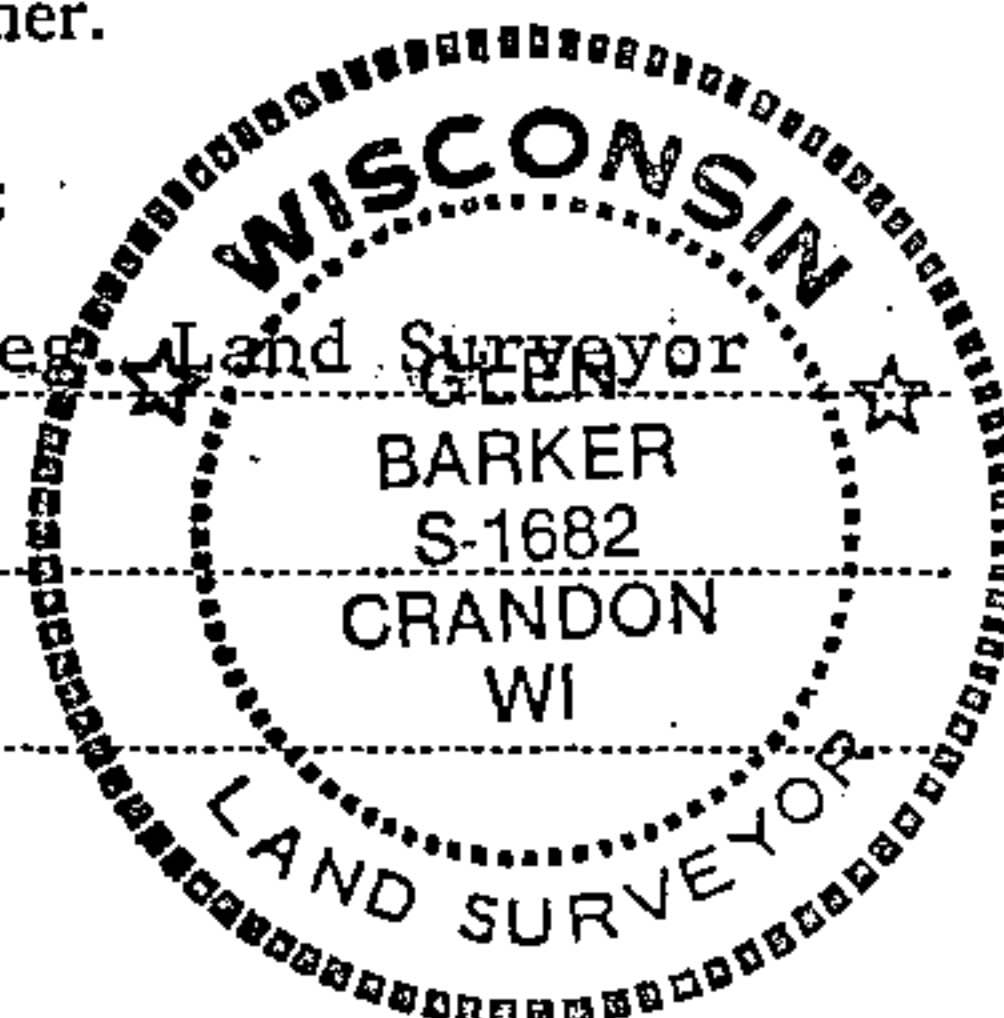

○ = Corner monument restored.

CERTIFIED LAND CORNER RESTORATION

Index No. S-13

813

History of original corner establishment:

Corner established by C. Walker in 1945.

Description of corner evidence found:

Total distance from section corner 21-22-27-28 to 1/4 corner between sections 27
and 28 is 2644.13 at bearing S 0-37-21 W.
Set N 1/16 1322.07 feet intermediate.
C. Walker's old 5" squared cedar post bears S 3° W 19.0 feet of our corner
position.

Description of monument and accessories I established to perpetuate the original location of this corner.

Set a 1" iron pipe with 2" diameter alloy cap - stamped:
Monument projects 18" above ground.

Marked NBT's:

Sugar 8" S34W 13.50 feet
Sugar 6" N11W 28.55 feet
scribed 1/16 - B.T.

S1682
T35N R13E
N 1/16 28 + 27
CPI-1982

435.13283099

Dated at Rhineland, Wis., this 21st day of March, 19 83

Signature Glen Barker Title Registered Land Surveyor Registration No. S-1682
(County Surveyor, Registered Land Surveyor, or other duly authorized official)

Office of Register of Deeds, County of Forest, I hereby certify that the within
instrument was filed in this office for record on the 7th day of April, 19 83
at 9:30 o'clock A. M.

Eugene Stutzman
(Register of Deeds)

DOCUMENT NO. **123148**

By _____ Deputy