

CERTIFIED LAND CORNER RESTORATION

Index No. Q-13

013

State of Wisconsin }
County of Forest } ss.

History of original corner establishment:
C. Walker set S 1/16 corner in 1940.

I Glen Barker, do hereby certify that on the 13th day of October, 1982, I found evidence of the S 1/16 corner of Sections 21 & 22 Township 35 North, Range 13 East, Fourth Principal Meridian, as described hereon; and that from this evidence I established a new monument and accessories as described hereon to perpetuate the original location of this corner.

Description of corner evidence found:

Total distance from section corner 21-22-27-28 to 1/4 corner between sections 21-22 is 2618.19 ft. at bearing N1-46-28E. Set S 1/16 1309.095 intermediate. Corner falls 1.20 ft. north of C. Walker's 5" squared cedar post.

Resident witnesses:

J. Claflin - R.L.
H. Wagoner

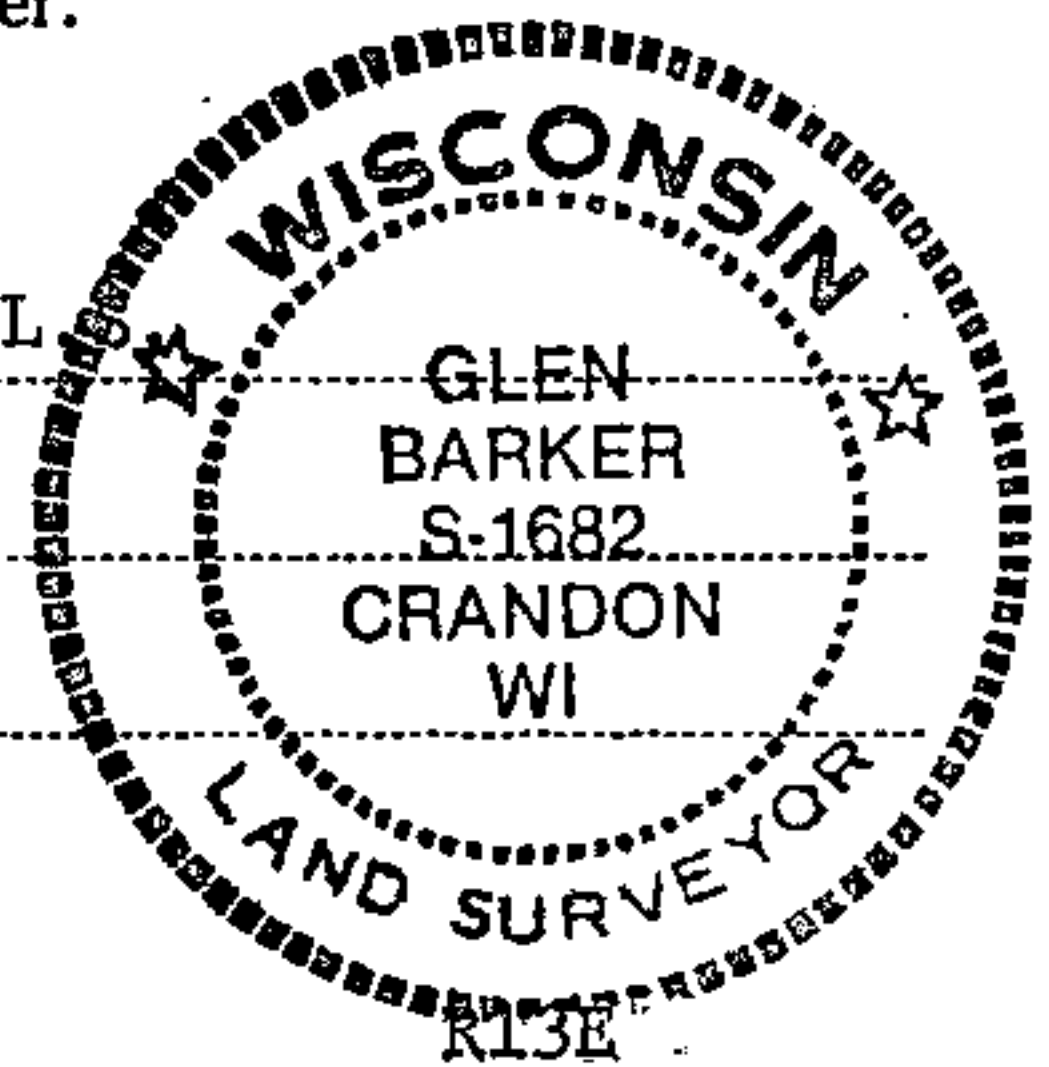

FORM 983 R. C. MILLER CO., MILWAUKEE

Description of monument and accessories I established to perpetuate the original location of this corner.

Set a 1" iron pipe with 2" diameter alloy cap stamped:
Monument projects 18" above ground.

S1682
T35N R13E
21 22
S 1/16
C.P.I. 1982

Marked NBTs:

Sugar 5" S55W 11.58 ft.
Elm 6" N30W 29.20 ft.
Scribed 1/16 B.T.

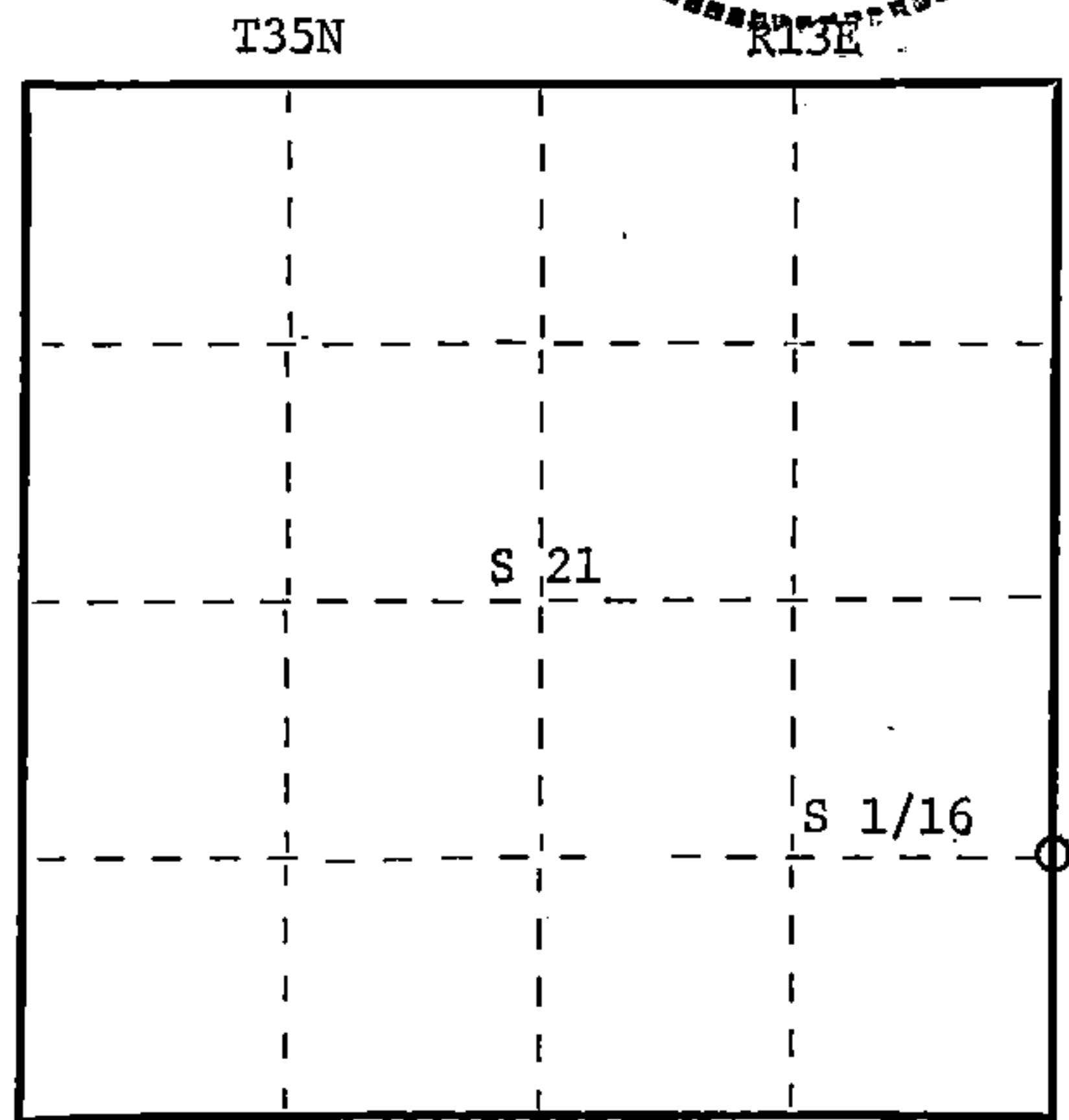

○ = Corner monument restored.

Dated at Rhinelander, Wis., this 30th day of December, 1982

Signature *Glen Barker* Title Registered Land Surveyor Registration No. S1682
(County Surveyor, Registered Land Surveyor, or other duly authorized official)

Office of Register of Deeds, County of Forest, I hereby certify that the within instrument was filed in this office for record on the 16th day of February, 1983 at 10:30 o'clock A.M.

Eugene Staszny
(Register of Deeds)

DOCUMENT NO. 122916

By _____ Deputy

4351321000