

CERTIFIED LAND CORNER RESTORATION

Index No. 2N7

State of Wisconsin }  
County of Forest } ss.

History of original corner establishment:

I Thomas R. Arnott, do hereby certify that on the 16th day of September, 19 75, I found evidence of the 1/4 corner of sections 17 & 20 Township 35, North, Range 13 E, Fourth Principal Meridian, as described hereon; and that from this evidence I established a new monument and accessories as described hereon to perpetuate the original location of this corner.

Original Subdivision by James L. Nowlin Sept 11 - Sept. 21, 1865

Birch 15 N32W 20 Lks.  
Cedar 12 S4E 37 Lks.

Resident witnesses:  
Herbert Wagoner

Description of corner evidence found:

1 1/2" iron pipe found

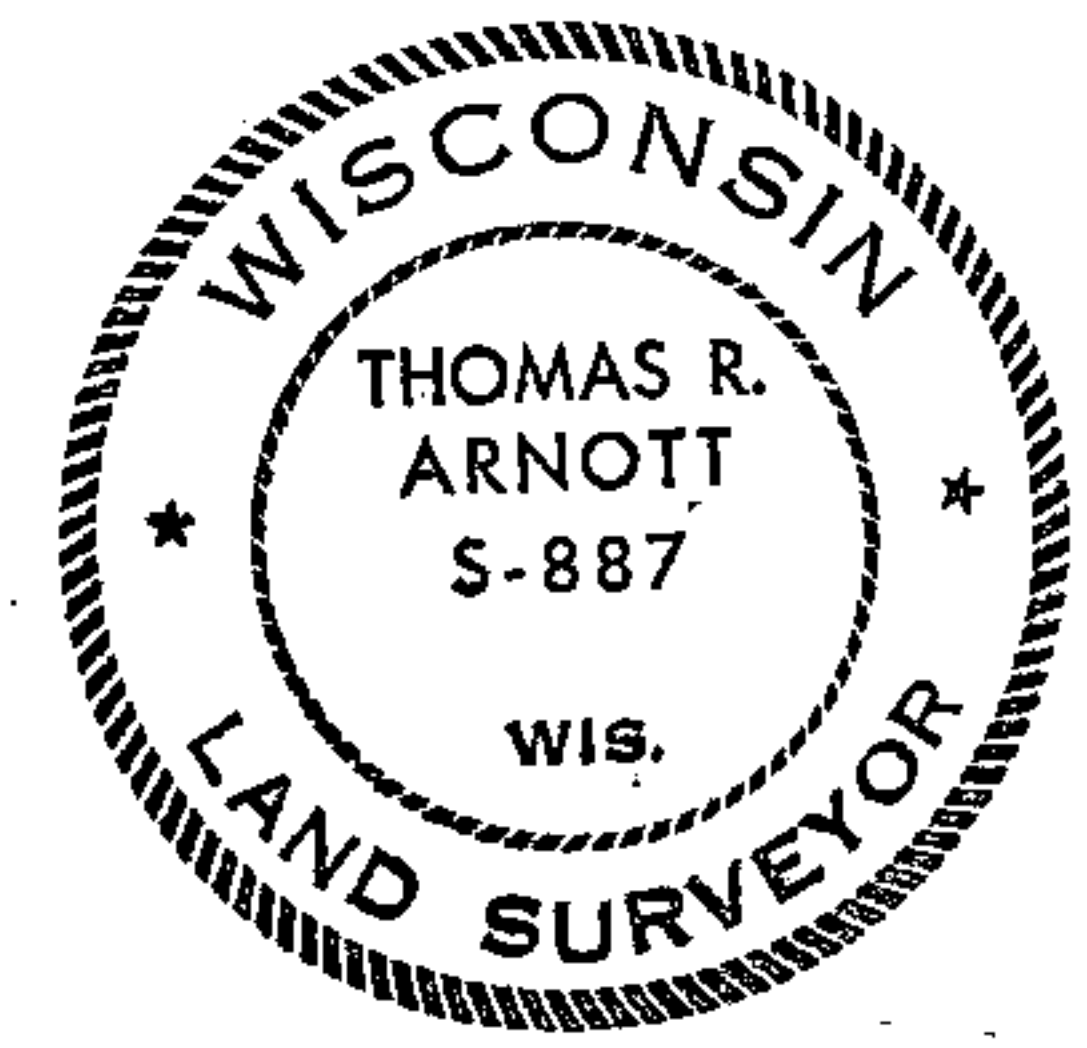

A3513170020

Description of monument and accessories I established to perpetuate the original location of this corner.

Reset corner with new Forest County aluminum monument 6" below ground level.

Ties:

power pole N36W 35.47 feet  
power pole (3513-20E1) S66 1/2 E 51.81 feet

FORM 985 H. C. MILLER CO., MILWAUKEE

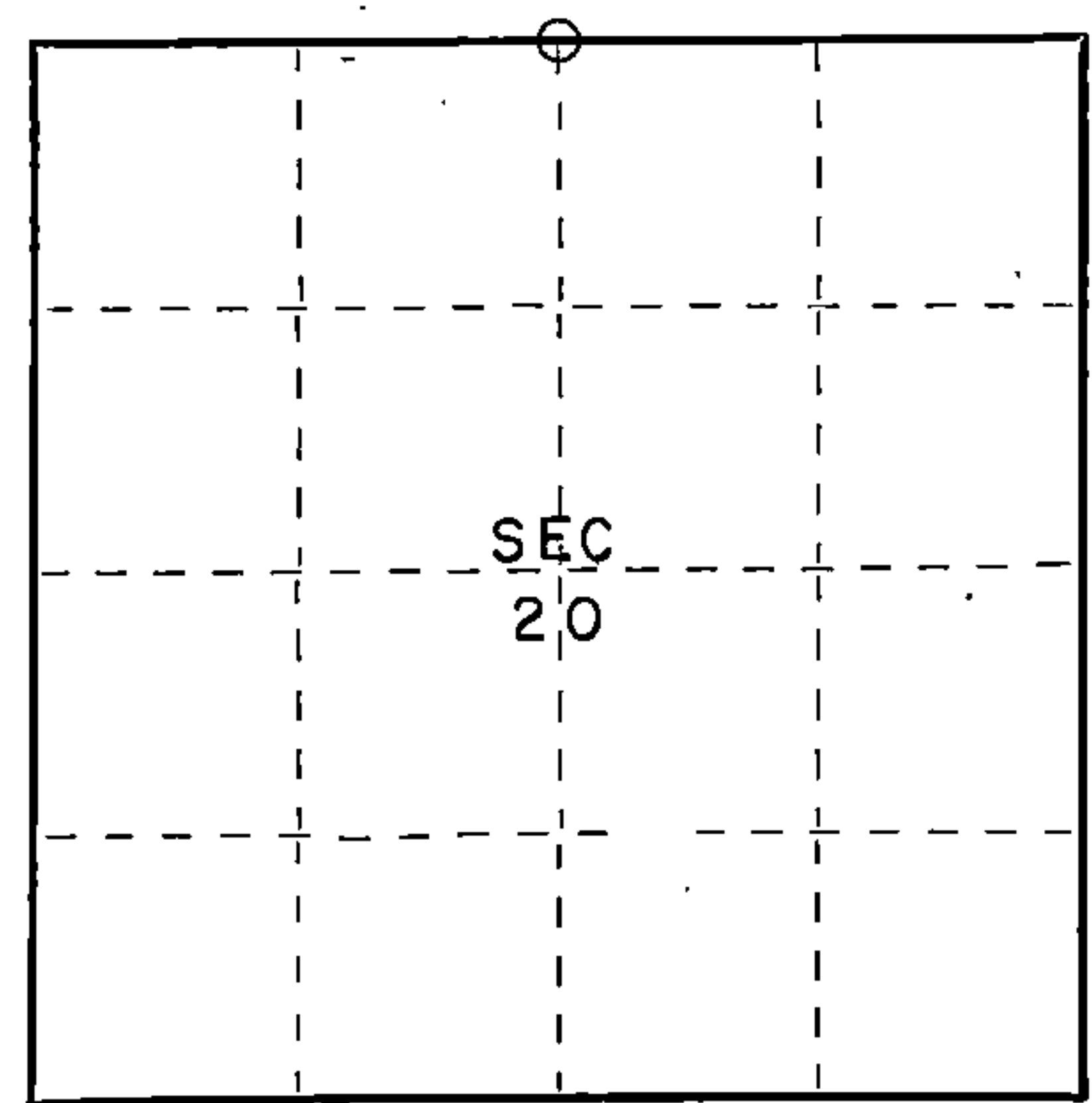

○ = Corner monument restored.

Dated at Grandon Wis., this 30th day of October, 19 75.

Signature Thomas R. Arnott Title Land Surveyor Registration No. S-887  
(County Surveyor, Registered Land Surveyor, or other duly authorized official)

Office of Register of Deeds, County of Forest, I hereby certify that the within instrument was filed in this office for record on the 30th day of October, 19 75 at 3 o'clock P. M.

Eugene Staszny Document Number 108123  
(Register of Deeds)

By \_\_\_\_\_ Deputy